

INDEX OF SHEETS

# STATE OF VERMONT DEPARTMENT OF HIGHWAYS



POOR ORIGINAL COPY

R.O.W. PLANS

## PROPOSED IMPROVEMENT BRIDGE PROJECT

TOWN OF JAMAICA  
COUNTY OF WINDHAM

ROUTE NO. VT. RTE 30 BRIDGE NO: 30

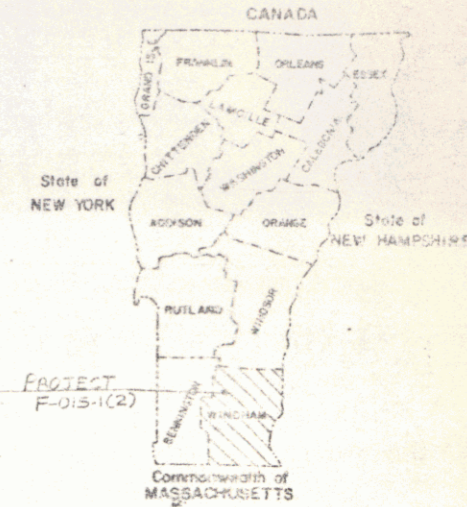

P.O. 77B019  
Date: 01/24/1978

### GENERAL NOTES:

- The General Note pertaining to Specifications, Materials, and Construction is shown on Std. Dwg. 508-DI-7B. Other General Notes on the Standard, not otherwise shown or modified on these plans, are notes 2, 3, 4, 5, 7, 8, 9, 10, 11, and 14.
- As designed the structure is capable of carrying an HS20-44 live load. The roadway is designed for 40 mph in the village.
- The existing beams shall be re-positioned to the spacing as shown on the Typical Bridge Section. New diaphragms shall be erected and new bearings shall be placed. The existing structural steel shall be blast cleaned and painted according to Section 513 of the Standard Specifications with payment to be subsidiary to Painting, Blast Cleaning.

PROJECT LOCATION: Beginning 0.1 miles from the intersection of VERMONT 30 AND JAMAICA in Jamaica Village and proceeding 0.057 miles northwesterly along Rte 30.

PROJECT DESCRIPTION: Remove existing concrete bridge deck, widen abutments, pier, and superstructure, construct new composite concrete deck and sidewalk with related roadway and channel work.

LENGTH OF STRUCTURE:	117.84 FEET
LENGTH OF PARTICIPATION ROADWAY:	182.16 FEET
LENGTH OF NON-PARTICIPATION ROADWAY:	---
LENGTH OF PROJECT:	300 FEET
LENGTH OF ROW PROJECT:	300 FEET

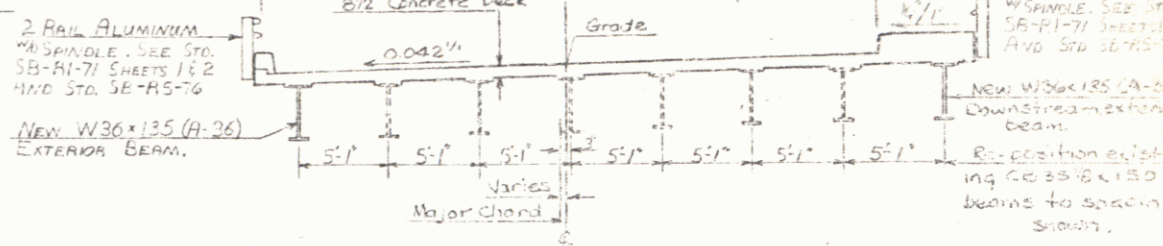

TYPICAL BRIDGE SECTION

SCALE 3/8" = 1'-0"

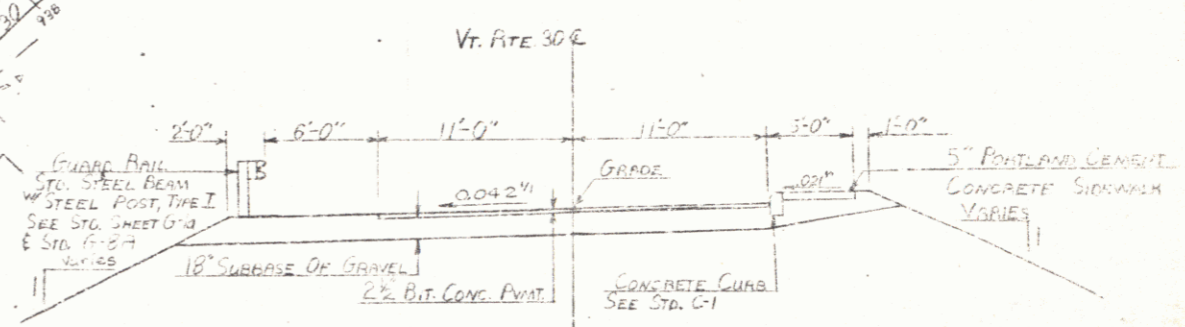

TYPICAL ROADWAY SECTION

SCALE 3/8" = 1'-0"

### CONVENTIONAL SIGNS

- COUNTY LINE
- TOWN LINE
- LIMITS OF ACCESS
- POINT OF ACCESS
- FENCE LINE
- STONE WALL
- TRAVELED WAY
- GUARD RAIL
- RAILROAD
- SURVEY LINE
- SILVERT
- POWER POLE
- TELEPHONE POLE
- TREES
- F.A. COAST IDENTIFICATION SWIRL
- PROPERTY LINE
- ROW TAKING LINE
- SLOPE RIGHTS
- TOP OF CUT
- TOE OF SLOPE

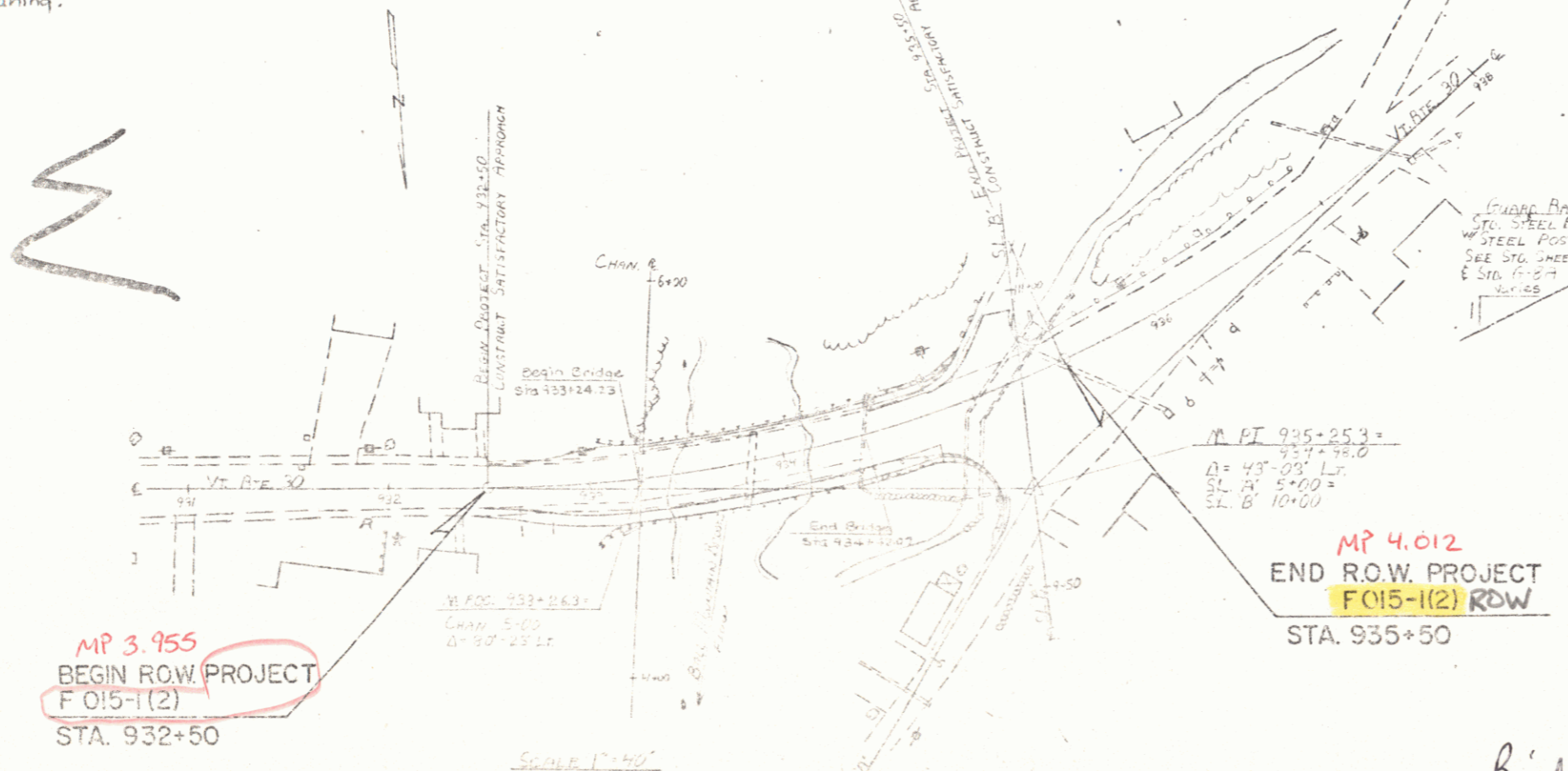

MP 3.955  
BEGIN ROW PROJECT  
F 015-1(2)  
STA. 932+50

MP 4.012  
END R.O.W. PROJECT  
F 015-1(2) RDW  
STA. 935+50

### RIGHT-OF-WAY DIVISION

TOWN FILE

PERPETUAL

Town of Vt 30  
(To Be Returned To R.O.W. Division)

Bridge # 30  
M.P. 3.84

SUBMITTED BY ORDER OF THE STATE HIGHWAY BOARD  
APPROVED: [Signature] DATE: 12-23-78  
CHIEF ENGINEER

DEC 23 1981

APPROVED: [Signature]  
DATE: 1-27-78  
CHIEF ENGINEER

PROJECT: JAMAICA  
SHEET: 1 OF 4  
SCALE: AS SHOWN