

STATE OF VERMONT  
AGENCY OF TRANSPORTATION

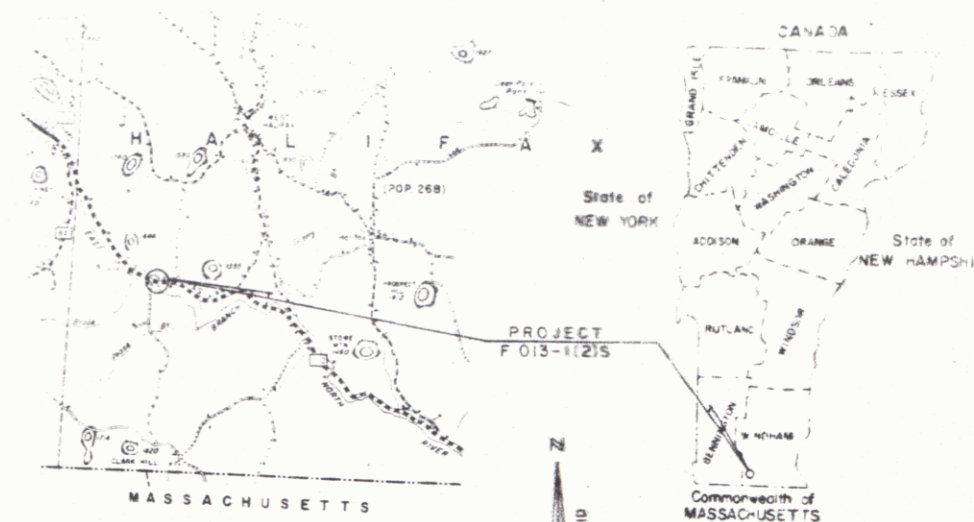

**PROPOSED IMPROVEMENT**  
**TOWN OF HALIFAX**  
**COUNTY OF WINDHAM**  
**BR. 7 (FORMERLY BR. 10) - VT RTE. 112 (FAP)**



SCALE IN MILES

R.O.W. PLANS

BEGINNING AT POINT APPROXIMATELY 1.277 MILES  
SOUTHEASTERLY OF THE HALIFAX-WHITINGHAM TOWN  
LINE AND EXTENDING SOUTHEASTERLY 0.095 MILES

LENGTH OF ROADWAY= 423.39 FEET= 0.080 MILES  
LENGTH OF BRIDGE= 76.61 FEET= 0.015 MILES  
LENGTH OF PROJECT= 500.00 FEET= 0.095 MILES  
LENGTH OF R.O.W. PROJECT= 850.00 FEET= 0.161 MILES

WORK UNDER THIS PROJECT INCLUDES REPLACEMENT  
OF BRIDGE NO. 7 AND RECONSTRUCTION OF ROADWAY  
APPROACHES.

BEGIN R.O.W. PROJECT  
F 013-1(2)S STA. 65+50 CL

END R.O.W. PROJECT  
F 013-1(2)S STA. 74+00 CL

CONVENTIONAL SIGNS

COUNTY LINE	---
TOWN LINE	- - - -
LIMITS OF ACCESS	---X---
POINT OF ACCESS	X
FENCE LINE	=====
STONE WALL	-----
TRAVELED WAY	.....
GUARD RAIL	---X---
RAILROAD	====X====
SURVEY LINE	-----
CULVERT	-----
POWER POLE	○
TELEPHONE POLE	○
TREES	○
CONTROL OF ACCESS	///
PROPERTY LINE	---
R.O.W. TAKING LINE	---
SLOPE RIGHTS	SR
TOP OF CUT	△
TOE OF SLOPE	○

DATUM

VERTICAL	NGVD 1929
HORIZONTAL	N/A

SCALE IN FEET

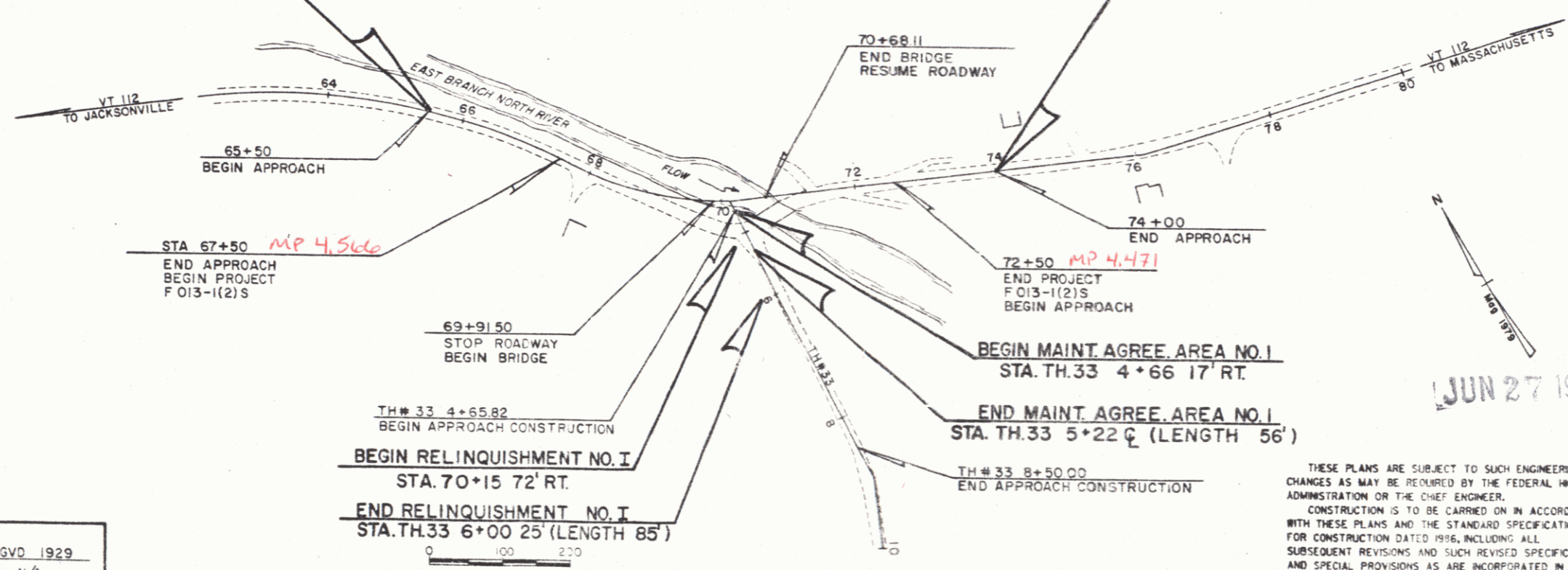

Pin# 77B017

JUN 27 1988

ALL DRIVES AS INDICATED ON  
PLANS ARE SUBJECT TO PER-  
MITS PURSUANT TO TITLE 19,  
SECTION 43, V.S.A.

PROJECT PROCESSED UNDER  
SECONDARY ROAD PLAN

APPROVED [Signature] DATE 6/9/88  
CHIEF ENGINEER

APPROVED [Signature] DATE 6/10/88  
ACTING CHIEF PROPERTY ADMINISTRATION

HALIFAX  
F 013-1(2)S  
SHEET 1 OF 7

THESE PLANS ARE SUBJECT TO SUCH ENGINEERING  
CHANGES AS MAY BE REQUIRED BY THE FEDERAL HIGHWAY  
ADMINISTRATION OR THE CHIEF ENGINEER.  
CONSTRUCTION IS TO BE CARRIED ON IN ACCORDANCE  
WITH THESE PLANS AND THE STANDARD SPECIFICATIONS  
FOR CONSTRUCTION DATED 1976, INCLUDING ALL  
SUBSEQUENT REVISIONS AND SUCH REVISED SPECIFICATIONS  
AND SPECIAL PROVISIONS AS ARE INCORPORATED IN THESE  
PLANS.

# TYPICAL SECTIONS

1 1/2" Bituminous Concrete Pavement Type II  
 4" Plant Mixed Base Course Placed in Two - 2" Courses  
 24" Subbase of Gravel

Shoulders: 1 1/2" Bituminous Concrete Pavement Type II  
 0"-12" Granular Borrow (In Fills)  
 0"-24" Sand Borrow (In Cuts)

as indicated on the plans or as directed by the Engineer

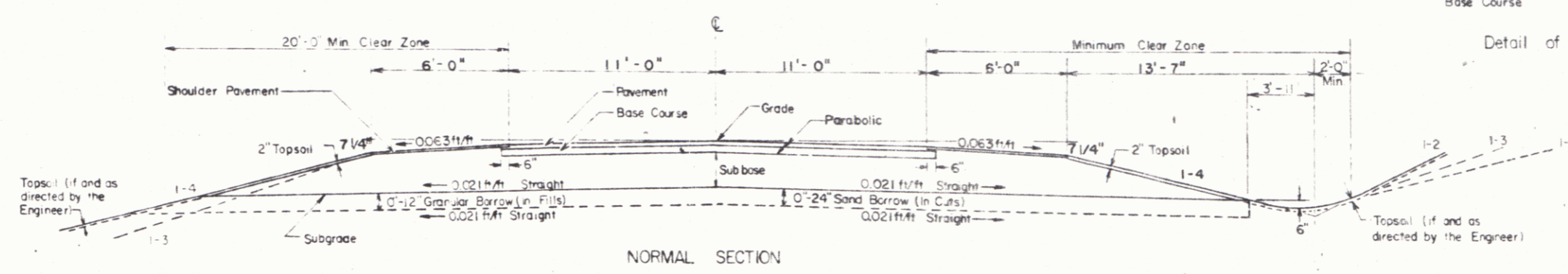
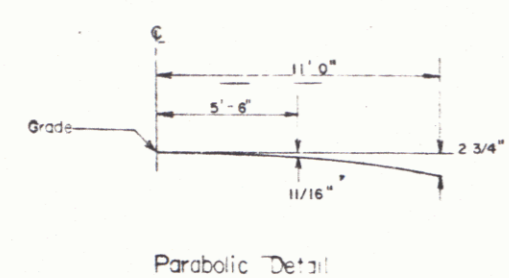
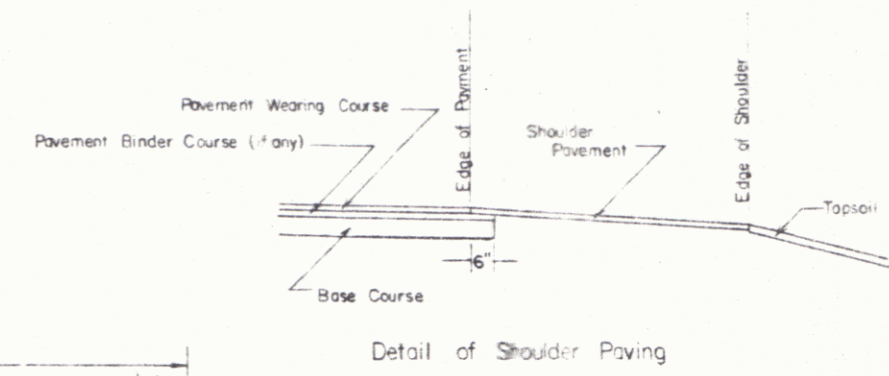
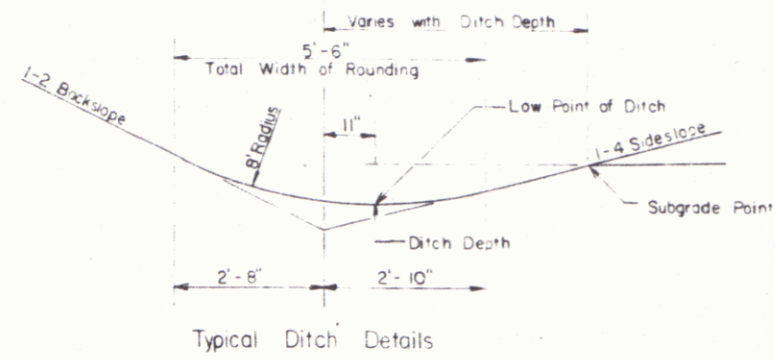

Material Item	Thickness	Tolerance
Pavement	1 1/2"	± 1/4"
Base Course	4"	± 1/2"
Subbase	24"	± 1"
Granular Borrow	0"-12"	± 1"
Sand Borrow	0"-24"	± 1"

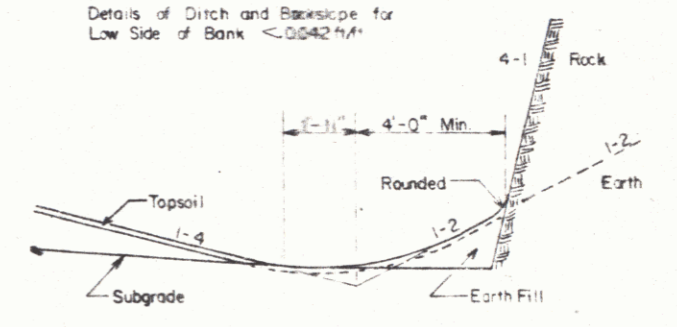
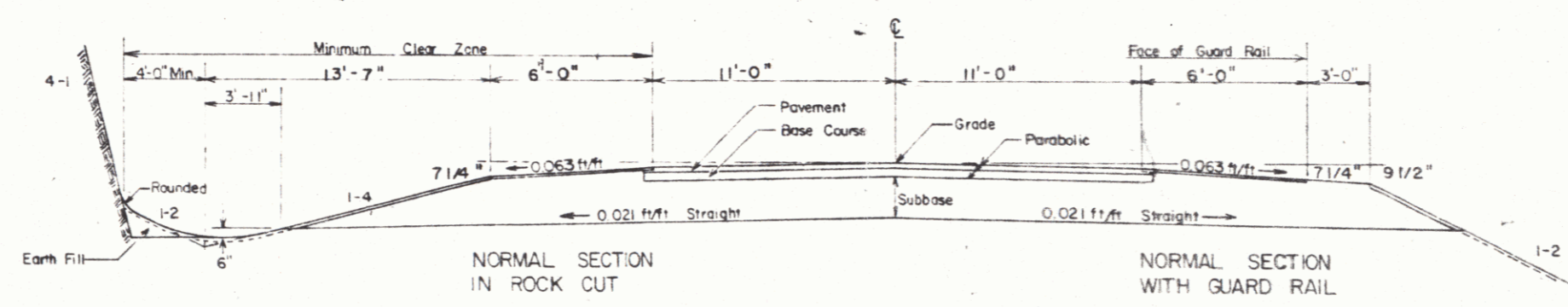
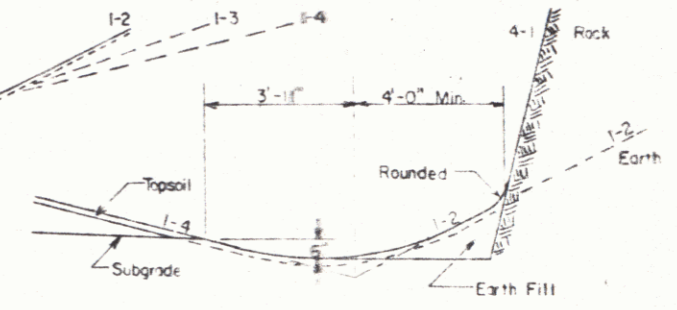
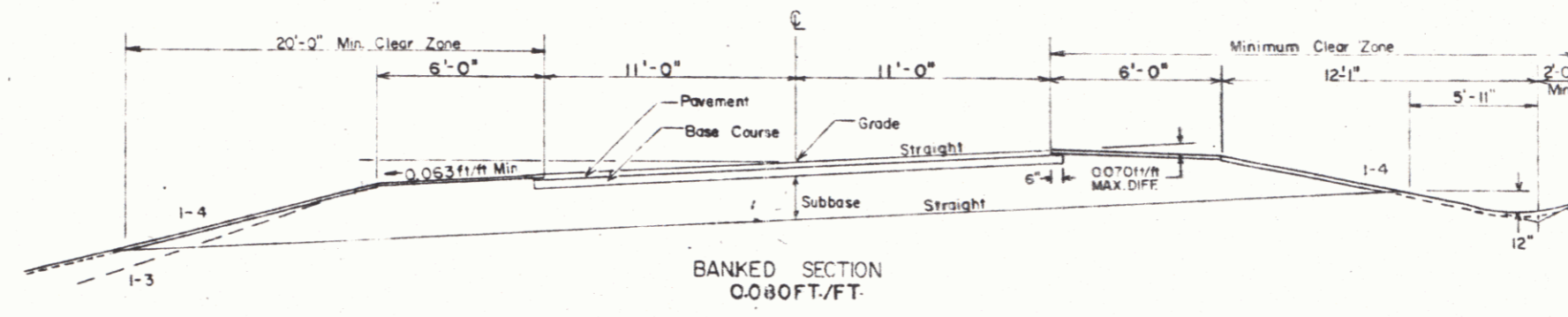
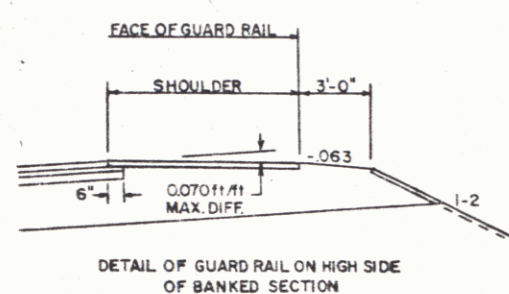

For slopes in Solid Rock Excavation and Drilling and Blasting of Solid Rock Subgrade, see Standard Sheet A-62.

Rate	lbs./A.	Name	Par. 1	Par. 2
3.33	2	Crow Vetch	97	75
50.00	30	Cresting Red Fescue	98	85
8.33	5	Timothy	99	85
16.67	10	Perennial Ryegrass (Var. Pennine)	95	85
1.34	3	Alfalfa (Var. Saracoe)	55	85
8.33	5	Birdfoot Trefoil (Var. Espire)	56	85
5.00	5	Highland Seed Grass	92	85
20.00	20			

- General Notes
- SEED - To be applied per Seeding Formula as directed by the Engineer.
  - FERTILIZER - Formula 10-20-10 to be used with Seed, applied at the rate of 500 lbs./Acre.
  - AGRICULTURAL LIMESTONE - To be used with Seed, applied at the rate of 2 Tons/Acre or as directed by the Engineer.
  - HAY MULCH - To be placed on earth slopes at the rate of 2 Tons/Acre.
  - TOPSOIL - To be used with Seed as indicated on the plans or as directed by the Engineer.
  - MARKER POSTS (Wood or Steel, as specified) - To be placed as directed by the Engineer.
  - SLOPE ROUNDING - All cut slopes to be rounded in accordance with Standard Sheet B-5.
  - PAY LIMITS OF SAND BORROW WHEN USED IN CONJUNCTION WITH UNDERDRAIN - See Standard Sheet D-2.

SEE SHEET 3 FOR TH 33 TYPICAL SECTION.

HALIFAX  
 F 013-1(2) S  
 SHEET 2 OF 7

PLAN	DATE	
	BY	
APPROVED		
ALIGNED CHECKED		
BY		
DATE		

PROFILE	DATE	
	BY	
APPROVED		
ALIGNED CHECKED		
BY		
DATE		

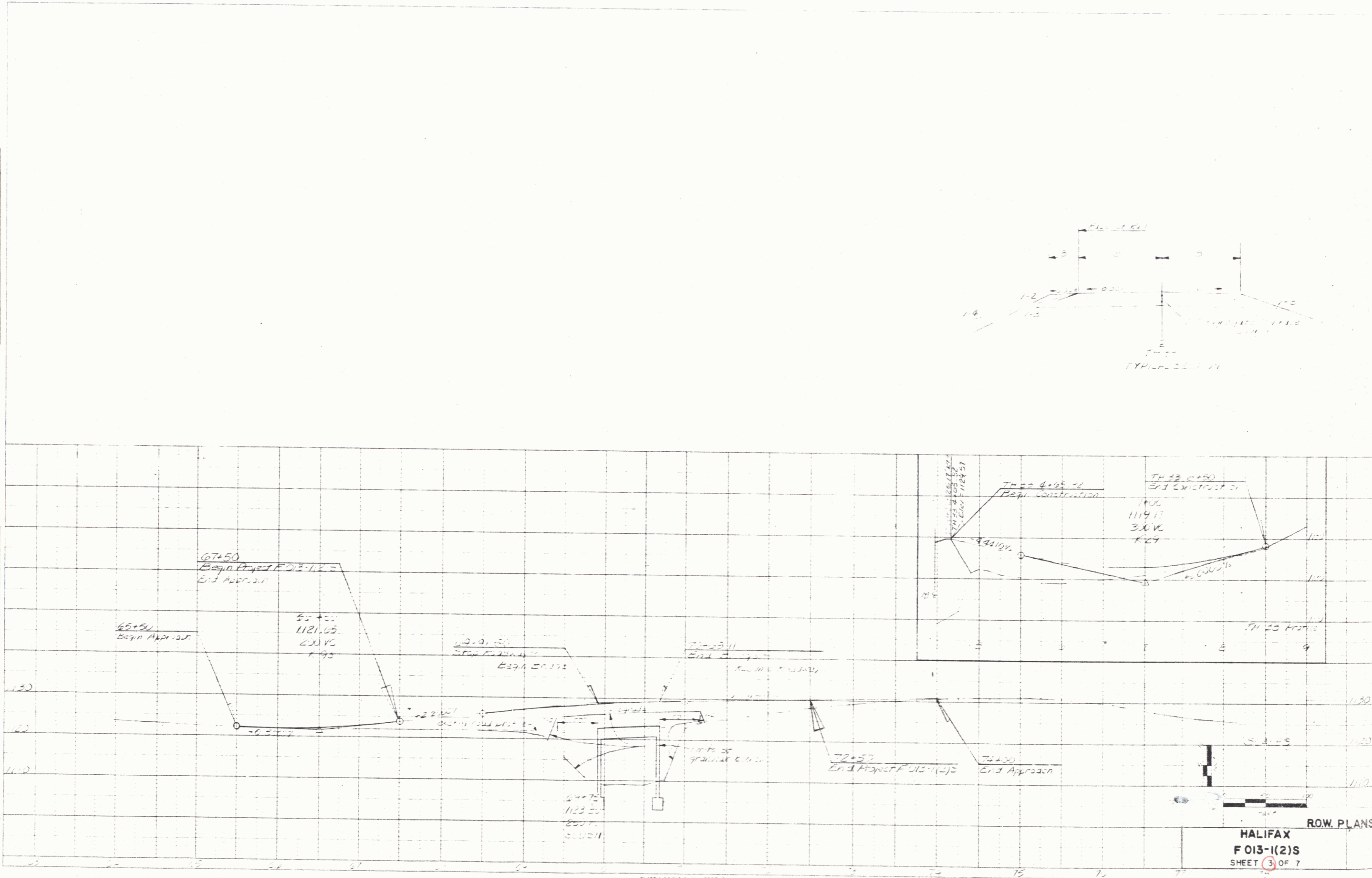

ROW PLANS  
 HALIFAX  
 F013-1(2)  
 SHEET 3 OF 7

STRUCTURE LAYOUT TABLE						
WORK POINT	REV. VT. RTE. 112		CHANNEL LINE		TOP EL.	BOT. OF FTNG. EL.
	STATION	OFFSET	STATION	OFFSET		
1	68+84.09	31.33' LT.	8+76.52	43.53' LT.	1118.50	1104.00
2	69+47.47	23.75' LT.	9+35.68	53.53' LT.	1125.50	1104.00
3	69+97.02	49.83' LT.	9+66.77	95.79' LT.	1125.50	1103.78
4	69+91.50	0.0'	9+84.46	48.92' LT.	1122.61	1103.61
5	70+68.11	0.0'	10+50.36	87.87' LT.	1122.11	1103.11
6	70+57.62	49.01' RT.	10+68.18	41.01' LT.	1125.50	1102.94
7	71+04.30	28.47' RT.	10+96.20	83.55' LT.	1125.50	1102.75
8	71+56.76	36.03' RT.	11+44.39	105.62' LT.	1121.50	1102.75
9	70+68.02	75.00' RT.	10+90.91	24.79' LT.	1121.50	1102.94

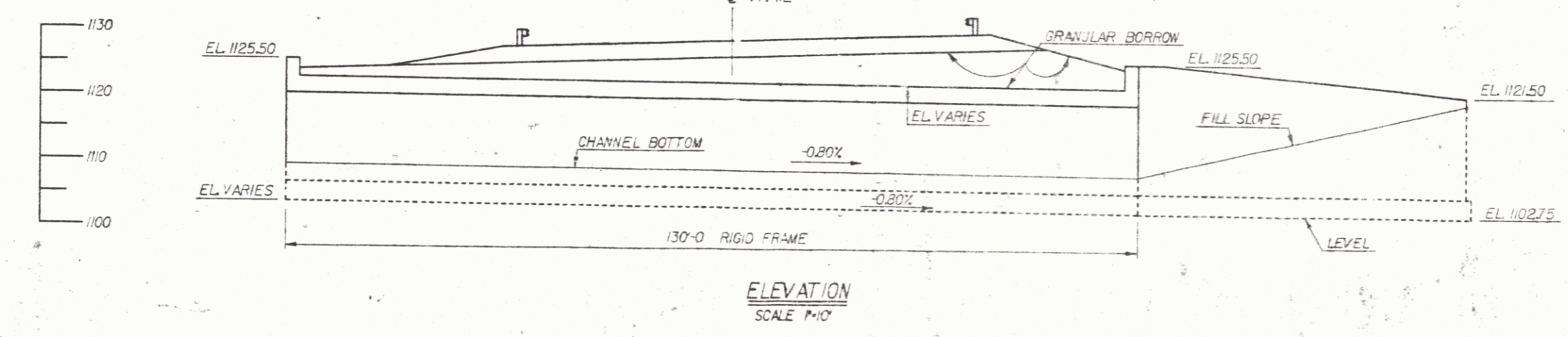
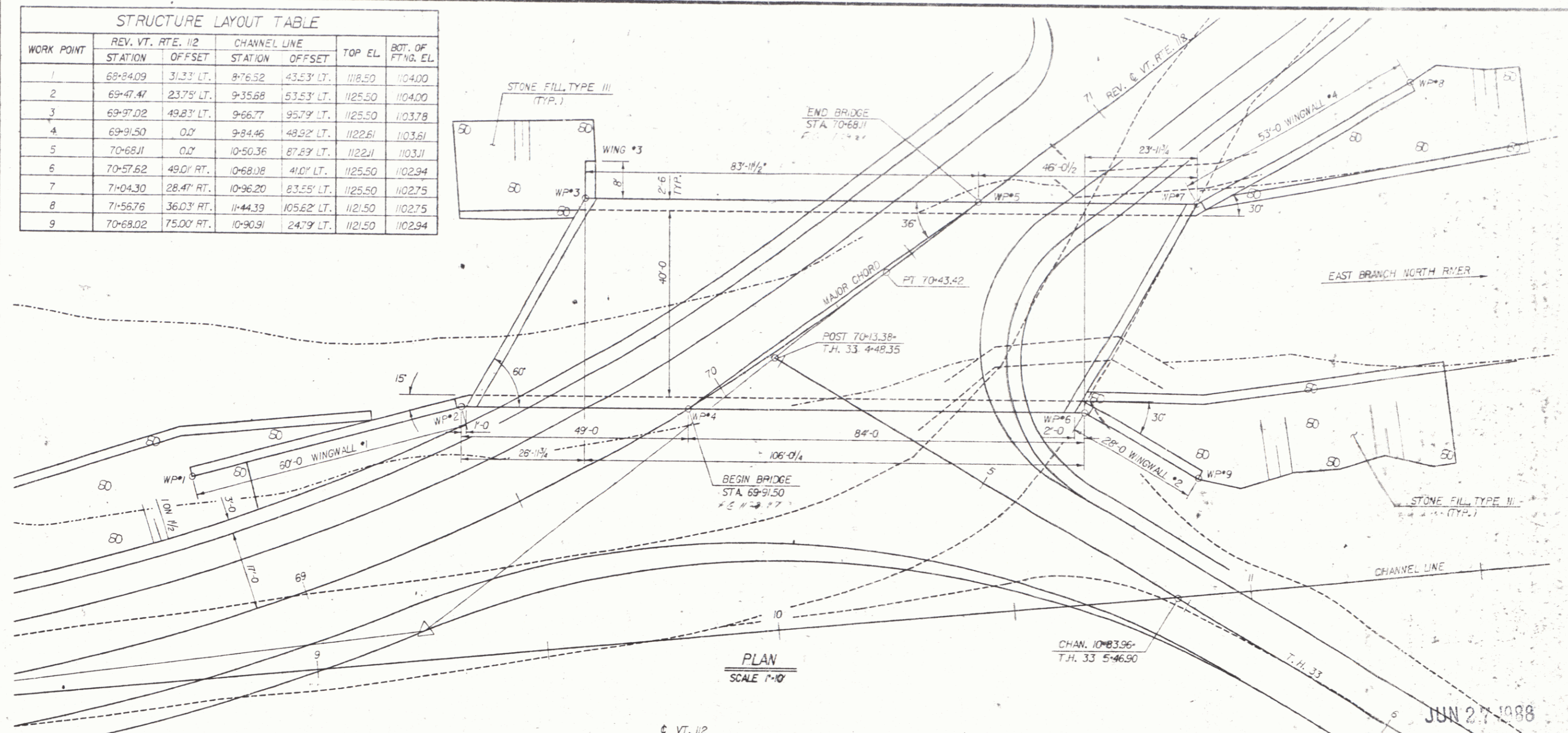

ROW PLANS

**STATE OF VERMONT**  
**AGENCY OF TRANSPORTATION**

Town of HALIFAX	Bridge No.
Highway No. VT. RTE. 112	Log. Sta.
PLAN AND ELEVATION	
VT. RTE. 112 OVER THE EAST BRANCH NORTH RIVER	
Designed By	Drawn By
Checked By	Bridge Design Supervisor
G. V. SPILAK	R. S. HALIFAX
Date 11-85	Date 8-85
<b>HALIFAX</b>	
<b>F 013-1(2)S</b>	
SHEET 4 OF 7	

JUN 27 1988

BR-4

11-85

4

STATE OF VERMONT  
AGENCY OF TRANSPORTATION  
RIGHT-OF-WAY PLANS  
DETAIL SHEET

TABLE OF PROJECT PROPERTY ACQUISITION

PARCEL NO.	GRANTOR	SHEET NO.	BEGINNING STATION	ENDING STATION	TAKING	REM	RIGHTS	TITLE TAKEN	DATE	TOWN OR CITY RECORDED	BK.	PG.	REMARKS
1A	STONE, WESLEY A. & GRACE J. STONE, FRANK M.	7	66+25 LT 65+50 LT 65+80 LT 66+25 LT±	70+75 E 66+25 LT 66+25 LT	0.34A±		CONST. EASE. (T) (0.01 A±) SLOPE (T) (340 SF±) CULVERT & DRAINAGE (P)	WD		HALIFAX			EXCLUDING FLOWAGE RIGHTS (600 S.F.±)
1B		7	70+69 RT 72+50 RT 72+50 RT± 73+00 RT TH 33 6+00 RT± TH 33 5+97 LT TR 33 6+00 LT 77+50 RT	72+50 RT 73+68 RT TH 33 7+50 LT TH 33 7+00 LT	0.20 A±		DRIVE (T) CULVERT & DRAINAGE (P) SLOPE (T) (0.01 A±) DRAINAGE (P) CONST. EASE. (T) (0.02 A±) SLOPE (T) (225 SF±) DRIVE (T)						EXCLUDING FLOWAGE RIGHTS 15' GRAVEL W.P. 0447  600 S.F.±  (1000 S.F.±)  12' PAVED W.P. 0437
1C		7	66+25 RT 65+95 RT 66+25 RT	72+50 RT 66+90 RT 66+95 RT	0.43 A±		ALL R.T. & I. CONST. EASE. (T) (0.02 A±) SLOPE (T) (0.01 A±)						VT STATE H2 EXCLUDING FLOWAGE RIGHTS (800 S.F.±) (440 S.F.±)
1D		7	TH 33 6+00 E	70+40 RT	0.04 A±		ALL R.T. & I.						TH 33 (1800 S.F.±)
2A	STEWART, GERTRUDE G.	7	70+15 RT TH 33 6+75 RT 69+60 RT 69+85 RT	TH 33 6+00 RT TH 33 6+22 RT TH 33 6+15 R	0.01 A±		DRIVE (T) CONST. EASE. (T) (0.03 A±) SLOPE (T) (0.03 A±)	WD		HALIFAX			(415 S.F.±)  (1200 S.F.±) (1300 S.F.±)
2B		7	66+95 RT 66+90 RT 66+92 RT 68+00 RT 67+90 RT	70+40 RT 67+85 RT 67+85 RT 69+08 RT	0.21 A±		ALL R.T. & I. CONST. EASE. (T) (0.02 A±) SLOPE (T) (0.02 A±) SLOPE (T) (0.01 A±) DRIVE (T)						VT RTE. 112 (700 S.F.±) (695 S.F.±) (440 S.F.±) 12' GRAVEL W.P. 0454
PARCEL 2 CONTINUED ON NEXT SHEET													

TABLE OF REVISIONS

REVISION NO.	SHEET NO.	DESCRIPTION OF REVISION	DATE	MADE BY	APPROVED BY
1	6,7	PARCEL NO. 8 TOWN OF HALIFAX DELETE TAKING OF R.T. # 1 IN TOWN ROAD AND ADD APPROACH (T) AT 70+15 RT PER CO 6881	2-5-87	H.J.R.	K.A.H.
2	5,7	PARCEL NO. 1 STONE, RECONSTRUCT DRIVE @ STA. 77+50 RT. ADD DIRK RT. (T) PER CO 6148	6-12-87	H.J.R.	K.A.H.

MADE BY: F. JOHN MALNATI JR. DATE 27 MAY 86  
CHECKED BY: L.W. BLISS DATE 27 MAY 86

DR. RT. - DRAINAGE RIGHT  
DIT. RT. - DITCHING RIGHT  
CH. RT. - CHANNEL RIGHT  
DRIVE RT. - DRIVE RIGHT  
CUL. RT. - CULVERT RIGHT  
⊖ - DEMOLITION OR  
REMOVAL  
W - WATER SOURCES

PRESENT R.O.W.  
- - - - - TAKING WITHOUT ACCESS  
- P - L - - - - TAKING WITHOUT ACCESS ALONG PROPERTY LINES  
- - - - - TAKING WITH ACCESS  
(P) - PERMANENT EASEMENT  
(T) - TEMPORARY EASEMENT

LEGEND  
- - - - - CONST. EASE. - - - - - CONST. EASEMENT  
SR - SR - - - - - SLOPE RIGHTS  
P - L - - - - - PROPERTY LINE  
- Δ - Δ - - - - - TOP OF CUT  
- O - O - - - - - TOE OF SLOPE

APPROVED: *[Signature]* DATE: 6-2-88  
CHIEF OF PLANS & TITLES

JUN 27 1988  
PROJECT HALIFAX  
NO. F 013-1(2) S  
SHEET 5 OF 7

STATE OF VERMONT  
AGENCY OF TRANSPORTATION  
RIGHT-OF-WAY PLANS  
DETAIL SHEET

TABLE OF PROJECT PROPERTY ACQUISITION

PARCEL NO.	GRANTOR	SHEET NO.	BEGINNING STATION	ENDING STATION	TAKING	REM.	RIGHTS	TITLE TAKEN	DATE	TOWN OR CITY RECORDED	BK.	PG.	REMARKS
2C	PARCEL 2 CONTINUED FROM PREVIOUS SHEET	7	70+22 RT	TH33 6+00 RT	0.04 A±		ALL R. T. & I.						TH 33
3	DELETED												FORMERLY ROWEN
4C	LOCINTO, LENA	7	68+93 LT 71+25 LT 71+22 LT 71+31 LT 72+54 LT	72+50 LT 74+00 LT 73+25 LT	0.18 A±		DRIVE (T) CONST.EASE. (T) (0.05 A±) SLOPE (P) (0.11 A±) DRIVE (T)	WD		HALIFAX			12' GRAVEL MP 0445 (2380 S.F. ±) 10' GRAVEL MP 0445
5	DELETED	7											FORMERLY STONE, JAMES W. & STONE, FRANK M.
6	NEW ENGLAND TELEPHONE CO.	7											UTILITY
7	CENTRAL VT. CO-OP	7											UTILITY
8	TOWN OF HALIFAX	7	70+15 RT				APPROACH (T)						TH 33
	MAINTENANCE AGREEMENT AREA NO. 1	7	TH33 4+66 E	TH33 5+22 E									TH 33 (LENGTH 56)
	RELINQUISHMENT NO. 1	7	70+15 RT	TH33 6+00 RT									TH 33

TABLE OF REVISIONS

REVISION NO.	SHEET NO.	DESCRIPTION OF REVISION	DATE	MADE BY	APPROVED BY

MADE BY: F. JOHN MALNATI JR. DATE 27 MAY 86  
CHECKED BY: L.W. BLISS DATE 27 MAY 86

DR RT - DRAINAGE RIGHT  
DIT RT - DITCHING RIGHT  
CH RT - CHANNEL RIGHT  
DRIVE RT - DRIVE RIGHT  
CUL RT - CULVERT RIGHT  
D - DEMOLITION OR REMOVAL  
W - WATER SOURCES

PRESENT R.O.W.  
TAKING WITHOUT ACCESS  
TAKING WITHOUT ACCESS ALONG PROPERTY LINES  
TAKING WITH ACCESS  
PERMANENT EASEMENT  
TEMPORARY EASEMENT

LEGEND  
--- CONST. EASE --- CONST. EASEMENT  
SR SR SLOPE RIGHTS  
P L PROPERTY LINE  
-Δ- Δ- Δ- TOP OF CUT  
-O- O- O- TOE OF SLOPE

APPROVED: *[Signature]* DATE: *[Date]*  
CHIEF OF PLANS & TITLES

R.O.W. PLANS  
JUN 27 1988  
PROJECT HALIFAX  
NO. F 013-1(2) S  
SHEET 6 OF 7

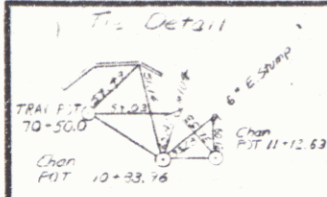

- Steel Beam Guard Rail
  - Lt 65+75 ~ 70+75
  - Rt 70+55 ~ 72+00 (TH 33-5+32.0)
- Construct Drive
  - Lt 71+25
  - Rt 67+90
  - 72+64
  - TH 33-6+69
- Special Ditch
  - Rt 5+25 ~ 5+95
- Unclassified Channel Excavation
  - Lt 66+25 ~ 69+25
- Stone Fill Type III
  - Lt 66+25 ~ 69+25
- Removal & Disposal of Guard Rail
  - Lt 69+80 ~ 70+25
  - Rt 70+60 ~ 70+70
  - 70+90 ~ 71+15 Lt
  - 71+15 ~ 71+27
- Scarifying Pavement
  - 63+50 ~ 71+50

**BEGIN R.O.W. PROJECT**  
FO13-1(2)S STA. 65+50 C

**END R.O.W. PROJECT**  
FO13-1(2)S STA. 74+00 C

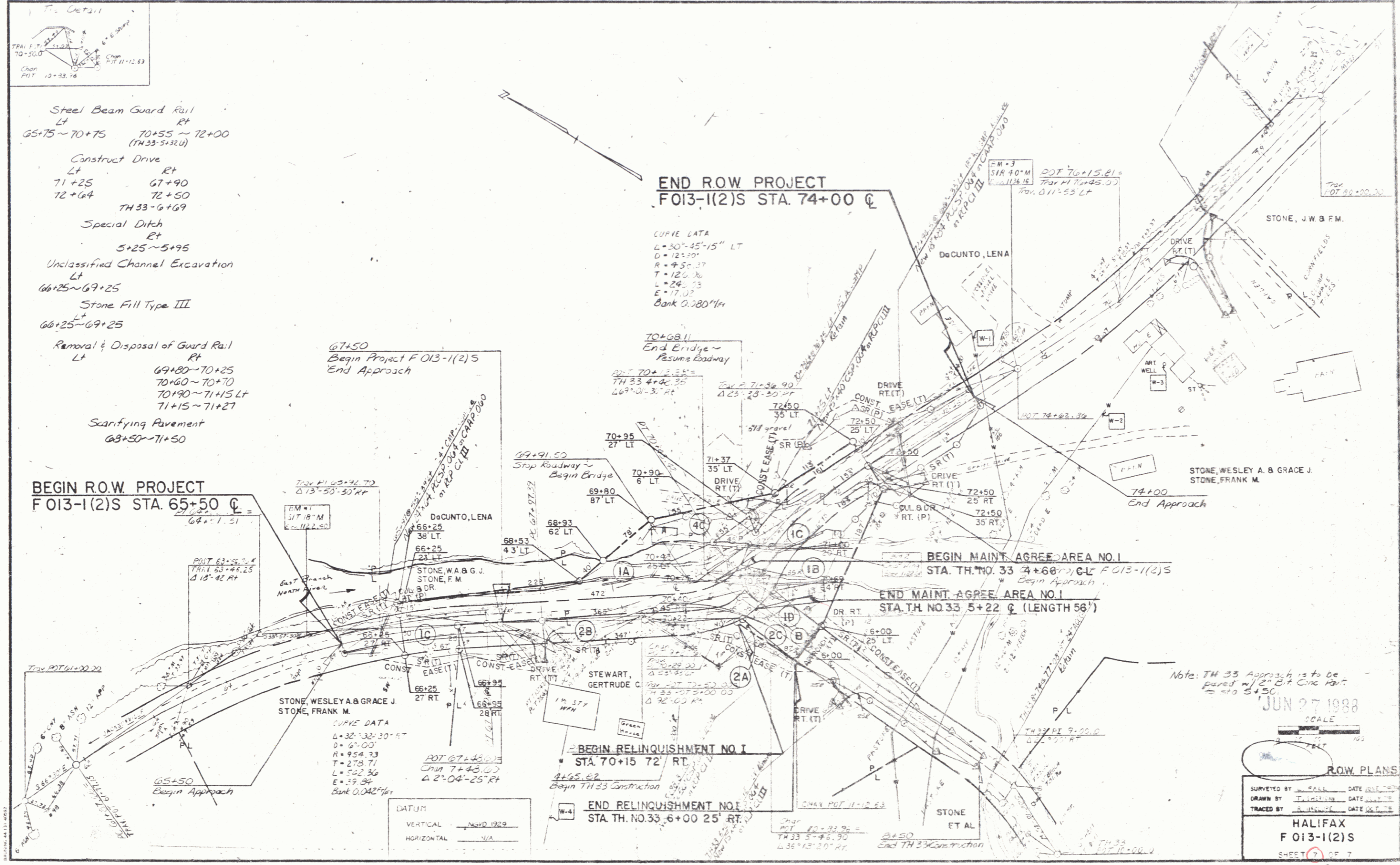

**CURVE DATA**  
 L=30'-45'-15" LT  
 D=12'-00"  
 R=45'-00"  
 T=12'-00"  
 L=24'-00"  
 E=17'-00"  
 Bank 0.280%/ft

67+50  
End Bridge ~  
Begin Project FO13-1(2)S  
End Approach

**BEGIN MAINT. AGREE. AREA NO. 1**  
STA. TH. NO. 33 4+66 C-LT FO13-1(2)S  
Begin Approach

**END MAINT. AGREE. AREA NO. 1**  
STA. TH. NO. 33 5+22 C (LENGTH 56')

**BEGIN RELINQUISHMENT NO. 1**  
STA. 70+15 72' RT

**END RELINQUISHMENT NO. 1**  
STA. TH. NO. 33 6+00 25' RT

**CURVE DATA**  
 L=32'-32'-30"-R  
 D=6'-00"  
 R=95'-33"  
 T=27'-71"  
 L=54'-36"  
 E=39'-34"  
 Bank 0.042%/ft

**DATUM**  
 VERTICAL - NAVD 1929  
 HORIZONTAL - N/A

Note: TH 33 Approach is to be paved w/ 12" Bit Conc Pav. to 5+30.

JUN 27 1988

SCALE  
1" = 40'

**R.O.W. PLANS**

SURVEYED BY	DATE
DRAWN BY	DATE
TRACED BY	DATE

HALIFAX  
FO13-1(2)S  
SHEET 7 OF 7