

- Steel Beam Guard Rail
  - Lt 65+75 ~ 70+75
  - Rt 70+55 ~ 72+00 (TH 33-5+32.0)
- Construct Drive
  - Lt 71+25
  - Rt 67+90
  - 72+64
  - TH 33-6+69
- Special Ditch
  - Rt 5+25 ~ 5+95
- Unclassified Channel Excavation
  - Lt 66+25 ~ 69+25
- Stone Fill Type III
  - Lt 66+25 ~ 69+25
- Removal & Disposal of Guard Rail
  - Lt 69+80 ~ 70+25
  - Rt 70+60 ~ 70+70
  - 70+90 ~ 71+15 Lt
  - 71+15 ~ 71+27
- Scarifying Pavement
  - 63+50 ~ 71+50

**BEGIN R.O.W. PROJECT**  
FO13-1(2)S STA. 65+50 C

**END R.O.W. PROJECT**  
FO13-1(2)S STA. 74+00 C

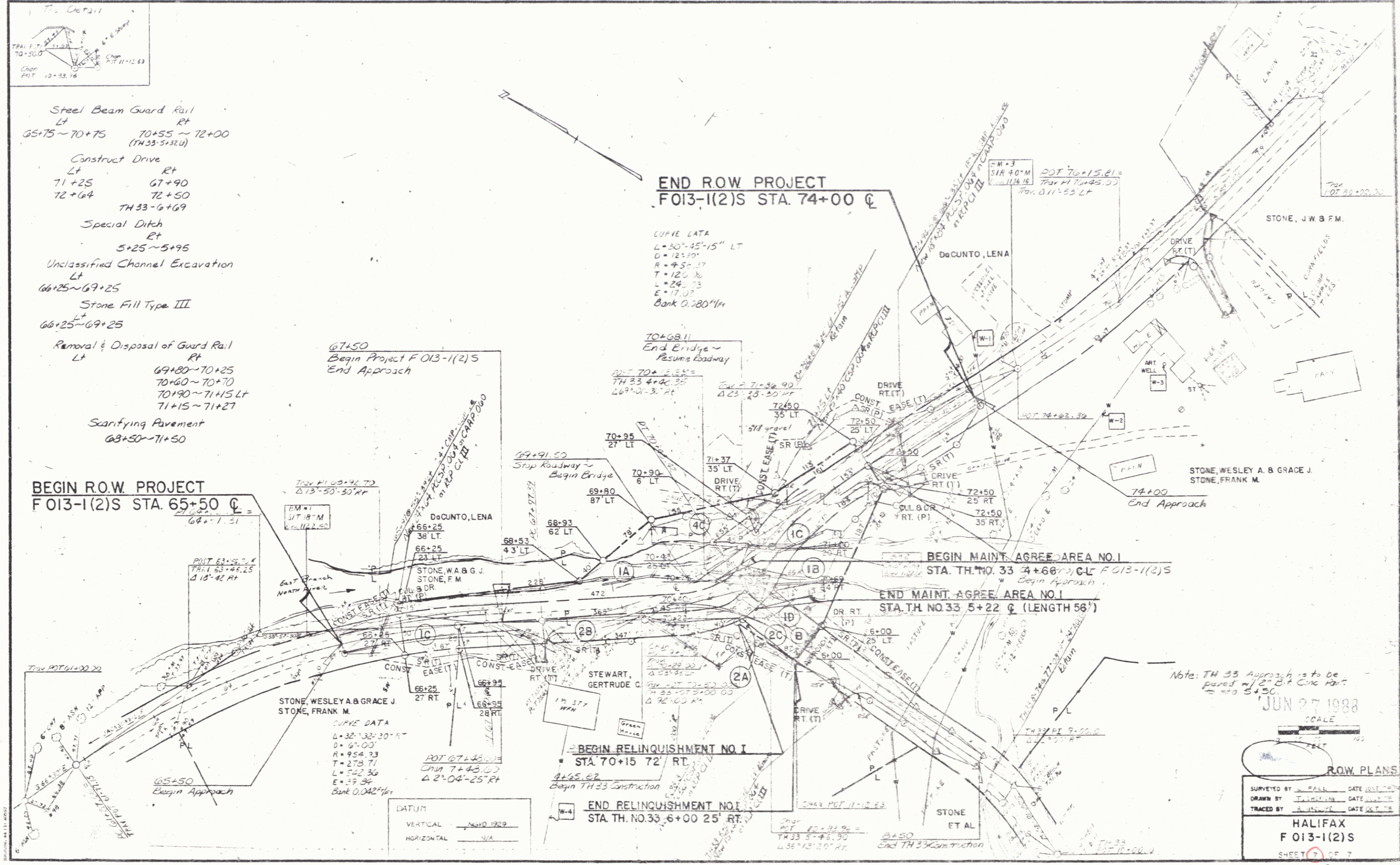

CURVE DATA  
 L=30'-45'-15" LT  
 D=12'-00"  
 R=45'-00"  
 T=12'-00"  
 L=24'-00"  
 E=17'-00"  
 Bank 0.280%/ft

70+68.11  
 End Bridge ~  
 Resume Roadway

67+50  
 Begin Project FO13-1(2)S  
 End Approach

**BEGIN MAINT. AGREE. AREA NO. 1**  
STA. TH. NO. 33 4+66 C-LT FO13-1(2)S

**END MAINT. AGREE. AREA NO. 1**  
STA. TH. NO. 33 5+22 C (LENGTH 56')

**BEGIN RELINQUISHMENT NO. 1**  
STA. 70+15 72' RT

**END RELINQUISHMENT NO. 1**  
STA. TH. NO. 33 6+00 25' RT

CURVE DATA  
 L=32'-32'-30"-9"  
 D=6'-00"  
 R=95'-33"  
 T=27'-71"  
 L=54'-36"  
 E=39'-34"  
 Bank 0.042%/ft

DATUM  
 VERTICAL - Mean D 1929  
 HORIZONTAL - N/A

Note: TH 33 Approach is to be paved w/ 12" Bit Conc Pav. to 5+30.

JUN 27 1988

SCALE  
 1" = 40'

R.O.W. PLANS

SURVEYED BY: FALL DATE 1987  
 DRAWN BY: T. J. GILMAN DATE 1987  
 TRACED BY: A. J. GILMAN DATE 1987

HALIFAX  
 FO13-1(2)S  
 SHEET 7 OF 7