

**INDEX OF SHEETS**

1	TITLE SHEET
2	TYPICAL SHEET
3-5	QUANTITY SHEETS
6	ITEM DETAIL AND DRAINAGE SHEET
7	GRADE AND EARTHWORK SHEET
8-9	BLANKS
10-12	R.O.W. DETAIL SHEETS
13-14	BLANKS
15-17	PLAN AND PROFILE SHEETS
18-19	TRAFFIC SIGN AND PAVEMENT MARKING SHEETS
20-21	BLANKS
22-30	BRIDGE 100 SERIES (OVER MIDDLE BRANCH WILLIAMS RIVER)
31-34	BLANKS
35-44	PROPOSED SECTION SHEETS - MAINLINE

**STANDARDS**

A-60	SLOPES IN SOLID ROCK EXCAV. (50MPH & OVER)	04-02-84
B-3	SLOPE GRABING, EMBANKMENTS, RUCK	12-04-71
B-17	GUARD RAIL, BRIDGES, REST AREA, TURNOUTS	10-25-85 R
B-71	RESIDENTIAL AND COMMERCIAL DRIVES	07-23-80 R
B-71A	RESIDENTIAL DRIVES	03-07-90 R
C-1	CURBS, BITUMINOUS CONCRETE SIDEWALKS	10-25-85 R
D-2	C.R.H., HEADWALLS, UNDERDRAIN	10-30-85 R
D-3	TREATED CUTTERS	04-02-84
D-1	FLUJING CASINGS, END SECTION, ELBOWS	10-30-85 R
D-4	REINF. CONCRETE DROP INLET W/GRATE (DITCHES)	04-04-73
D-11	GRATES & COVERS	08-24-81 R
D-14	PRECAST CURB DI. GRATE, RCP END SECTION, ETC.	10-30-85 R
E-100	CONSTRUCTION APPROACH SIGNS	05-24-89 R
E-101	CONSTRUCTION SIGN DETAILS	10-30-87
E-102	CONSTRUCTION SIGN DETAILS	01-23-89 R
E-104	TRAFFIC CONTROL - MISCELLANEOUS DETAILS	01-23-89 R
E-107	DELIMITATION, BARRICADES AND DETOURS FOR CONSTRUCTION AREAS	01-23-89 R
E-107A	BREAKAWAY BARRICADE DETAILS	04-27-86 R
E-110	MAJOR MAINTENANCE OPERATION LANE CLOSURE	09-10-84
E-121	STANDARD SIGN PLACEMENT - CONVENTIONAL ROAD	03-01-88 R
E-131	WARNING SIGN DETAILS	10-30-87
E-140	FLANGED CHANNEL STEEL SIGN POST DETAIL	02-01-88 R
B-1	STEEL BEAM GUARDRAIL (50MPH & OVER)	10-31-85 R
B-1B	STEEL BEAM GUARDRAIL (40MPH & LFSS)	10-31-85 R
B-14	BREAKAWAY CABLE TERMINAL W/UCSD POSTS	11-01-88 R
P-1	PROJECT AND MILEPOST MARKERS	04-27-86 R
T-1	TEMPORARY EROSION CONTROL DETAILS	12-07-74 R
T-2	TEMPORARY EROSION CONTROL DETAILS	07-05-72 R
SB-R44-82	BRIDGE RAILING, GALVANIZED RIB BEAM	09-18-89 R
SB-R49-82	GUARD RAIL APPROACH SECTION, TYPE I & II	03-28-88 R

STATE OF VERMONT  
AGENCY OF TRANSPORTATION



PROPOSED IMPROVEMENT  
**TOWN OF CHESTER**  
COUNTY OF WINDSOR  
**VT. ROUTE 11 (FAP)**

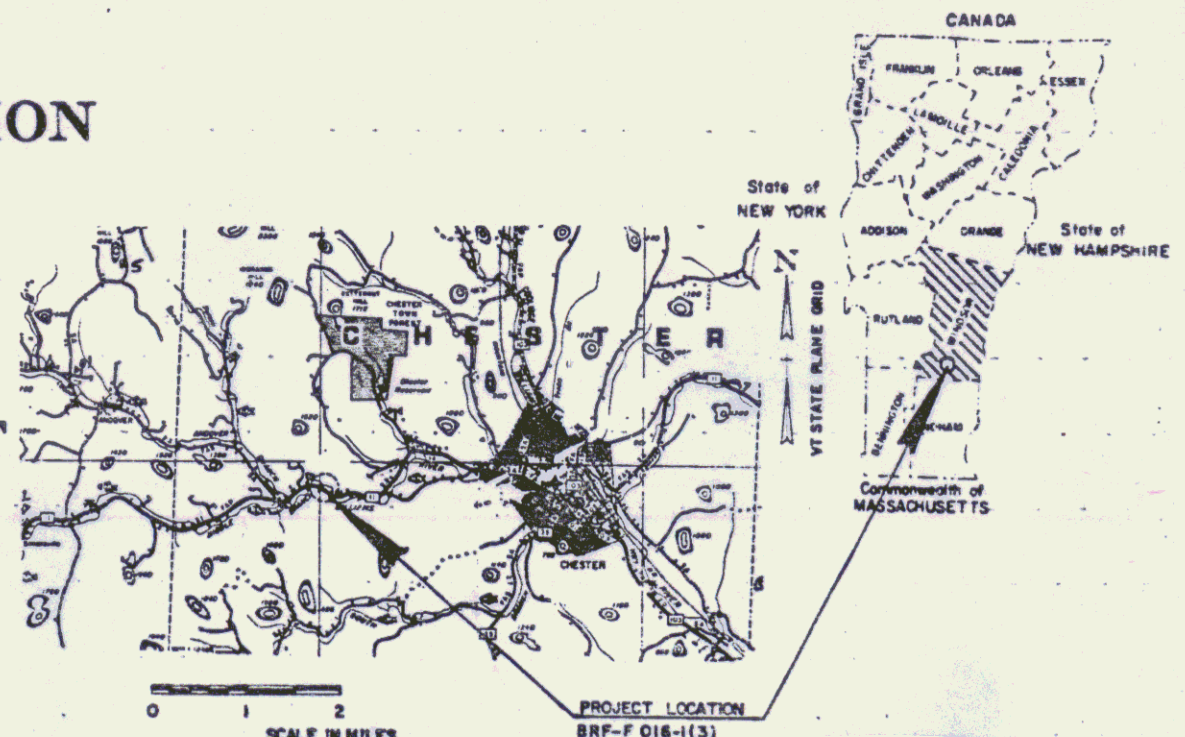

**R.O.W. PLANS**

BEGINNING AT A POINT APPROXIMATELY 2.170 MILES  
EASTERLY OF THE ANDOVER-CHESTER TOWN LINE  
AND EXTENDING WESTERLY 0.2637 MILES

LENGTH OF R.O.W. PROJ 1837.75 FEET 0.348 MILES  
LENGTH OF ROADWAY 1280.07 FEET 0.243 MILES  
LENGTH OF BRIDGE 112.68 FEET 0.021 MILES  
LENGTH OF PROJECT 1392.75 FEET 0.264 MILES

BEGIN R.O.W. PROJECT  
BRF F 016-1(3) STA. 9+00 25' LT.

END R.O.W. PROJECT  
BRF F 016-1(3) REV. STA. 27+45 40' LT.

**PROJECT DESCRIPTION**

WORK TO BE PERFORMED UNDER THIS PROJECT  
INCLUDES REMOVAL OF EXISTING BRIDGE No. 66  
AND CONSTRUCTION OF A NEW BRIDGE AND  
APPROACHES ON IMPROVED ALIGNMENT, GRADINGS,  
DRAINAGE, SUBBASE, PAVEMENT AND GUARD RAIL.

RIGHT-OF-WAY DIVISION  
TOWN FILE  
PERPETUAL  
Town of Chester VT. RTE. 11  
(To Be Returned To R.O.W. Division)

ALL DRIVES AS INDICATED ON PLANS  
ARE SUBJECT TO PERMITS PURSUANT  
TO TITLE 19 SECTION III, V.S.A.

Pn # 77B015

**CONVENTIONAL SIGNS**

COUNTY LINE	---
TOWN LINE	- - - -
LIMITS OF ACCESS	○ ○ ○ ○
POINT OF ACCESS	X
FENCE LINE	— · — · — ·
STONE WALL	— · — · — ·
TRAVELED WAY	— · — · — ·
GUARD RAIL	— · — · — ·
RAILROAD	— · — · — ·
SURVEY LINE	— · — · — ·
CULVERT	— · — · — ·
POWER POLE	○ ○ ○ ○
TELEPHONE POLE	○ ○ ○ ○
TREES	○ ○ ○ ○
CONTROL OF ACCESS	///
PROPERTY LINE	— · — · — ·
R.O.W. TAKING LINE	— · — · — ·
SLOPE RIGHTS	— · — · — ·
TOP OF CUT	— · — · — ·
TOE OF SLOPE	— · — · — ·

**DATUM**

VERTICAL	MEVD 1929
HORIZONTAL	N/A

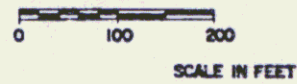

THESE PLANS ARE SUBJECT TO SUCH ENGINEERING  
CHANGES AS MAY BE REQUIRED BY THE FEDERAL HIGHWAY  
ADMINISTRATION OR THE CHIEF ENGINEER.  
CONSTRUCTION IS TO BE CARRIED ON IN ACCORDANCE  
WITH THESE PLANS AND THE STANDARD SPECIFICATIONS  
FOR CONSTRUCTION DATED 1990, AS APPROVED BY THE  
FEDERAL HIGHWAY ADMINISTRATION ON MARCH 15, 1990  
FOR USE ON THIS PROJECT, INCLUDING ALL SUBSEQUENT  
REVISIONS AND SUCH REVISED SPECIFICATIONS AND  
SPECIAL PROVISIONS AS ARE INCORPORATED IN THESE  
PLANS.

APPROVED: *Andrew C. McArthur* DATE: 03/17/94  
Dir., Dept. of Planning & Preconstruction

APPROVED: *Lauren Cummings* DATE: 03/17/94  
Chief, Property Administration

**CHESTER**  
**BRF F 016-1(3)**  
R.O.W. SHEET 1 OF 10

MAR 17 1994

SEEDING FORMULA  
RURAL AREAS

X WT.	LBS./A.	NAME	PLR %	GERM %
3.33	2	CROWN VETCH	97	75
50.00	50	CREEPING RED FESCUE	98	85
8.33	5	TIMOTHY	99	85
16.67	10	PERENNIAL RYE GRASS (VAR. PENNFINE)	95	85
8.34	5	ALFALFA (VAR. SARANAC)	99	85
8.33	5	BIRDFOOT TREFOL (VAR. EMPIRE)	98	85
5.00	3	HIGHLAND BENT GRASS	92	85
100.00	60			

THE SEED MIXTURE SHALL NOT HAVE A WEED CONTENT EXCEEDING 0.40% BY WEIGHT AND SHALL BE FREE OF ALL NOXIOUS WEED SEED.  
SEED- TO BE APPLIED PER SEEDING FORMULAS DIRECTED BY THE ENGINEER.  
FERTILIZER- FORMULA 10-20-10 TO BE USED WITH SEED, APPLIED AT THE RATE OF 500 LBS./ACRE.  
AGRICULTURAL LIMESTONE- TO BE APPLIED AT THE RATE OF 2 TONS/ACRE OR AS DIRECTED BY THE ENGINEER.  
HAY MULCH- TO BE PLACED ON EARTH SLOPES AT THE RATE OF 2 TONS/ACRE, OR AS DIRECTED BY THE ENGINEER.  
TOPSOIL- TO BE USED WITH SEED AS INDICATED ON THE PLANS, OR AS DIRECTED BY THE ENGINEER.  
MARKER POSTS- TO BE PLACED AS DIRECTED BY THE ENGINEER.  
SLOPE ROUNDING- ALL CUT SLOPES TO BE ROUNDED IN ACCORDANCE WITH STANDARD SHEET B-5.  
PAY LIMITS OF SAND BORROW WHEN USED IN CONJUNCTION WITH UNDERDRAIN- SEE STANDARD SHEET D-2.

# TYPICAL SECTIONS

2" BITUMINOUS CONCRETE PAVEMENT, TYPE II  
6" BITUMINOUS CONCRETE PAVEMENT, TYPE I (2 - 3" LIFTS)  
24" SUBBASE OF DENSE GRADED CRUSHED STONE  
14" SAND BORROW  
SHOULDERS: 2" BITUMINOUS CONCRETE PAVEMENT, TYPE II

MATERIAL ITEM	THICKNESS TOLERANCE
PAVEMENT	± 1/4"
BASE COURSE	± 1/4"
SUBBASE	± 1/2"
SAND BORROW	± 1/2"

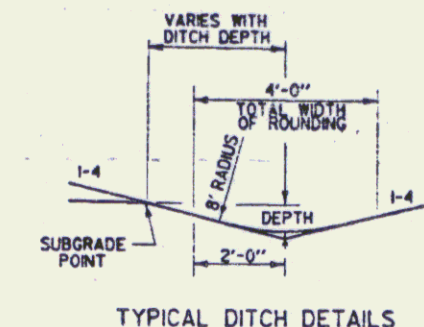
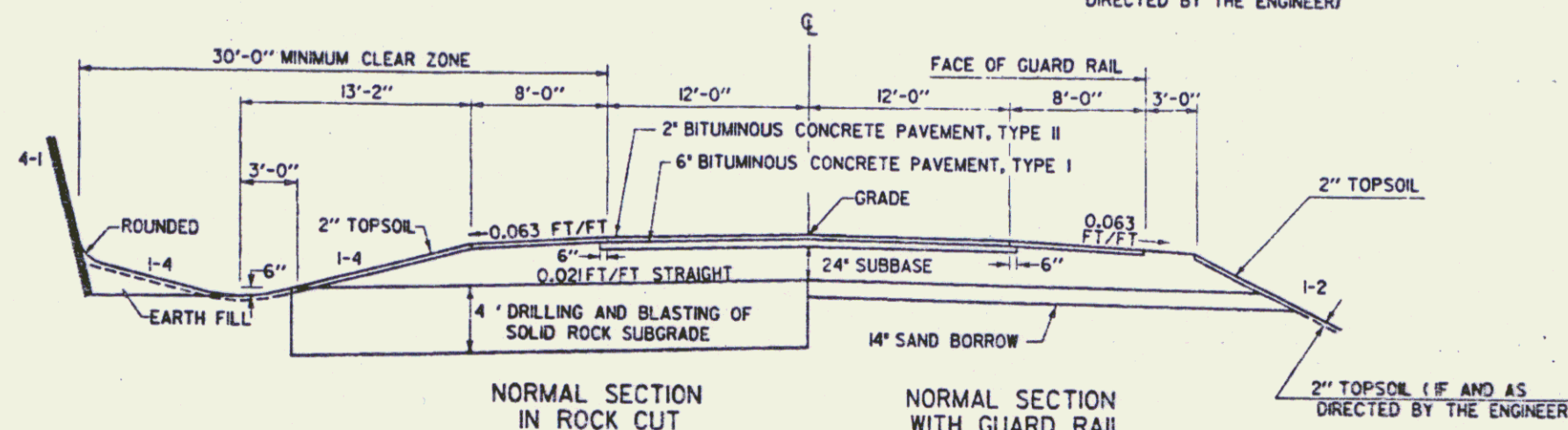
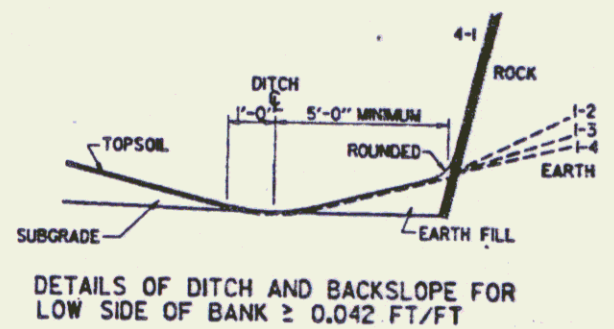
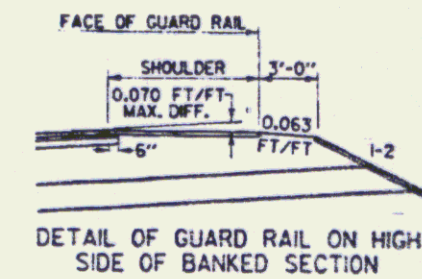
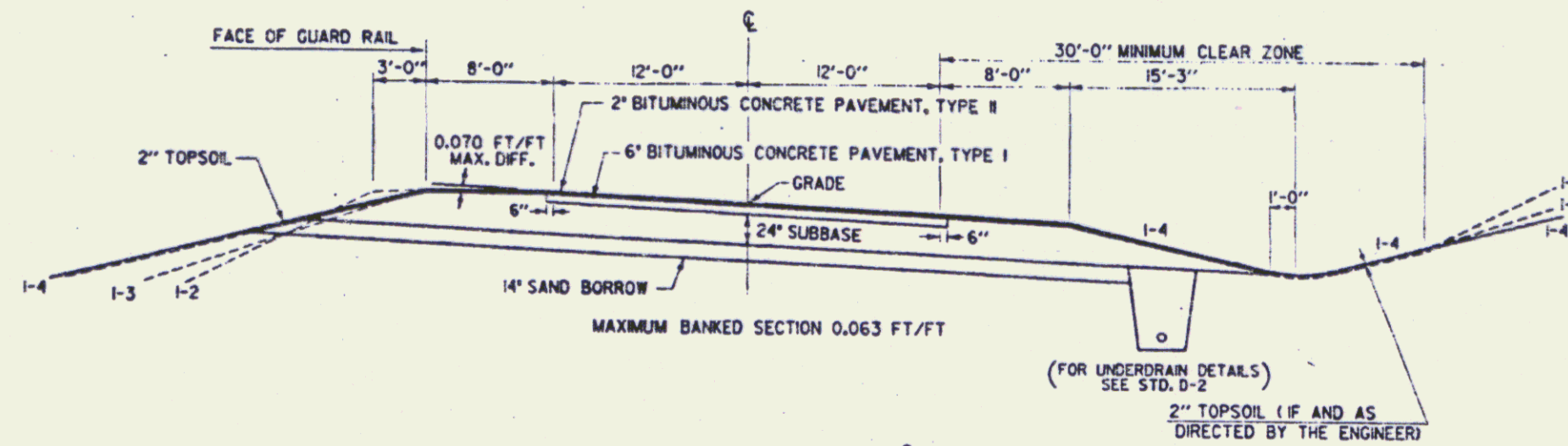
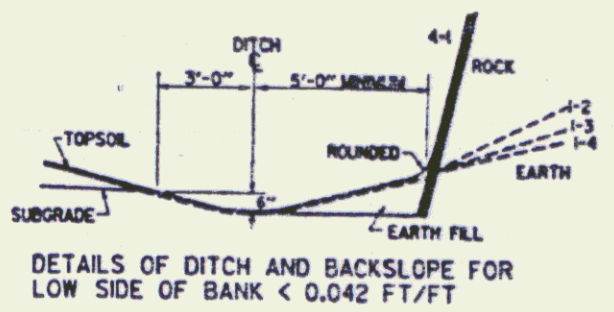
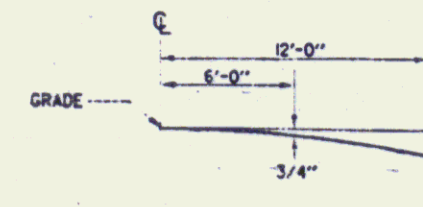
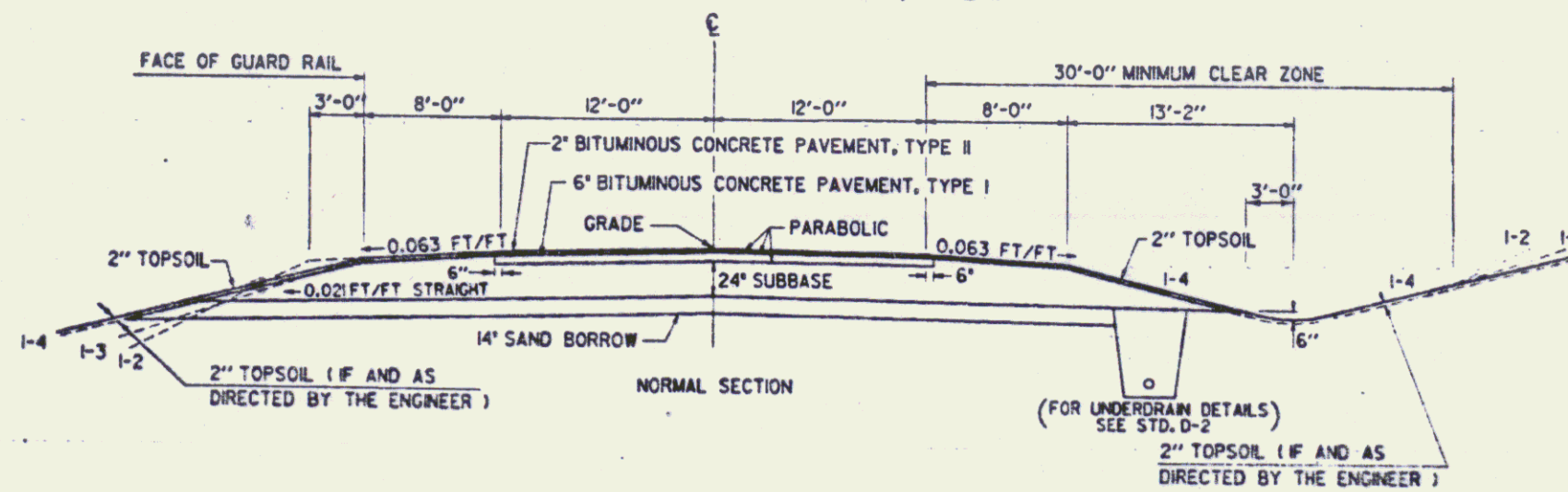

FOR SLOPES IN SOLID ROCK EXCAVATION AND DRILLING AND BLASTING OF SOLID ROCK SUBGRADE, SEE STANDARD SHEET A-60.

SURVEYED BY	LASKOWSKI	DATE	04-90
DRAWN BY	PERKINS	DATE	04-90
SQUAD LEADER			
DESIGN FILE NO.	Z00450,77377805.DGN		
FILE	77805TY1	DATE PLOTTED	13-JUN-1990
CHESTER BRF 016-1(3) R.O.W. SHEET 2 OF 10 SHEETS			

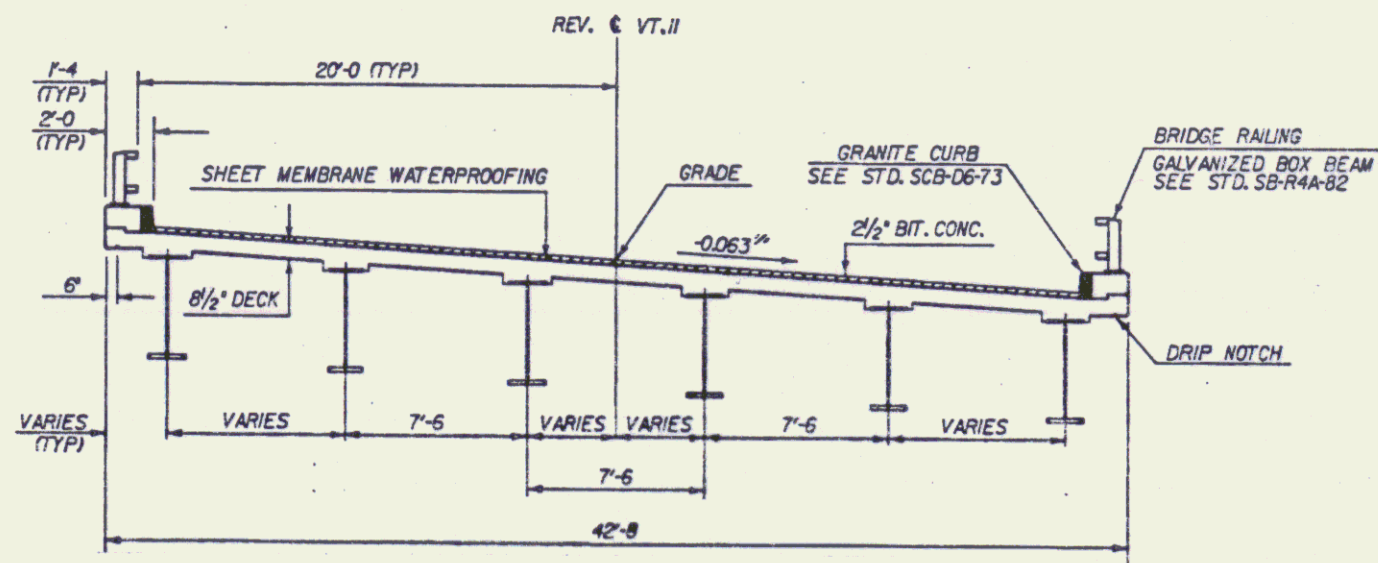

TYPICAL SECTION  
SCALE 1/4" = 1'-0"

EXISTING STRUCTURE

- STRUCTURE TYPE 3 Span Concrete T-Beam OVERALL LENGTH 125' INVENTORY RATING
- SPAN LENGTH(S) CENTER TO CENTER OF BEARINGS 28'-0" - 11'-0" - 28'-0"
- CLEAR SPAN LENGTH(S) NORMAL TO STREAM 28'-0" - 11'-0" - 28'-0"
- WATERWAY AREA OF FULL OPENING (NORMAL TO STREAM) 622 sq. ft. VERTICAL CLEARANCE ABOVE STREAMBED 12'
- WATER SURFACE ELEVATION @ Q 233 775.2 WATER SURFACE ELEVATION @ Q 100 775.6
- WATER SURFACE ELEVATION AT FLOOD OF RECORD UNKNOW YEAR 1976 ESTIMATED DISCHARGE UNKNOW
- DOES ALL WATER PASS THROUGH EXISTING STRUCTURE? YES IF NOT AT WHAT FREQUENCY AND ELEVATION DOES RELIEF OCCUR? N/A
- ADDITIONAL WATERWAY AREA PROVIDED BY RELIEF N/A
- TYPE OF SUBSTRUCTURE FOUNDATION MATERIAL GRAVEL
- DISPOSITION OF STRUCTURE REMOVE

NEW STRUCTURE

- STRUCTURE GEOMETRY
- STRUCTURE TYPE 3 Span Concrete T-Beam OVERALL LENGTH
  - SPAN LENGTH(S) CENTER TO CENTER OF BEARINGS 110'
  - VERTICAL CLEARANCE ABOVE STREAMBED OR ROAD UNDER
  - CLEAR SPAN LENGTH(S) NORMAL TO STREAM 71'
  - WATERWAY AREA OF FULL OPENING (NORMAL TO STREAM) 222 sq. ft.
  - ARE PROVISIONS TO BE MADE FOR PUBLIC UTILITIES?

HYDRAULIC DATA:

1	Q 233	1150 CFS	WATER ELEVATION	775.2	VELOCITY	6.9 FPS
2	Q 10	250 CFS	WATER ELEVATION	775.6	VELOCITY	2.6 FPS
3	Q 50	1700 CFS	WATER ELEVATION	775.8	VELOCITY	3.6 FPS
4	Q 100	2500 CFS	WATER ELEVATION	775.7	VELOCITY	10.2 FPS

- DRAINAGE AREA 212 sq. mi. CHARACTER OF TERRAIN ROLLING TO HILLY
- ARE THERE OBJECTIONS TO A PIER IN THE STREAM? NO
- DOES STREAM REACH ITS MAXIMUM HIGH WATER ELEVATION RAPIDLY? YES IS ORDINARY RISE RAPID? YES
- NATURE OF NATURAL STREAMBED GRAVEL AND Boulders
- ESTIMATED SCOUR DEPTH 2'-6" COMMENT ON DRIFT MODERATE OR ADDS
- WILL ALL WATER PASS THROUGH NEW STRUCTURE? YES IF NOT WHAT FREQUENCY AND ELEVATION WILL RELIEF OCCUR? N/A
- ADDITIONAL WATERWAY AREA PROVIDED BY RELIEF N/A
- VERTICAL CLEARANCE ABOVE Q 50 12'
- ALLOWABLE WATER SURFACE ELEVATION 776 LIMITED BY LOW FLOOD SEAT
- IS DESIGN STAGE AFFECTED BY UPSTREAM OR DOWNSTREAM CONDITIONS? NO IF YES DESCRIBE N/A
- AVERAGE DAILY LOW FLOW 250 CFS DEPTH 1.8' AVERAGE DAILY HIGH FLOW 2000 CFS DEPTH 2.5'
- STREAMBANK OR CHANNEL PROTECTION REQUIRED NO
- DISTANCE TO EXISTING UPSTREAM STRUCTURE 500' SPAN 71' WATERWAY AREA OF FULL OPENING 0
- DISTANCE TO EXISTING DOWNSTREAM STRUCTURE 500' SPAN 71' WATERWAY AREA OF FULL OPENING 0

ALLOWABLE STRESSES

- DESIGN LIVE LOAD RATING 4 E57 ON LEDGE N/A
- ALLOWABLE LOAD FOR SPREAD FOOTINGS ON SOIL 4 E57 TYPE N/A ESTIMATED LENGTH N/A
- ALLOWABLE STRESS FOR STRUCTURAL STEEL ASTM A 572 TENSION 47,000 PSI
- ALLOWABLE STRESS FOR REINFORCING STEEL GRADE 60 TENSION 47,000 PSI COMPRESSION 40,000 PSI
- ALLOWABLE STRESS FOR CONCRETE CLASS A 3,500 PSI CLASS B 3,500 PSI

- TRAFFIC MAINTENANCE
- IS TRAFFIC TO BE MAINTAINED? YES IF YES ON EXISTING STRUCTURE NO OR ON TEMPORARY BRIDGE YES
  - TEMPORARY BRIDGE REQUIREMENTS ONE OR TWO WAYS 2 TRAFFIC CONTROL SIGNALS REQUIRED 2
  - MINIMUM CLEAR SPAN 50' MINIMUM CLEAR HEIGHT 8' MINIMUM WATERWAY AREA
  - ARE SIDEWALKS REQUIRED? NO IF SO ON WHAT SIDE? N/A

\* SEE ROADWAY DESIGN DETAILS.

ADDITIONAL DESIGN CONSIDERATIONS

LOAD RATING (TONS)

STRESS LEVELS	TRUCK					
	H	HS	3S2	6 AXLE	3A STR	4A STR
INVENTORY						
POSTED						
OPERATING						

RECOMMENDED FOR APPROVAL

STRUCTURES ENGINEER DATE

RECOMMENDED FOR APPROVAL

CHIEF OF DESIGN DATE

APPROVED BY

DIRECTOR OF ENGINEERING & CONSTRUCTION DATE

STATE OF VERMONT  
AGENCY OF TRANSPORTATION

TOWN OF CHESTER Bridge No. 40

Log Sta. 15+00

HIGHWAY NO. Vt. RTE. 11 Surv. Sta. 15+00

PRELIMINARY INFORMATION

VT. 11 OVER MILLER RIVER WILLIAMS RIVER

Designed by G.V. SPILAK Drawn by D.G. WILLEY

CHESTER  
BRF FO16-1(3)  
R.O.W. SHEET 3 OF 10 SHEETS

MAR 17 1994

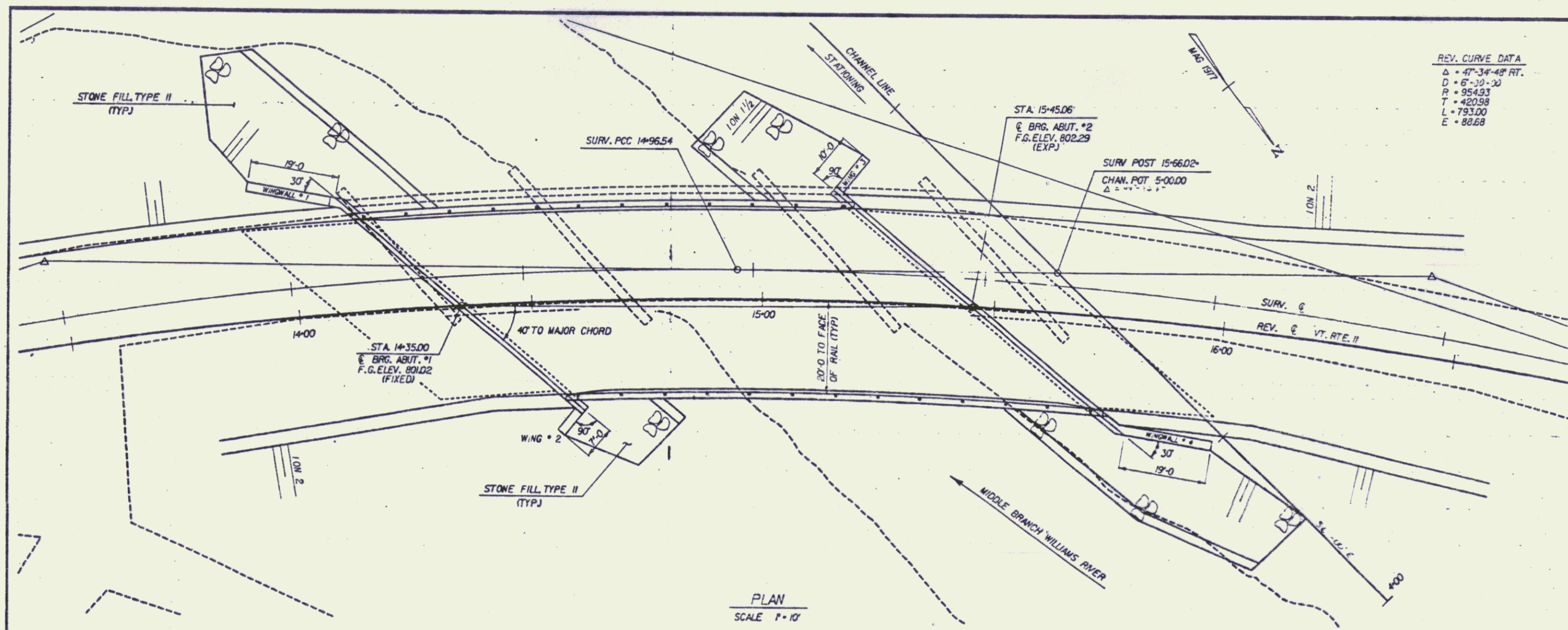

PLAN  
SCALE P-10'

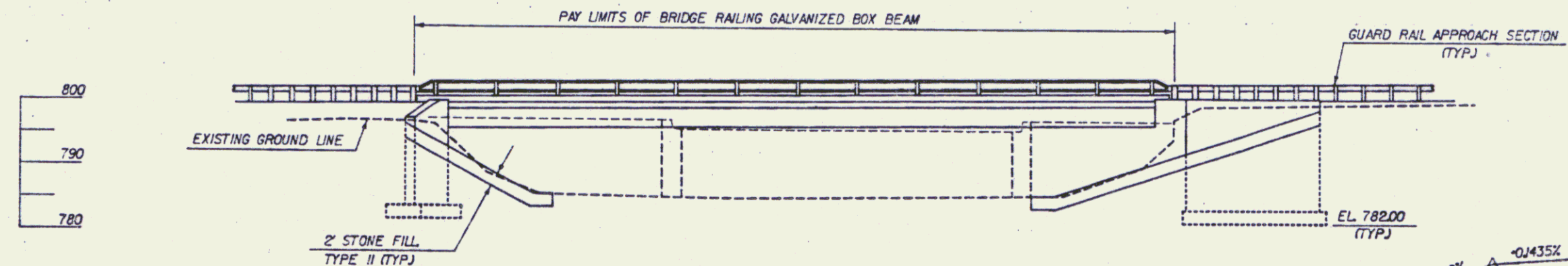

ELEVATION  
SCALE P-10'

**STATE OF VERMONT  
AGENCY OF TRANSPORTATION**

Town Of	CHESTER	Bridge No.	46
Highway No.	VT. RTE. 11	Log Sta.	
		Surv. Sta.	1500

PLAN AND ELEVATION  
VT. RTE. 11 OVER THE MIDDLE BRANCH WILLIAMS RIVER  
Designed by G.V. SPILAK Drawn by D.C. WILLEY

MAR 17 1994  
CHESTER  
BRF FO15-(13)  
R.O.W. SHEET 4 OF 10 SHEETS

BRIDGE 46 11 46

BR-6

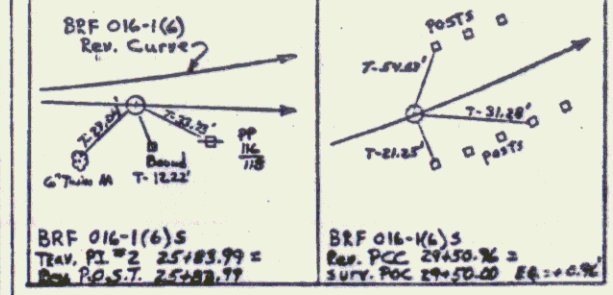
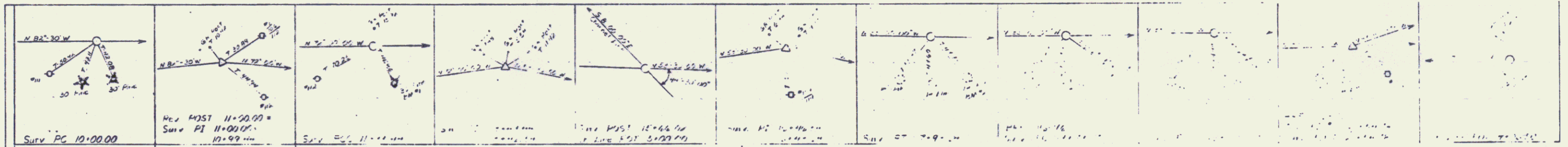

DATE	
BY	
DESIGNED	
CHECKED	
IN CHARGE	
DATE	
BY	
DATE	
BY	
DATE	
BY	
DATE	
BY	

DATE	
BY	
DATE	
BY	
DATE	
BY	
DATE	
BY	
DATE	
BY	

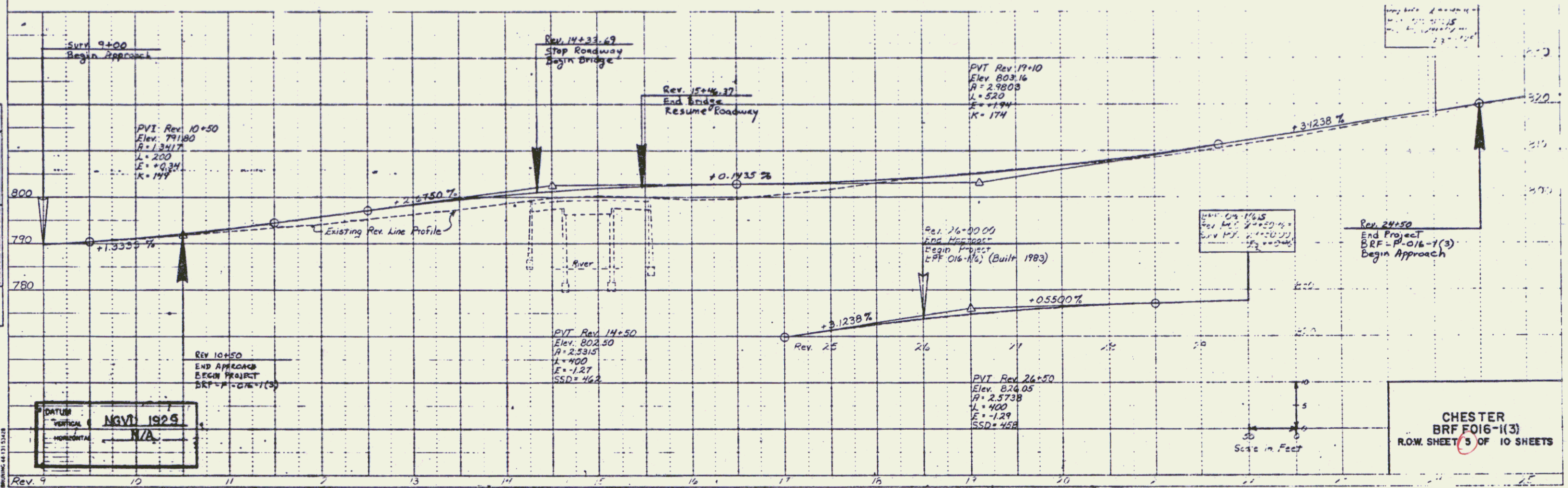

DATE	
BY	
DATE	
BY	
DATE	
BY	
DATE	
BY	
DATE	
BY	

CHESTER  
BRF 016-1(3)  
R.O.W. SHEET 3 OF 10 SHEETS

TABLE OF PROJECT PROPERTY ACQUISITION

STATE OF VERMONT  
AGENCY OF TRANSPORTATION  
RIGHT OF WAY PLANS  
DETAIL SHEET

PARCEL NO.	GRANTOR	SHEET NO.	BEGINNING STATION	ENDING STATION	TAKING	REM.	RIGHTS	TITLE TAKEN	DATE	TOWN OR CITY RECORDED	BK.	PG.	REMARKS	REVISION NO.	SHEET	DESCRIPTION OF REVISION	DATE	MADE BY	APPROVED BY
1A	MARTENS, JOHN F. & DOROTHY	9	9+00 LT. 9+00 LT. 9+20 LT.	REV. 14+60 LT. REV. 10+44 LT. REV. 10+44 LT.	0.63A±		CONST. SLOPE (T) 0.02A± (T) 0.01A±	WD	4-28-91	CHESTER	72	18-20	750 S.F.± 600 S.F.±	1	7,10	PARCEL NO. 6 CERSOSIMO. MOVE DRIVE FROM 22+00 LT. TO 20+50 LT. PER C.O. 7967.	8-29-90	M.J.R.	F.J.M.
1B		9	9+00 CL.	REV. 14+95 LT.	0.92A±		ALL R. T. & I.						VT ROUTE 11 EXISTING R.O.W.	2	6,9	PARCEL NO. 2 LYNCH. CHANGE NAME TO MURPHY, GAIL A. & MANCHO, BEVERLY. PER C.O. 7970.	9-06-90	M.J.R.	F.J.M.
1C		9	REV. 14+00 LT.	REV. 14+45 LT.	0.01A±		ALL R. T. & I.						500 S.F.± EXISTING R.O.W.	3	6,7	PARCELS 1C, 4B, 6A, 6C CHANGE PARCEL 1C ENDING STATION TO 14+45 LT.; CHANGE PARCEL 4B ENDING STATION TO 13+68 RT.; CHANGE PARCEL 6A BEGINNING STATION TO 14+45 LT.; ALSO ADD REV. 25+00 LT. - REV. 25+40 LT. - REMOVE (T) - HOUSE FOUNDATION; PARCEL 6C PL AS NOTED; RESPECTIVELY. REQUEST FROM FHWA. PER C.O. 7971.	9-12-90	C.C.P.	F.J.M.
2A	MURPHY, GAIL A. & MANCHO, BEVERLY	9	9+33 RT. 9+95 RT. REV. 10+30 RT.	REV. 10+60 RT. REV. 10+60 RT.	0.03A±	0.83A±	DRIVE SLOPE (T) 0.01A± (T) 0.01A±	WD	6-25-81	CHESTER	72	281-283	1135 S.F.± 12' GRAVEL MP 0216 60 S.F.±	4	7	PARCEL NO. 5 QUIRK. ADD INSTALL (P) FOR GUARDRAIL AT REV. 13+79 RT. - REV. 13+90 RT. ON DETAIL SHEET ONLY. PER C.O. 7982.	10-11-90	M.J.R.	F.J.M.
2B		9	9+33 RT.	REV. 10+60 RT.	0.07A±		ALL R. T. & I.						3140 S.F.± VT ROUTE 11 EXISTING R.O.W.	5	7,9	PARCEL NO. 5 QUIRK. CHANGE DESIGN OF GUARDRAIL. REMOVE THE RIGHT TO INSTALL. PER C.O. 7993.	11-01-90	M.J.R.	F.J.M.
3A	CONNOLLY, ANDREW J. & KATHERINE	9	REV. 10+60 RT. REV. 10+60 RT.	REV. 11+65 RT. REV. 11+68 RT.	0.04A±	0.65A±	SLOPE (T) 0.02A±	WD	6-8-81	CHESTER	72	358-362	1800 S.F.± 800 S.F.±	6	6,9	PARCEL NO. 3 CONNOLLY. CHANGE SPELLING OF CONNELLY TO CONNOLLY. PER C.O. 8028.	02-20-91	C.C.P.	F.J.M.
3B		9	REV. 10+60 CL.	REV. 11+63 RT.	0.06A±		ALL R. T. & I.						2525 S.F.± VT ROUTE 11 EXISTING R.O.W.	7	6	PARCEL NO. 2B MURPHY & MANCHO. CHANGE BEGINNING STATION ON DETAIL SHEET FROM 9+00 RT. TO 9+33 RT. PER C.O. 8027.	02-21-91	C.C.P.	F.J.M.
4A	MEIXMAN, DONNA C. & VAN SYCKLE, CHERYL C.	9	REV. 11+63 RT. REV. 11+65 RT. REV. 12+40 RT. REV. 12+50 RT. REV. 13+48 RT. REV. 12+85 RT. REV. 13+25 RT.	REV. 13+79 RT. REV. 12+20 RT. REV. 13+25 RT. REV. 13+55 RT. REV. 13+80 RT.	0.10A±	1.30A±	SLOPE (T) 0.01A± DRIVE (T) 0.01A± SLOPE (T) 0.01A± DRIVE (T) CUL. (P) EASE (T) 0.01A±	WD	02-25-92	CHESTER	73	124-127	350 S.F.± 12' GRAVEL MP 0221 375 S.F.± 26' GRAVEL MP 0223 TEMPORARY DETOUR 575 S.F.±	9	7,10	PARCEL NO. 6 CERSOSIMO. ADD PARCEL NO. 6E. (1.37A±). PER C.O. 8114.  <i>MyLANE to DESIGN 9-24-91</i>	09-03-91	M.J.R.	F.J.M.
4B		9	REV. 11+63 RT.	REV. 13+68 RT.	0.12A±		ALL R. T. & I.						VT ROUTE 11 EXISTING R.O.W.						

MAR 17 1994

23-2909 1805 778015

ACCT. PVR.BROOK  
ZFN(TO).37780150.DGN  
PRF1 778015DR  
DATE PLOTTED 1-APR-99

DR. (T)- DRAINAGE RIGHT  
DIT. (T)- DITCHING RIGHT  
CH. (T)- CHANNEL RT.  
DRIVE (T)- DRIVE RIGHT  
CUL. (T)- CULVERT RIGHT  
[W]- WATER SOURCES

PRESENT R.O.W.  
TAKING WITHOUT ACCESS  
TAKING WITHOUT ACCESS ALONG PROPERTY LINE  
TAKING WITH ACCESS  
PERMANENT EASEMENT  
TEMPORARY EASEMENT

LEGEND  
CONST. (T)  
SR SR CONSTRUCTION EASEMENT  
P SLOPE RIGHTS  
L PROPERTY LINE  
TOP OF CUT  
TOE OF SLOPE

APPROVED: LAWRENCE B. JESS, L.S. DATE: 08-27-90  
AGENT D. PLANS & TITLES

R.O.W. PLANS  
CHESTER  
BRF F016-1(3)  
SHEET 6 OF 10

**STATE OF VERMONT  
AGENCY OF TRANSPORTATION  
TABLE OF PROJECT PROPERTY ACQUISITION  
RIGHT OF WAY PLANS  
DETAIL SHEET**

PARCEL NO.	GRANTOR	SHEET NO.	BEGINNING STATION	ENDING STATION	TAKING	REM.	RIGHTS	TITLE TAKEN	DATE	TOWN OR CITY RECORDED	BK.	PG.	REMARKS	REVISION NO.	SHEET	DESCRIPTION OF REVISION	DATE	MADE BY	APPROVED BY	
5A	QUIRK, MARGARET M.	9	REV. 13+68 RT. REV. 13+79 RT. REV. 13+79 RT. REV. 13+79 RT. REV. 15+25 RT.	REV. 15+46 RT. REV. 15+46 RT. REV. 13+85 RT. REV. 16+00 RT. REV. 16+10 RT.	0.06a±	0.97a±	SLOPE (T) 0.01a± EASE (T) 0.05a± CHANNEL (P) 0.05a±	MO	10-9-81	CHESTER	72	429-432	2510 S.F.± 30 S.F.± TEMPORARY DETOUR 2300 S.F.± 2030 S.F.±							
5B		9	REV. 13+68 LT.	REV. 15+40 RT.	0.11a±								VT ROUTE 11 EXISTING R.O.W.							
6A	CERSOSIMO, ANTHONY F.	9,10	REV. 14+45 LT. REV. 15+10 LT. REV. 16+70 LT. REV. 19+50 LT. REV. 22+95 LT. REV. 25+00 LT. REV. 25+40 LT. REV. 25+62 LT.	REV. 26+00 LT. REV. 27+45 LT. REV. 22+50 LT. REV. 27+27 LT. REV. 25+40 LT. REV. 25+40 LT. REV. 26+00 LT.	0.43a±		CONST. (T) 0.27a± SLOPE (T) 0.06a± DRIVE (T) SLOPE (T) 0.18a± ALL R. T. & L. REMOVE (T) ALL R. T. & L. DRIVE (T)	MO	11-21-81	CHESTER	73	15-18	2500 S.F.± 16' GRAVEL HP 0234 HOUSE FOUNDATION HOUSE FOUNDATION SEPTIC SYSTEM 24" GRAVEL HP 0246							
6B		9,10	REV. 15+40 RT.	REV. 25+00 RT.	1.73a±															
6C		9,10	REV. 14+60 LT.	REV. 23+20 RT.	1.01a±		ALL R. T. & L.						VT ROUTE 11 EXISTING R.O.W.							
6D		9	REV. 14+18 LT.	REV. 14+60 LT.	0.01a±		ALL R. T. & L.						450 S.F.± EXISTING R.O.W.							
6E		10	REV. 25+00 RT.	30+18 RT.	1.37a±	0.00a±														

MAR 17 1994

23-2508 1805 778015  
ACCT. PMLBROOK  
ZFH170/31778050.DGN  
PRF: 7780502R  
DATE PLOTTED 28-MAR-99

DR. (T)- DRAINAGE RIGHT  
DIT. (T)- DITCHING RIGHT  
CH. (T)- CHANNEL RT.  
DRIVE (T)- DRIVE RIGHT  
CUL. (T)- CULVERT RIGHT  
[W]- WATER SOURCES

PRESENT R.O.W.  
TAKING WITHOUT ACCESS  
TAKING WITHOUT ACCESS ALONG PROPERTY LINE  
TAKING WITH ACCESS  
PERMANENT EASEMENT  
TEMPORARY EASEMENT

LEGEND  
CONST. (T)  
SR SR  
P  
L  
TOP OF CUT  
TOE OF SLOPE

CONSTRUCTION EASEMENT  
SLOPE RIGHTS  
PROPERTY LINE

APPROVED: LAWRENCE B. ISS, L.S. DATE: 08-27-90  
AGENT D. PLANS & TITLES

R. O. W. PLANS

CHESTER  
BRF F016-1(3)  
SHEET 7 OF 10

**TABLE OF PROJECT PROPERTY ACQUISITION**

**STATE OF VERMONT  
AGENCY OF TRANSPORTATION  
RIGHT OF WAY PLANS  
DETAIL SHEET**

PARCEL NO.	GRANTOR	SHEET NO.	BEGINNING STATION	ENDING STATION	TAKING	REL.	RIGHTS	TITLE TAKEN	DATE	TOWN OR CITY RECORDED	BK.	PG.	REMARKS	REVISION NO.	SHEET	DESCRIPTION OF REVISION	DATE	MADE BY	APPROVED BY	
7	CENTRAL VERMONT PUBLIC SERVICE CORP.												UTILITY							
8	CONTINENTAL TELEPHONE CO.												UTILITY							

MAR 17 1994

ACCT. PHILBROOK  
ZFM\703\3778060.DGN  
PWF: 7780503R  
DATE PLOTTED 3-AUG-89

DR. (T)- DRAINAGE RIGHT  
DIT. (T)- DITCHING RIGHT  
CH. (T)- CHANNEL RT.  
DRIVE (T)- DRIVE RIGHT  
CUL. (T)- CULVERT RIGHT  
[W]- WATER SOURCES

PRESENT R.O.W.  
TAKING WITHOUT ACCESS  
TAKING WITHOUT ACCESS ALONG PROPERTY LINE  
TAKING WITH ACCESS  
PERMANENT EASEMENT  
TEMPORARY EASEMENT

LEGEND

CONST. (T) CONSTRUCTION EASEMENT  
SR SLOPE RIGHTS  
P PROPERTY LINE  
L TOP OF CUT  
O TOE OF SLOPE

APPROVED: \_\_\_\_\_ DATE: \_\_\_\_\_  
AGENT D. PLANS & TITLES

R. O. W. PLANS

CHESTER  
BRF F016-1(3)  
SHEET (8) OF 10



STEEL BEAM GUARD RAIL  
REV 19+99 - REV 23+99 RT

CONSTRUCT DRIVES  
REV 19+50 LT (GRAVEL-16' WIDE)  
REV 24+45 RT (GRAVEL-12' WIDE)  
REV 25+62 LT (GRAVEL-24' WIDE)

BREAKAWAY CABLE TERMINAL  
REV 19+74 RT - REV 19+99 RT  
REV 23+99 RT - REV 24+24 LT

STONE FILL TYPE II  
REV 20+84 RT - REV 23+95 RT

UNCLASSIFIED CHANNEL EXCAVATION  
REV 20+64 RT - REV 23+95 RT

CONSTRUCT TURNOUT  
REV 19+00 - REV 20+00 RT  
(See Std. B-17 for Details)

END R.O.W. PROJECT  
BRF FO16-1(3) REV. STA. 27+45 40' LT.

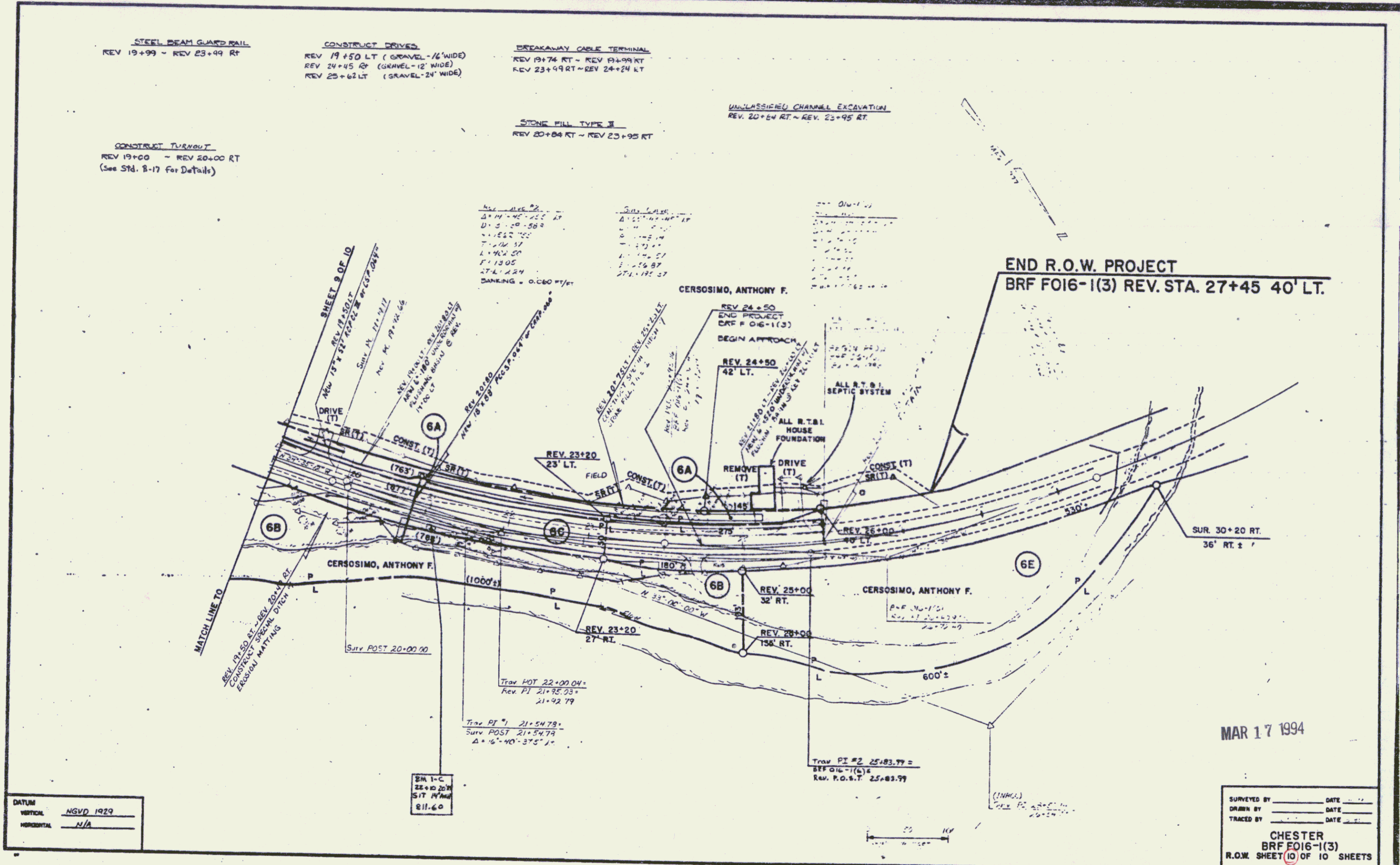

DATUM	NGVD 1929
VERTICAL	N/A
HORIZONTAL	N/A

BM 1-C
22+00.00
SIT W/IND
811.60

SURVEYED BY	DATE
DRAWN BY	DATE
TRACED BY	DATE
CHESTER	
BRF FO16-1(3)	
R.O.W. SHEET 10 OF 10 SHEETS	