

STEEL BEAM GUARD RAIL
REV 19+99 - REV 23+99 RT

CONSTRUCT DRIVES
REV 19+50 LT (GRAVEL-16' WIDE)
REV 24+45 RT (GRAVEL-12' WIDE)
REV 25+62 LT (GRAVEL-24' WIDE)

BREAKAWAY CABLE TERMINAL
REV 19+74 RT - REV 19+99 RT
REV 23+99 RT - REV 24+24 LT

STONE FILL TYPE II
REV 20+84 RT - REV 23+95 RT

UNCLASSIFIED CHANNEL EXCAVATION
REV 20+64 RT - REV 23+95 RT

CONSTRUCT TURNOUT
REV 19+00 - REV 20+00 RT
(See Std. B-17 for Details)

END R.O.W. PROJECT
BRF FO16-1(3) REV. STA. 27+45 40' LT.

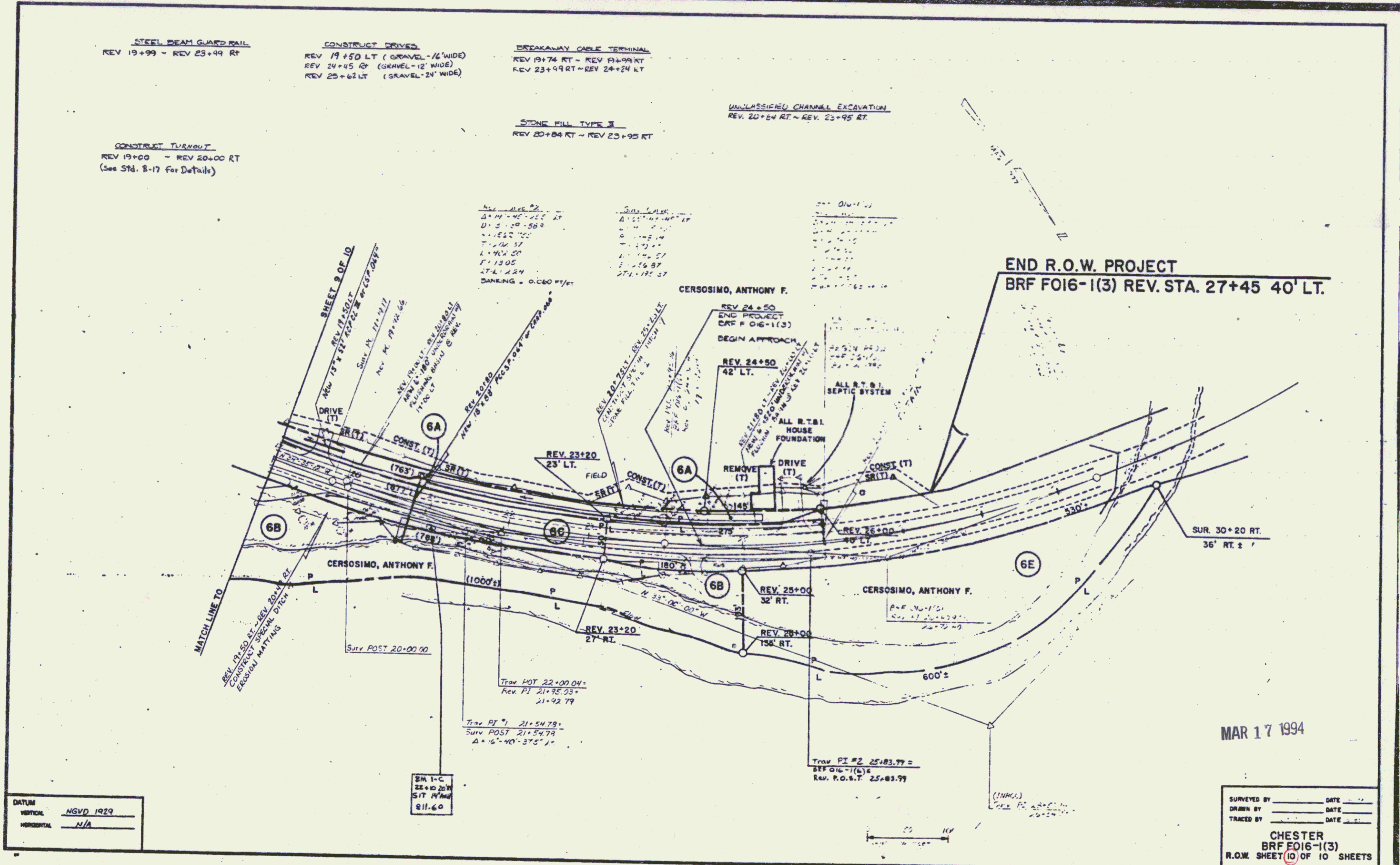

MAR 17 1994

DATUM
VERTICAL NGVD 1929
HORIZONTAL N/A

BM 1-C
22+00.00
SIT W/ROAD
811.60

SURVEYED BY	DATE
DRAWN BY	DATE
TRACED BY	DATE

CHESTER
BRF FO16-1(3)
R.O.W. SHEET 10 OF 10 SHEETS