

INDEX OF SHEETS

SHEET No.	DESCRIPTION
1	TITLE SHEET
2	TYPICAL SHEET
3-4	ITEM QUANTITY DRAINAGE SHEETS
5-6	EARTHWORK & GRADE SHEETS
7-12	PLAN & PROFILE SHEETS
13-15	PRELIMINARY BRIDGE SHEETS
16-23	MAINLINE CROSS SECTIONS
34	APPROACH TO OLD V-15 CROSS SECTIONS
35-37	TOWN HIGHWAY 14 CROSS SECTIONS
38-42	CHANNEL CROSS SECTIONS @ ML 27100
43-52	CHANNEL CROSS SECTIONS @ ML 262171.45

STATE OF VERMONT
AGENCY OF TRANSPORTATION



PROPOSED IMPROVEMENT
TOWN OF WOLCOTT
COUNTY OF LAMOILLE
VT. RTE. 15
HARDWICK - MORRISVILLE
ROAD

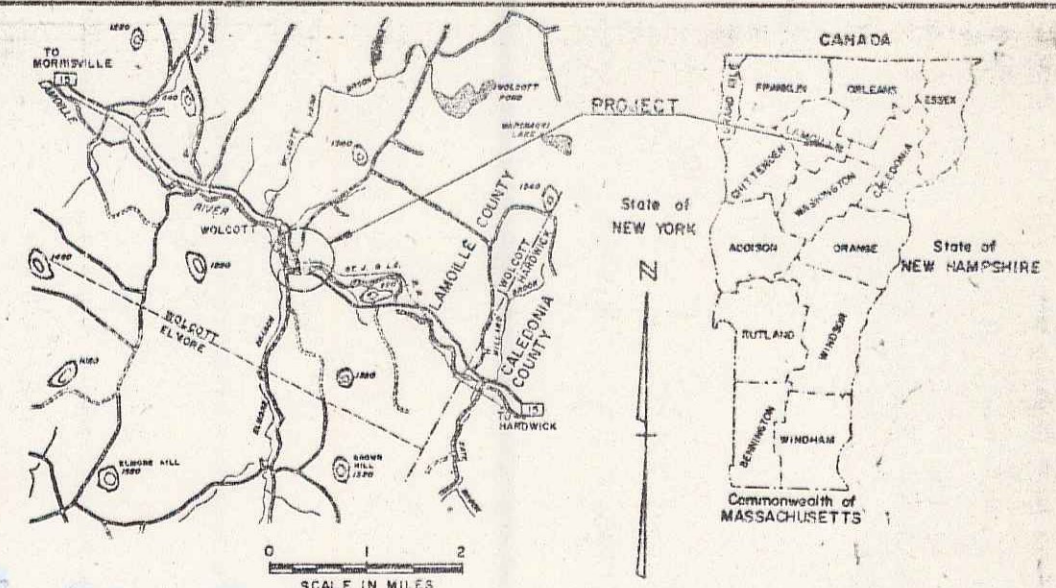

R.O.W. PLANS

BEGIN R.O.W. PROJECT FG-F-BRF 030-2(4)
STA. 250+00 CL

BEGINNING AT A POINT APPROXIMATELY 1.931 MILES
WESTERLY OF THE HARDWICK-WOLCOTT TOWN LINE
AND EXTENDING 0.532 MILES WESTERLY.

LENGTH OF ROADWAY 2588.56 FEET = 0.490 MILES
LENGTH OF BRIDGE 221.50 FEET = 0.42 MILES
LENGTH OF PROJECT 2810.06 FEET = 0.532 MILES
LENGTH OF R.O.W. PROJECT 3060.66 FEET = 0.580 MILES
1978 AADT = 2310
1998 AADT = 3290
1998 DIVV = 495
D = 52%
T = 6%
V = 40 MPH

END R.O.W. PROJECT FG-F-BRF 030-2(4)
STA. 280+50 CL

CONVENTIONAL SIGNS

COUNTY LINE	---
TOWN LINE	---
LIMITS OF ACCESS	---
POINT OF ACCESS	X
FENCE LINE	---
STONE WALL	---
TRAVELED WAY	---
GUARD RAIL	---
RAILROAD	---
SURVEY LINE	---
SULVERT	---
WATER POLE	○
TELEPHONE POLE	○
TREES	○
CONTROL OF ACCESS	---
PROPERTY LINE	---
R.O.W. TAKING LINE	---
SLOPE RIGHTS	---
TOP OF CUT	---
TOE OF SLOPE	---

DATUM

VERTICAL	---
HORIZONTAL	---

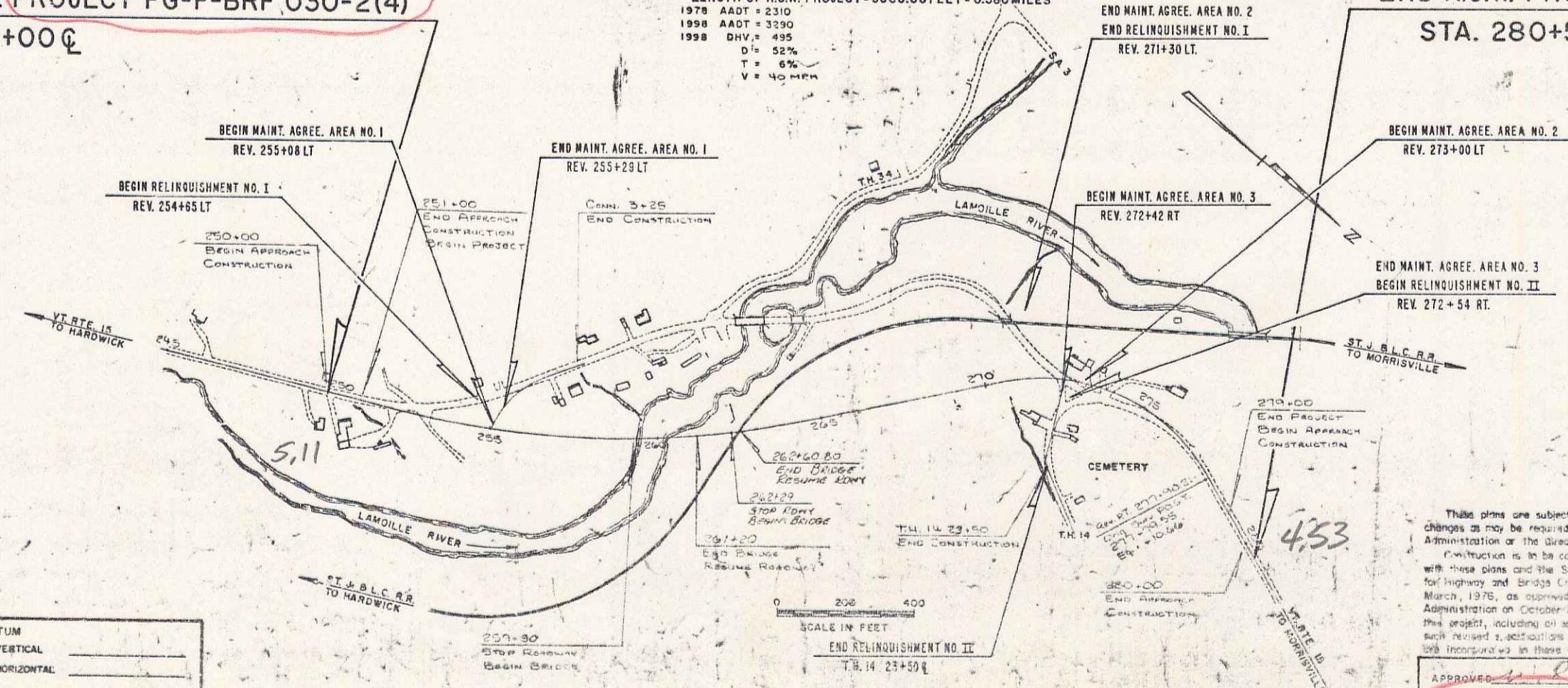

MM0446-0510⁵³

This plan is subject to such engineering changes as may be required by the Federal Highway Administration or the Director of Engineering and Construction. Construction is to be carried on in accordance with these plans and the Standard Specifications for Highway and Bridge Construction dated March, 1976, as approved by the Federal Highway Administration on October 27, 1976 for use on this project, including all subsequent revisions and such revised specifications and special provisions as are incorporated in these plans.

Pin# 77A003

APPROVED: [Signature] DATE 1/23/80
DIRECTOR OF ENGINEERING AND CONSTRUCTION

AGENCY OF TRANSPORTATION
FEDERAL HIGHWAY ADMINISTRATION

APPROVED: [Signature] DATE 1/23/80
DIVISION ADMINISTRATOR

PROJECT: FG-F-BRF 030-2(4)
SHEET 1 OF 12 SHEETS

SCALE IN FEET
0 200 400
END RELINQUISHMENT NO. II
T.H. 14 23+50 CL