

INDEX OF SHEETS

1.	Title Sheet	
2.	Typical Sheet	
3.	Summary of Quantities and Drainage	
4.	Earthwork	
5-6.	Plan and Profile	
7-9.	R.O.V. Detail Sheets	
10-12.	Blank	
13.	A-60 Solid Rock Excavation	4-20-73 F
14.	B-1 Banking Tables	12-4-71
15.	B-5 Typical Slope Rounding	12-4-71
16.	D-11 Use of Underdrain with Shattered Rock Subgrade	12-12-74 F
17.	B-71 Drives	8-23-73 F
18.	D-2 Headwalls and Underdrain	2-8-72 R
19.	D-4 Underdrain Flushing Basin And Metal End Section	7-26-75 R
20.	D-6 Drop Inlets in Ditches	4-4-73
21.	D-8 Drop Inlet with Precast Cover	12-4-71
22.	D-16 Grates, Energy Dissipator and PRCOI	11-18-72 R
23.	E-2 Road Construction Approach Signs	5-19-74 R
24.	E-6 On Project Construction Signs	5-19-74 R
25.	E-7 delineation and Precast for Construction Areas	9-19-73 F
26.	G-4 Guard Rail, Plank with Wood Posts	5-23-74 R
27.	G-6 Guard Rail and Anchors	5-23-74 R
28.	C-1 Treated Timber Curb	8-30-73 R
29.	J-1 Boundary Markers	12-4-71
30.	T-1 Temporary Erosion Control Details	6-14-73 R
31.	T-2 Temporary Erosion Control Details	7-5-72
32-41.	Cross Sections	

RECORD PLANS-MATERIALS
MARLBORO TQF 010-1 (10)
CONTRATOR-CALLANAN INDUSTRIES INC., SOUTH BETHLEHEM, N.Y.
CONTRACT DATED-4 NOVEMBER 1976
CONSTRUCTION BEGAN-11 APRIL 1977
CONSTRUCTION COMPLETED-24 AUGUST 1977
CONSTRUCTION ACCEPTED-29 AUGUST 1977
RESIDENT ENGINEER-PAUL J. JETTE
RECORD PLANS - S. MURRAY

STATE OF VERMONT
DEPARTMENT OF HIGHWAYS



PROPOSED IMPROVEMENT
TOWN OF MARLBORO
COUNTY OF WINDHAM
BRATTLEBORO-BENNINGTON ROAD VT. RTE. 9

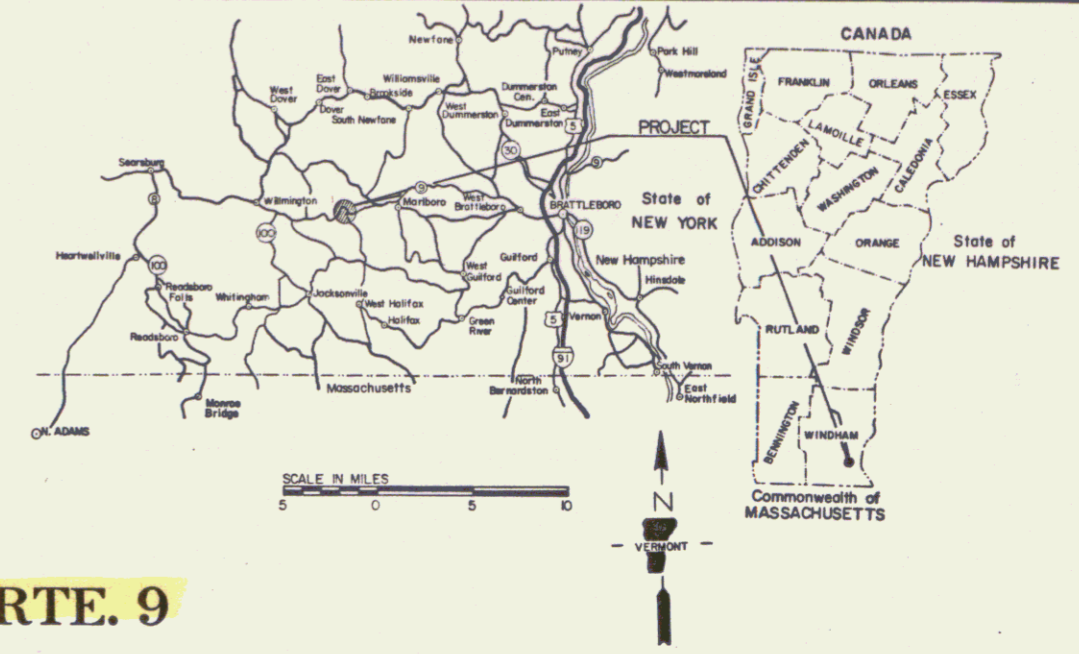

NOTE: ANY FURTHER INFORMATION CONCERNING FINAL QUANTITIES, AMOUNTS OR OTHER DETAILS RELATIVE TO THIS PROJECT MAY BE FOUND IN EITHER THE FIELD BOOKS OR THE ESTIMATE FILE.

BEGINNING AT A POINT APPROXIMATELY 0.273 MILES WESTERLY OF T.H.#1 CLASS II INTERSECTION AND EXTENDING WESTERLY 0.294 MILES.
 LENGTH OF ROADWAY 1550 FEET = 0.294 MILES
 LENGTH OF PROJECT 1550 FEET = 0.294 MILES

1976	AADT	3100
1981	AADT	3720 (Est)
1981	DHV	630 (Est)
1986	AADT	4245 (Est)
1986	DHV	700 (Est)
	D	62%
	T	8%
	V	40 MPH
5 YEAR ACCIDENTS 1971-1975		18

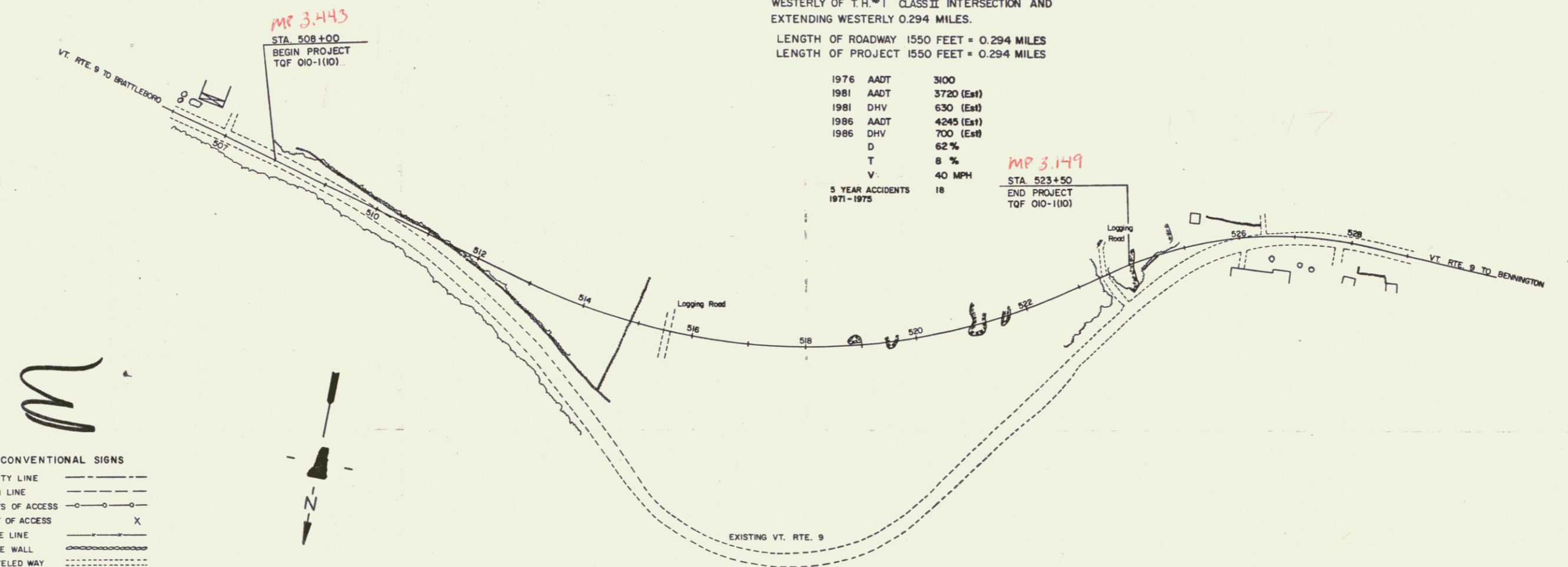

CONVENTIONAL SIGNS

COUNTY LINE	---
TOWN LINE	- - - -
LIMITS OF ACCESS	○
POINT OF ACCESS	X
FENCE LINE	— · — · —
STONE WALL	— · — · —
TRAVELED WAY	— · — · —
GUARD RAIL	— · — · —
RAILROAD	— · — · —
SURVEY LINE	— · — · —
CULVERT	— · — · —
POWER POLE	— · — · —
TELEPHONE POLE	— · — · —
EES	— · — · —
A CONST. IDENTIFICATION SIGNS	— · — · —
PROPERTY LINE	— · — · —
R.O.W. TAKING LINE	— · — · —
SLOPE RIGHTS	— · — · —
TOP OF CUT	— · — · —
TOE OF SLOPE	— · — · —

TREATED TIMBER CURB, BOUNDARY MARKERS, STEEL MARKER POSTS, GUARD RAIL, ANCHORS FOR GUARD RAIL, SEED, FERTILIZER, AGRICULTURAL LIMESTONE, HAY MULCH - LAFAYETTE-SHELDON INC., ESSEX JCT., VT.
 ACCGMP, CGMP, MES, UNDERDRAIN, CARRIER PIPE, FLUSHING BASINS - LANE METAL PRODUCTS CO., BALLISTON, N.Y. PRECAST DI'S WITH CAST IRON GRATES - E.L. LEBARRON FOUNDRY CO., BROCKTON, MASSACHUSETTS
 SAND BORROW, GRANULAR BORROW, GRANULAR BACKFILL FOR STRUCTURES, SUBBASE OF GRAVEL - FLETCHER PIT, BRATTLEBORO, VT.
 PLANT MIX BASE COURSE, BITUMINOUS CONCRETE PAVEMENT, - W.E. DAILEY, SHAFSTSBURY, VT. CONCRETE, CEMENT RUBBLE MASONRY - BRATTLEBORO SAND & GRAVEL CO., BRATTLEBORO, VT.
 EARTH BORROW - ADAMS PIT, MARLBORO, VT. BITUMINOUS SURFACE TREATMENT - HOOSIC VALLEY ASPHALT CO. INC., VALLEY FALLS, N.Y. RCP - HUME PIPE CORP., WINDSOR, VT.
 REINFORCING STEEL - PIONEER VALLEY STEEL CO. INC., GREENFIELD, MASS. CALCIUM CHLORIDE - CALLANAN INDUSTRIES INC., SOUTH BETHLEHEM, N.Y.



Pin # 769160
 FEB 29 1980

MARLBORO

SUBMITTED BY ORDER OF THE STATE HIGHWAY BOARD

APPROVED *E.H. Stebbins* DATE 8-30-76
 CHIEF ENGINEER

DEPARTMENT OF TRANSPORTATION
 FEDERAL HIGHWAY ADMINISTRATION

APPROVED _____ DATE _____
 DIVISION ENGINEER

PROJECT TQF No 010-1 (10)

SHEET 1 OF 4 SHEETS

D-10 SRS 12/17/70