

INDEX OF SHEETS

STATE OF VERMONT AGENCY OF TRANSPORTATION



R.O.W. PLANS

PROPOSED IMPROVEMENT TOWN OF NEW HAVEN COUNTY OF ADDISON

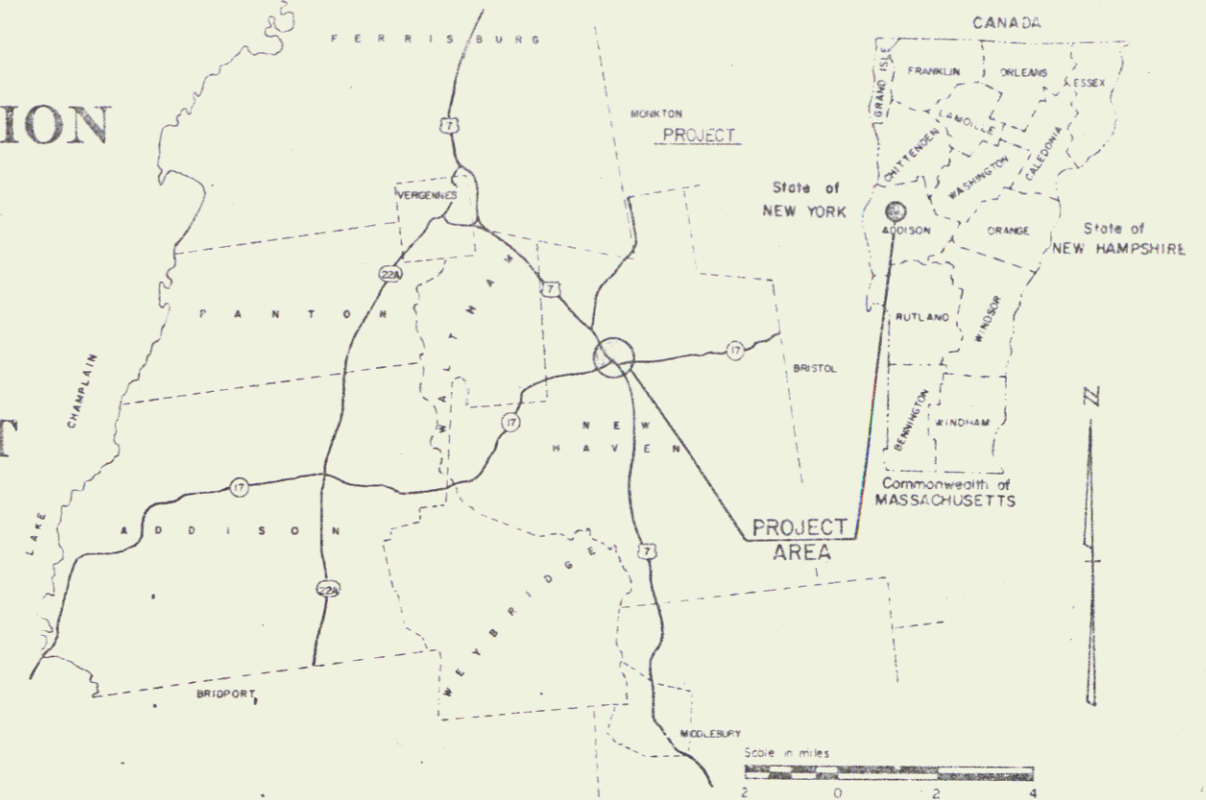

**RIGHT-OF-WAY DIVISION
E O W N F I L E**
PERPETUAL
*Town of New Haven
(To Be Returned To R.O.W. Division)
MP 5.30 to 6.19*

BEGIN R.O.W. PROJECT
HHS 019-3(16) STA. 279+00

BEGINNING AT A POINT APPROXIMATELY 5.284 MILES NORTHERLY OF THE MIDDLEBURY - NEW HAVEN TOWN LINE AND EXTENDING IN NORTHERLY DIRECTION 0.890 MILES.

LENGTH OF ROADWAY	4628 FEET	0.876 MILES
LENGTH OF BRIDGE	20 FEET	0.004 MILES
LENGTH OF RAILROAD	52 FEET	0.010 MILES
LENGTH OF PROJECT	4,700 FEET	0.890 MILES
LENGTH OF ROW PROJECT	5,015 FEET	0.950 MILES



CONVENTIONAL SIGNS

COUNTY LINE	—+—+—+—+—
TOWN LINE	—+—+—+—+—
LIMITS OF ACCESS	—+—+—+—+—
POINT OF ACCESS	X
FENCE LINE	—+—+—+—+—
STONE WALL	—+—+—+—+—
TRAVELED WAY	—+—+—+—+—
GUARD RAIL	—+—+—+—+—
RAILROAD	—+—+—+—+—
SURVEY LINE	—+—+—+—+—
CULVERT	—+—+—+—+—
POWER POLE	—+—+—+—+—
TELEPHONE POLE	—+—+—+—+—
TREES	—+—+—+—+—
CONTROL OF ACCESS	—+—+—+—+—
PROPERTY LINE	—+—+—+—+—
R.O.W. TAKING LINE	—+—+—+—+—
SLOPE RIGHTS	—+—+—+—+—
TOP OF CUT	—+—+—+—+—
TOE OF SLOPE	—+—+—+—+—

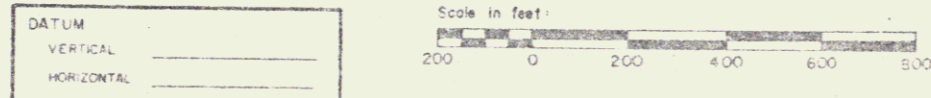

TRAFFIC DATA

1979 ADT	3840	VPD	57
1989 ADT	4630	VPD	69
1989 DHV	615	VPH	92

D = 5.5%
T = 6%
V = 50 MPH

US 7 ACCIDENTS
1972-1
1973-7
1974-6
1975-5
1976-3
VT 17 ACCIDENTS
1972-2 (E & W)

These plans are subject to such engineering changes as may be required by the Federal Highway Admin. or the Director of Engineering and Const. Construction is to be carried on in accordance with these plans and the Standard Specifications for Highway and Bridge Construction dated March, 1976, as approved by the Federal Highway Administration on October 27, 1976 for use on this project, including all subsequent revisions and such revised specifications and special provisions as are incorporated in these plans.

Approved: *[Signature]*
Chief, Property Administration
Date: 11-1-78

Rte. US 7

SUBMITTED BY ORDER OF THE STATE TRANSPORTATION BOARD
APPROVED: *[Signature]* DATE: 11-1-78
DIRECTOR OF ENGINEERING AND CONSTRUCTION
DEPARTMENT OF TRANSPORTATION
FEDERAL HIGHWAY ADMINISTRATION

PROJECT HHS 019-3(16)
SHEET 1 OF 14 SHEETS
SRS 01/79

P.O.# 76G147

STATE OF VERMONT
DEPARTMENT OF HIGHWAYS
RIGHT-OF-WAY PLANS
DETAIL SHEET

TABLE OF PROJECT PROPERTY ACQUISITION

PARCEL NO.	GRANTOR	SHEET NO.	BEGINNING STATION	ENDING STATION	TAKING	REM.	RIGHTS	TITLE TAKEN	DATE	TOWN OR CITY RECORDED	BK.	PG.	REMARKS
1	MONTY, PETER A. & VERONICA M.	10	280+03 RT.	282+32 RT.	0.21 A±		ALL R. T. & L. SLOPE (T) (130 S.F.±) DRIVE (T)	W.D.		NEW HAVEN			HWY. CASE, U.S. 7 DRIVE 40' PAVED M.P. 0531 DRIVE PERMIT DATE DRIVE 30' PAVED M.P. 0349 DRIVE PERMIT DATE PUMP ISLAND - REMOVE NO. 4 SIGN
			281+70 RT.	281+95 RT.									
			280+38 RT.										
			VI. RT. I7E 183+60 RT.	281+50 RT.									
2A	BESAW, KEITH R. & CAROLYN C.	10	286+23 LT.	287+37 LT.	0.14 A±		ALL R. T. & L. SLOPE (T) (250 S.F.±) SLOPE (T) (25 S.F.±) DRIVE (T)	W.D.		NEW HAVEN			HWY. EASE, U.S. 7 DRIVE 40', PAVED M.P. 0535 DRIVE PERMIT DATE DRIVE 40', PAVED M.P. 0537 DRIVE PERMIT DATE (2100 S.F.±) (1500 S.F.±)
			283+70 LT.										
			283+70 LT.	286+23 LT.									
			285+75 LT.	286+23 LT.									
					TOTAL	0.77 A±							
3	MORSE, CECIL & RAMONA P.	10	282+32 RT.	285+69 RT.	0.38 A±		ALL R. T. & L. SLOPE (T) (0.03 A±) DRAINAGE (P)	W.D.	5-6-83	NEW HAVEN	40	539-40	HWY. EASE U.S. 7 DRIVE 24' PAVED M.P. 0539 DRIVE PERMIT DATE DRIVE 40' PAVED M.P. 0540 DRIVE PERMIT DATE SIGN SIGN POST SIGN CELLAR DRAIN SEPTIC TANK & DRAIN PIPES GAS PUMPS DRIVE 40' PAVED M.P. 0350 DRIVE PERMIT DATE EXCEPT & RESERVE BUILDING DRIVE 20' PAVED M.P. 0349 DRIVE PERMIT DATE: (BY OPTION)
			VI. I7E 184+00 LT.	283+20 RT.									
			VI. I7E 183+20 LT.	283+00 RT.									
			284+52 RT.										
			285+38 RT.										
			283+00 RT.	283+12 RT.									
283+25 RT.													
284+77 RT.													
283+10 RT.													
283+07 RT.	283+12 RT.												
284+10 RT.													
VI. I7E 184+20 LT.													
283+44 RT.	284+38 RT.												
VI. I7E 183+40 LT.													

TABLE OF REVISIONS

REVISION NO.	SHEET NO.	DESCRIPTION OF REVISION	DATE	MADE BY	APPROVED BY
1	8,13	Parcel 12, Briggs M. Widened Drive at 309+88 Lt. from 14 to 22. Added Drive (14) at 309+88 Rt. Per C.O. #4087.	11/18/78	A.G.S.	T.P.M.
2	8,13	Parcels 13 & 12, Briggs & Briggs. Added Dead Waterline & Old Barn Foundation at 309+50 Lt. Per C.O. #4088.	11/18/78	A.G.S.	T.P.M.
3	8,12	Parcel 12, Briggs M. Revised Slope @ 307+00 Lt. to Sault Spring. Per C.O. #4125	12/16/78	A.G.S.	T.P.M.
4	5,10	PARCEL #2, LATHROP. WIDENED DRIVES AND REDUCED CURBS AT 282+45 LT. & 283+75 LT. PER REVISED DESIGN & C.O. #4135	1-5-79	P.J.H.	T.P.M.
5	6	PARCEL #7, CHURCHILL. ADDED "PERMIT TO MAINTAIN GAS PUMPS, 6184, AND LIGHTS IN R.O.W." PER C.O. #4139	1-8-79	P.J.H.	T.P.M.
6	8,13	PARCEL #12, BRIGGS. REMOVED SHED AT STA. 310+00 LT. PER C.O. #4140	1-8-79	P.J.H.	T.P.M.
7	5,10	Parcel #1, Morse. added demolition number & to pump island 281+17 RT - 281+50 RT per C.O. #4217	2-22-79	SPM	T.P.M.
8	6,10	Parcel #7, Churchill, added demolition number 589-27, island Tank, sign & light - 281+00-281+72 Lt. per C.O. #4218	2-22-79	SPM	T.P.M.
9	7,12	Parcel #9, Bolduc, added demolition number 6 to septic system and drainage 275+334E - 285+024E, 286+047 - 283+15, & 297+302E. Per C.O. #4219	2-22-79	SPM	T.P.M.
10	5,10	Parcel #3 Morse, Added const. ease for bldg. removal & added demo nos. to 2 signs, sign post, septic system & gas pumps. Per C.O. #4267	11-24-79	JDP	T.P.M.
10	5,10	PARCEL #3 MORSE, REMOVED CONST. EASE & DEMOLITION NUMBER FOR BUILDING REMOVAL (STORE) PER C.O. #4611	1-30-80	BAM	T.P.M.
11	6,10,12	PARCEL #7 KENNEDY, CHANGE IN TITLE ALSO DEMOLITION OF GAS PUMPS & SIGN PER C.O. #4230	2-12-80	BAM	T.P.M.
12	6,10	PARCEL #5 STATE OF VERMONT, CHANGE IN TITLE PER C.O. #4674	3-9-80	BAM	T.P.M.
13	9	PARCEL #15 BOLDUK, REMOVED ALL RT & L FROM WATERLINES AT T.M.T. 274 RT - 276 LT. PER C.O. #4662	3-19-80	BAM	T.P.M.

MADE BY: A.G.S. DATE 10/31/78
CHECKED BY: R.L.S. DATE 10/31/78

DR. RT. - DRAINAGE RIGHT
DIT. RT. - DITCHING RIGHT
CH. RT. - CHANNEL RIGHT
DRIVE RT. - DRIVE RIGHT
CUL. RT. - CULVERT RIGHT
⊙ - DEMOLITION OR REMOVAL
W - WATER SOURCES

PRESENT R.O.W.
--- TAKING WITHOUT ACCESS
--- TAKING WITHOUT ACCESS ALONG PROPERTY LINES
--- TAKING WITH ACCESS
(P) PERMANENT EASEMENT
(T) TEMPORARY EASEMENT

LEGEND
--- CONST. EASE
SR - SR SLOPE RIGHTS
P - P PROPERTY LINE
--- TOP OF CUT
--- TOP OF SLOPE

APPROVED *Thomas P. M...* DATE 11-1-78
CHIEF OF PLANS & TITLES

PROJECT: NEW HAVEN
NO. HHS 019-3(16)
SHEET 5 OF 14

STATE OF VERMONT
DEPARTMENT OF HIGHWAYS
RIGHT-OF-WAY PLANS
DETAIL SHEET

TABLE OF PROJECT PROPERTY ACQUISITION

PARCEL NO.	GRANTOR	SHEET NO.	BEGINNING STATION	ENDING STATION	TAKING	REM.	RIGHTS	TITLE TAKEN	DATE	TOWN OR CITY RECORDED	BK.	PG.	REMARKS
4	LUCIA, JOHN	10	285+69 RT. 285+90 RT. 286+35 RT.	287+54 RT. 287+55 RT. 288+88 RT.	0.21 A±		ALL R.T. & L. CONST. EASE. (T) 0.03 A± CHANNEL (P) (150 S.F.±)	W.D.		NEW HAVEN			HWY. EASE. U.S. 7 (1265 S.F.±)
5	STATE OF VERMONT AGENCY OF DEVELOPMENT AND COMMUNITY AFFAIRS, HISTORIC SITES DIVISION	10	287+54 RT. 288+10 RT.	288+89 RT. 289+35 RT.	0.15 A±		ALL R.T. & L.	EX. ORDER	3-29-83	NEW HAVEN	40	433-34	HWY. EASE. U.S. 7 DRIVE 20' PAVED M.P. 0546 DRIVE PERMIT DATE
8A	STATE OF VERMONT (LESSOR) VERMONT RAILWAY INC. (LESSEE)	10	287+37 LT. 286+85 LT.	288+89 LT. 287+70 LT.	0.17 A±		ALL R.T. & L. SLOPE (T) (0.02 A±)	R.A. AGREE		NEW HAVEN			HWY. EASE. U.S. 7 (1000 S.F.±)
8B		10	288+89 RT.	291+14 RT. TOTAL	0.23 A± 0.40 A±		ALL R.T. & L.						HWY. EASE. U.S. 7
7	KENNEDY, NANCY J.	10, 12	289+89 LT. 289+20 LT. 289+20 LT. 290+55 LT. 292+35 LT. 292+15 LT. 292+05 LT. 291+00 LT.	294+54 LT. 289+35 LT. 289+35 LT. 294+55 LT. 294+55 LT. 291+42 LT.	0.73 A±		ALL R.T. & L. SLOPE (T) (54 S.F.±) DRAINAGE (P) DRIVE (T) DRIVE (T) SLOPE (T) (0.05 A±) CONST. EASE. (T) (0.05 A±)	W.D.		NEW HAVEN			HWY. EASE. U.S. 7 DRIVE 24' PAVED M.P. 0550 DRIVE PERMIT DATE DRIVE 40' PAVED M.P. 0554 DRIVE PERMIT DATE (1,150 S.F.±) (2,100 S.F.±) LIGHTS
8A	WHITE PIGMENT CORPORATION	10, 12	294+00 RT. 295+20 RT. 294+95 RT. 296+65 RT. 295+95 RT. REV. 302+00 RT. REV. 302+00 RT. 292+15 RT. 293+15 RT.	REV. 302+00 RT. REV. 304+10 RT. REV. 304+10 RT. 296+77 RT. 295+65 RT. REV. 302+35 RT. REV. 302+35 RT.	0.04 A±		SLOPE (T) (0.25 A±) CONST. EASE. (T) (0.22 A±) CULVERT (P) DITCH & DRAINAGE (P) CULVERT (P) DRAINAGE (P) DRIVE (T)	W.D.	4-29-83	NEW HAVEN	40	523-251	(500 S.F.±) DRIVE 18' GRAVEL M.P. 0553 DRIVE PERMIT DATE DRIVE 20' GRAVEL M.P. 0555 DRIVE PERMIT DATE

TABLE OF REVISIONS

REVISION NO.	SHEET NO.	DESCRIPTION OF REVISION	DATE	MADE BY	APPROVED BY
14	9	PARCEL # 10 LADUNE, REMOVED ALL R.T. & L. FROM WATERLINE AT TH. B. 2+10 RT. - 2+50 LT. PER C.O. # 4643	3-19-80	BRM	T.P.M.
15	9, 14	ADDED PARCEL # 10 TOWN OF NEW HAVEN, PER C.O. # 4664	3-19-80	BRM	T.P.M.
16	9, 12	ADDED PARCEL # 21 H.P. HOOD & SON, PER C.O. # 4665	3-19-80	BRM	T.P.M.
17	8	PARCEL # 11 BOLDOC, ADDED ALL R.T. & L. AND WATERLINE AT REV. STA. 304+55 LT. - REV. STA. 306+10 RT. PER C.O. # 4667	3-19-80	BRM	T.P.M.
18	7	PARCEL # 9 BOLDOC, DELETED ALL R.T. & L. AND WATERLINE AT STA. 292+60 - 290+74 PER C.O. # 4662	4-4-80	BRM	T.P.M.
19	9, 12	PARCEL # 21 BOLDOC - H.P. HOOD (3085), ADDED ALL R.T. & L. TO WATERLINE AT 291+60 - 298+74 PER C.O. # 4683	4-4-80	BRM	T.P.M.
20	9, 12	PARCEL # 21 - CHANGE IN TITLE FROM H.P. HOOD, INC. TO AGRIC. MARK, INC. - LESSOR; H.P. HOOD, INC. & CLEARWATER CHEESE CO., INC. AS LESSEES PER C.O. # 5000	6-10-81	NWJ	T.P.M.
21	8, 13	PARCEL # 14 COLOMB, ADDED TO TITLE KATHARIN S. PER C.O. # 5006	6-30-81	BRM	J.D.P.
22	5-9, 14	PARCELS 1-3, 5, 7-9, 12-16 DELETED DRIVE RELEASES. PARCEL # 10 CHANGED FROM APPEL TO RELEASE. PARCEL # 20 ADDED APPEL & PARCEL # 21 ADDED W.D.G.E. PER C.O. # 5020	7-13-81	BRM	J.D.P.
23	5, 10	PARCEL # 3 CHANGE IN TITLE FROM LITHNER TO BROWN. ADDED TANK AREA DECREASED SIZE OF CONST. EASE. & ADDED CHANNEL RT. PER C.O. # 5108	10-6-81	NWJ	J.D.P.
24	5, 10	PARCEL # 3 MORSE, ADDED DRIVE AT STA. 182+00 LT. PER C.O. # 5107	10-7-81	NWJ	T.P.M.
25	6, 10, 12	PARCEL # 8 WHITE PIGMENT CORP. DELETED SLOPE RT. FROM 291+10 RT. - 293+20 RT. PER C.O. # 5110	10-9-81	J.D.P.	T.P.M.
26	6, 10	PARCEL # 7 KENNEDY, ADDED SLOPE & DRAINAGE RT. AT STA. 289+20 LT. - 289+35 LT. PER C.O. # 5111	10-9-81	J.D.P.	T.P.M.
27	6, 10	PARCEL # 6 VT. RAILWAY LESSEE, DELETED ALL TANKS ON RIGHT SIDE & ADDED SLOPE AREA ON THE LEFT PER C.O. # 5112	10-9-81	J.D.P.	T.P.M.
28	6, 10	PARCEL # 5 DELETED 30' DRAINAGE & CULVERT & CHANGED DRIVE STA. FROM 288+14 RT. TO 288+18 RT. - 289+35 RT. PER C.O. # 5113	10-9-81	J.D.P.	T.P.M.
29	6, 10	PARCEL # 4 DELETED SLOPE RT., DECREASED SIZE OF CONST. EASE. & ADDED CHANNEL RT. PER C.O. # 5114	10-9-81	J.D.P.	T.P.M.
30	5, 10	PARCEL # 3 DELETED CONST. EASE. FROM 285+50 RT. TO 285+70 RT. PER C.O. # 5115	10-9-81	J.D.P.	T.P.M.

MADE BY: A.G.S. DATE 10/31/78
CHECKED BY: R.L.S. DATE 10/31/78

DR. RT. - DRAINAGE RIGHT
DT. RT. - DITCHING RIGHT
CH. RT. - CHANNEL RIGHT
DRIVE RT. - DRIVE RIGHT
CUL. RT. - CULVERT RIGHT
D. - DEMOLITION OR REMOVAL
W. - WATER SOURCES

PRESENT R.O.W.
--- ---
--- --- TAKING WITHOUT ACCESS
--- --- TAKING WITHOUT ACCESS ALONG PROPERTY LINES
--- --- TAKING WITH ACCESS
(P) PERMANENT EASEMENT
(T) TEMPORARY EASEMENT

LEGEND
--- --- CONST. EASEMENT
--- --- SLOPE RIGHTS
--- --- PROPERTY LINE
--- --- TOP OF CUT
--- --- TOE OF SLOPE

APPROVED [Signature] DATE 11-1-78
CHIEF OF PLANS & TITLES

PROJECT NEW HAVEN
NO. HHS 019-3161
SHEET (6) OF 14

STATE OF VERMONT
DEPARTMENT OF HIGHWAYS
RIGHT-OF-WAY PLANS
DETAIL SHEET

TABLE OF PROJECT PROPERTY ACQUISITION

PARCEL NO.	GRANTOR	SHEET NO.	BEGINNING STATION	ENDING STATION	TAKING	REM	RIGHTS	TITLE TAKEN	DATE	TOWN OR CITY RECORDED	BK	PG	REMARKS		
8A	WHITE PIGMENT CORPORATION (CONT'D)	10,12	295+00 RT.				DRIVE (T)						DRIVE 20' GRAVEL W.P. 0559		
			295+80 RT.				DRIVE (T)						DRIVE PERMIT DATE DRIVE 28' GRAVEL W.P. 0560		
			297+35 RT. REV. 302+45 RT. REV. 302+45 RT. 296+55 RT.	REV. 304+10 RT. REV. 302+50 RT.				DITCH (P) DRAINAGE (P) ALL R. T. & I.						DRIVE PERMIT DATE FENCE	
				298+55 LT.				WATER LINE							
8B		10,12	291+14 RT.	REV. 304+12 RT.	1.10 A± 1.14 A±		ALL R. T. & I.						HWY. EASE. U.S. 7		
				TOTAL											
9A	BOLDUC, PETER R. & BARBARA W.	12	294+54 LT. 294+80 LT.	REV. 300+26 LT.	0.82 A±		ALL R. T. & I. DRIVE (T)	WD.		NEW HAVEN			HWY. EASE. U.S. 7 DRIVE 14' GRAVEL W.P. 0558 DRIVE PERMIT DATE		
			297+00 LT.				DRIVE (T)							DRIVE 12' GRAVEL W.P. 0562 DRIVE PERMIT DATE	
			297+50 LT.				DRIVE (T)							DRIVE 12' GRAVEL W.P. 0563 DRIVE PERMIT DATE	
			295+55 LT. 296+55 LT. 297+30 LT. 298+35 LT. 296+05 LT.	295+85 LT. 296+55 RT.				ALL R. T. & I.							LEACH FIELDS - REMOVE NO.6 WATER LINE LEACH PIPE - REMOVE NO.6 EASEMENT TO MAINTAIN SPRING IN ROW LEACH PIPE - REMOVE NO.6
				REV. 304+29 LT. REV. 303+90 LT. REV. 304+00 LT. REV. 306+45 LT. REV. 306+45 LT. REV. 305+25 LT. REV. 304+80 LT. REV. 304+50 LT.	REV. 306+56 LT. REV. 304+45 LT.	0.11A±		EASEMENT TO REMOVE BARN (0.04A±) ALL R. T. & I. ALL R. T. & I. ALL R. T. & I. CULVERT (P) DITCH (P) DRIVE (T)							(1,938 S.F.±) BARN D1 SPRING HOUSE D2 SPRING W1
				REV. 302+50 LT. REV. 302+73 LT. REV. 302+73 LT. REV. 304+45 LT. REV. 302+89 RT.	REV. 306+56 LT. REV. 303+95 LT. REV. 303+90 LT. REV. 306+65 LT. REV. 306+54 LT.	0.45A± 1.38A±		SLOPE (T) (755 S.F.±) CONST. EASE. (T) (0.04A±) CONST. EASE. (T) (0.04A±) ALL R. T. & I.	WD			NEW HAVEN			DRIVE 14' GRAVEL W.P. 0577 DRIVE PERMIT DATE FENCE
	REV. 302+50 LT. REV. 300+35 LT. REV. 300+85 LT. REV. 302+26 LT.	REV. 300+26 LT. REV. 300+80 LT.	0.36A±		ALL R. T. & I. DRIVE (T) DRIVE (T)	WD			NEW HAVEN			HWY. EASE. U.S. 7 12' GRAVEL W.P. 0569 DRIVE PERMIT DATE 16' GRAVEL W.P. 0570 DRIVE PERMIT DATE 16' GRAVEL W.P. 0572 DRIVE PERMIT DATE EXCEPT & RESERVE HOUSE SEPTIC TANK DRAIN PIPE CELLER DRAIN			
	REV. 300+45 LT. REV. 300+02 LT. REV. 299+50 LT.	REV. 300+80 LT. REV. 300+50 LT.			ALL R. T. & I. ALL R. T. & I.										

TABLE OF REVISIONS

REVISION NO.	SHEET NO.	DESCRIPTION OF REVISION	DATE	MADE BY	APPROVED BY
31	5-10, 12-14	Revised R.O.W. Project Plans per C.O. #5229. Acquired "Fee" in PAW EASE. U.S. 7. Affected Parcels 1 through 16. Also includes C.O.'s 5256 through 5271	3-15-82	NWJ	T.P.M.
32	9,10	Created new parcel #23, Segun. O.I.P. All R.T. & I., Hwy. Eas. Per C.O. #5254	3-15-82	NWJ	T.P.M.
33	9,10	Created new parcel #22, Segun. O.I.P. All R.T. & I., Hwy. Eas. Per C.O. #5255	3-15-82	NWJ	T.P.M.
34	9,10,14	Parcel #15 BOLDUC, Added "OHIO OIL & GAS LESSEE" TO TITLE PER C.O. #5602	10-26-82	DEM	R.L.S.
35	10	At STA 319, Revised offset DITCHES PER C.O. #5642	11-22-82	DEM	R.L.S.
36	9,14	Parcel #16, Change in Easement Per C.O. #5675	12-22-82	B.A.M.	C.H.F.
37	9,12	Parcel #21, Change in Title Per C.O. #5676	12-22-82	B.A.M.	C.H.F.
38	10	Parcel #3 Morse, Revised CUT AT STA. 293+14 RT. & VT. 17 EAST 142+65 LT. PER C.O. #5667	1-17-83	DEM	R.L.S.
39	9,10,14	Parcel #15 BOLDUC, Deleted OHIO OIL & GAS FROM TITLE, CHANGED LEASURE TO DRAINAGE ON 1/2" LAYOUT PER C.O. #5725	1-26-83	DEM	R.L.S.
40	9	Parcel #11 BOLDUC, Added "EXCEPT & RESERVE HOUSE" AT STA. REV. 305+14 RT. - REV. 305+50 RT. PER C.O. #5766	2-28-83	M.W.H.	R.B.
41	9	Parcel #15 BOLDUC, Added "EXCEPT & RESERVE HOUSE" AT STA. REV. 323+75 RT. - REV. 324+15 RT. PER C.O. #5767	2-28-83	M.W.H.	R.B.
42	13	Parcel #14 COLLINS, Deleted HARD LIGHT & WILLOW (18') AT APPROXIMATE STA. REV. 312+90 RT., CHANGED NOTATION FROM "SAVE" TO "REMOVE" ON 1/2" C&G OR AT STA. REV. 313+75 RT. PER C.O. #5738	2-23-83	M.W.H.	R.B.
43	8,13	Parcel #12 BRIGGS, Revised Drive From 16' To 22' At Sta. 309+85 RT. 1' Extended Water Line To Mobil Home Per Revised Design C.O. #5773	3-7-83	B.A.M.	R.L.S.
44	12	Parcel #10 LEE, Revised TOP OF 12" LIFT POST 700+44 LT. + COLLAR DRAIN, WATERLINE + SEPTIC TANK PER C.O. #5737	3-21-83	DEM	R.L.S.

MADE BY: A.G.S. DATE 10/31/78
CHECKED BY: R.L.S. DATE 10/31/78

DR. RT. - DRAINAGE RIGHT
DIT. RT. - DITCHING RIGHT
CH. RT. - CHANNEL RIGHT
DRIVE RT. - DRIVE RIGHT
CUL. RT. - CULVERT RIGHT
⊖ - DEMOLITION OR REMOVAL
☐ - WATER SOURCES

PRESENT R.O.W.
- - - - - TAKING WITHOUT ACCESS
- - - - - TAKING WITHOUT ACCESS ALONG PROPERTY LINES
- - - - - TAKING WITH ACCESS
(P) PERMANENT EASEMENT
(T) TEMPORARY EASEMENT

LEGEND
--- CONST. EASE --- CONST. EASEMENT
SR SR SLOPE RIGHTS
P P PROPERTY LINE
-Δ-Δ-Δ- TOP OF CUT
-○-○-○- TOE OF SLOPE

APPROVED Henry P. Messer DATE 11-1-78
CHIEF OF PLANS & TITLES

PROJECT NEW HAVEN
NO. HHS 019-2(16)
SHEET 7 OF 14

STATE OF VERMONT
DEPARTMENT OF HIGHWAYS
RIGHT-OF-WAY PLANS
DETAIL SHEET

TABLE OF PROJECT PROPERTY ACQUISITION

PARCEL NO.	GRANTOR	SHEET NO.	BEGINNING STATION	ENDING STATION	TAKING	REM.	RIGHTS	TITLE TAKEN	DATE	TOWN OR CITY RECORDED	BK.	PG.	REMARKS
11	BOLDUC, REAL J. & GISELE D.	12	REV. 304+12 RT. REV. 304+10 RT. REV. 304+10 RT. REV. 305+04 RT.	REV. 306+51 RT. REV. 304+20 RT. REV. 304+35 RT.	0.27 A±		ALL R. T. & L. SLOPE (T) (205.F.±) CONST. EASE (T) (2005.F.±) DRIVE (T)	W.D.	5-7-83	NEW HAVEN	40	541-42	HWY. EASE. U.S. 7 DRIVE 12' GRAVEL M.P. 0579 DRIVE PERMIT DATE WATERLINE EXCEPT & RESERVE HOUSE
			REV. 305+55 LT. REV. 305+14 RT.	REV. 306+10 RT. REV. 305+50 RT.			ALL R. T. & L.						
12A	BRIGGS, MARVIN E.	12, 13	REV. 306+49 LT. REV. 308+05 LT. REV. 306+60 LT. REV. 309+88 LT.	REV. 312+86 LT. REV. 312+86 LT. REV. 312+90 LT.	0.38A±		SLOPE (T) 0.08A± CONST. EASE (T) 0.15A± DRIVE (T)	W.D.	4-21-83	NEW HAVEN	40	504-09	(3,360 S.F.±) DRIVE 22' GRAVEL M.P. 0587 DRIVE PERMIT DATE SHED FOUNDATION D-3 SPRING-RIGHTS TO BE RESERVED BARN FOUNDATION
			REV. 310+05 LT. REV. 307+20 LT. REV. 309+50 LT.				ALL R. T. & L. ALL R. T. & L.						
12B		12, 13	REV. 306+51 RT. REV. 309+04 RT.	REV. 312+80 LT.	1.01 A±		ALL R. T. & L. DRIVE (T)						HWY. EASE. U.S. 7 DRIVE 14' GRAVEL M.P. 0585 DRIVE PERMIT DATE DRIVE 22' GRAVEL M.P. 0587 DRIVE PERMIT DATE WATERLINE
			REV. 309+88 RT. REV. 308+80 RT.	REV. 309+40 LT. TOTAL	1.39 A±		ALL R. T. & L.						
13	BRIGGS, KALMA T.	12, 13	REV. 306+47 RT. REV. 306+60 RT. REV. 309+04 RT.	REV. 309+14 RT.	0.39 A±		ALL R. T. & L. DRIVE (T)	W.D.	3-19-83	NEW HAVEN	40	431-32	HWY. EASE. U.S. 7 DRIVE 12' GRAVEL M.P. 0581 DRIVE PERMIT DATE DRIVE 14' GRAVEL M.P. 0585 DRIVE PERMIT DATE WATERLINE
			REV. 308+80 RT.	REV. 309+40 LT.			ALL R. T. & L.						
14	COLOMB, RANDALL S. & KATHLEEN S.	13	REV. 312+59 RT. REV. 313+17 RT.	REV. 315+87 RT.	0.39 A±		ALL R. T. & L. DRIVE (T)	W.D.		NEW HAVEN			HWY. EASE. U.S. 7 DRIVE 24' GRAVEL M.P. 0593 DRIVE PERMIT DATE

TABLE OF REVISIONS

REVISION NO.	SHEET NO.	DESCRIPTION OF REVISION	DATE	MADE BY	APPROVED BY
45	5, 10	PARCEL # 3 MOUSE, Added "EXCEPT & RESERVE HOUSE" BUILDING AT STA. 304+20 RT. = 40' DCL. AT STA. 285+38 RT. = 17' 11" DCL. DELETED DR. # 17 183+40 LT. = "CELLAR DRAIN" FROM PIPE AT STA. 283+14 RT. PER C.O. # 5182	3-21-83	DEM	R.L.S.
46	7, 11	PARCEL # 10 LEE, Added "EXCEPT & RESERVE HOUSE" AT STA. 308+05 LT. = 10' 30" DCL. = ALL RT. TO 307' 10" TRUE DRAIN PIPE (STA. 302+00 LT.) CELLAR DRAIN (REV. 199+80 LT. - REV. 300+50 LT.) PER C.O. # 5718	3-21-83	DEM	R.L.S.
47	9, 12	PARCEL # 11 BOLDUC, Added "EXCEPT & RESERVE RT. TO H.C. SHED & WATERLINE" AT STA. 306+51 RT. = 24' 6" LT. PER C.O. # 5719	3-21-83	DEM	R.L.S.
48	5, 10	PARCEL # 3 MOUSE, ADDED DRIVE @ VT. 17E STA. 183+40 LT. APPROXIMATE ON LAYOUT SHEET # 10 AND PERMIT ON DETAIL SHEET PER C.O. # 5816	4-1-83	M.W.K.	R.L.S.
49	8, 13	PARCEL # 14 COLOMB, REVISED DRIVE REV. 313+17 RT. 24' WIDE FROM 313+17 RT. 18' WIDE PER C.O. 5842	4-13-83	DEM	R.L.S.
50	12	PARCEL # 10 LEE, Eliminated Ditch in Road 18" x 18" Pipe (30' x 18" = 302+94 LT.) Per Revised Design (C.O. # 5855	4-10-83	B.A.M.	J.F.O.

MADE BY: A.G.S. DATE 10/31/78
CHECKED BY: B.L.S. DATE 10/31/78

DR. RT. - DRAINAGE RIGHT
DT. RT. - DITCHING RIGHT
CH. RT. - CHANNEL RIGHT
DRIVE RT. - DRIVE RIGHT
CL. RT. - CULVERT RIGHT
D - DEMOLITION OR REMOVAL
W - WATER SOURCES

PRESENT R.O.W.
TAKING WITHOUT ACCESS
TAKING WITHOUT ACCESS ALONG PROPERTY LINES
TAKING WITH ACCESS
(P) PERMANENT EASEMENT
(T) TEMPORARY EASEMENT

LEGEND
CONST. EASE - CONST. EASEMENT
SR - SR - SLOPE RIGHTS
P - P - PROPERTY LINE
Δ - Δ - TOP OF CUT
O - O - TOE OF SLOPE

APPROVED: *Thomas P. Mast* DATE 11-1-78
CHIEF OF PLANS & TITLES

PROJECT NEW HAVEN
NO. HHS 019-3(15)
SHEET 8 OF 14

STATE OF VERMONT
DEPARTMENT OF HIGHWAYS
RIGHT-OF-WAY PLANS
DETAIL SHEET

TABLE OF PROJECT PROPERTY ACQUISITION

PARCEL NO.	GRANTOR	SHEET NO.	BEGINNING STATION	ENDING STATION	TAKING	REM.	RIGHTS	TITLE TAKEN	DATE	TOWN OR CITY RECORDED	BK.	PG.	REMARKS
15A	BOLDUC, ANTHONY L. & MARCELLE M.	13, 14	REV. 312+80 LT.	REV. 329+15 LT.	0.50 A ±		CONST. EASE (T) 0.04 A ± SLOPE (T) (100 S.F. ±) CONST. EASE (T) 0.06 A ± SLOPE (T) (0.08 A ±) DRIVE (T)	W.D.		NEW HAVEN			(1,900 S.F. ±)
			REV. 312+86 LT.	REV. 315+10 LT.									(2,700 S.F. ±)
			REV. 312+86 LT.	REV. 316+00 LT.									(3,700 S.F. ±)
			REV. 319+05 LT.	REV. 322+08 LT.									DRIVE PERMIT DATE
			REV. 318+83 LT.	REV. 321+90 LT.									(3,200 S.F. ±)
			REV. 326+50 LT.										DRIVE 14' GRAVEL M.P. 0618
			REV. 329+85 LT.	REV. 327+90 LT.			CONST. EASE (T) 0.07 A ± SLOPE (T) (350 S.F. ±) ALL R.T. & I.						DRIVE PERMIT DATE
			REV. 325+35 LT.	REV. 327+20 LT.									(3,200 S.F. ±)
			REV. 329+65 LT.	REV. 322+75 RT.									WATER LINE
15B			REV. 312+80 RT.	REV. 326+34 RT.	3.45 A ±		ALL R.T. & I. DRIVE (T) DRIVE (T)						HWY. EASE. U.S. 7
			REV. 312+90 RT.	REV. 323+10 RT.									DRIVE 20' GRAVEL M.P. 0613
			REV. 323+75 RT.	REV. 324+15 RT.			DRIVE PERMIT DATE: EXCEPT & RESERVE HOUSE						
			T.H. B 1+50 RT.	T.H. B 2+60 LT.			WATER LINE						
			T.H. B 2+40 RT.	T.H. B 2+60 LT.	TOTAL	3.95 A ±							
16	BRENMAN, RICHARD J. & MARIANN L.	14	REV. 326+73 RT.	REV. 329+15 RT.	0.08 A ±		DRIVE (T)	W.D.		NEW HAVEN			(2,550 S.F. ±)
			REV. 328+30 RT.										DRIVE 12' GRAVEL M.P. 0622
			T.H. B 2+50 LT.	T.H. B 2+60 LT.			DRIVE (T)						DRIVE PERMIT DATE
			T.H. B 2+40 RT.	T.H. B 2+60 LT.									WATERLINE
16B			REV. 326+34 RT.	REV. 329+15 RT.	0.28 A ±		ALL R.T. & I.						HWY. EASE. U.S. 7
				TOTAL	0.32 A ±								
17	GREEN MOUNTAIN POWER CORP.												UTILITY
18	CONTINENTAL TELEPHONE CO.												UTILITY
19	NEW ENGLAND TELEPHONE & TELEGRAPH CO.												UTILITY
20	TOWN OF NEW HAVEN	14	T.H. B 1+03 RT.	T.H. B 3+00 LT.			CONSTRUCT APPROACH (T)	AGREE.					T.H. B
21	BOLDUC, PETER R. & BARBARA W. & WHITE PIGMENT CORP.	12	298+60 RT.	298+84 LT.			ALL R.T. & I.	OPTION	6-40-83	NEW HAVEN	40	516-8	WATERLINE
			298+60 RT.	298+84 LT.									EXCEPT & RESERVE RT. TO USE SLEEVE & WATERLINE
22	STONE, ORISON W. & JEANNE D.	10	279+00 LT.	281+94 LT.	0.35 A ±		ALL R.T. & I.	W.D.	3-17-85	NEW HAVEN	40	424	HWY. EASE. U.S. 7
23	SECUN, REGENT G. & ETHEL J.	10	279+00 RT.	280+03 RT.	0.11 A ±		ALL R.T. & I.	W.D.					HWY. EASE. U.S. 7

TABLE OF REVISIONS

REVISION NO.	SHEET NO.	DESCRIPTION OF REVISION	DATE	MADE BY	APPROVED BY

MADE BY: A.S.S. DATE 10/31/78
CHECKED BY: R.L.S. DATE 10/31/78

DR. RT - DRAINAGE RIGHT
DIT. RT - DITCHING RIGHT
CH. RT - CHANNEL RIGHT
DRIVE RT - DRIVE RIGHT
CL. RT - CULVERT RIGHT
⊖ - DEMOLITION OR REMOVAL
⊞ - WATER SOURCES

--- PRESENT R.O.W.
/// TAKING WITHOUT ACCESS
--- P --- TAKING WITHOUT ACCESS ALONG PROPERTY LINES
--- TAKING WITH ACCESS
(P) PERMANENT EASEMENT
(T) TEMPORARY EASEMENT

LEGEND

--- CONST. EASE --- CONST. EASEMENT
--- SR --- S/R --- SLOPE RIGHTS
--- P --- P --- PROPERTY LINE
--- Δ --- Δ --- TOP OF CUT
--- ○ --- ○ --- TOP OF SLOPE

APPROVED: *Thomas P. Moore* DATE 11-1-78
CHIEF OF PLANS & TITLES

PROJECT NEW HAVEN
NO. HHS 019-3(16)
SHEET 9 OF 14

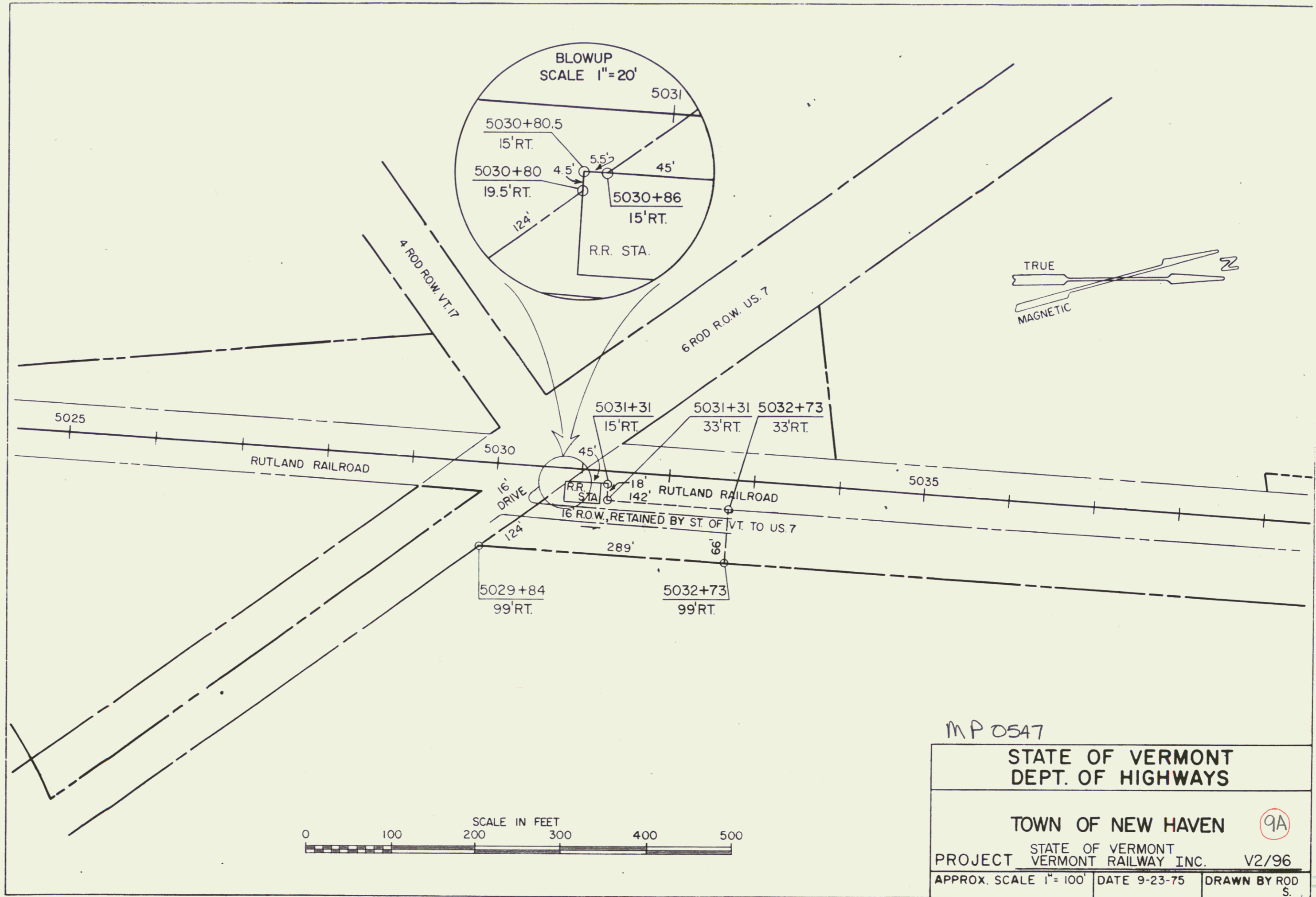

PLAN	DATE
NO.	
BY	
CHECKED	
APPROVED	
DATE	

PROFILE	DATE
NO.	
BY	
CHECKED	
APPROVED	
DATE	

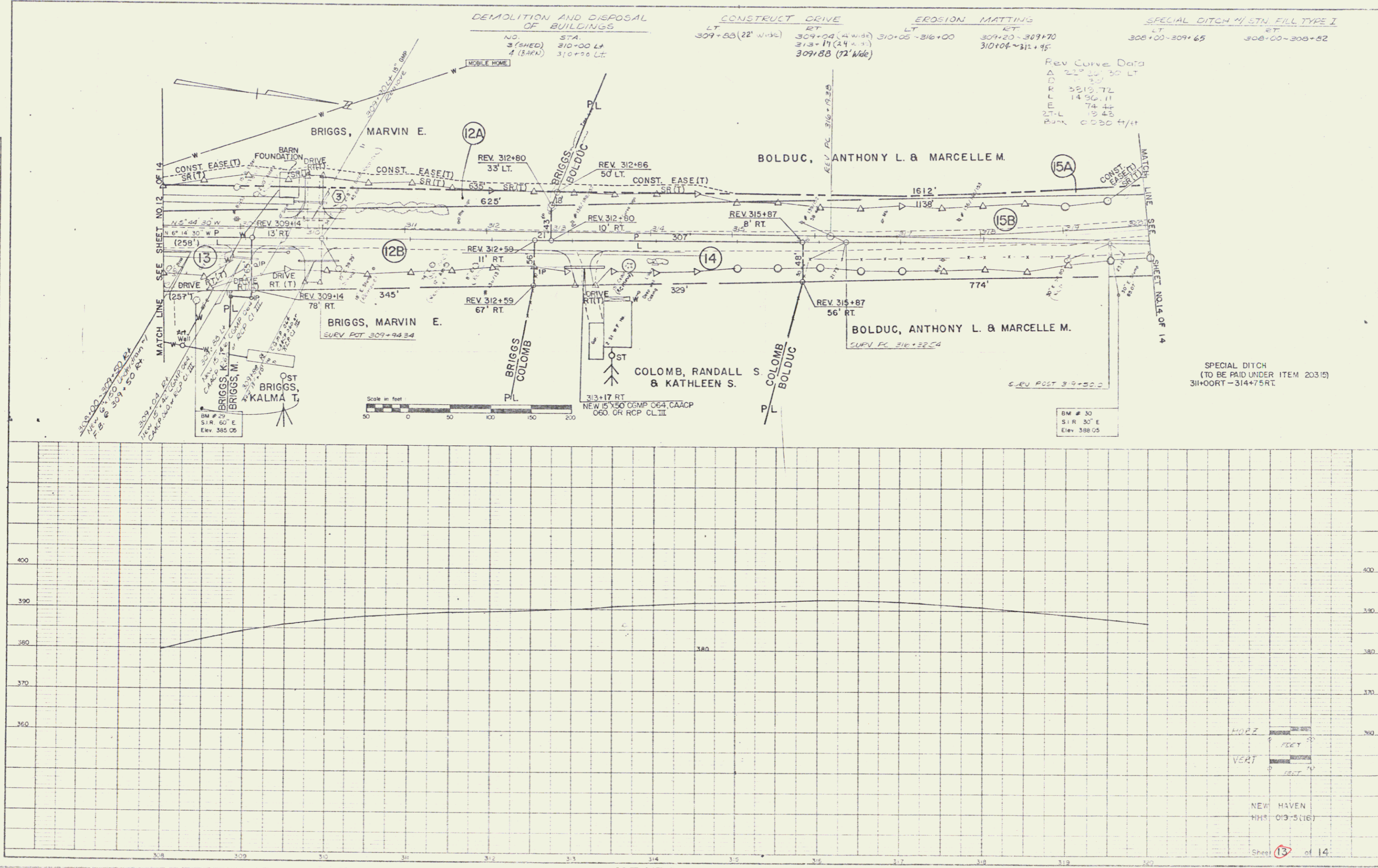

10

DATE	
BY	
CHECKED	
SCALE	
PROJECT	
NOTE BOOK	
NO.	

DATE	
BY	
CHECKED	
SCALE	
PROJECT	
NOTE BOOK	
NO.	

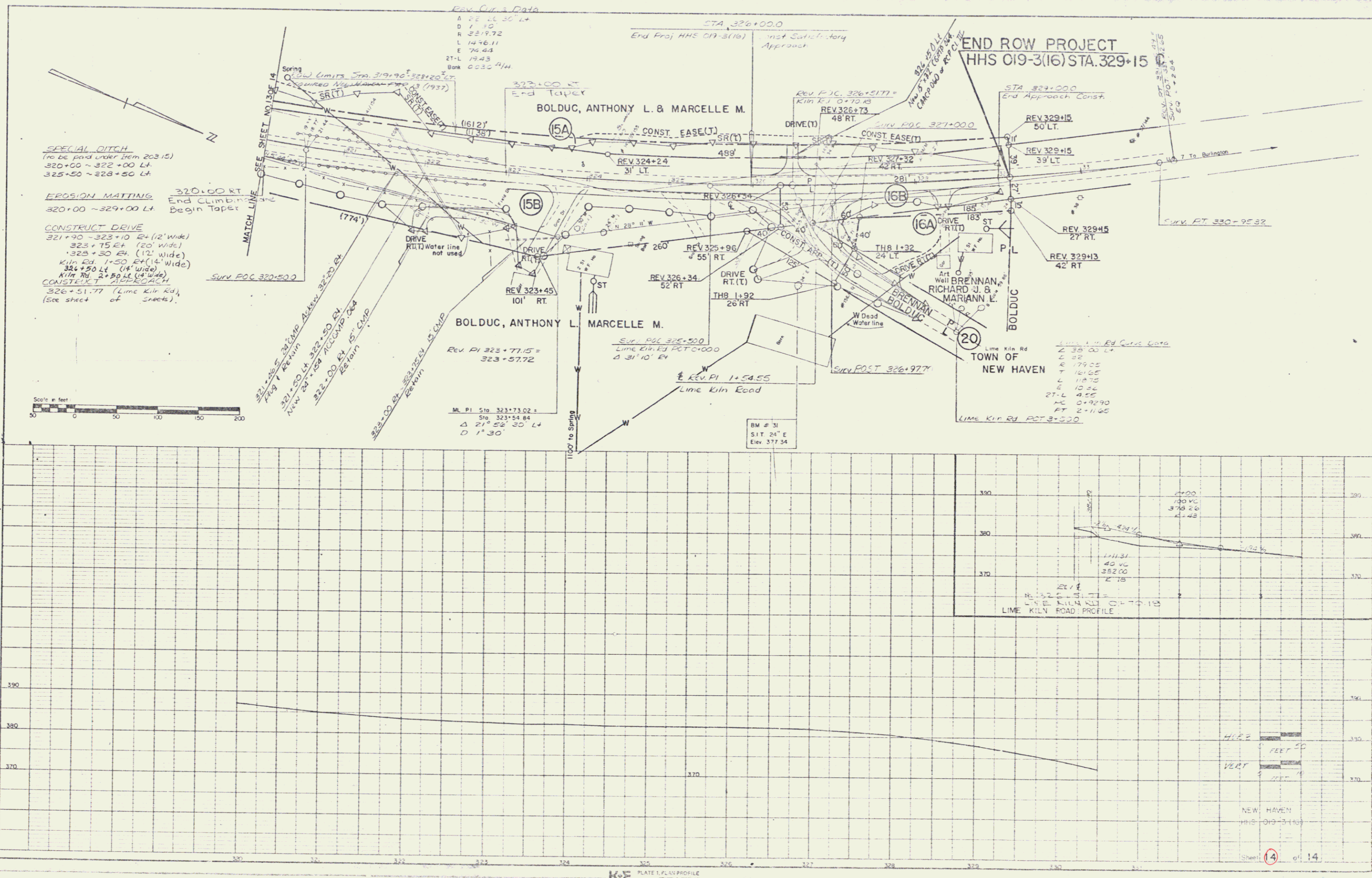

SPECIAL DITCH
 To be paid under Item 203 (S)
 320+00 ~ 322+00 LT
 325+50 ~ 328+50 LT

EROSION MATING
 320+00 RT
 End Climbing
 320+00 LT
 Begin Taper

CONSTRUCT DRIVE
 321+90 ~ 323+10 E4 (12' wide)
 323+15 E4 (20' wide)
 323+30 E4 (12' wide)
 Kiln Rd. 1+50 E4 (14' wide)
 324+50 LT (14' wide)
 Kiln Rd. 2+80 LT (14' wide)
CONST. APPROACH
 326+51.77 (Lime Kiln Rd.)
 (See sheet of sheets).

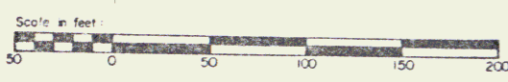

END ROW PROJECT
 HHS 019-3(16) STA. 329+15

TOWN OF NEW HAVEN
 Lime Kiln Rd. Curve Data
 L 351.00 LT
 L 52
 E 179.05
 T 161.65
 L 18.75
 E 10.26
 27-L 4.25
 MC 0+9290
 PT 2+1190
 LIME KILN RD. PCT 3+500