

PLAN
 NOTE BOOK
 NO.

The VAOT has elected to use a three (3) rod R.O.W. This elective in no way should be considered as the Agency's intent to give up any claim whatsoever, now or in the future, to the present existing six (6) rod R.O.W.

DATUM
 VERTICAL NGVD 1929
 HORIZONTAL N/A

BEGIN ROW PROJECT SECT. I
 FEGC-FF 019-4(10)S STA. 270+00C

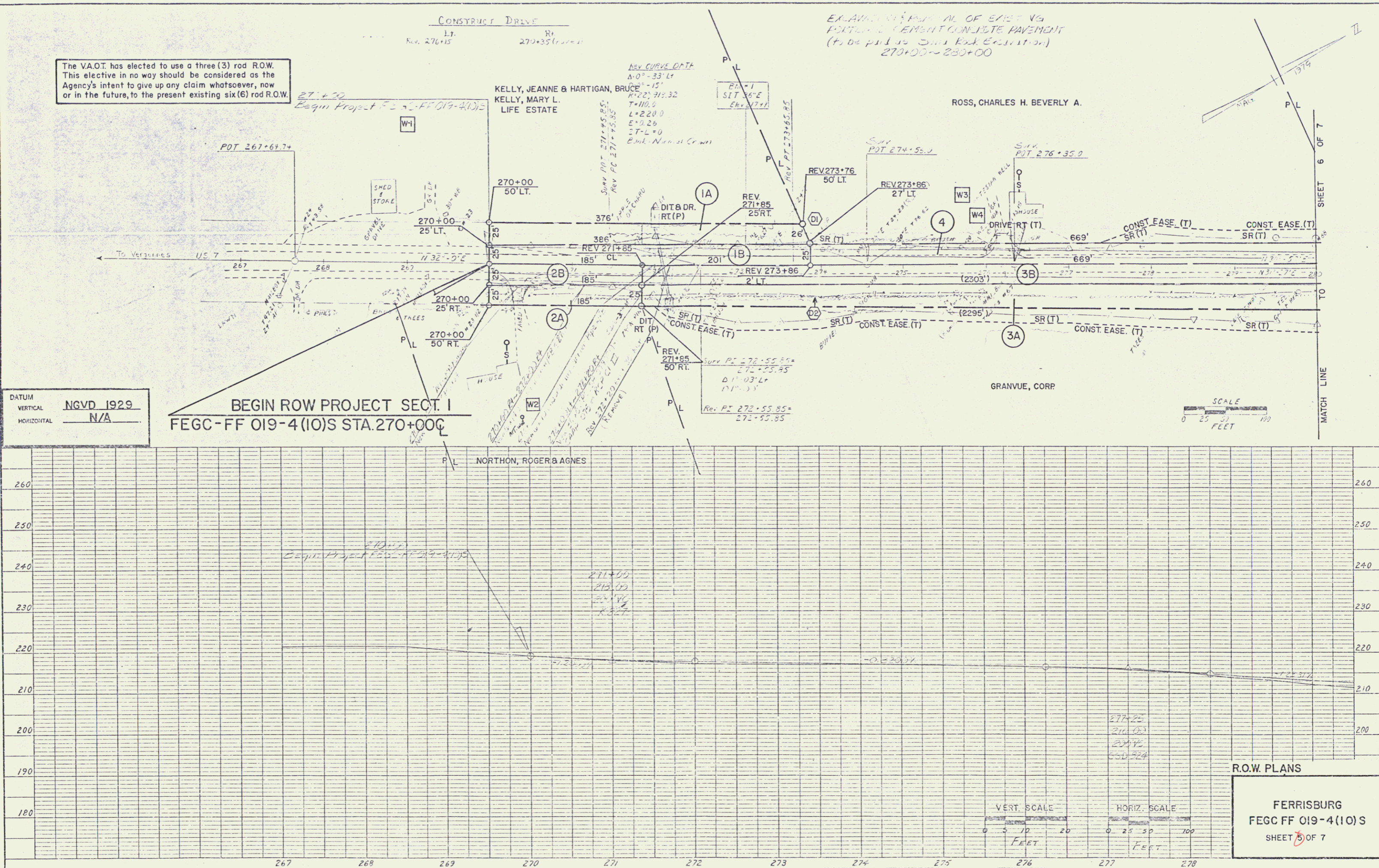

EX-AVANTAGEMENTAL OF EXISTING PORTLAND CEMENT CONCRETE PAVEMENT (To be placed on Subgrade) 270+00 ~ 280+00

KELLY, JEANNE & HARTIGAN, BRUCE
 KELLY, MARY L.
 LIFE ESTATE

ROSS, CHARLES H. BEVERLY A.

GRANVUE, CORP

NORTHON, ROGER & AGNES

VERT. SCALE
 0 5 10 20
 FEET

HORIZ. SCALE
 0 25 50 100
 FEET

R.O.W. PLANS
FERRISBURG
 FEGC FF 019-4(10)S
 SHEET 5 OF 7

JUN 02 1992

5