

INDEX OF SHEETS

- 1 Title
- 2 Typical
- 3 Drainage & Quantity Sheet
- 4 Earthwork Sheet
- 5-6 Layout & Profile
- 7-13 Mainline X-Sections
- 14-18 Channel Line X-Sections
- 19 Guard Rail Details

STATE OF VERMONT
AGENCY OF TRANSPORTATION



PROPOSED IMPROVEMENT

TOWN OF BRANDON

COUNTY OF RUTLAND

ETHAN ALLEN HIGHWAY, U.S. ROUTE 7
RUTLAND - MIDDLEBURY ROAD

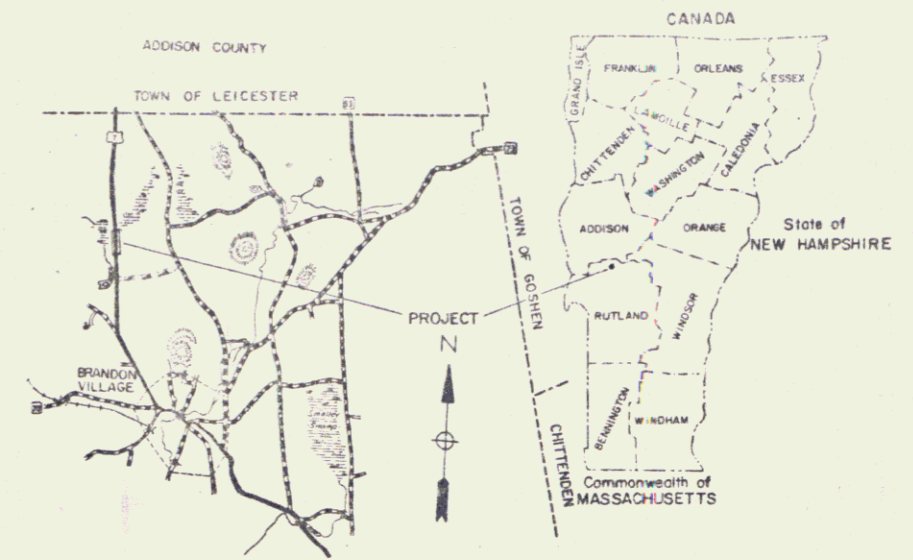

R.O.W. PLANS

IN THE TOWN OF BRANDON, BEGINNING AT A POINT ON US ROUTE 7 WHICH IS 6.027 MI. NORTHERLY OF THE PITTSFORD-BRANDON TOWN LINE AND EXTENDING NORTHERLY FOR 0.265 MI.

LENGTH OF ROADWAY 1400.0 FEET = 0.265 MILES
LENGTH OF PROJECT 1400.0 FEET = 0.265 MILES
LENGTH OF R.O.W. PROJECT 2000.0 FEET = 0.379 MILES

EST. 1981 ADT	4390
EST. 2001 ADT	6130
EST. 2001 DHV	665
D	51%
T	6%
V	55

BEGIN R.O.W. PROJECT
FR 019-3 (22) STA. 314+00

END R.O.W. PROJECT
FR 019-3 (22) STA. 334+00

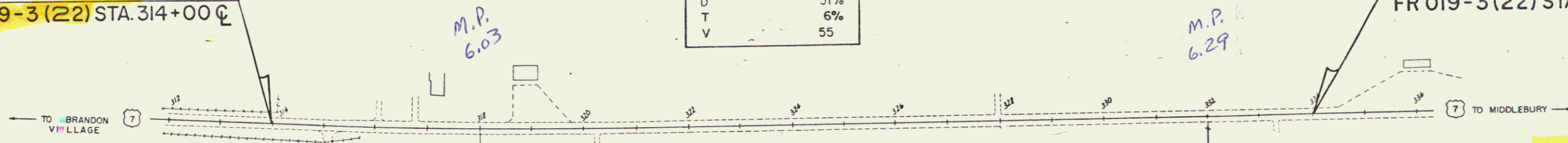

Pin # 766142

- CONVENTIONAL SIGNS
- COUNTY LINE
 - TOWN LINE
 - LIMITS OF ACCESS
 - POINT OF ACCESS
 - FENCE LINE
 - STONE WALL
 - TRAVELED WAY
 - RAILROAD
 - SURVEY LINE
 - CULVERT
 - POWER POLE
 - TELEPHONE POLE
 - TREES
 - F.A. CONST. IDENTIFICATION SIGNS
 - PROPERTY LINE
 - R.O.W. TAKING LINE
 - SLOPE RIGHTS
 - TOP OF CUT
 - TOP OF SLOPE

STA 318+00
BEGIN PROJECT FR 019-3(22)
CONSTRUCT SATISFACTORY APPROACH

STA 332+00
END PROJECT FR 019-3(22)
CONSTRUCT SATISFACTORY APPROACH



RIGHT-OF-WAY DIVISION
TOWN FILE
PERPETUAL
Town of _____
(To Be Returned To R.O.W. Division)

These plans are subject to such engineering changes as may be required by the Federal Highway Administration or the Director of Engineering and Construction. Construction is to be carried on in accordance with these plans and the Standard Specifications for Highway and Bridge Construction dated March, 1976, as approved by the Federal Highway Administration on October 27, 1976, for use on this project, including all subsequent revisions and such revised specifications and special provisions as are incorporated in these plans.

APPROVED: _____ DATE: 4/24/80

CHIEF, PROPERTY ADMINISTRATION

PROJECT FR 019-3(22)
SHEET 1 OF 5 SHEETS

TYPICAL SECTIONS

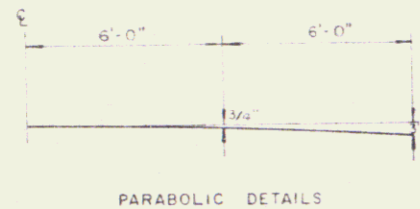

3" BITUMINOUS CONCRETE PAVEMENT, ITEM 406.25, PLACED IN TWO 1-1/2" COURSES
 5" PLANT MIXED BASE COURSE, ITEM 303.25 (PLACED IN TWO 2-1/2" COURSES)
 SHOULDERS: 1-1/2" BITUMINOUS CONCRETE PAVEMENT ITEM 406.25
 24" SUBBASE OF GRAVEL, ITEM 301.15

0'-24" SAND BORROW (IN CUT) ITEM 203.31
 0'-12" GRANULAR BORROW (IN FILL) ITEM 203.32] TO BE PLACED AS NOTED ON THE PLANS OR AS DIRECTED BY THE ENGINEER.

GENERAL NOTES

SEED, ITEM 651.10 TO BE APPLIED AS DIRECTED BY THE ENGINEER			
%WT	LBS/A	NAME	PUR% GERM%
3.33	2	CROWN VETCH	97 75
50.00	30	CREeping RED FESCUE	90 85
8.33	5	TIMOTHY	99 85
16.67	10	PERENNIAL RYE GRASS (VAR. PENNFINE)	95 85
8.34	5	ALFALFA (VAR. SARANAC)	99 85
8.33	5	BROSFoot TREFOIL (VAR. EMPRE)	98 85
5.00	3	HIGHLAND BENT GRASS	92 85
100.00	60	LBS/ACRE	

THE SEED MIXTURE SHALL NOT HAVE A WEED CONTENT EXCEEDING 0.40% BY WEIGHT AND SHALL BE FREE OF ALL NOXIOUS WEED SEED.

MARKER POSTS, (WOOD OR STEEL AS SPECIFIED) TO BE PLACED AS DIRECTED BY THE ENGINEER

FERTILIZER, ITEM 651.15
 FORMULA 10-20-10 TO BE USED WITH SEED, ITEM 651.10 APPLIED AT THE RATE OF 500 LBS/ACRE

AGRICULTURAL LIMESTONE, ITEM 651.20 TO BE APPLIED AT RATE OF 2 TONS/ACRE OR AS DIRECTED BY THE ENGINEER

HAY MULCH, ITEM 651.25 TO BE PLACED ON EARTH SLOPES AT THE RATE OF 2 TONS/ACRE

TOPSOIL, ITEM 653.10 TO BE USED WITH SEED, ITEM 651.10 IN RESIDENTIAL AREAS, AS DIRECTED BY THE ENGINEER

SEE STANDARD SHEET B-5 FOR TYPICAL SLOPE ROUNDING
 SEE STANDARD SHEET D-2 FOR PAY LIMITS OF SAND BORROW WHEN USED IN CONJUNCTION WITH UNDERDRAIN

ALLOWABLE THICKNESS TOLERANCES

SUB-BASE	± 1"
CONTROLLED MATERIAL	± 1"
PAVEMENT	± 1/4"
BASE COURSE	± 1/2"

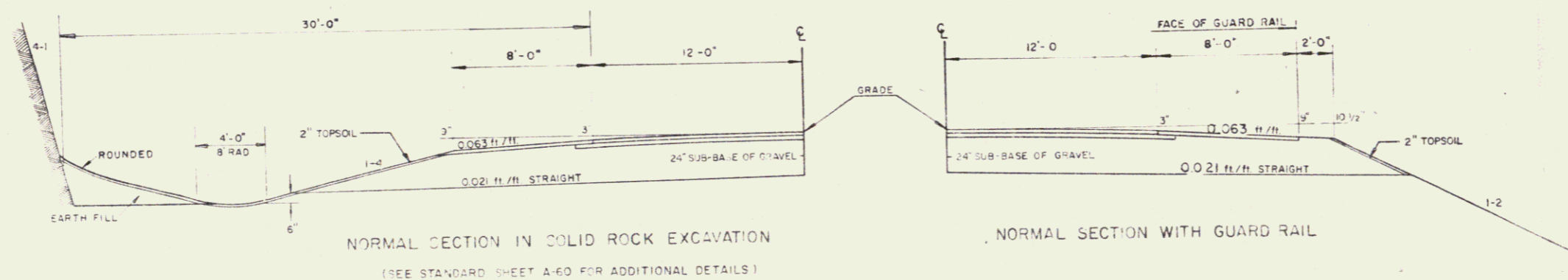
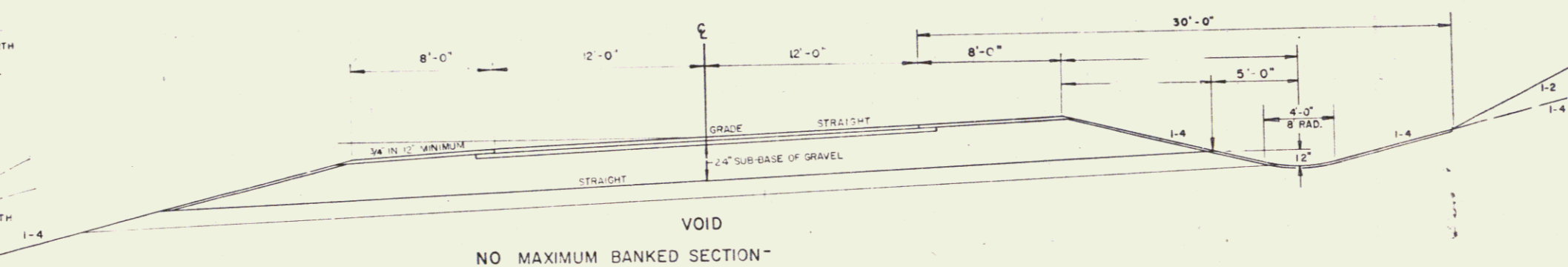
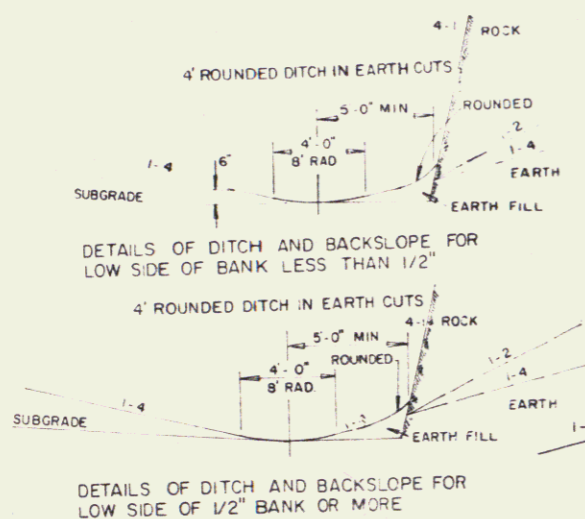
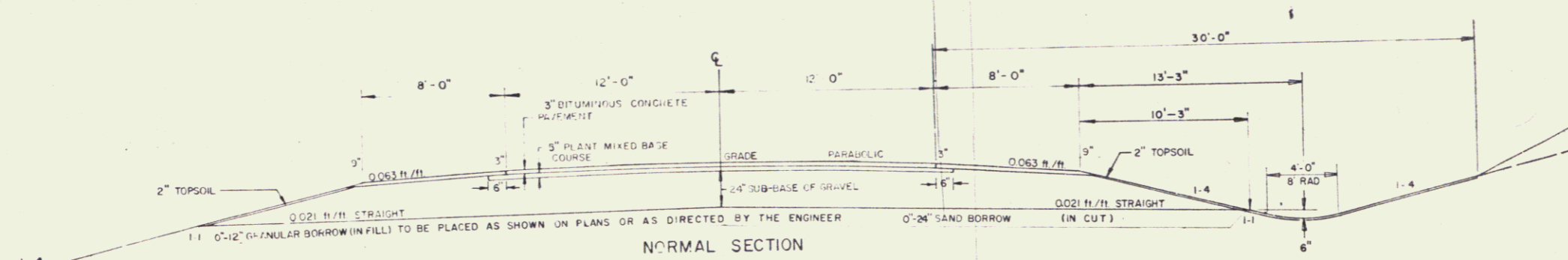

TOWN OF BRANDON

STATE OF VERMONT
 DEPARTMENT OF HIGHWAYS

DRAWN BY CE Hurley TRACED BY Laufman
 PROJ. N° FR 019-3(22) SHEET 2 OF 5

STATE OF VERMONT
AGENCY OF TRANSPORTATION
RIGHT-OF-WAY PLANS
DETAIL SHEET

TABLE OF PROJECT PROPERTY ACQUISITION

PARCEL NO.	GRANTOR	SHEET NO.	BEGINNING STATION	ENDING STATION	TAKING	REM.	RIGHTS	TITLE TAKEN	DATE	TOWN OR CITY RECORDED	BK.	PG.	REMARKS		
1A	COUSINO, MELVIN & BERNICIA	4,5	314+96 RT	344+00 RT	0.72 A±		DRIVE (T)	W.D.	10-6-80	BRADON	85	370	25' GRAVEL DRIVE M.P. 0598 DRIVE RELEASE DATE DRIVE PERMIT DATE		
			315+25 RT												
			317+25 RT	331+80 RT				CONST. EASE. (T) (0.32 A±)							
			318+50 RT 320+21 RT	331+27 RT				SLOPE (T) (0.42 A±) DRIVE (T)							16" GRAVEL DRIVE M.P. 0607 DRIVE RELEASE DATE DRIVE PERMIT DATE
			328+70 RT 329+00 RT	329+00 RT 330+25 RT			CUL. (P) DR. (P)								
1B			329+36 LI	334+00 LI	0.16 A±		SLOPE (T) (0.07 A±)						(2925 S.F.)		
			329+36 LI	332+35 LI				CONST. EASE. (T) (0.08 A±)						(3500 S.F.)	
			329+36 LI	332+85 LI											
1C			314+96 E	334+00 E	1.79 A±							HIGHWAY EASE. U.S. ROUTE 7			
2A	TOTI, ROBERT L. & RUTH M.	4,5	319+46 LI	329+36 LI	0.37 A±		DRIVE (T)	W.D.	10-30-80	BRANDON	85	387	14' GRAVEL DRIVE M.P. 0600 DRIVE RELEASE DATE DRIVE PERMIT DATE		
			316+25 LI												
			316+80 LI					DRIVE (T)						16' GRAVEL DRIVE M.P. 0601 DRIVE RELEASE DATE DRIVE PERMIT DATE	
			317+75 LI 319+00 LI	318+50 LI				SLOPE (T) (70 S.E±) DRIVE (T)							40' GRAVEL DRIVE M.P. 0605 DRIVE RELEASE DATE DRIVE PERMIT DATE
			319+35 LI 319+46 LI 319+75 LI 327+95 LI	329+36 LI 329+36 LI				CONST. EASE. (T) (0.27 A±) SLOPE (T) (0.88 A±) CUL. & DR. (P) DRIVE (T)							16' GRAVEL DRIVE M.P. 0622 DRIVE RELEASE DATE DRIVE PERMIT DATE
			328+00 LI					DRAINAGE (P)							
			314+96 E	329+36 E	1.09 A±										HIGHWAY EASE. U.S. ROUTE 7
3	NEW ENGLAND TELEPHONE & TELEGRAPH CO.												UTILITY		
4	CENTRAL VERMONT PUBLIC SERVICE CORP.												UTILITY		

TABLE OF REVISIONS

REVISION NO.	SHEET NO.	DESCRIPTION OF REVISION	DATE	MADE BY	APPROVED BY
1	3	PARCEL #2 TOTI, ADDED DRAINAGE RIGHT AT 326+00 LT PER C.O. # 4727	5-13-80	S.H.F.	T.P.M.
2	3,4 5	PARCEL #1A COUSINO, 1 2A TOTI, REMOVED 18" PIPE AT STA. 320+35 & ADDED UNDERDRAIN AT STA. 319+75 & 326+00 - 329+00 ADDED CUL. DRAIN RT'S. PER REVISED DESIGN & C.O. # 4784	8-13-80	B.A.M.	T.P.M.

MADE BY: S.A.M. DATE 4/24/80
CHECKED BY: W.E.B. DATE 4/24/80

DR. RT. - DRAINAGE RIGHT
DIT. RT. - DITCHING RIGHT
CH. RT. - CHANNEL RIGHT
DRIVE RT. - DRIVE RIGHT
CUL. RT. - CULVERT RIGHT
⊖ - DEMOLITION OR REMOVAL
W - WATER SOURCES

----- PRESENT R.O.W.
/// - - - - - TAKING WITHOUT ACCESS
--- P --- TAKING WITHOUT ACCESS ALONG PROPERTY LINES
--- - - - - TAKING WITH ACCESS
(P) PERMANENT EASEMENT
(T) TEMPORARY EASEMENT

LEGEND
----- CONST. EASE. ----- CONST. EASEMENT
--- SR --- SR --- SLOPE RIGHTS
--- P --- P --- PROPERTY LINE
--- Δ --- Δ --- TOP OF CUT
--- O --- O --- TOE OF SLOPE

APPROVED Thomas Y. Mayo DATE 4-24-80
CHIEF OF PLANS & TITLES

PROJECT BRANDON
NO. FR 019-3 (22)
SHEET 3 OF 5

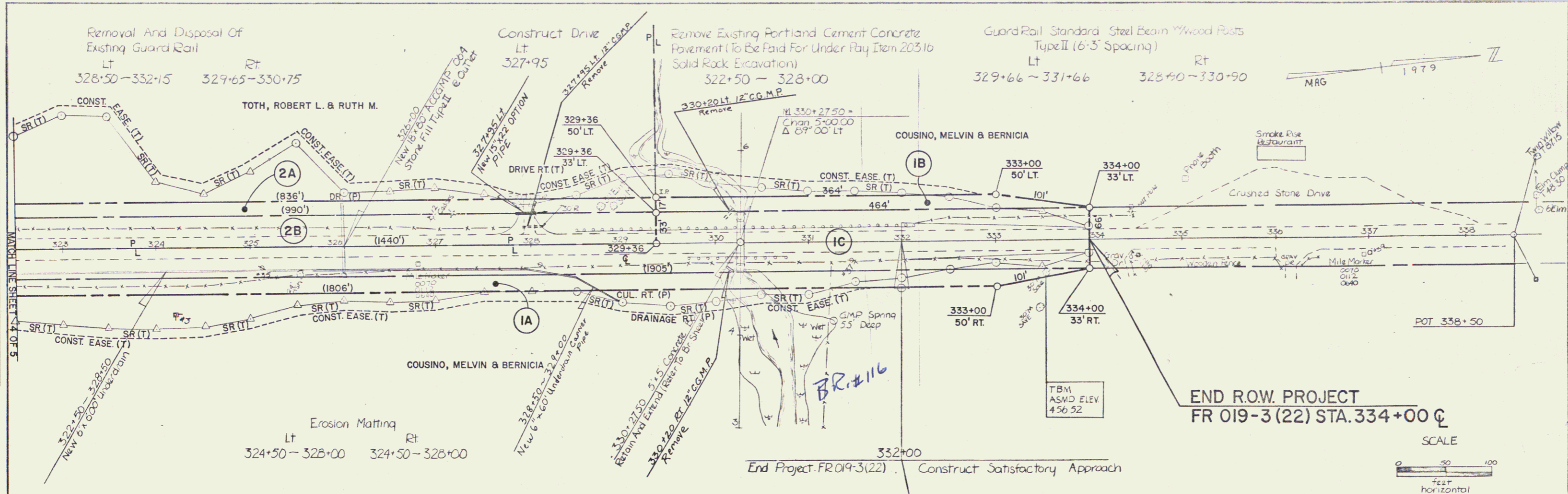

PLAN

DATE	
BY	
CHECKED	
APPROVED	
NOTED	
NO.	

PROFILE

DATE	
BY	
CHECKED	
APPROVED	
NOTED	
NO.	

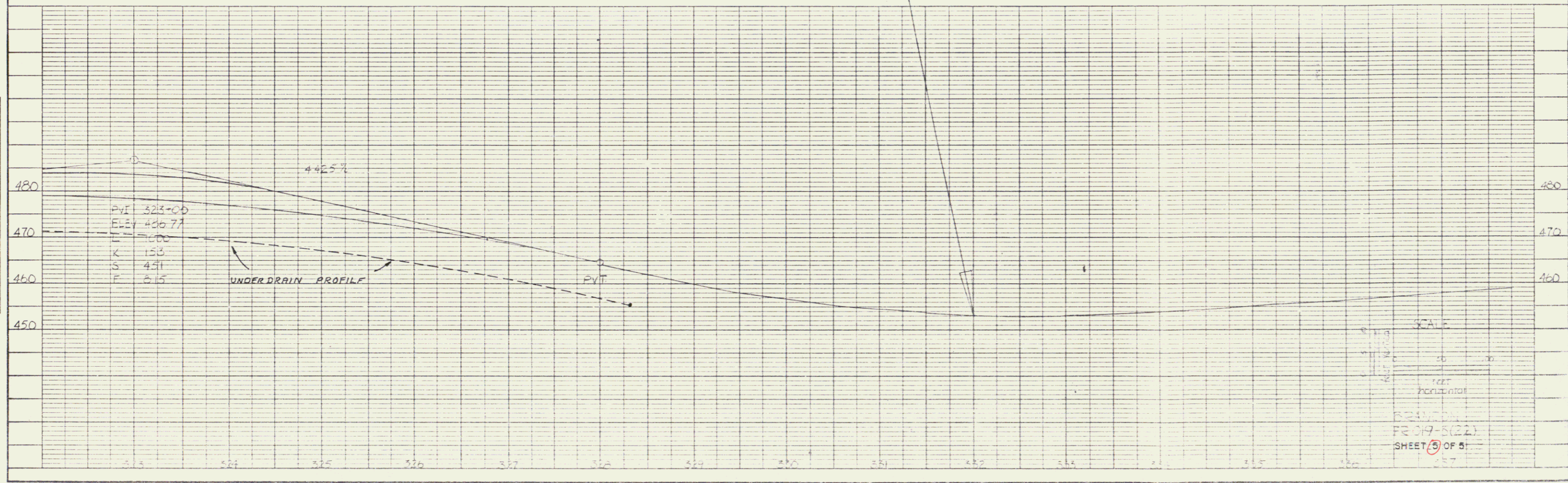

K&E PLATE 1, PLAN PROFILE
K&E & SON CO.

SCALE
1" = 10'
1" = 100'
FEET
HORIZONTAL

BRUNSON
PR 019-3(22)
SHEET 5 OF 5

5