

INDEX OF SHEETS
 1. FIELD SHEET
 2. DESIGN SECTION SHEET
 3. DRAINAGE AND QUANTITY SHEET
 4. LEGAL AND PAVEMENT SHEET
 5. SIGN SHEET
 6. EARTHWORK SHEET
 7. CONSTRUCTION SHEET

STATE OF VERMONT
 DEPARTMENT OF HIGHWAYS



PROPOSED IMPROVEMENT
TOWNS OF MARSHFIELD-CABOT
 COUNTY OF WASHINGTON
U.S. ROUTE 2

R.O.W. PLANS

BEGINNING AT A POINT APPROXIMATELY 0.296 MILES
 SOUTHWESTERLY OF THE MARSHFIELD-CABOT TOWN
 LINE AND EXTENDING NORTHEASTERLY 0.539 MILES.

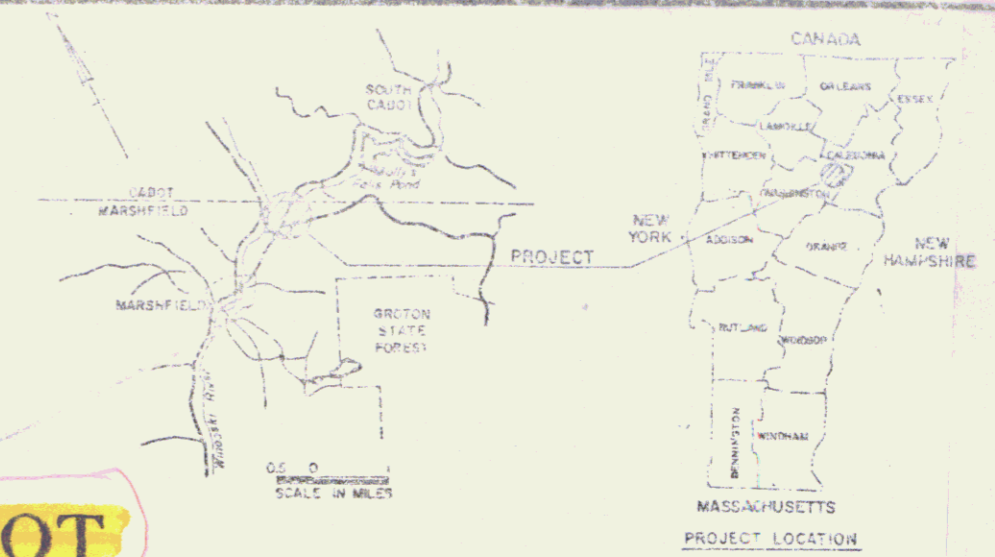

*Danville
 BRFO283 (19)S
 ST JCL R/Skyry
 F 028-4(2)*

MP 7.89
 BEGIN R.O.W. PROJ. TQF 028-3 (9)
 STA. 422+25 @

LENGTH OF R.O.W.	PROJ.	2060.54 FEET	0.391 MILES
1977	FACT = 1790		
1677	CHV = 253		
1657	AAST = 2275		
1287	DNV = 325		
	S = 14%		
	T = 5%		
	V = 50 MPH		

MP 0.08
 END R.O.W. PROJ. TQF 028-3(9)
 STA. 443+00 @

- CONVENTIONAL SIGNS
- COUNTY LINE
 - TOWN LINE
 - LINE OF ACCESS
 - POINT OF ACCESS
 - FENCE LINE
 - SIGNED WALL
 - TRAVELLED PIV
 - GRASS RAIL
 - RAILROAD
 - SURF IN LINE
 - CLINCH
 - POWER POLE
 - TELEPHONE POLE
 - TRIP
 - WATER
 - WELL
 - WATER
 - WATER
 - WATER

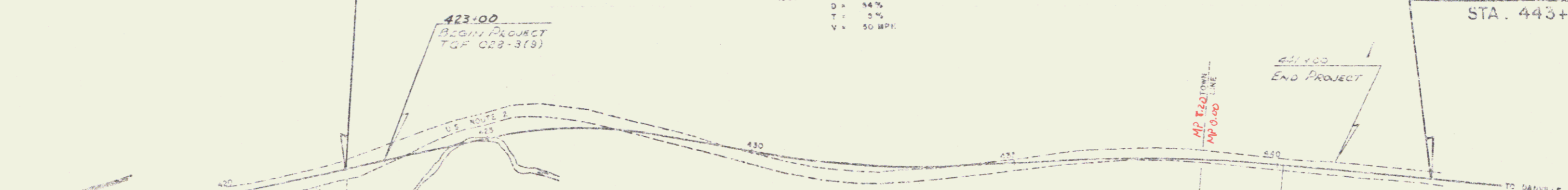

RIGHT-OF-WAY DIVISION
 TOWN FILE
 PERPETUAL
 Town of _____
 (To Be Returned To R.O.W. Division)

*Marshfield
 7.89 to 8.20
 0.04 Pin # 766138*

These plans are subject to such engineering changes
 as may be required by the Federal Highway Administration
 or the Client Engineer.
 Construction is to be carried on in accordance with these
 plans and the Standard Specifications for Highway and
 Bridge Construction dated March, 1976, as approved by the
 Federal Highway Administration on October 27, 1976, for
 use on the project, including all subsequent revisions and
 such revised specifications and special provisions as are
 incorporated in the plans.

SUBMITTED BY ORDER OF THE STATE TRANSPORTATION BOARD

APPROVED: 10/3/77 DATE

DEPARTMENT OF TRANSPORTATION
 FEDERAL HIGHWAY ADMINISTRATION

APPROVED: _____ DATE

DIVISION ADMINISTRATOR

PROJECT TOP NO. 028-3 (9)

SHEET 1 OF 5 SHEETS

STATE OF VERMONT
DEPARTMENT OF HIGHWAYS
RIGHT-OF-WAY PLANS
DETAIL SHEET

TABLE OF PROJECT PROPERTY ACQUISITION

PARCEL NO.	GRANTOR	SHEET NO.	BEGINNING STATION	ENDING STATION	TAKING	REM.	RIGHTS	TITLE TAKEN	DATE	TOWN OR CITY RECORDED	BK.	PG.	REMARKS
1A	SWOZT, WALTER F. JR. & ADA (H&W) & DIMATTEO, THOMAS J. & JACQUELINE G. (H&W)	4	427+25 RT. 423+00 RT. REV. 425+35 RT. REV. 420+00 RT. REV. 429+50 RT. REV. 424+16 RT. REV. 432+57 RT.	REV. 429+21 RT. REV. 428+00 RT. REV. 431+86 RT.	0.31 AC		CHANNEL (P) SLOPE (T) (0.17 A±) CULVERT & DRAINAGE (P) CULVERT & DRAINAGE (P) DITCH (P) SLOPE (T) (20 S.F.±)	WD	4/29/78	MARSHFIELD	32	221	
1B		5	REV. 434+43 RT. REV. 433+10 RT. REV. 430+86 RT.	REV. 438+53 RT. REV. 438+52 RT.	0.09 AC		SLOPE (P) (0.51 A±) CULVERT, DITCH, & DRAINAGE (P)						(39005 S.F.±)
2	KENNETH A. ROGERS & SON, INC.	4,5	REV. 427+68 LT. REV. 427+40 LT. REV. 437+00 LT. REV. 430+58 LT.	REV. 430+56 LT. REV. 425+38 LT. REV. 438+56 LT.	0.35 AC		SLOPE (P) (0.73 A±) CULVERT (P) SLOPE (T) (0.13 A±)	WD	3/18/78	MARSHFIELD	32	159-160	
3	WOOD, GEORGE H.	5	REV. 438+55 LT. REV. 438+55 LT. REV. 439+95 LT.	REV. 439+95 LT. REV. 439+04 LT.	0.02 AC		SLOPE (T) (300 S.F.±) DRIVE (T)	OPTION	8/29/78	MARSHFIELD	38	489	(100 S.F.±)
4A	ASHCRAFT, THOMAS W.	5	REV. 438+52 RT. REV. 438+50 RT. 442+36 RT. 441+00 RT.	441+00 RT. REV. 439+92 RT.	0.07 AC		SLOPE (P) (0.08 A±) DITCH (P) DRIVE (T)	WD	4/20/78	CABOT	38	473	(3200 S.F.±) (2600 S.F.±)
4B		5	REV. 439+82 LT. REV. 440+00 LT. REV. 439+85 LT.	443+00 LT. 443+00 LT.	0.04 AC		SLOPE (T) (0.13 A±) DRIVE (T)						(1730 S.F.±)
5	GREEN WOODEN POWER COMPANY												UTILITY
6	CONTINENTAL TELEPHONE COMPANY OF VT., INC.												UTILITY

TABLE OF REVISIONS

REVISION NO.	SHEET NO.	DESCRIPTION OF REVISION	DATE	MADE BY	APPROVED BY
1	3	REVISED DETAIL SHEET SO PARCEL # 1 TITLE READS AS FOLLOWS: SWOZT, WALTER F. JR. & ADA (H&W) & DIMATTEO, THOMAS J. & JACQUELINE G. (H&W) AND PARCEL # 2 TITLE READS AS FOLLOWS: KENNETH A. ROGERS & SON, INC. PER C.O.# 3531	11/8/77	KDP	T.P.D.
2	3	PARCEL # 1B KENNETH A. ROGERS & SON, INC. REVISED SLOPE RIGHTS FROM (T) TO (P) PER C.O.# 3532	11/8/77	KDP	T.P.D.
3	3	PARCEL # 4A ASHCRAFT REVISED SLOPE RIGHTS FROM (T) TO (P) PER C.O.# 3534	11/11/77	KDP	T.P.D.
4	3	PARCEL # 2 DIMATTEO & SWOZT REVISED SLOPE RIGHTS TO READ AS FOLLOWS: REV. 427+40 LT. - REV. 435+00 LT. (0.73 A±) (P) & REV. 435+38 LT. - REV. 438+56 LT. (0.13 A±) (T) PER C.O.# 3533	11/11/77	KDP	T.P.D.
5	365	Parcel # 4, Ashcraft, Added Drive at 44+00 RT. PER C.O.# 3664	2/22/78	H.G.S.	T.P.D.

MADE BY: K.D. PERKINS DATE: 12-1-77
CHECKED BY: W.E. BELLIN DATE: 10-1-77

DR RT - DRAINAGE RIGHT
DT RT - DITCHING RIGHT
OR RT - CURB/RAIL RIGHT
DRIVE RT - DRIVE RIGHT
CUL. RT - CULVERT RIGHT
DEMOLITION OR REPAIR
WATER STORAGE

PRESENT R.O.W.
TAKING WITHOUT ACCESS
TAKING WITHOUT ACCESS ALONG PROPERTY LINES
TAKING WITH ACCESS
PERMANENT EASEMENT
TEMPORARY EASEMENT

LEGEND

SR - SR - SLOPE RIGHTS
P - P - PROPERTY LINE
TOP OF CUT
TOP OF SLOPE

APPROVED: [Signature] DATE: 12-2-77
ACTING CHIEF OF SURVEY & TITLES

PROJECT: MARSHFIELD - CABOT
NO. 10E008-3 (9)
SHEET 3 OF 4

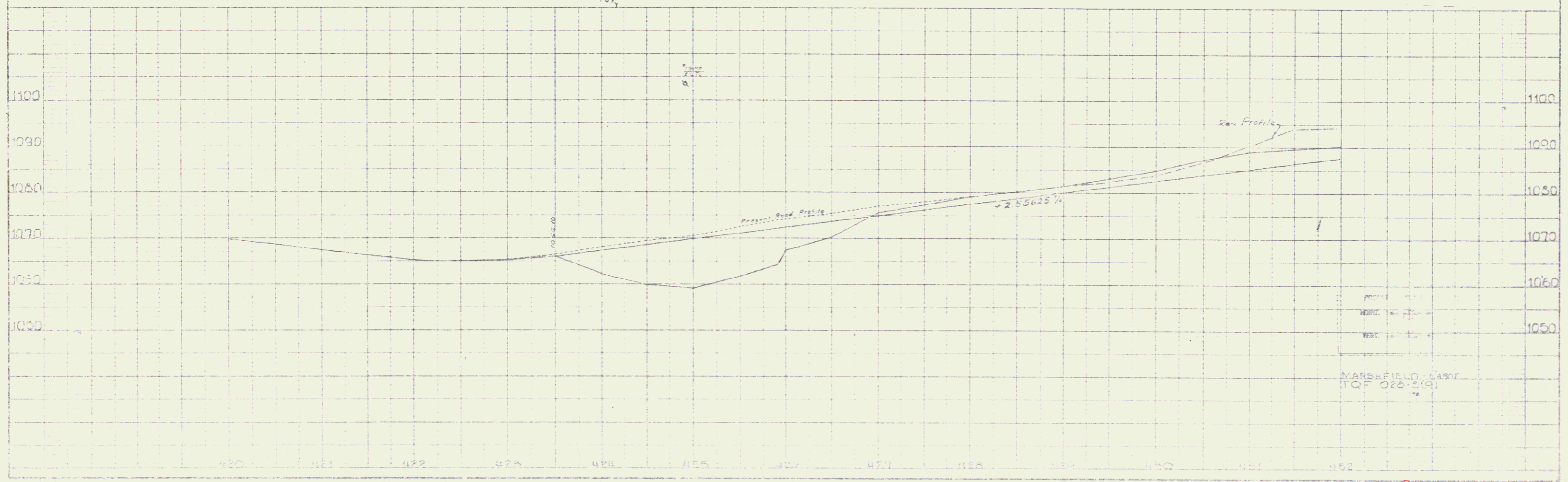
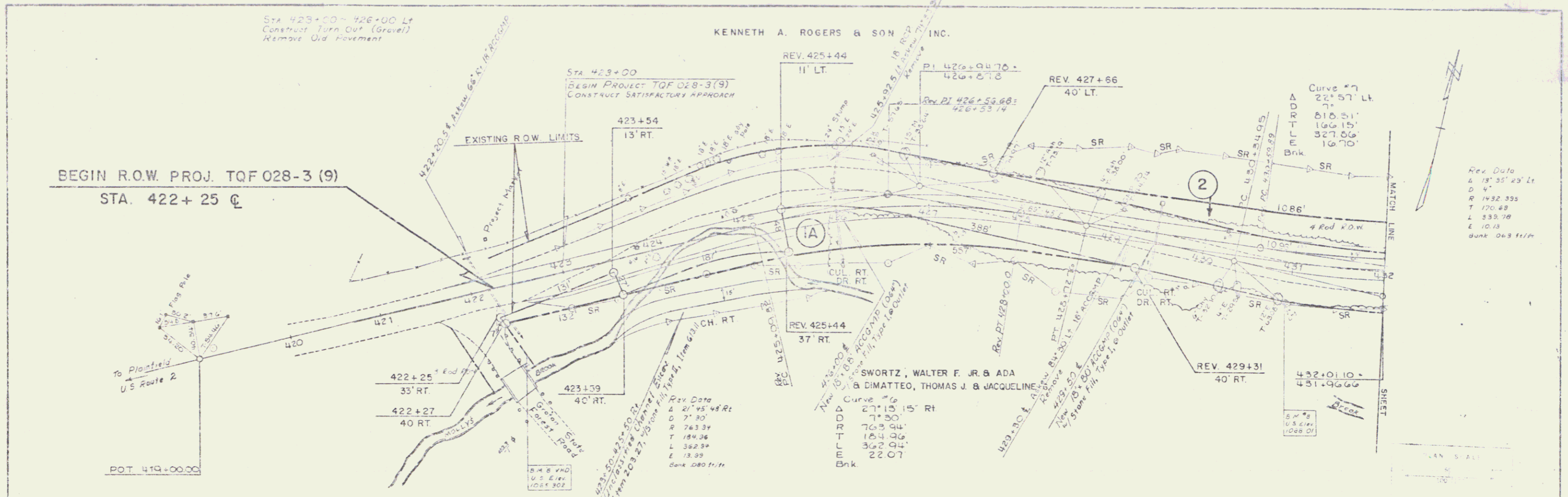

1/2" = 10' HORIZ. PLAN/PROFILE

3

FILED
 NOTES
 DATE
 DRAWN BY
 CHECKED BY

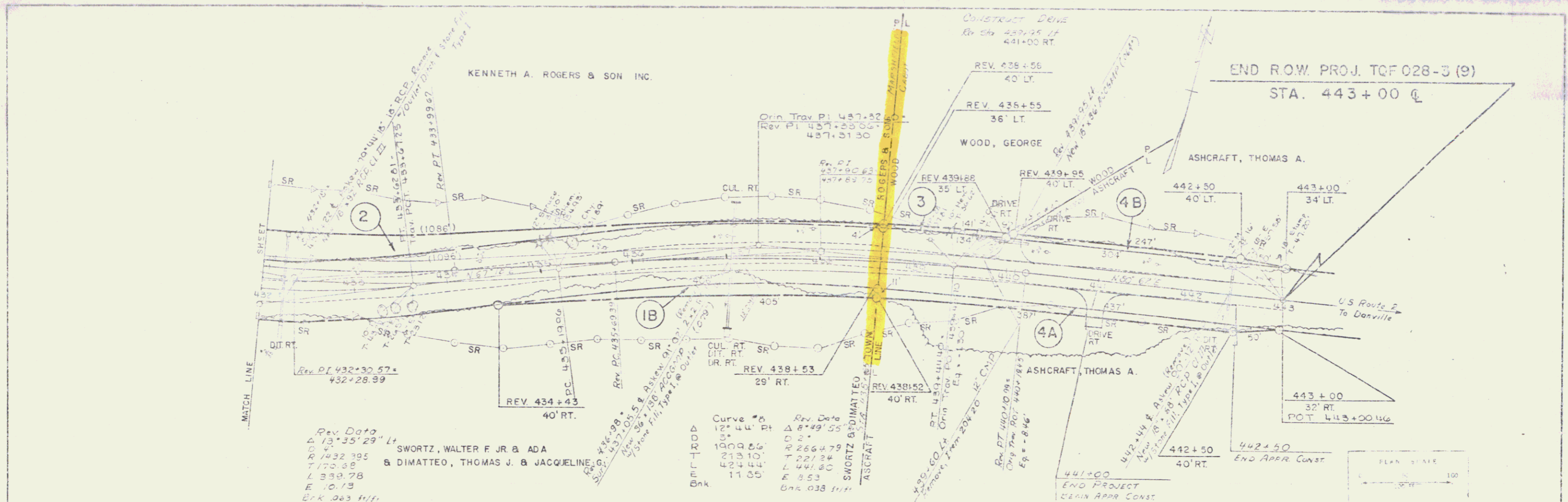

Rev. Data
 Δ 13° 35' 29" Lt
 D 1432.395
 T 170.88
 L 359.78
 E 10.73
 B.K. 063 H/F

SWORTZ, WALTER F. JR. & ADA
 & DIMATTEO, THOMAS J. & JACQUELINE

Curve #	Rev. Data
12° 44' 18"	Δ 8° 49' 55"
100.0	D 3.0
213.10	T 221.24
424.44	L 441.60
11.05	E 8.53
B.K.	B.K. 038 H/F

FILED
 NOTES
 DATE
 DRAWN BY
 CHECKED BY

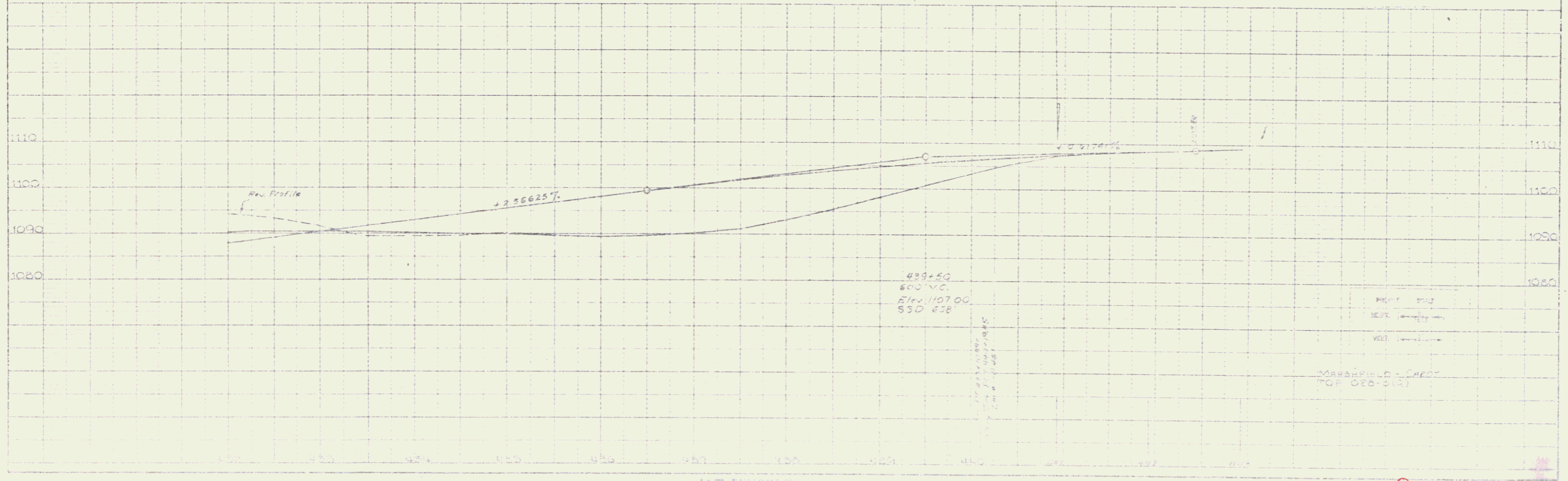

RIGHT OF WAY
 CENTERLINE
 UTILITY

MARSHFIELD - CHECK
 TOP 028-5(3)

KE

SHEET 5 OF 5 SHEETS

4