

- INDEX OF SHEETS
- 1 Title
 - 2 Typical Sheet
 - 3 Summary of Items
 - 4 Drainage Items & details
 - 5 Earthworks
 - 6 Plans & Profile
 - 7 Tie Sheet
 - 8-9 Blank
 - 10-23 X-Sections, Mainline
 - 24-27 X-Sections, T-19

#

232

RIGHT-OF-WAY DIVISION
TOWN FILE
PERPETUAL
Town of Marshfield
(To Be Returned To R.O.W. Division)
MP = 1.48 to 1.81
R.O.W. PLANS

STATE OF VERMONT
DEPARTMENT OF HIGHWAYS



PROPOSED IMPROVEMENT
TOWN OF MARSHFIELD
COUNTY OF WASHINGTON

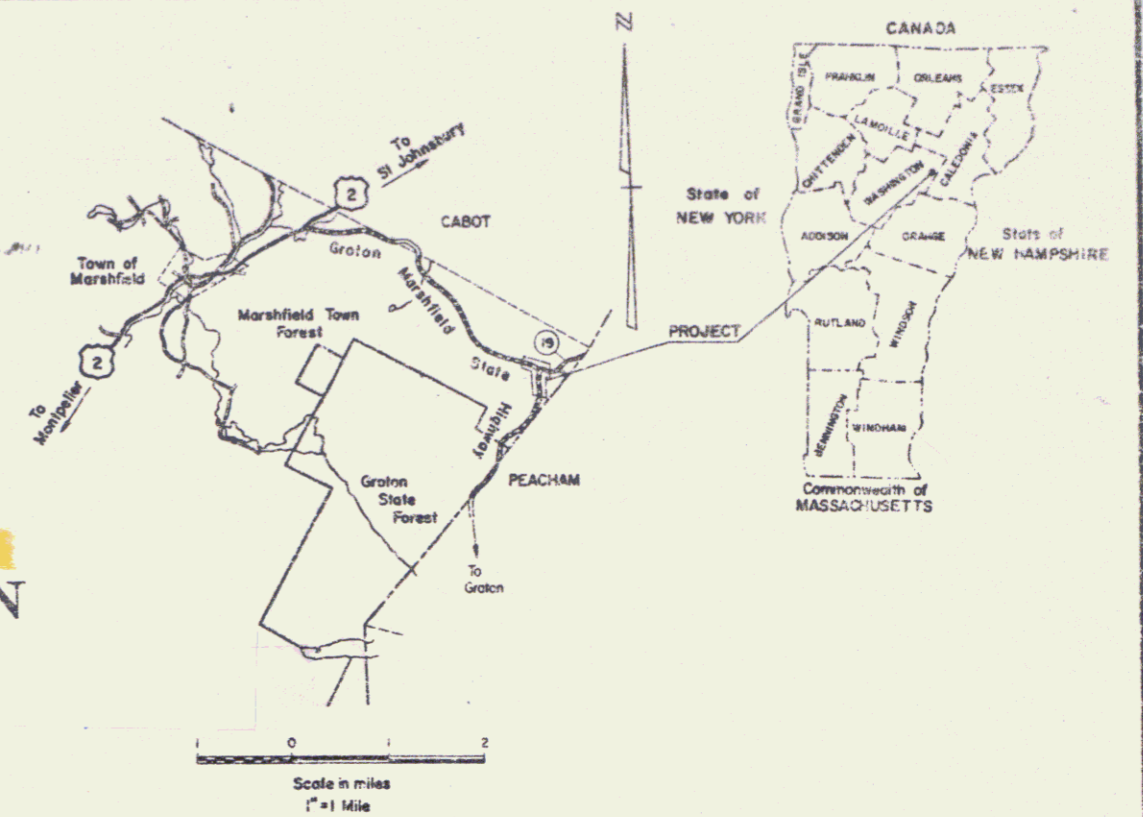

GROTON-MARSHFIELD STATE HIGHWAY
BEGINNING AT A POINT APPROXIMATELY 1.40 MILES SOUTHWESTERLY OF THE INTERSECTION OF GROTON STATE HIGHWAY AND TOWN HIGHWAY 19 AND PROCEEDING NORTH AND WESTERLY 0.331 MILES.
LENGTH OF PROJECT = 1749.00 FEET = 0.331 MILES
LENGTH OF R.O.W. PROJECT = 2149.80 FEET = 0.407 MILES

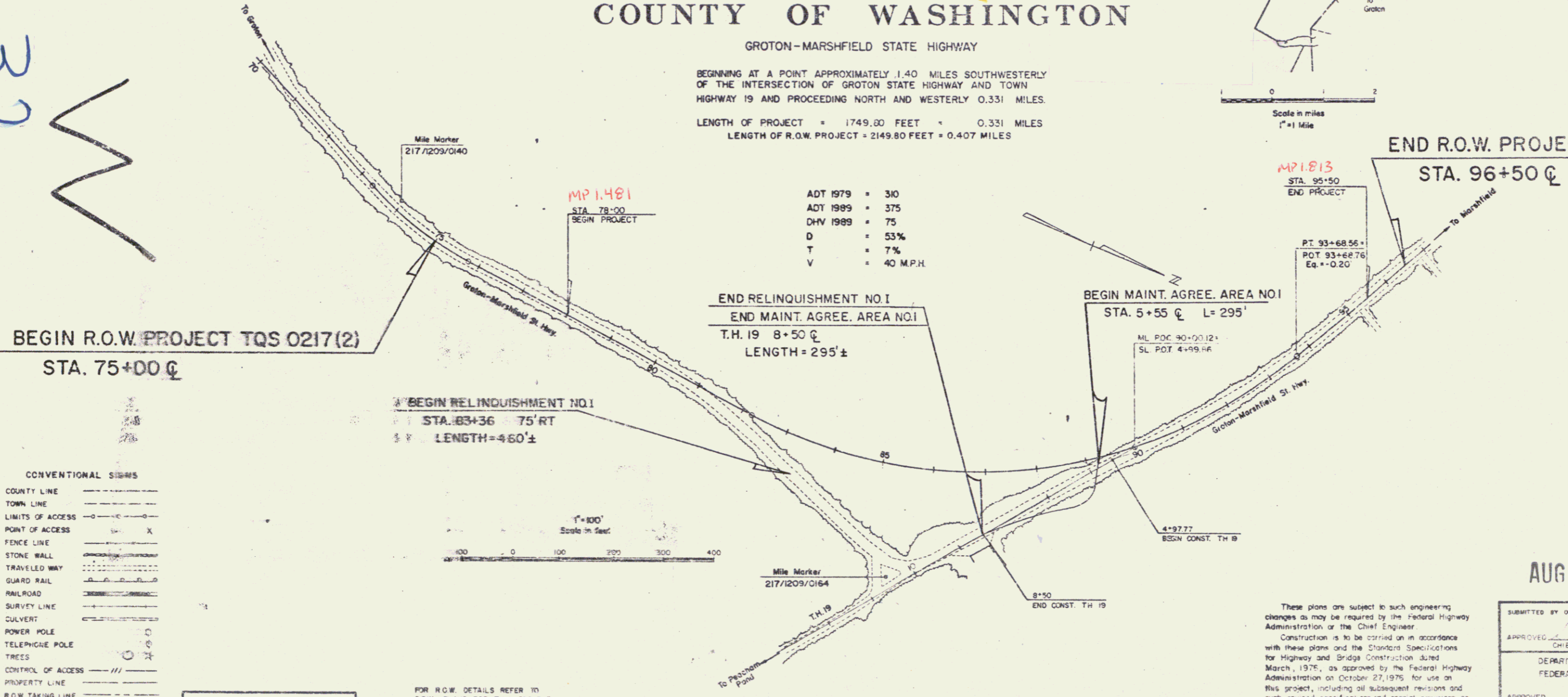

- CONVENTIONAL SIGNS
- COUNTY LINE
 - TOWN LINE
 - LIMITS OF ACCESS
 - POINT OF ACCESS
 - FENCE LINE
 - STONE WALL
 - TRAVELED WAY
 - GUARD RAIL
 - RAILROAD
 - SURVEY LINE
 - CULVERT
 - POWER POLE
 - TELEPHONE POLE
 - TREES
 - CONTROL OF ACCESS
 - PROPERTY LINE
 - R.O.W. TAKING LINE
 - SLOPE RIGHTS
 - TOP OF CUT
 - TOE OF SLOPE

DATUM
VERTICAL: 1975 ADJUSTMENT
HORIZONTAL: N/A

FOR R.O.W. DETAILS REFER TO R.O.W. PLANS FOR THIS PROJECT

ADT 1979	=	310
ADT 1989	=	375
DHV 1989	=	75
D	=	53%
T	=	7%
V	=	40 M.P.H.

Pin # 76F123
Route VT232
Date 2/9/1978

AUG 19 1978

These plans are subject to such engineering changes as may be required by the Federal Highway Administration or the Chief Engineer. Construction is to be carried on in accordance with these plans and the Standard Specifications for Highway and Bridge Construction dated March, 1976, as approved by the Federal Highway Administration on October 27, 1975 for use on this project, including all subsequent revisions and such revised specifications and special provisions as are incorporated in these plans.

APPROVED: _____
R.O.W. DIRECTOR
DATE: 2-9-78

PROJECT: TQS 0217(2)
SHEET 1 OF 6 SHEETS
DWG. SRE 0217(2)

SUBMITTED BY ORDER OF THE STATE TRANSPORTATION BOARD
APPROVED: _____ DATE: 2-9-78
CHIEF ENGINEER
DEPARTMENT OF TRANSPORTATION
FEDERAL HIGHWAY ADMINISTRATION
APPROVED: _____ DATE: _____
DIVISION ADMINISTRATOR