

INDEX OF SHEETS

1	General Notes	4-20-79
2	Proposed Right-of-Way	4-20-79
3	Proposed Roadway	4-20-79
4	Proposed Drainage	4-20-79
5	Proposed Utilities	4-20-79
6	Proposed Structures	4-20-79
7	Proposed Signs	4-20-79
8	Proposed Easements	4-20-79
9	Proposed Survey	4-20-79
10	Proposed Construction	4-20-79
11	Proposed Maintenance	4-20-79
12	Proposed Safety	4-20-79
13	Proposed Environment	4-20-79
14	Proposed Aesthetics	4-20-79
15	Proposed Noise	4-20-79
16	Proposed Air Quality	4-20-79
17	Proposed Energy	4-20-79
18	Proposed Water Resources	4-20-79
19	Proposed Cultural Resources	4-20-79
20	Proposed Historical Resources	4-20-79
21	Proposed Archaeological Resources	4-20-79
22	Proposed Paleontological Resources	4-20-79
23	Proposed Biological Resources	4-20-79
24	Proposed Wetlands	4-20-79
25	Proposed Flood Hazard	4-20-79
26	Proposed Seismicity	4-20-79
27	Proposed Landslide	4-20-79
28	Proposed Rockfall	4-20-79
29	Proposed Snow Accumulation	4-20-79
30	Proposed Ice Accumulation	4-20-79
31	Proposed Wind Accumulation	4-20-79
32	Proposed Other Hazards	4-20-79

STATE OF VERMONT  
• AGENCY OF TRANSPORTATION



PROPOSED IMPROVEMENT  
TOWN OF EAST MONTPELIER  
COUNTY OF WASHINGTON  
VT. RTE. 14

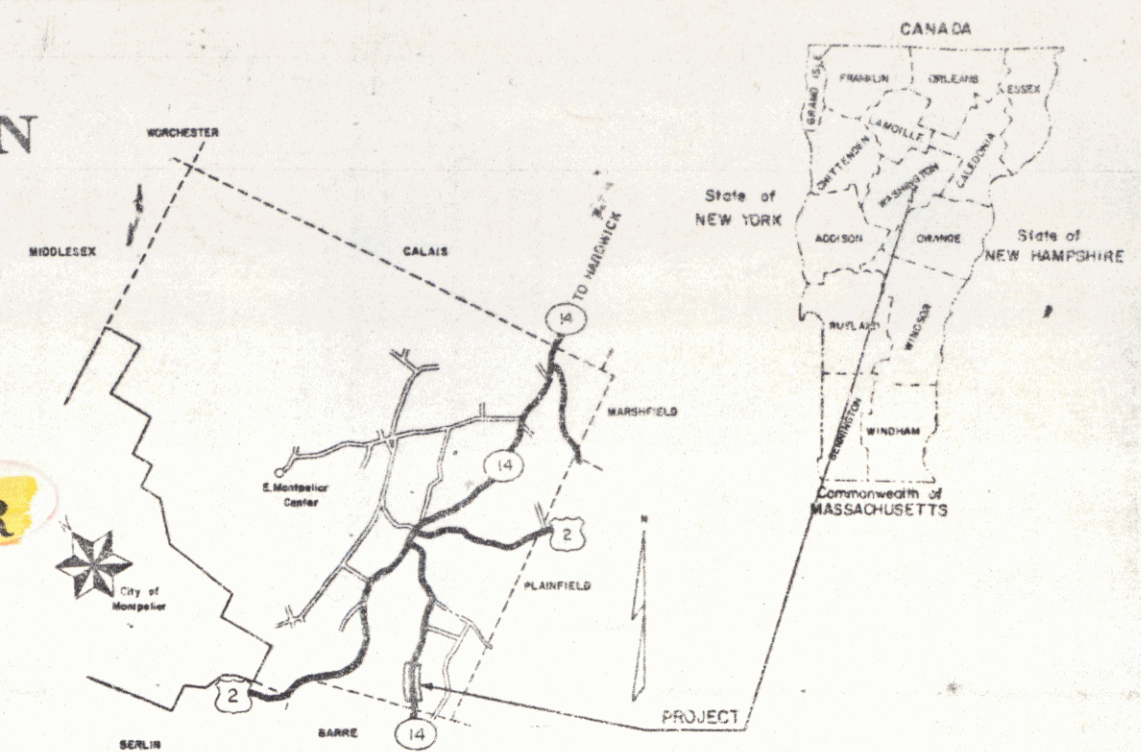

R.O.W. PLANS

Beginning at a point 600 feet North of the  
Barre-East Montpelier Town Line and extending Northerly 0.528 miles.

Length of Roadway 2785.91 ft = 0.528 mi.  
Length of Project 2785.91 ft = 0.528 mi.  
LENGTH OF R.O.W. PROJECT = 3217.91 FEET = 0.609 MILES

Traffic Data

1990 ADT	2670
1985 ADT	2950
1985 DHV	410
D	58%
T	4%

BEGIN R.O.W. PROJECT TQF 037-2(2)  
STA. 103+00 CL

END R.O.W. PROJECT TQF 037-2(2)  
STA. 135+12 LT

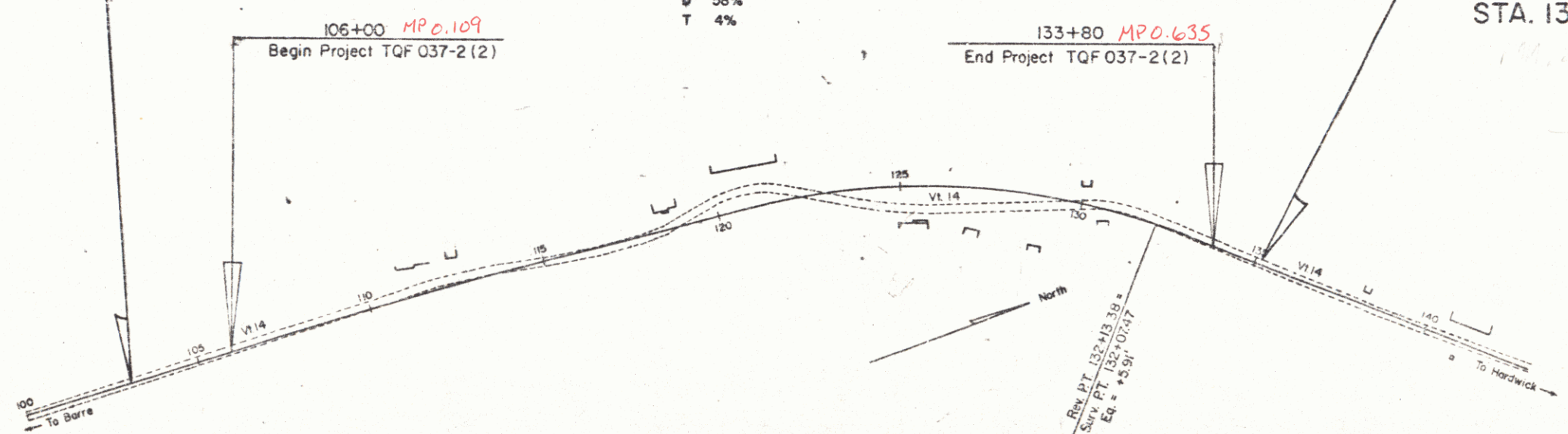

CONVENTIONAL SIGNS

COUNTY LINE	---
TOWN LINE	- - - -
LIMITS OF ACCESS	○
POINT OF ACCESS	X
FENCE LINE	— · — · — ·
STONE WALL	— · — · — ·
TRAVELED WAY	— · — · — ·
GUARD RAIL	— · — · — ·
RAILROAD	— · — · — ·
SURVEY LINE	— · — · — ·
CULVERT	— · — · — ·
POWER POLE	○
TELEPHONE POLE	○
TREES	○
CONTROL OF ACCESS	— · — · — ·
PROPERTY LINE	— · — · — ·
ROW TAKING LINE	— · — · — ·
SLOPE RIGHTS	— · — · — ·
TOP OF CUT	— · — · — ·
TOE OF SLOPE	— · — · — ·

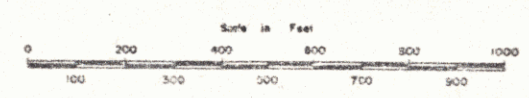

REV. PT. 132+43.39  
NEW PT. 132+10.00  
EN. = +3.91'

These plans are subject to such engineering changes as may be required by the Federal Highway Administration or the Director of Engineering & Construction. Construction is to be carried on in accordance with these plans and the Standard Specifications for Highways and Bridge Construction dated March, 1978, as approved by the Federal Highway Administration on October 27, 1975 for use on this project, including all subsequent revisions and such revised specifications and special provisions as are incorporated in these plans.

Plan # 76F119

APPROVED  
CHIEF, PROPERTY ADMINISTRATION  
1-26-79

APPROVED BY ORDER OF THE STATE TRANSPORTATION BOARD  
Director of Engineering and Construction  
DEPARTMENT OF TRANSPORTATION  
FEDERAL HIGHWAY ADMINISTRATION

PROJECT TQF 037-2(2)  
SHEET 1 OF 8 SHEETS