

INDEX OF SHEETS  
 1. Title - Typical  
 2. South by Discharge  
 3. Plan Profile  
 4-9 Cross Sections

STATE OF VERMONT  
 DEPARTMENT OF HIGHWAYS



PROPOSED IMPROVEMENT  
 FEDERAL AID SECONDARY HIGHWAY PROJECT

TOWN OF BRADFORD  
 COUNTY OF ORANGE

ROUTE NO: 25-B LOG STA. 45+00

PROJECT LOCATION: Beginning approx. 0.2 mi. southwesterly of intersection of U.S. 5 and Vt. Rte 25-B proceeding northeasterly 418' along Rte 25-B  
 PROJECT DESCRIPTION: This project consists of replacing an existing 38' x 5.5' stone box with a new 70' x 3' CSMPA installation of new guard rail if additional drainage.

LENGTH OF STRUCTURE: FEET  
 LENGTH OF PARTICIPATION ROADWAY: 418.0 FEET  
 LENGTH OF NON-PARTICIPATION ROADWAY: FEET  
 LENGTH OF PROJECT: 418.0 FEET  
 LENGTH OF ROW PROJECT: 418 FEET = 0.079 MILES

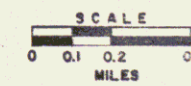
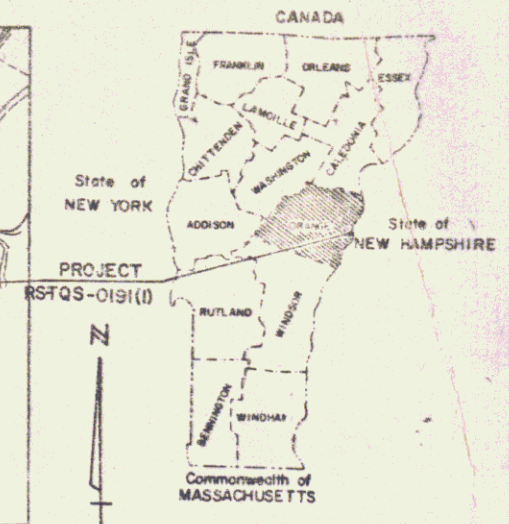
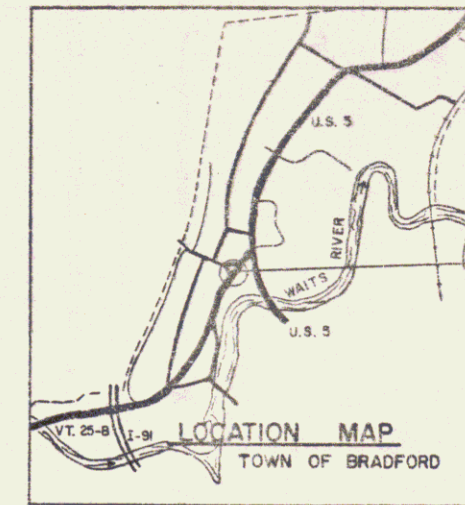

GENERAL NOTES:

SEED, Item 651.10 (To be applied as directed by the Engineer.)

QNT	LBS/A	NAME	PUR. %	GERM %
3.33	2	Crown Vetch	97	75
50.00	3C	Creeping Red Fescue	98	85
8.33	5	Timothy	99	85
16.67	10	Perennial Rye Grass (Var Pennfine)	95	85
8.34	5	Alfalfa (Var. Saranac)	99	85
8.33	5	Birdsfoot Trefoil (Var Empire)	98	85
5.00	3	Highland Bent Grass	92	85
100.00		60 Lbs/Acre		

The seed mixture shall not have a weed content exceeding 0.40% by weight and shall be free of all noxious weed seed.  
 MARKER POSTS, (Wood or Steel as specified) (To be placed as directed by the Engineer)  
 FERTILIZER, Item 651.15  
 Formula 10-20-10 to be used with seed (Item 651.10) applied at the rate of 500 lbs./Acre.  
 AGRICULTURAL LIMESTONE, Item 651.20  
 To be applied at the rate of 2 tons/acre or as directed by the Engineer.  
 HAY MULCH, Item 651.25  
 To be placed on earth slopes at the rate of 2 tons/acre  
 SOIL, Item 651.1C  
 To be used with seed, Item 651.10, in residential areas, as directed by the Engineer.

See Standard B-5 for Typical Slope Rounding

R.O.W. PLANS

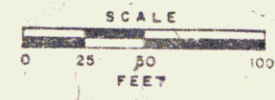
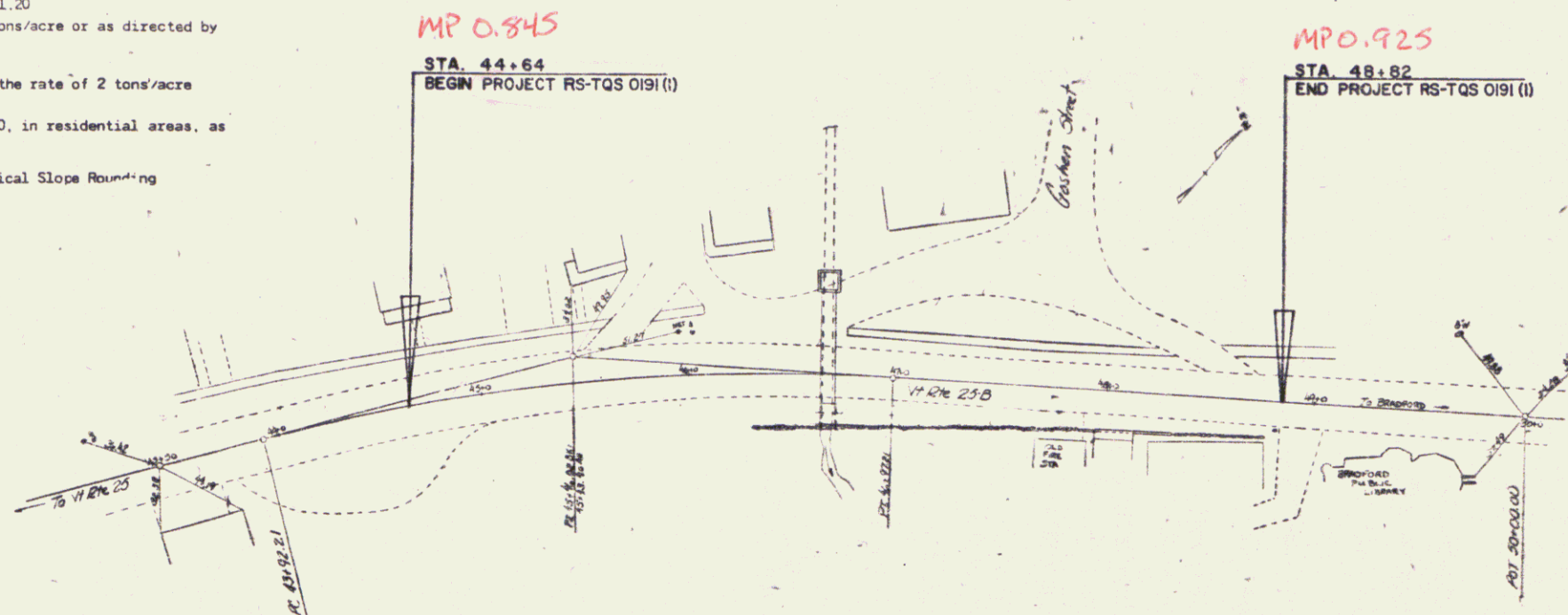

CONVENTIONAL SIGNS

COUNTY LINE	---
TOWN LINE	---
LIMITS OF ACCESS	---
POINT OF ACCESS	X
FENCE LINE	---
STONE WALL	---
TRAVELED WAY	---
GUARD RAIL	---
RAILROAD	---
SURVEY LINE	---
CULVERT	---
POWER POLE	○
TELEPHONE POLE	○
TREES	○
F.A. CONST. IDENTIFICATION SIGNS	▲
PROPERTY LINE	---
ROW TAKING LINE	---
SLOPE RIGHTS	---
TOR OF CUT	---
TOE OF SLOPE	---

Traffic Data

VT 25-B	Goshen Rd
1980 ADT	2370
1990 ADT	3110
1990 DIV	430
D	62%
T	1%
V	30MPH

RIGHT-OF-WAY DIVISION  
 TOWN FILE  
 PERPETUAL

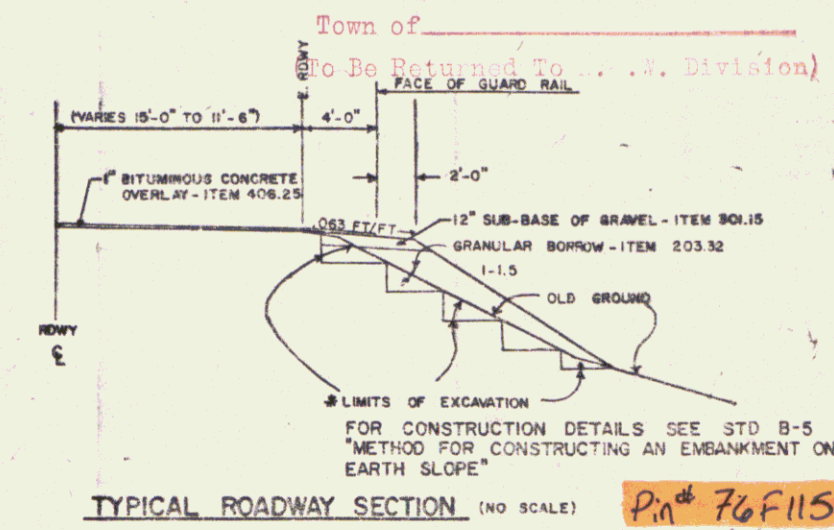

\* NOTE: PAYMENT FOR EXCAVATION TO BE SUBSIDIARY TO GRANULAR BORROW, ITEM 203.32 SEE SPECIAL PROVISIONS

These plans are subject to such engineering changes as may be required by the Federal Highway Administration or the Director of Engineering and Construction.  
 Construction is to be carried on in accordance with these plans and the Standard Specifications for Highway and Bridge Construction dated March, 1976, as approved by the Federal Highway Administration on October 27, 1976 for use on this project, including all subsequent revisions and such revised specifications and special provisions as are incorporated in these plans.

PROJECT PROCESSED UNDER  
 SECONDARY ROAD PLAN

SUBMITTED BY ORDER OF THE STATE TRANS. BOARD  
 APPROVED: *A.J. Gage* DATE: JAN 17 1980  
 DIRECTOR OF ENGINEERING AND CONSTRUCTION  
 DEPARTMENT OF TRANSPORTATION  
 FEDERAL HIGHWAY ADMINISTRATION  
 APPROVED: \_\_\_\_\_ DATE: \_\_\_\_\_  
 DIVISION ADMINISTRATOR

APPROVED: *[Signature]*  
 CHIEF PROPERTY ADMINISTRATION  
 DATE: 1-15-80

PROJECT RS-TQS-0191 (I)  
 SHEET 1 OF 3 SHEETS

STATE OF VERMONT  
DEPARTMENT OF HIGHWAYS  
RIGHT-OF-WAY PLANS  
DETAIL SHEET

TABLE OF PROJECT PROPERTY ACQUISITION

PARCEL NO.	GRANTOR	SHEET NO.	BEGINNING STATION	ENDING STATION	TAKING	REM	RIGHTS	TITLE TAKEN	DATE	TOWN OR CITY RECORDED	BK.	PG.	REMARKS
1	CENTRAL VERMONT PUBLIC SERVICE CORP.		45+74 RT	46+13 RT			SLOPE (T) (190SF±)						LETTER AUTHORIZATION
2	WELCH, PHOEBE H.		46+10 RT	46+27 RT			SLOPE (P) (40SF±)	W.D.E.	4-30-80	BRADFORD	51	450-451	
3	VILLAGE OF BRADFORD WATER CO.												UTILITY
4	VILLAGE OF BRADFORD SEWER CO.												UTILITY

TABLE OF REVISIONS

REVISION NO.	SHEET NO.	DESCRIPTION OF REVISION	DATE	MADE BY	APPROVED BY

MADE BY: \_\_\_\_\_ DATE \_\_\_\_\_  
CHECKED BY: \_\_\_\_\_ DATE \_\_\_\_\_

DR. RT - DRAINAGE RIGHT  
DIT. RT - DITCHING RIGHT  
CH. RT - CHANNEL RIGHT  
DRIVE RT - DRIVE RIGHT  
CUL. RT - CULVERT RIGHT  
Ⓞ - DEMOLITION OR REMOVAL  
W - WATER SOURCES

----- PRESENT R.O.W.  
/// --- /// TAKING WITHOUT ACCESS  
/// P L --- /// TAKING WITHOUT ACCESS ALONG PROPERTY LINES  
----- TAKING WITH ACCESS  
(P) PERMANENT EASEMENT  
(T) TEMPORARY EASEMENT

LEGEND  
----- CONST. EASE. ----- CONST. EASEMENT  
SR ----- SR ----- SLOPE RIGHTS  
P ----- P ----- PROPERTY LINE  
-Δ- Δ- Δ- TOP OF CUT  
-O- O- O- TOE OF SLOPE

APPROVED *Thomas P. Maguire* DATE 1-13-80  
CHIEF OF PLANS & TITLES

PROJECT BRADFORD  
NO. RS-TQS 0191 (1)  
SHEET 2 OF 3

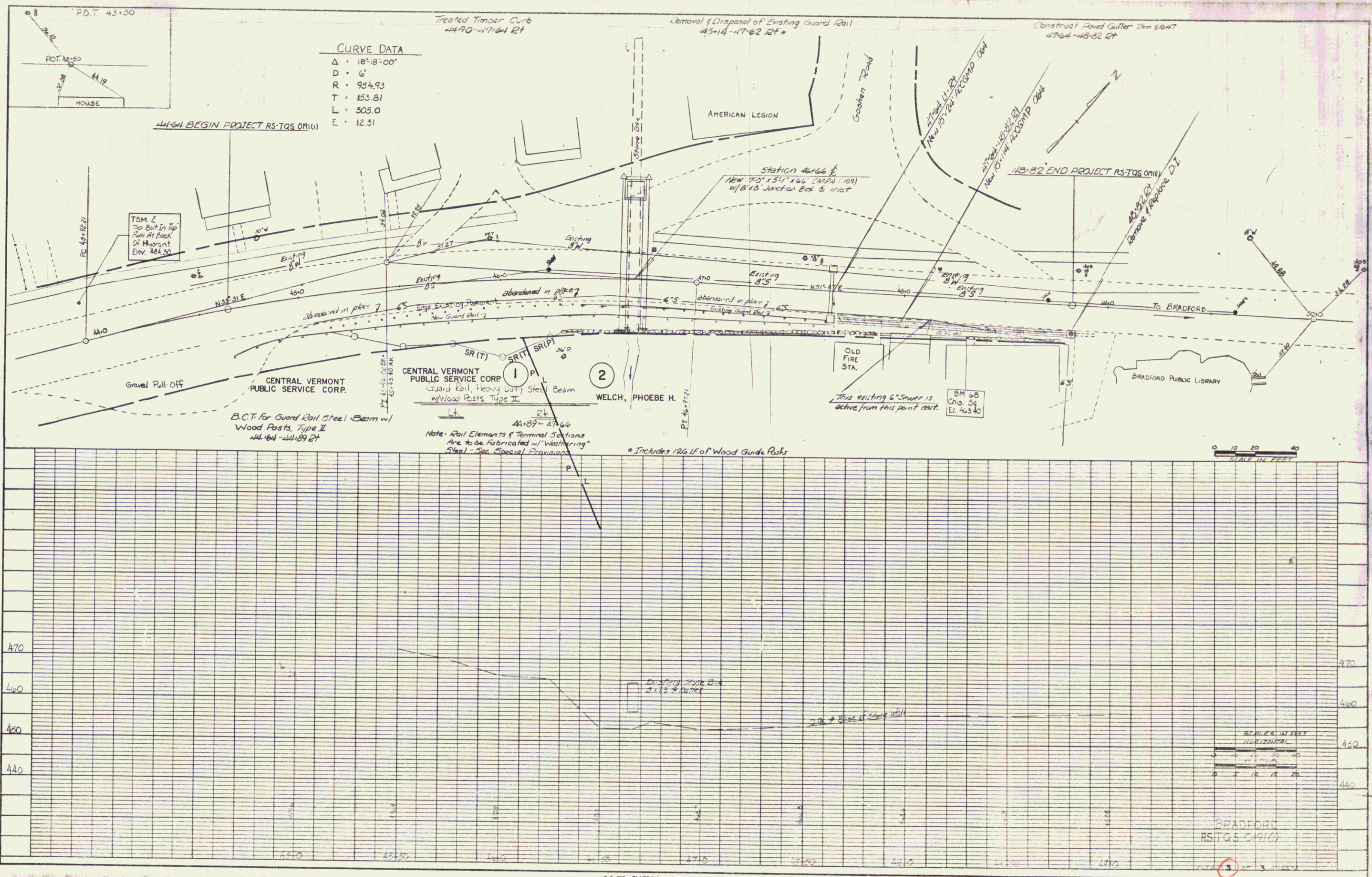

**PLAN**

DATE	
BY	
CHECKED	
APPROVED	
SCALE	
PROJECT	
DATE	
BY	
CHECKED	
APPROVED	

**PROFILE**

DATE	
BY	
CHECKED	
APPROVED	
SCALE	
PROJECT	
DATE	
BY	
CHECKED	
APPROVED	