

INDEX OF SHEETS

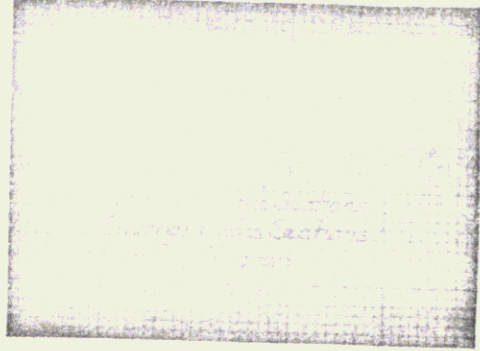

STATE OF VERMONT AGENCY OF TRANSPORTATION



PROPOSED IMPROVEMENT TOWN OF PLYMOUTH COUNTY OF WINDSOR

VT. ROUTE 100A (FAS)

R.O.W. PLANS

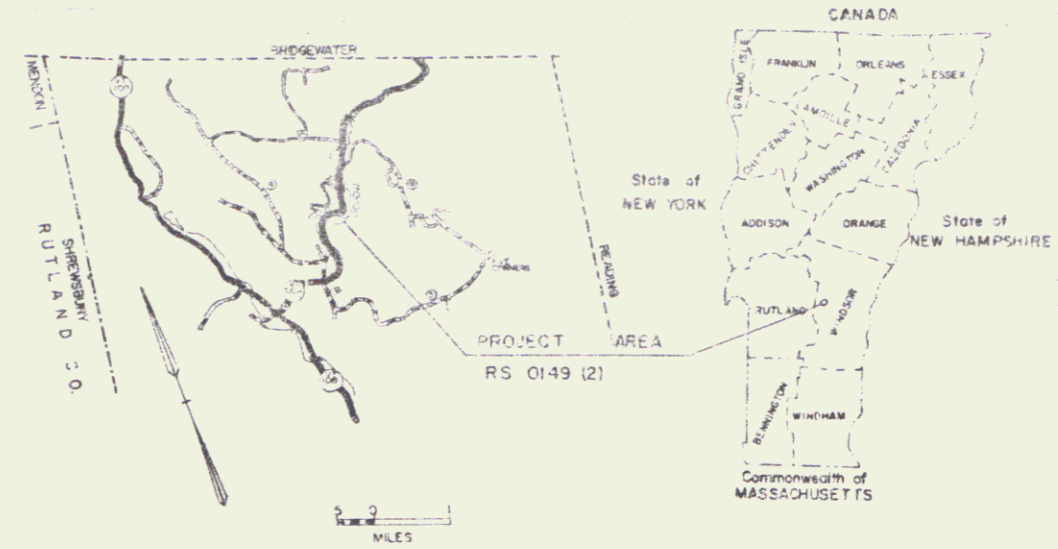

BEGIN R.O.W. PROJECT
RS 0149 (2) STA. 394+63

BEGINNING AT A POINT ON VT. RTE. 100A APPROXIMATELY 2.001 MI. EASTERLY OF THE INTERSECTION OF VT. RTE. 100 AND VT. RTE. 100A, AND PROCEEDING EASTERLY FOR 0.070 MILES.
LENGTH OF ROADWAY 340.10 FEET 0.064 MILES
LENGTH OF BRIDGE 30.90 FEET 0.006 MILES
LENGTH OF PROJECT 371 FEET 0.070 MILES
LENGTH OF R.O.W. PROJECT 687 FEET 0.130 MILES

Work to be performed consists of replacing the existing Hollow Brook concrete box structure and widening the roadway to provide two 11' wide travel lanes with 6' shoulders.

TRAFFIC DATA	
EST 1982 ADT	630
EST 2002 ADT	870
EST 1982 DHV	115
EST 2002 DHV	150
D	61%
T	6%
V	40 MPH

CONVENTIONAL SIGNS	
COUNTY LINE	---
TOWN LINE	---
LIMITS OF ACCESS	---
POINT OF ACCESS	X
FENCE LINE	---
STONE WALL	---
TRAVELED WAY	---
GUARD RAIL	---
RAILROAD	---
SURVEY LINE	---
CULVERT	---
POWER POLE	○
TELEPHONE POLE	○
TREES	○
CONTROL OF ACCESS	///
PROPERTY LINE	---
R.O.W. TAKING LINE	---
SLOPE RIGHTS	SR
TOP OF CUT	△
TOE OF SLOPE	○

DATUM	
VERTICAL	Assumed
HORIZONTAL	N/A

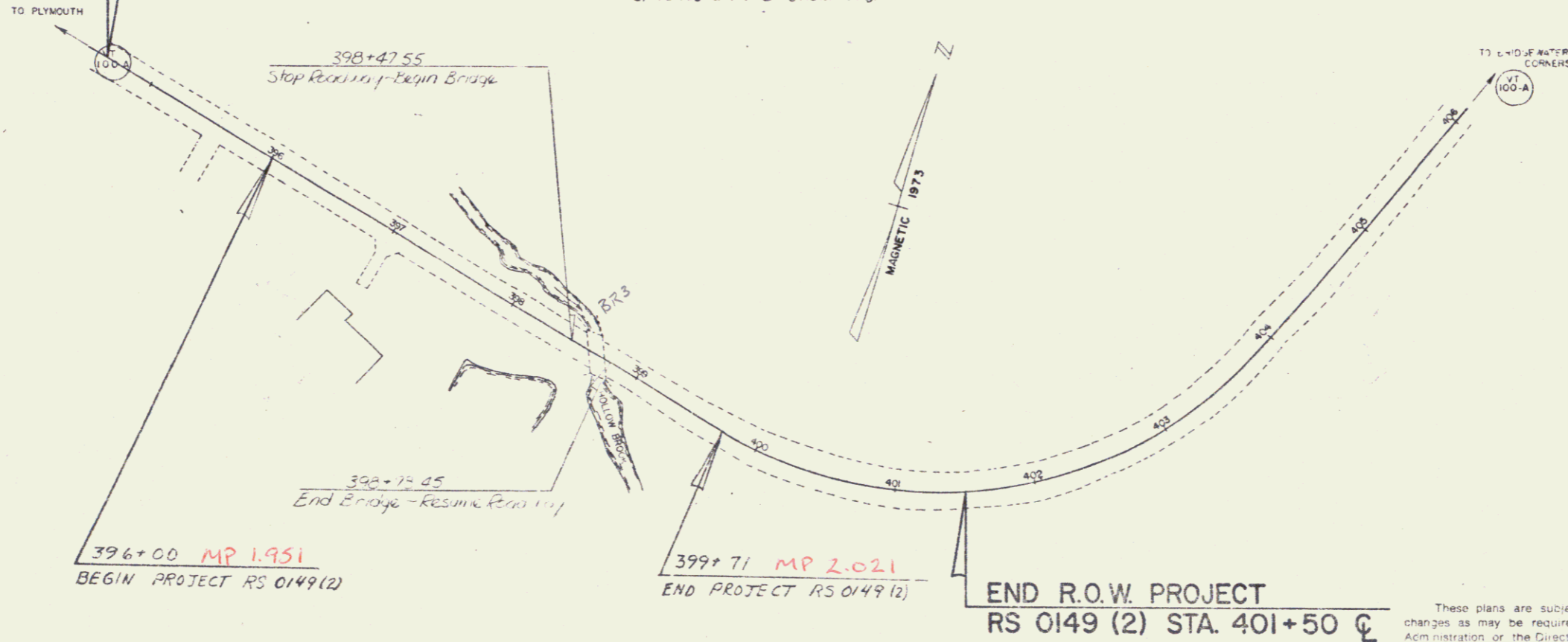

Pin # 76E 099

END R.O.W. PROJECT
RS 0149 (2) STA. 401+50

These plans are subject to such engineering changes as may be required by the Federal Highway Administration or the Director of Engineering and Construction.
Construction is to be carried on in accordance with these plans and the Standard Specifications for Highway and Bridge Construction dated March, 1976, as approved by the Federal Highway Administration on October 27, 1975 for use on this project including all subsequent revisions and such revised specifications and special provisions as are incorporated in these plans.

APPROVED	<i>[Signature]</i>	DATE	3-17-92
CHIEF PROPERTY ADMINISTRATION			
SUBMITTED BY	ORDER OF THE STATE TRANSPORTATION BOARD		
APPROVED	<i>[Signature]</i>	DATE	3-22-92
DIRECTOR OF ENGINEERING AND CONSTRUCTION			
DEPARTMENT OF TRANSPORTATION FEDERAL HIGHWAY ADMINISTRATION			
APPROVED	DATE		
DIVISION ADMINISTRATOR			
PROJECT	PLYMOUTH		
NO.	RS 0149 (2)		
SHEET	1 OF 4		

