

INDEX OF SHEETS

# STATE OF VERMONT DEPARTMENT OF HIGHWAYS

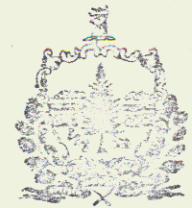

## PROPOSED IMPROVEMENT BRIDGE PROJECT

**TOWN OF HARDWICK**  
**COUNTY OF CALEDONIA**

ROUTE NO: **VT. 16** BRIDGE NO: 2

PROJECT LOCATION: Beginning @ a point approximately 0.20 miles  
northerly of the intersection of T47 & VT16 & extending 700' along VT16.

PROJECT DESCRIPTION: Removal of existing superstructure, extending  
existing abutments & prep, resetting existing beams with added cover, etc.  
Setting two new beams & constructing new reinforced concrete deck.  
Do necessary approach & channel work.

LENGTH OF STRUCTURE:	110 FEET
LENGTH OF PARTICIPATION ROADWAY:	590 FEET
LENGTH OF NON-PARTICIPATION ROADWAY:	~ FEET
LENGTH OF PROJECT:	700 FEET
LENGTH OF ROW PROJECT:	700 FEET

1937 ADT	= 1590
1977 ADT	= 1110
1997 ADT	= 230
D	= 54%
T	= 6%

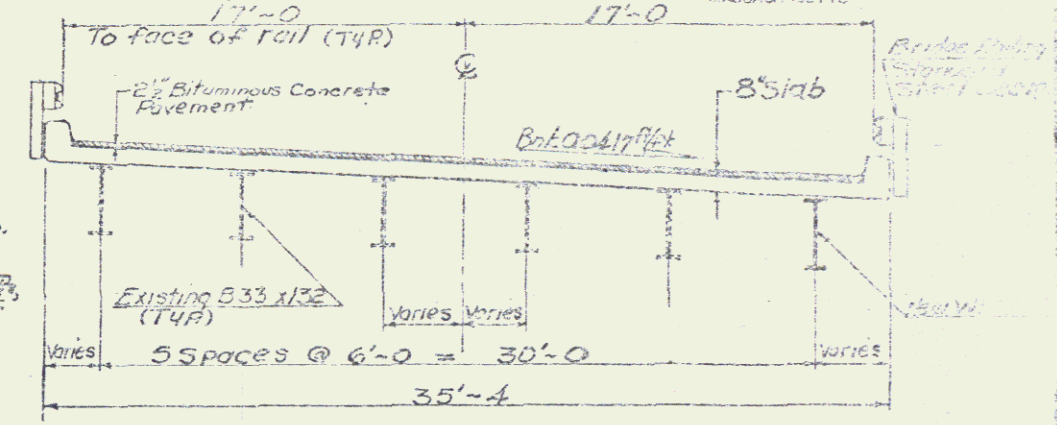
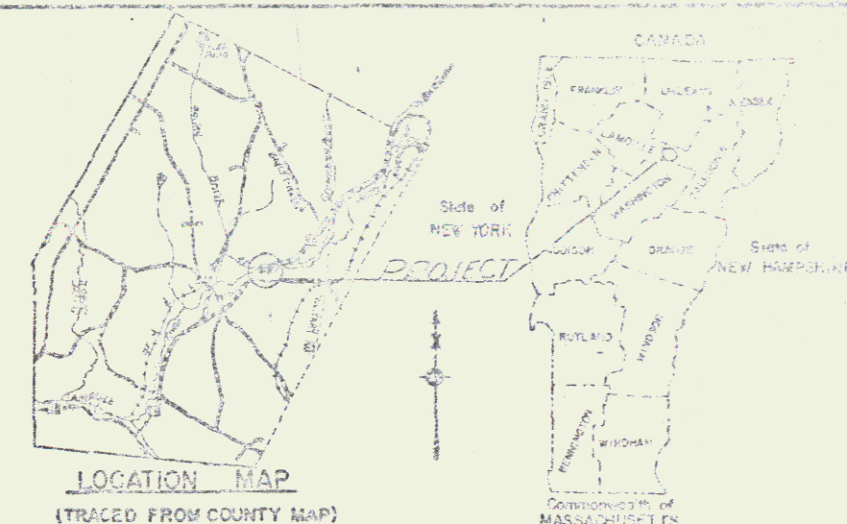

R.O.W. PLANS

MP 2.26

BEGIN ROW PROJ. TQF 037-3(1)  
STA. 119+50 @

END ROW PROJ. TQF 037-3(1)  
STA. 126+50 @

CONVENTIONAL SIGNS

COUNTY LINE	---
TOWN LINE	---
LIMITS OF ACCESS	---
POINT OF ACCESS	X
FENCE LINE	---
STONE WALL	---
TRAVELED WAY	---
GUARD RAIL	---
RAILROAD	---
SURVEY LINE	---
CULVERT	---
POWER POLE	○
TELEPHONE POLE	○
TRIED	○
VIA COUNTY IDENTIFICATION SIGNS	△
PROPERTY LINE	---
ROW TAKING LINE	---
SLOPE RIGHTS	---
TOP OF CUT	---
TOP OF SLOPE	---

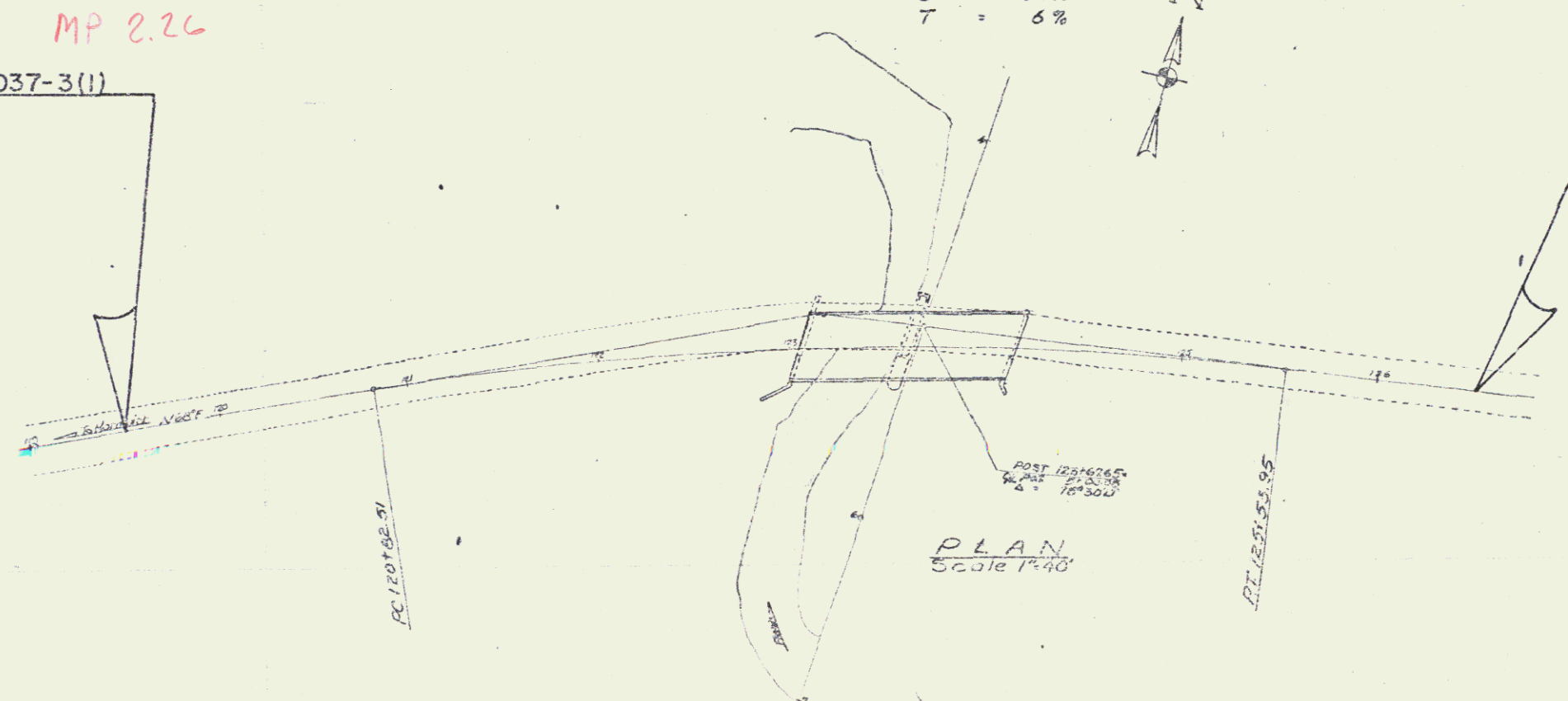

TYPICAL BRIDGE SECTION

MP 2.40

See Sheet 3 for  
TYPICAL ROADWAY SECTION

Route V+16  
Project TQF 037-3(1)  
Date 01/30/1978  
Pin# 76E 089

AUG 12 1980

SUBMITTED BY ORDER OF THE STATE HIGHWAY DEPARTMENT

APPROVED: \_\_\_\_\_  
DIRECTOR OF R.O.W.

HARDWICK

PROJECT: **TQF 037-3(1)**

DATE: 1-30-78

SHEET 1 OF 5