

STATE OF VERMONT
DEPARTMENT OF HIGHWAYS



PROPOSED IMPROVEMENT
BRIDGE PROJECT

TOWN OF ESSEX
COUNTY OF CHITTENDEN

ROUTE NO: VT 15 BRIDGE NO: 3

PROJECT LOCATION: BEGINNING AT A POINT .109 MILES SOUTHERLY OF THE INTERSECTION OF VT. RTE. 15 & VT. RTE. 128, AND EXTENDING SOUTHERLY .0057 MILES
PROJECT DESCRIPTION: *Replace Structure & Construct Approaches.*

LENGTH OF R.O.W. PROJECT = 525 FEET = 0.099 MILES

LENGTH OF STRUCTURE:		FEET
LENGTH OF PARTICIPATION ROADWAY:	300	FEET
LENGTH OF NON-PARTICIPATION ROADWAY:		FEET
LENGTH OF PROJECT:	300	FEET

1976 AADT = 7725
1976 DHV = 950
Design Speed = 40 MPH

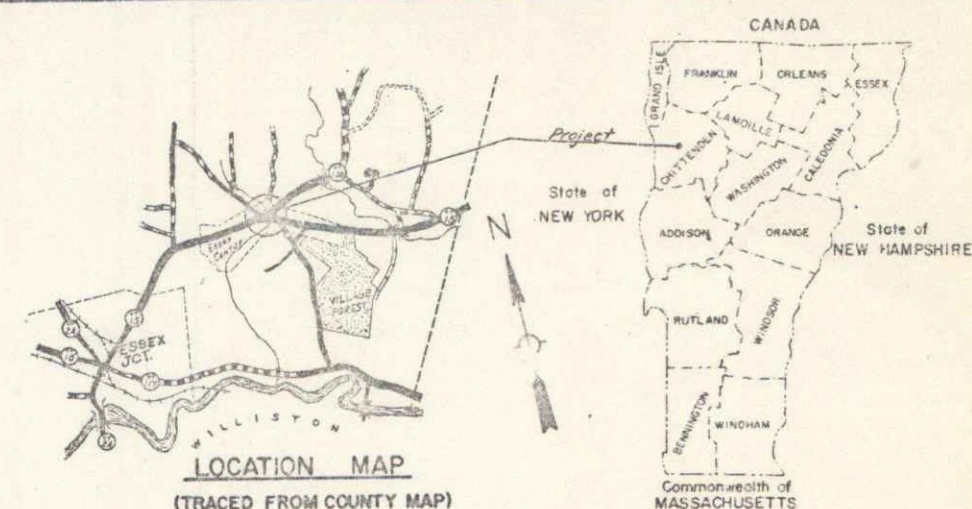

R.O.W. PLANS

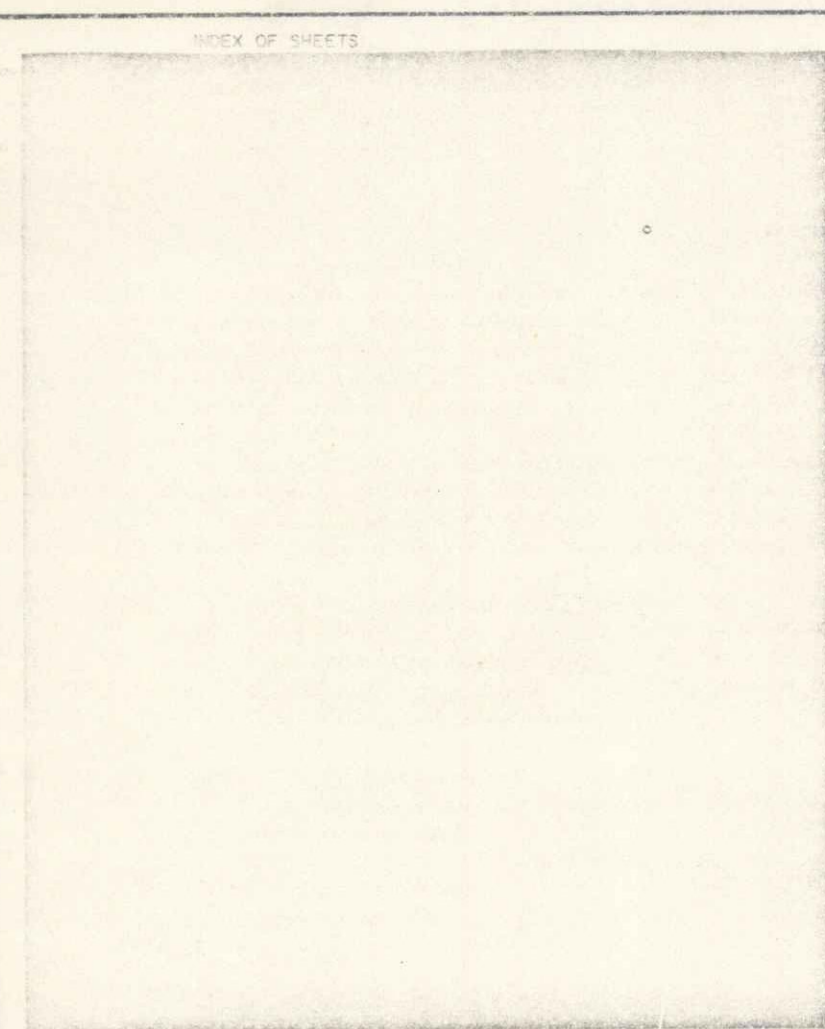

BEGIN R.O.W. PROJECT TQF 030-1(5)
STA. 168+50.0

END R.O.W. PROJECT TQF 030-1(5)
STA. 173+75.0

- CONVENTIONAL SIGNS
- COUNTY LINE
 - TOWN LINE
 - LIMITS OF ACCESS
 - POINT OF ACCESS
 - FENCE LINE
 - STONE WALL
 - TRAVELED WAY
 - GUARD RAIL
 - RAILROAD
 - SURVEY LINE
 - CULVERT
 - POWER POLE
 - TELEPHONE POLE
 - TREES
 - F.A. CONST. IDENTIFICATION SIGNS
 - PROPERTY LINE
 - R.O.W. TAKING LINE
 - SLOPE RIGHTS
 - TOP OF CUT
 - TOE OF SLOPE

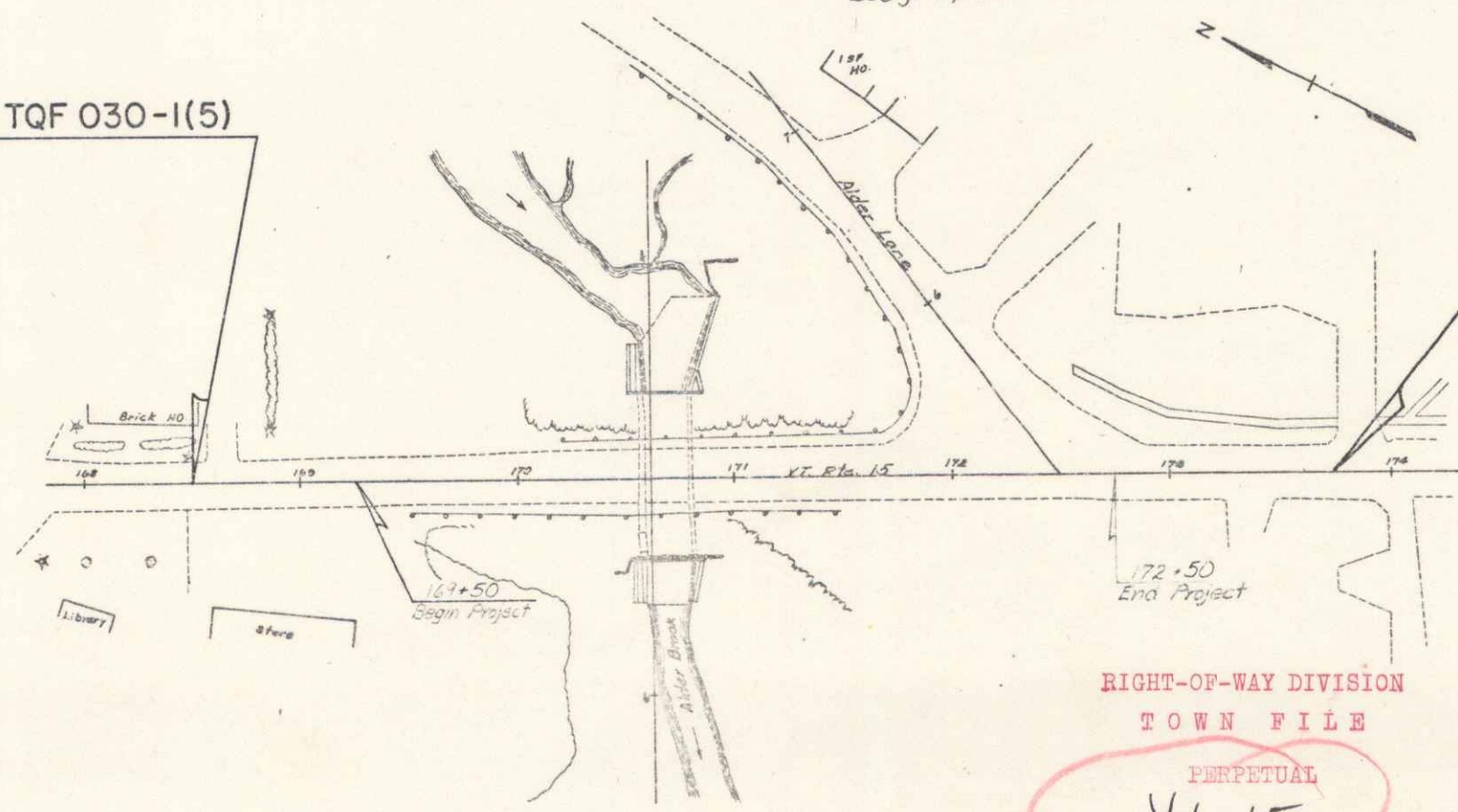

TYPICAL BRIDGE SECTION

TYPICAL ROADWAY SECTION

RIGHT-OF-WAY DIVISION
TOWN FILE
PERPETUAL

Town of Vt 15
(To Be Returned To R.O.W. Division)

Bridge #3
M.P. 5.44 - 6.55 A.P. MP 5.39-5.51

These plans are subject to such engineering changes as may be required by the Federal Highway Administration or the Chief Engineer.
Construction is to be carried on in accordance with these plans and the Standard Specifications for Highway and Bridge Construction dated March, 1976, as approved by the Federal Highway Administration on October 27, 1976, for use on this project, including all subsequent revisions and such revised specifications and special provisions as are incorporated in these plans.

APPROVED _____
DATE _____
R.O.W. DIRECTOR

Pin# 76E083
DEC 21 1981

SUBMITTED BY ORDER OF THE STATE TRANSPORTATION BOARD
APPROVED _____ DATE 10/5/77
CHIEF ENGINEER

PROJECT TQF No. 030-1(5)
SHEET 1 OF 5 SHEETS