

- Index of Sheets
- Title and Typical
 - General and Item Quantity sheet
 - Grades, Earthwork and Bridge Quantities
 - Plan and Profile
 - Blank
 - Plan and Elevation - Bridge
 - Substructure and Superstructure Details
 - Reinforcing Schedule - Bridge
 - Blank
 - SCB D-75 Bridge Details 12-15-76 R.
 - SCB D-75 Bridge Details 1-8-76
 - SCB D-75 Bridge Details 12-15-76 R.
 - Channel Sections - Bridge
 - B-1 Banking Tables 12-8-71
 - B-2 Typical Slope Rounding 12-6-71
 - D-2 Drainage 12-16-71 R.
 - E-3 Bridge Construction Approach Signs 6-7-77 R.
 - F-4 Road Construction Signs 6-7-77 R.
 - E-4 On Project Construction Signs 6-7-77 R.
 - E-7 Barricades 9-16-73 R.
 - G-1 Anchor for Steel Beam Rail at openings 6-4-74 R.
 - G-1a Guard Rail Steel Beam w/ Wood Posts, Type II 5-27-77 R.
 - J-1 Boundary Markers 12-6-71
 - K-1 Alignment for Guard Rail
 - K-2 Roadway Sections

STATE OF VERMONT
DEPARTMENT OF HIGHWAYS

Dated JUL 6 1978

Contractor
William N. Moore Inc.
Signature
W. N. Moore
Title
Secretary of Transportation



PROPOSED IMPROVEMENT
BRIDGE PROJECT
TOWN OF DOVER
COUNTY OF WINDHAM
ROUTE No. VT. RTE 100 BRIDGE No. B-59

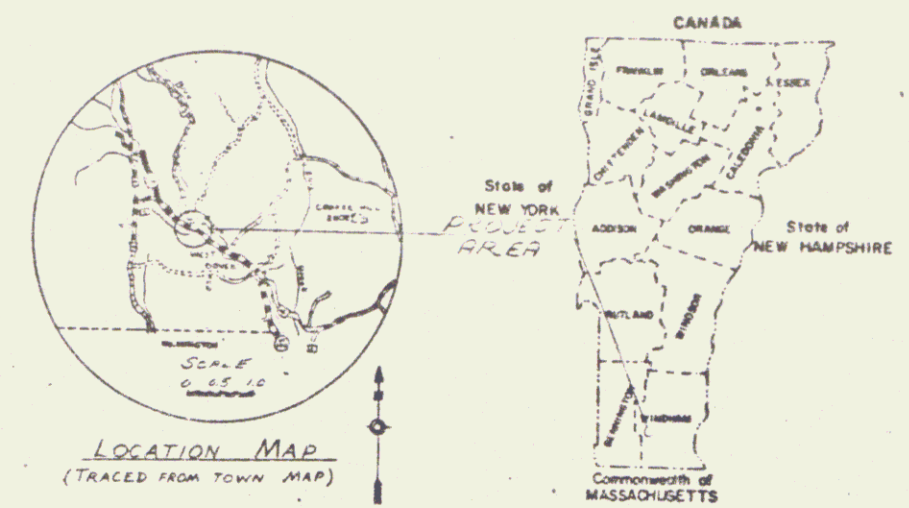

GENERAL NOTES:

- General notes pertaining to specifications and construction not shown on these plans are on Std. Dwg. SCB-D-75. Notes on the Std. Dwg. which apply are notes 4, 7, 11 and 14.
- Where new concrete is to be placed against existing concrete, it shall be placed in accordance with sub-section 501.12 (b). Mortar or neat cement grout shall be used to coat the existing concrete surfaces. The mortar or neat cement grout shall be mixed with the following proportions: 1 cement to 1 sand and enough water to make it a thick paint consistency. This work shall be considered subsidiary to the item, Concrete, Class B.

(General Notes continued on sheets 7 and 8 of 32.)

PROJECT LOCATION: BEGINNING AT A POINT APPROX. 2.1 MILES NORTHWESTERLY OF THE WILMINGTON-DOVER TOWN LINE AND EXTENDING NORTHWESTERLY .076 MILES.

PROJECT DESCRIPTION: WIDEN EXISTING T-BEAM BRIDGE WITH CAST-IN-PLACE CONCRETE SUBRANE T-BEAM, EXTEND UPSTREAM APPROACHES AND WINDWARD & DOWNDRAWN ROADSIDE CONSTRUCTION OF ROADWAY APPROACHES AND RELATED CHANNEL WORK.

LENGTH OF STRUCTURE: 353 FEET = 0.007 MILE
LENGTH OF ROADWAY: 367 FEET = 0.008 MILE
LENGTH OF PROJECT: 400 FEET = 0.007 MILE

1976 AADT - 2,335
1996 AADT - 3,595
D - 55%
T - 5%
V - 40

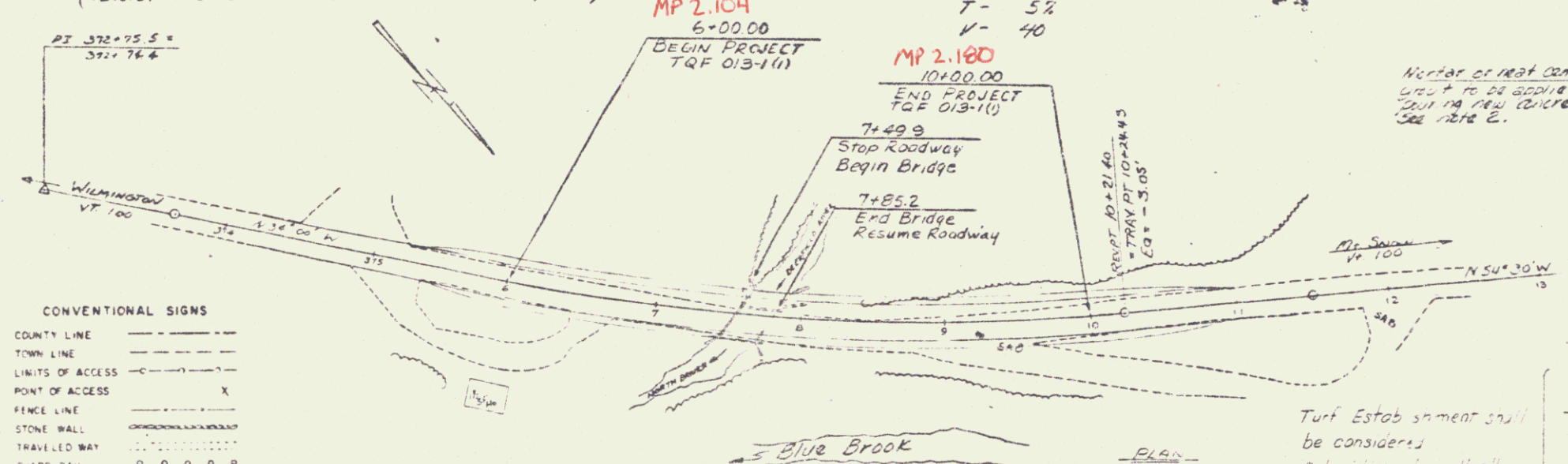

CONVENTIONAL SIGNS

COUNTY LINE	---
TOWN LINE	---
LIMITS OF ACCESS	---
POINT OF ACCESS	X
FENCE LINE	---
STONE WALL	---
TRAVELLED WAY	---
GUARD RAIL	---
RAILROAD	---
SURVEY LINE	---
CULVERT	---
POWER POLE	○
TELEPHONE POLE	○
TREES	○
FA CONST. IDENTIFICATION SIGNS	▲
PROPERTY LINE	---
ROW TAKING LINE	---
SLURRY RIGHTS	---
TOP OF CUT	---
TOP OF FILL	---

HYDRAULIC DATA
DRAINAGE AREA = 5.2 SQ. MI.
Q₁₀ = 600 CFS (MINUTE) = 4.0 FT
Q₂ = 250 CFS (MINUTE) = 3.3 FT
(NORMAL) Q₁₀₀ = 1200 CFS (MINUTE) = 8.4 FT
(NORMAL) Q₁ = 1420 CFS (MINUTE) = 7.2 FT
DEPTH OF FLOW IN NATURAL CHANNEL 5.0 FT
VELOCITY OF FLOW THROUGH STRUCTURE 11 FPS

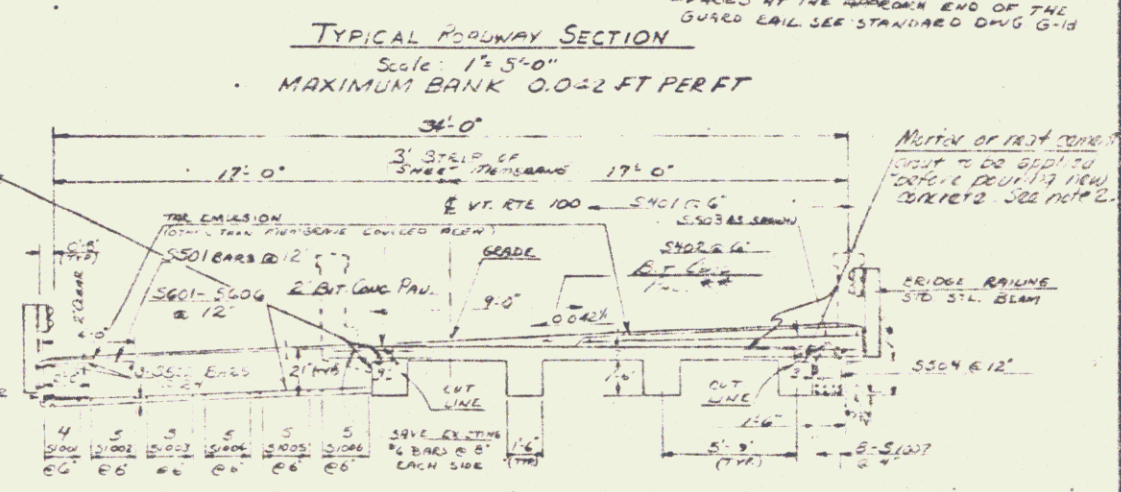
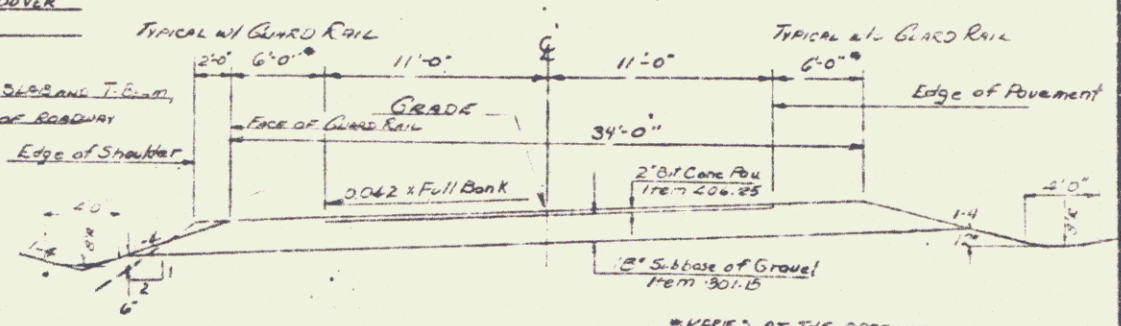

GRASS SEED FORMULA RURAL AREA

% BY WT	LB/T A	NAME	PUR %	GERM %
9.33	2	CROWN VETEN	99	75
50.00	20	CHELMING RED FESCUE	98	85
8.33	5	TIMOTHY	99	85
5.00	3	Highland Bent Grass	92	85
16.67	10	PERENNIAL RYE GRASS (Var. Prairie)	95	85
8.33	5	ALPACAL (Var. Shamrock)	99	85
8.33	5	BIRDSEED TREFOIL (Var. Empire)	98	85
100.00	60			

The seed mixture shall not have a weed content exceeding 0.40% by weight and shall be free from all noxious weed seed.

GENERAL NOTES
Fertilizer from 6-1-15 shall be mixed as follows: Nitrogen - 10%, Phosphorus - 20%, Potash - 10% (10-20-10). Fertilizer shall be delivered in bags of not to exceed 100 pounds each and is to be applied at the rate of 500 pounds per acre. Agricultural limestone from 6-1-20 to be applied to all earth slopes at the rate of two tons per acre or as directed by the Engineer. All fill on item 6-1-20 to be placed on all earth slopes at the rate of two tons per acre.

DIN: 76E080
DATE: 07/06/1978

SUBMITTED BY ORDER OF THE STATE TRANSPORTATION BOARD
APPROVED: _____ DATE _____
CHIEF ENGINEER

PROJECT NO. 100
DOVER VT. TQF 013-1(1)
SHEET 1 OF 30 SHEETS