

STATE OF VERMONT
AGENCY OF TRANSPORTATION



PROPOSED IMPROVEMENT
BRIDGE PROJECT

TOWN OF CANAAN
COUNTY OF ESSEX

Pin# 76E079

ROUTE NO: VT. RTE. 114 BRIDGE NO. 48 (FAS)
BEGINNING AT A POINT APPROXIMATELY 2.615 MILES
EASTERLY OF THE AVERILL-CANAAN TOWN LINE
AND EXTENDING EASTERLY 0.142 MILES

LENGTH OF ROADWAY	630.33	FEET	0.131	MILES
LENGTH OF BRIDGE	59.67	FEET	0.111	MILES
LENGTH OF PROJECT	750.00	FEET	0.142	MILES
LENGTH OF ROW PROJECT	948.64	FEET	0.180	MILES

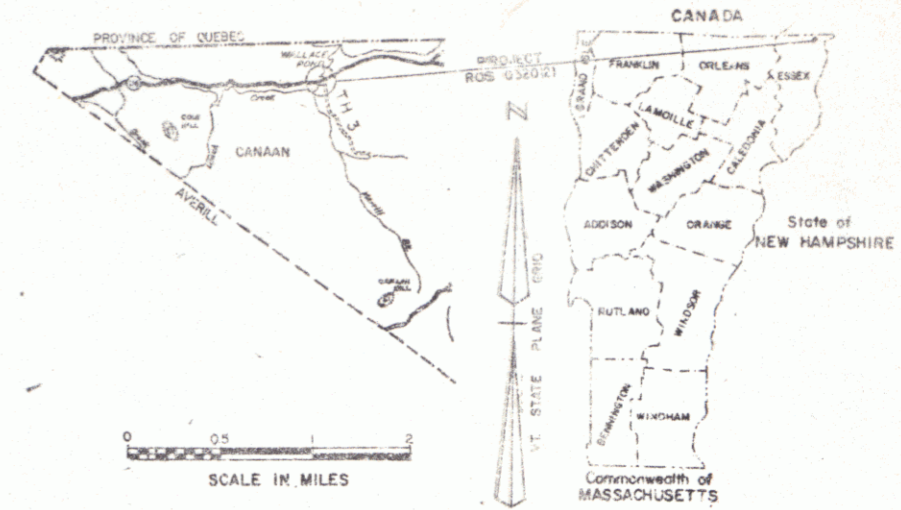

R.O.W. PLANS

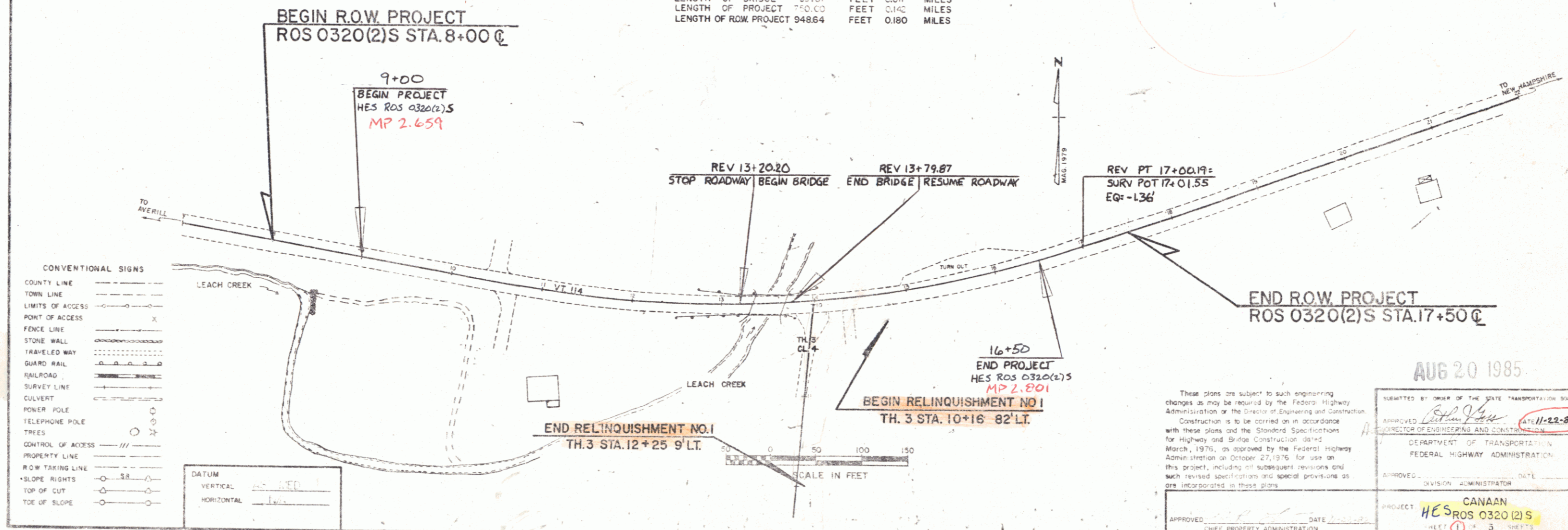

- CONVENTIONAL SIGNS
- COUNTY LINE
 - TOWN LINE
 - LIMITS OF ACCESS
 - POINT OF ACCESS
 - FENCE LINE
 - STONE WALL
 - TRAVELED WAY
 - GUARD RAIL
 - RAILROAD
 - SURVEY LINE
 - CULVERT
 - POWER POLE
 - TELEPHONE POLE
 - TREES
 - CONTROL OF ACCESS
 - PROPERTY LINE
 - R.O.W. TAKING LINE
 - SLOPE RIGHTS
 - TOP OF CUT
 - TOE OF SLOPE

These plans are subject to such engineering changes as may be required by the Federal Highway Administration or the Director of Engineering and Construction. Construction is to be carried on in accordance with these plans and the Standard Specifications for Highway and Bridge Construction dated March, 1976, as approved by the Federal Highway Administration on October 27, 1976 for use on this project, including all subsequent revisions and such revised specifications and special provisions as are incorporated in these plans.

APPROVED: _____ DATE: _____
CHIEF, PROPERTY ADMINISTRATION

AUG 20 1985

SUBMITTED BY ORDER OF THE STATE TRANSPORTATION BOARD

APPROVED: _____ DATE: 11-22-82
DIRECTOR OF ENGINEERING AND CONSTRUCTION

DEPARTMENT OF TRANSPORTATION
FEDERAL HIGHWAY ADMINISTRATION

APPROVED: _____ DATE: _____
DIVISION ADMINISTRATOR

PROJECT: CANAAN
HES ROS 0320(2)S
SHEET 1 OF 3 SHEETS

SRS 12/1/70

RIGHT-OF-WAY DIVISION
TOWN FILE
PERPETUAL
Town of Canaan
(To Be Returned To R.O.W. Division)