

INDEX OF SHEETS

STATE OF VERMONT DEPARTMENT OF HIGHWAYS



PROPOSED IMPROVEMENT BRIDGE PROJECT TOWNS OF BRANDON & GOSHEN COUNTY OF RUTLAND

ROUTE NO: VT. RTE 73 BRIDGE NO: 8

PROJECT LOCATION: BEGINNING AT A POINT ON VT. RTE 73, 0.057 MILE WESTERLY OF THE BRANDON-GOSHEN TOWN LINE AND EXTENDING EASTERLY ALONG VT. RTE. 73 FOR 0.085 MILE.
PROJECT DESCRIPTION: THE PROJECT EXTENDS 0.028 MILE INTO THE TOWN OF GOSHEN. REMOVE EXISTING CONCRETE BRIDGE DECK, WIDEN ABUTMENTS, AND SUPERSTRUCTURE. CONSTRUCT NEW COMPOSITE CONCRETE DECK WITH RELATED ROADWAY AND CHANNEL WORK.

LENGTH OF STRUCTURE:	74.0	FEET
LENGTH OF PARTICIPATION ROADWAY:	376.0	FEET
LENGTH OF NON-PARTICIPATION ROADWAY:		FEET
LENGTH OF PROJECT	450.0	FEET
LENGTH OF R.O.W PROJECT	450.0	FEET

TRAFFIC DATA

1977 ADT	1020
1982 ADT	1130
1982 DAV	180
D	67%
T	5%
V	40 MPH

ROW PLANS

GENERAL NOTES:

- GENERAL NOTES PERTAINING TO SPECIFICATIONS AND CONSTRUCTION NOT SHOWN ON THESE PLANS ARE ON STANDARD DRAWING 52B-DI-73. NOTES ON THE STANDARD DRAWING WHICH APPLY ARE NOTES 2, 3, 4, 5, 7, 8, 9, 10, 11, 14 AND 15. DESIGN IS FOR ASSHTO H5-20-94 LIVE LOAD.
- FOR SPECIFICATIONS REGARDING MOVEMENT OF TRAFFIC OVER THE BRIDGE SEE THE ITEM: MAINTENANCE OF TRAFFIC FOR BRIDGE PROJECTS. ONE-WAY TRAFFIC SHALL BE MAINTAINED WITH A CLEAR WIDTH OF AT LEAST 12'-0" BETWEEN TEMPORARY CURBS.
- DETOUR TRAFFIC WILL BE CONTROLLED BY TRAFFIC CONTROL SIGNALS. TRAFFIC CONTROL SIGNALS, INCLUDING RELATED HARDWARE, EQUIPMENT AND INCIDENTALS, WILL BE FURNISHED, INSTALLED, AND MAINTAINED BY STATE FORCES. THIS WORK SHALL BE PAID FOR UNDER THE ITEM TRAFFIC CONTROL SIGNALS (BRIDGE 73). THE STATE SHALL BE RESPONSIBLE FOR THE ELECTRIC POWER REQUIRED FOR THE OPERATION OF THE SIGNALS.
- REMOVAL OF THE EXISTING SUPERSTRUCTURE, INCLUDING PAVEMENT, DECK CONCRETE, CURB AND RAILING, AND ALL EXISTING APPROACH RAILING, SHALL BE PAID FOR UNDER THE ITEM REMOVAL OF EXISTING SUPERSTRUCTURE.

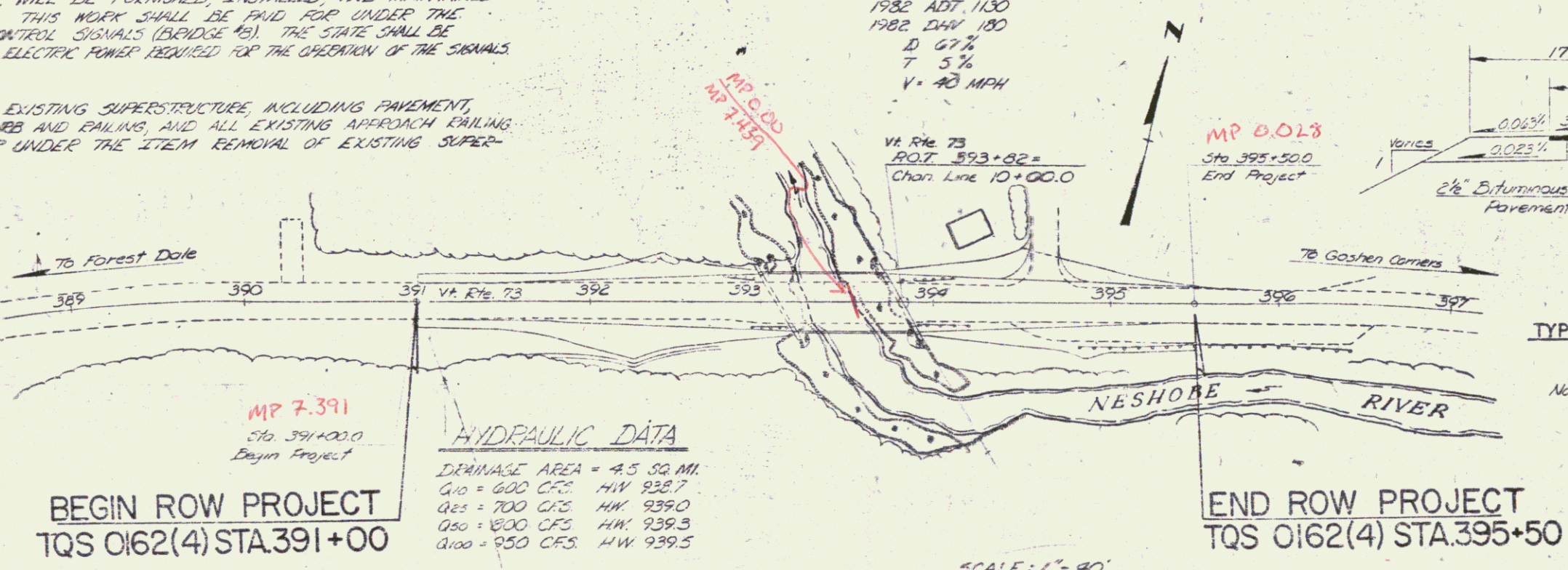
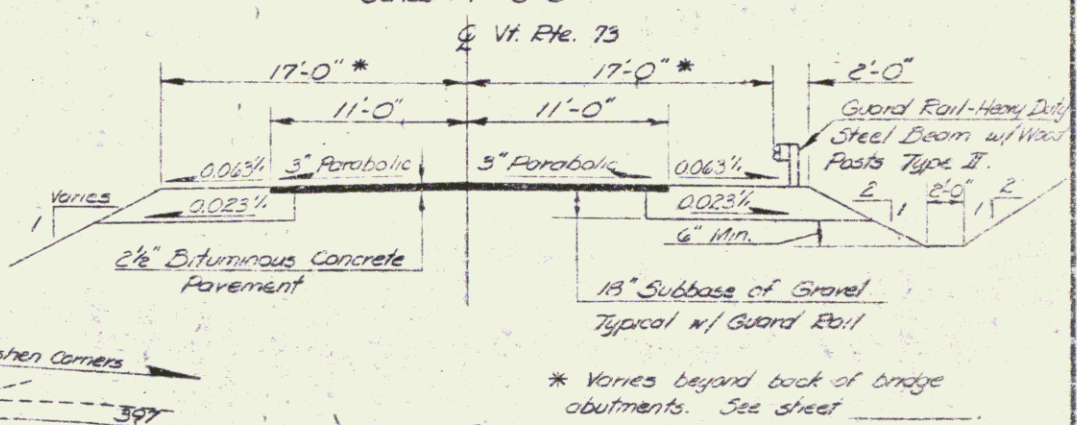
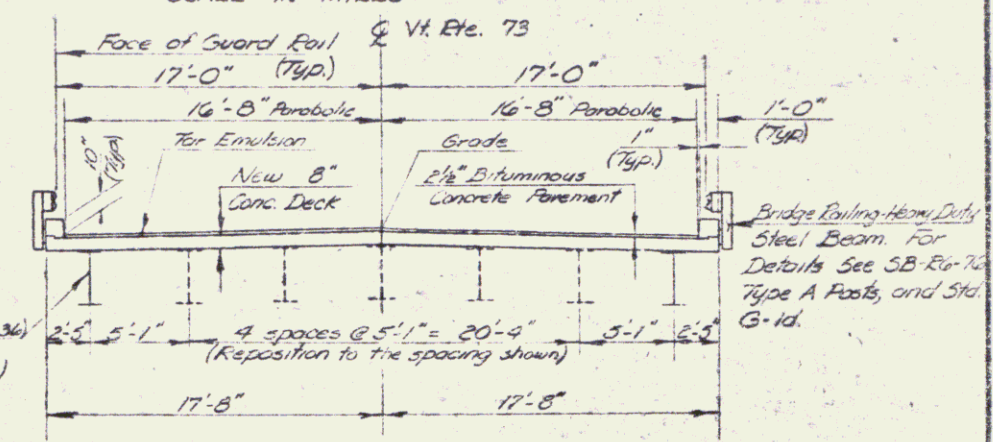
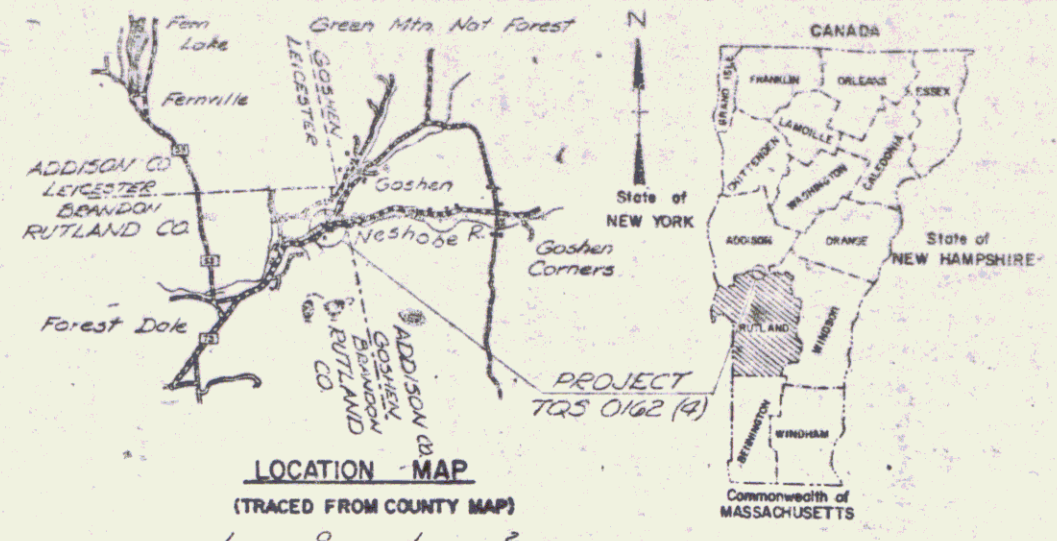

HYDRAULIC DATA

Drainage Area	= 4.5 SQ. MI.
Q10	= 600 CFS HW 938.7
Q25	= 700 CFS HW 939.0
Q50	= 800 CFS HW 939.3
Q100	= 950 CFS HW 939.5
Tailwater Elevation @ Q100	= 936.3
Outlet Velocity @ Q100	= 13.2 FPS
Stone Fill	Type II

- CONVENTIONAL SIGNS
- COUNTY LINE
 - TOWN LINE
 - LIMITS OF ACCESS
 - POINT OF ACCESS
 - FENCE LINE
 - STONE WALL
 - TRAVELED WAY
 - GUARD RAIL
 - RAILROAD
 - SURVEY LINE
 - CULVERT
 - POWER POLE
 - TELEPHONE POLE
 - TREES
 - F.A. CONST. IDENTIFICATION SIGNS
 - PROPERTY LINE
 - R.O.W. TAKING LINE
 - SLOPE RIGHTS
 - TOP OF CUT
 - TOE OF SLOPE

APPROVED: [Signature] DATE: 4/19/78
DIRECTOR OF ENGINEERING & CONSTRUCTION

PROJECT: BRANDON-GOSHEN
TQS 0162(4)
SHEET 1 OF 3 SHEETS
SRE 1217