

POOR ORIGINAL COPY

STATE OF VERMONT
AGENCY OF TRANSPORTATION

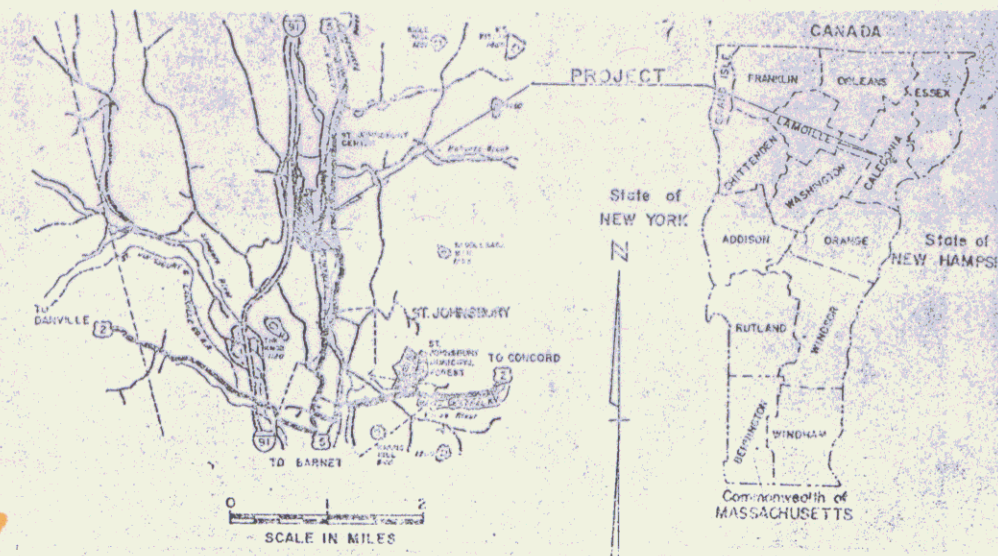

PROPOSED IMPROVEMENT
TOWN OF ST. JOHNSBURY
COUNTY OF CALEDONIA
INTERSTATE CONNECTOR



ROW PLANS

BEGINNING AT THE INTERSECTION OF U.S. ROUTE 5 AND THE
NORTHEAST VERMONT REGIONAL HOSPITAL ROAD AND EXTENDING
WESTERLY AND THEN NORTHERLY MILES TO THE
I 91 ST. JOHNSBURY NORTH INTERCHANGE.

LENGTH OF ROADWAY 3213.44 FEET = 0.609 MILES
LENGTH OF BRIDGE 365.00 FEET = 0.073 MILES
LENGTH OF PROJECT 3599.44 FEET = 0.692 MILES
LENGTH OF ROW PROJ. 3600.00 FEET = 0.682 MILES

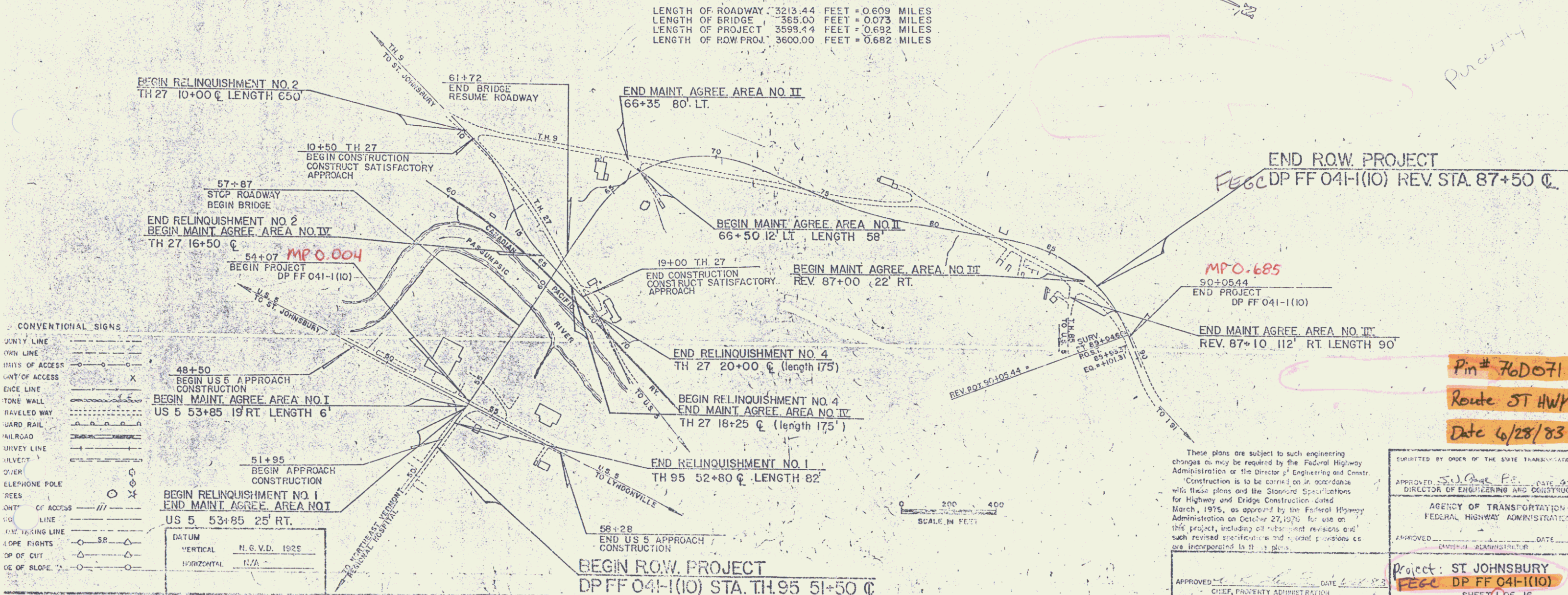

CONVENTIONAL SIGNS

UNITY LINE	---
OWN LINE	---
THRU ACCESS	---
WAY OF ACCESS	---
EDGE LINE	---
TONE WALL	---
TRAVELED WAY	---
WARD RAIL	---
RAILROAD	---
SHIVEY LINE	---
WAVECT	---
CLERK	---
ELEPHONE POLE	---
TREES	---
WHTY OF ACCESS	---
VIOL LINE	---
WHTY MARKING LINE	---
LOPE RIGHTS	---
TOP OF CUT	---
DE OF SLOPE	---

These plans are subject to such engineering
changes as may be required by the Federal Highway
Administration or the Director of Engineering and Constr.
Construction is to be carried on in accordance
with these plans and the Standard Specifications
for Highway and Bridge Construction dated
March, 1976, as approved by the Federal Highway
Administration on October 27, 1976 for use on
this project, including all subsequent revisions and
such revised specifications and special provisions as
are incorporated in these plans.

APPROVED: *S.J. Gagne, Jr.* DATE: 6/28/83
DIRECTOR OF ENGINEERING AND CONSTRUCTION

AGENCY OF TRANSPORTATION
FEDERAL HIGHWAY ADMINISTRATION

APPROVED: _____ DATE: _____
ENGINEER/ADMINISTRATOR

Project: ST JOHNSBURY
FECC DP FF 041-1(10)
SHEET 1 OF 16

Pin# 76D071
Route 5T HWY
Date 6/28/83

POOR ORIGINAL COPY

EROSION MATTING
ITEM 65A20
ML 54+50-54+00 RT.
GUARDRAIL STD STEEL
BEAM W/ WOOD POSTS, TYPE II
ITEM 6E123
56+25-58+00 RT
56+53-58+00 RT
BREAKAWAY CABLE TIE
FOR G.C. PILE, STD BEAM W/
WOOD POSTS, TYPE II
ITEM 6E177
56+05-56+25 RT
56+25-56+53 RT

Treated Timber Curb
56+50 - 57+64 RT
57+00 - 57+78 RT
Brimmed Surface for Gutters
and Traffic Islands (Islands)
ML 54+97 - 54+61 RT, US 5 RT.
US 5 51+80 - 52+20 RT
US 5 54+75 - 56+15 RT

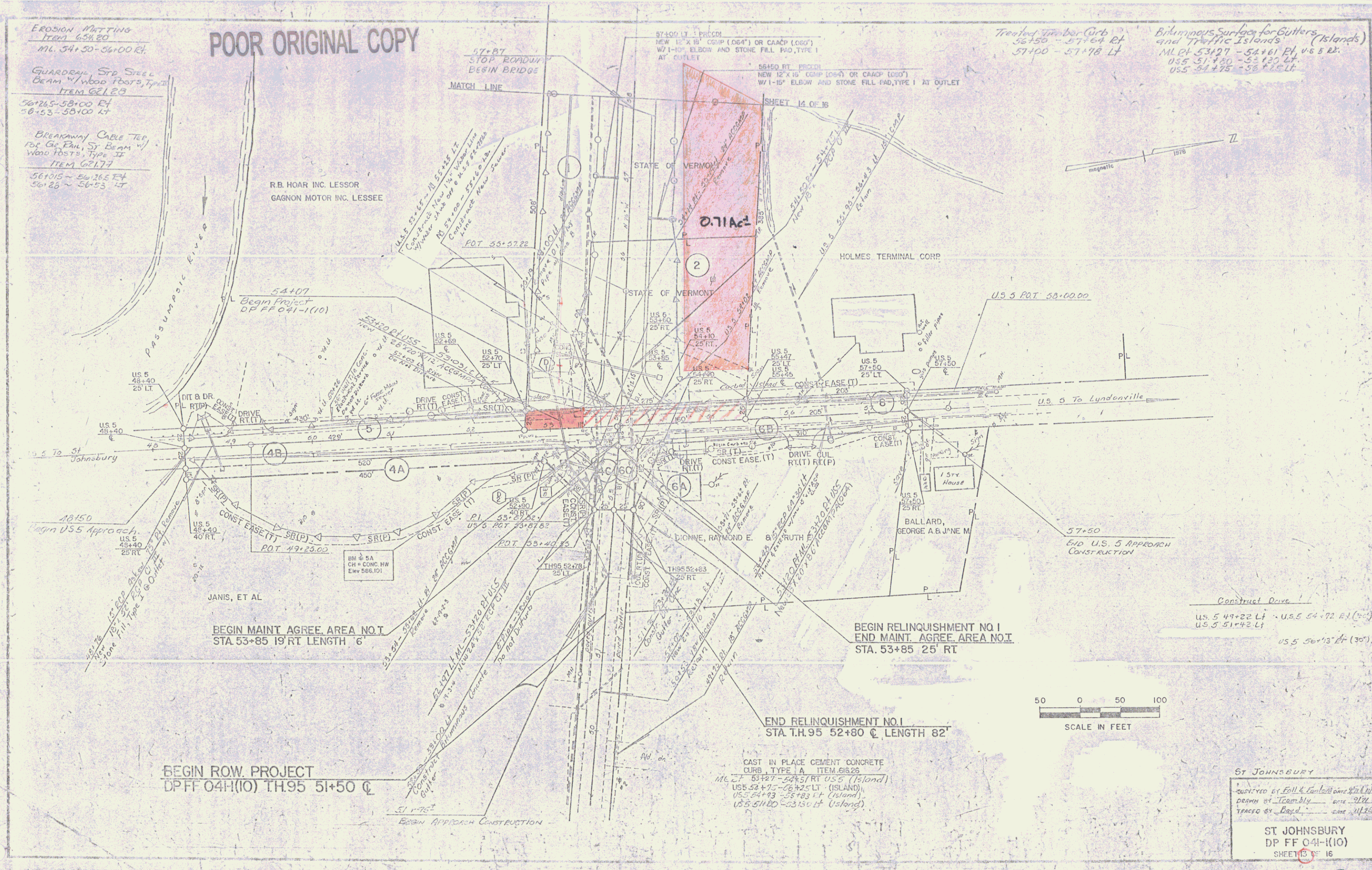

ST JOHNSBURY
DP FF 04H-1(10)
SHEET 14 OF 16

THIS IS PART OF THE SAME LAND AND PREMISES ACQUIRED BY THE STATE OF VERMONT FROM RICHARD W. HOAR BY WARRANTY DEED DATED DEC. 13, 1979 AND RECORDED IN BOOK 166, PAGES 514-515; AND FROM RAYMOND B. HOAR, INC. BY WARRANTY DEED DATED DEC. 13, 1979 AND RECORDED IN BOOK 166, PAGES 519-520, BOTH OF THE TOWN OF ST. JOHNSBURY LAND RECORDS.

STATE OF VERMONT TO
 THURSTON & DIMICK PROPERTIES
 BY QCD ON 7/1/94
 RECORDED IN BK 226/122

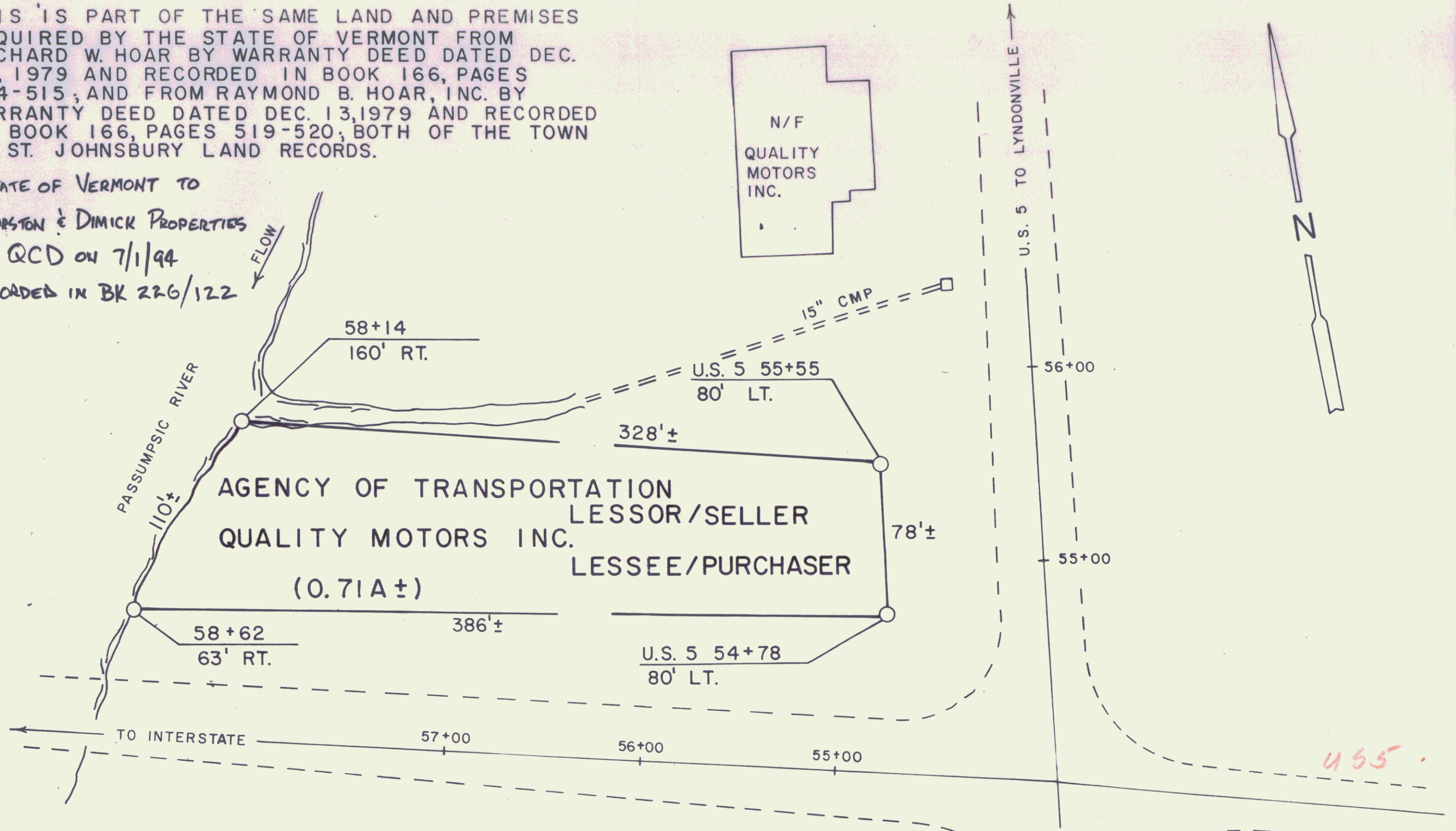
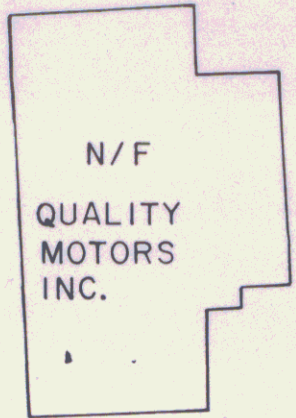

AGENCY OF TRANSPORTATION
 LESSOR/SELLER
 QUALITY MOTORS INC.
 LESSEE/PURCHASER
 (0.71A±)

REF: ST. JOHNSBURY
 FEGC DP FF 041-1(10)
 SHEETS 33,35 OF 229

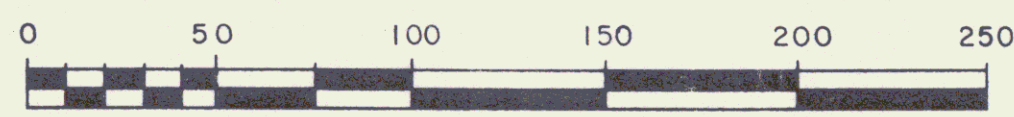

STATE OF VERMONT AGENCY OF TRANSPORTATION		
SHEET 13A		
TOWN OF ST. JOHNSBURY		
3		
APPROX. SCALE 1"= 50'	DATE: 10-27-89	DRAWN BY M.R.

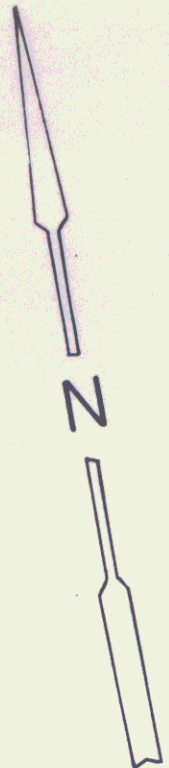

147

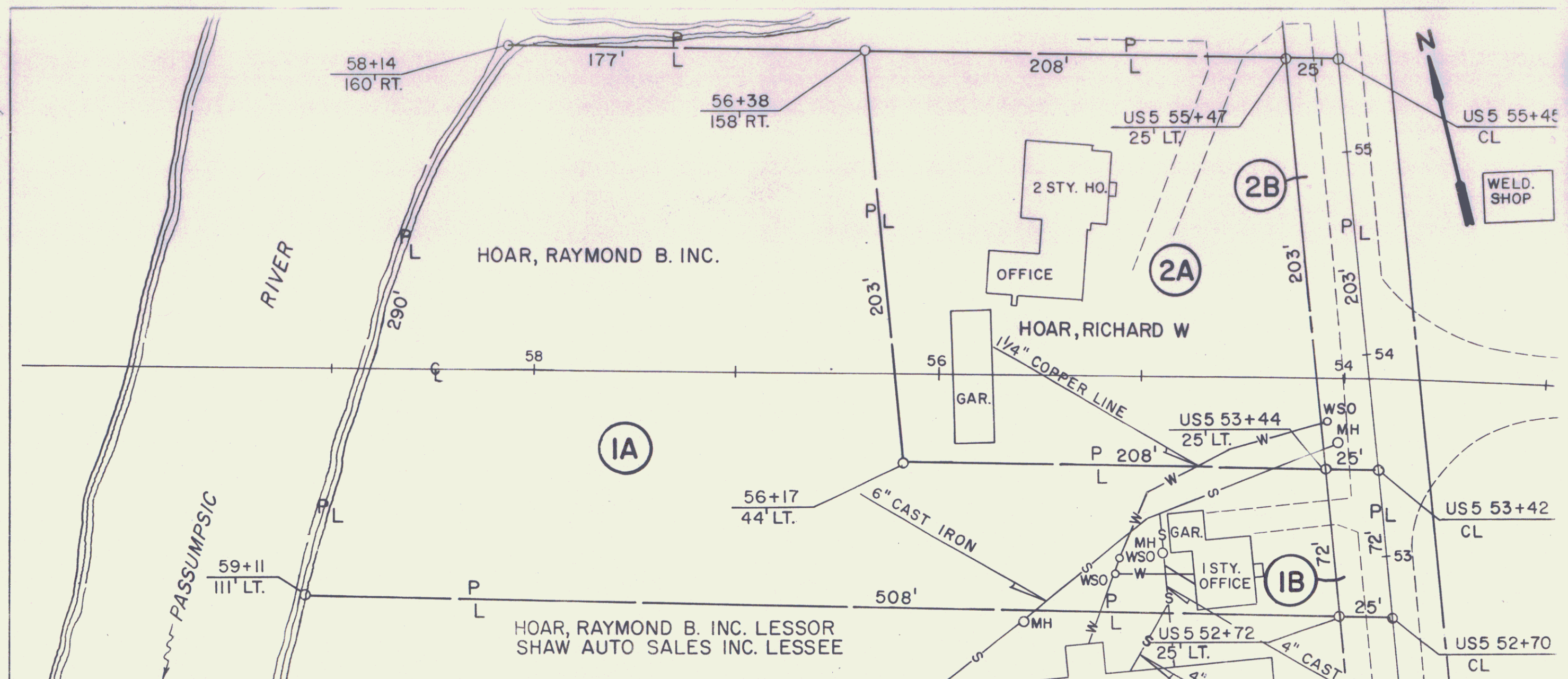

PARCEL NO.	GRANTOR	BEGINNING STATION	ENDING STATION	TAKING	TITLE TAKEN	RIGHTS	REMARKS
1A	HOAR, RAYMOND B. INC.	US 5 52+72 LT. 54+33 LT. 54+60 LT. 54+72 LT.	59+11 LT. 55+52 LT. 55+19 LT.	1.93 A±	WD		SEWER LINE (RESERVE) OFFICE BUILDING WATER LINE (RESERVE)
1B		US 5 52+70 CL	US 5 53+44 LT.	0.04 A±		ALL RT&I	1800 SF± US RTE. 5
2A	HOAR, RICHARD W	US 5 53+44 LT. 55+40 RT. 54+09 LT. 54+11 LT. 55+85 CL.	56+38 RT. 54+33 LT. 54+72 LT.	0.97 A±	WD		2 STY. HOUSE W/OFFICE SEWER LINE (RESERVE) WATER LINE (RESERVE) GARAGE
2B		US 5 53+42 CL	US 5 55+47 LT.	0.12 A±		ALL RT&I	US RTE. 5

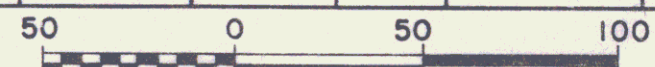

STATE OF VERMONT
 AGENCY OF TRANSPORTATION
 SHEET 138
 ST. JOHNSBURY
 PROJECT FF 041-1(10) 4
 APPROX. SCALE 1"=50' DATE APR 11, 79 DRAWN BY JDP
 139

EROSION MATTING
ITEM 624.20
TE 27 15+00-16+50.4

GUARDRAIL, STD. ST. BEAM
w/ WOOD POSTS, TYPE III
DIM 621.28
62+42 - 62+194.5 RT.
62+58 - 63+190.5 LT.
RT.
LT.

Guard Rail Plank w/ Wood Posts
13+50' LT

Sand Borrow
63+00-64+00

Drilling & Blasting of
Solid Rock Subgrade
62+15 - 63+50
64+50 - 67+25

BREAKAWAY CABLE TERMINAL
STEEL BEAM w/ WOOD POSTS, TYPE II
ITEM 621.77
62+195 - 63+04.5 RT.
63+10.5 - 63+195.5 LT.

END MAINT. AGREE. AREA NO. II
66+35 80' LT.

BEGIN MAINT. AGREE. AREA NO. II
66+55 12' LT. LENGTH 72'

Construct Drive
66+60 RT (20' wide)
18+65 LT TH 27

Construct Approach
66+50 LT (Paved) 111.52'

POOR ORIGINAL COPY

MAIN LINE CURVE #1
Δ 79° 59' RT
D 10'
R 372.96
T 482.63
L 799.63
E 174.09
BANK .077 FT/FT.

TH 27 CURVE #1
Δ 22° 43' RT
D 12'
R 477.465'
T 92.91'
L 189.31'
E 9.54
BANK .066 FT/FT.

TH 27 CURVE #2
Δ 25° 35' LT
D 12'
R 477.465'
T 92.91'
L 196.94'
E 10.34'
BANK .066 FT/FT.

TH 27 CURVE #3
Δ 17° 59' RT
D 12'
R 477.465'
T 76.55'
L 149.66'
E 3.94'
BANK .066 FT/FT.

SCALE IN FEET
0 50 100

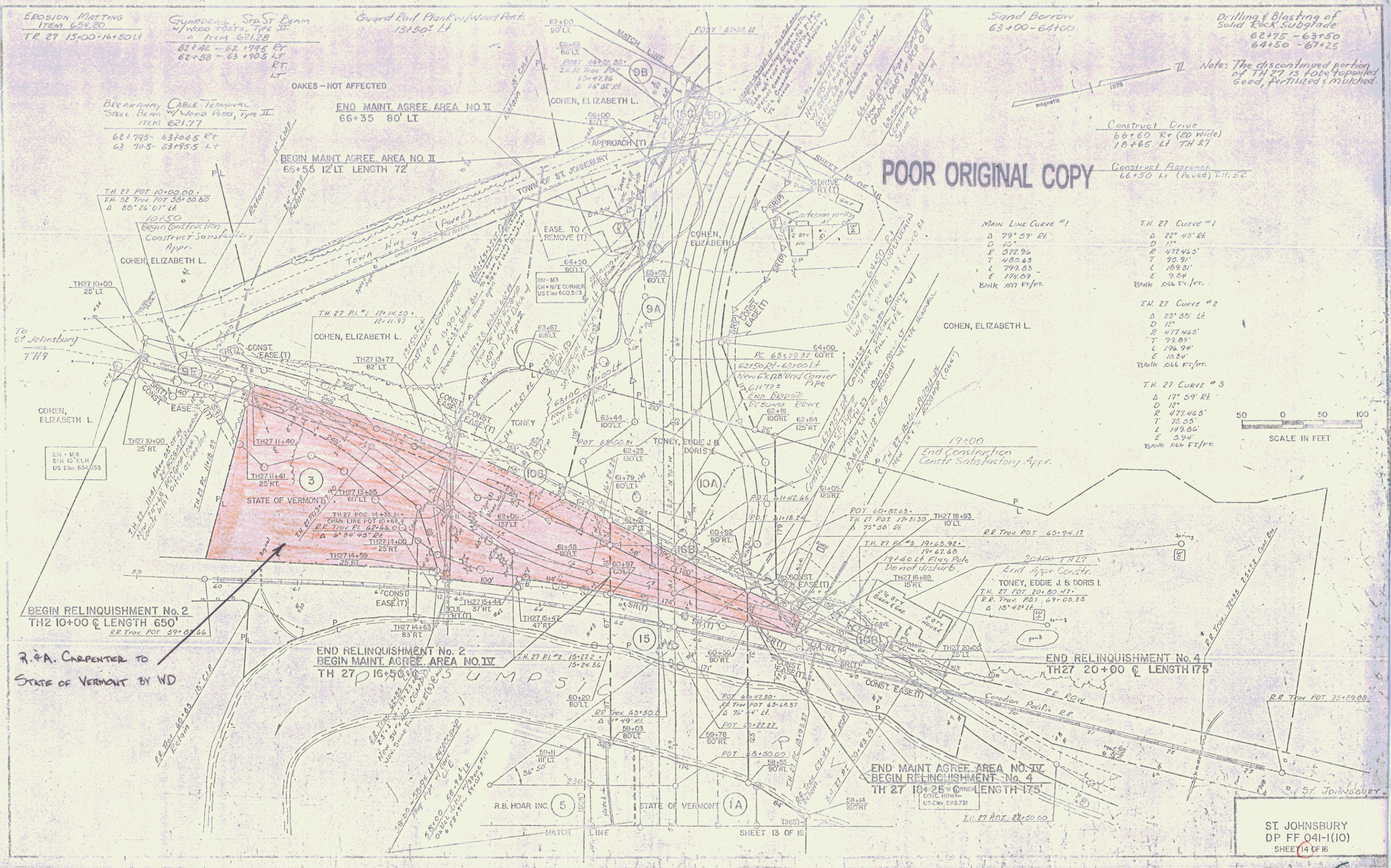

ST. JOHNSBURY
DP FF 041-1(10)
SHEET 14 OF 16

5

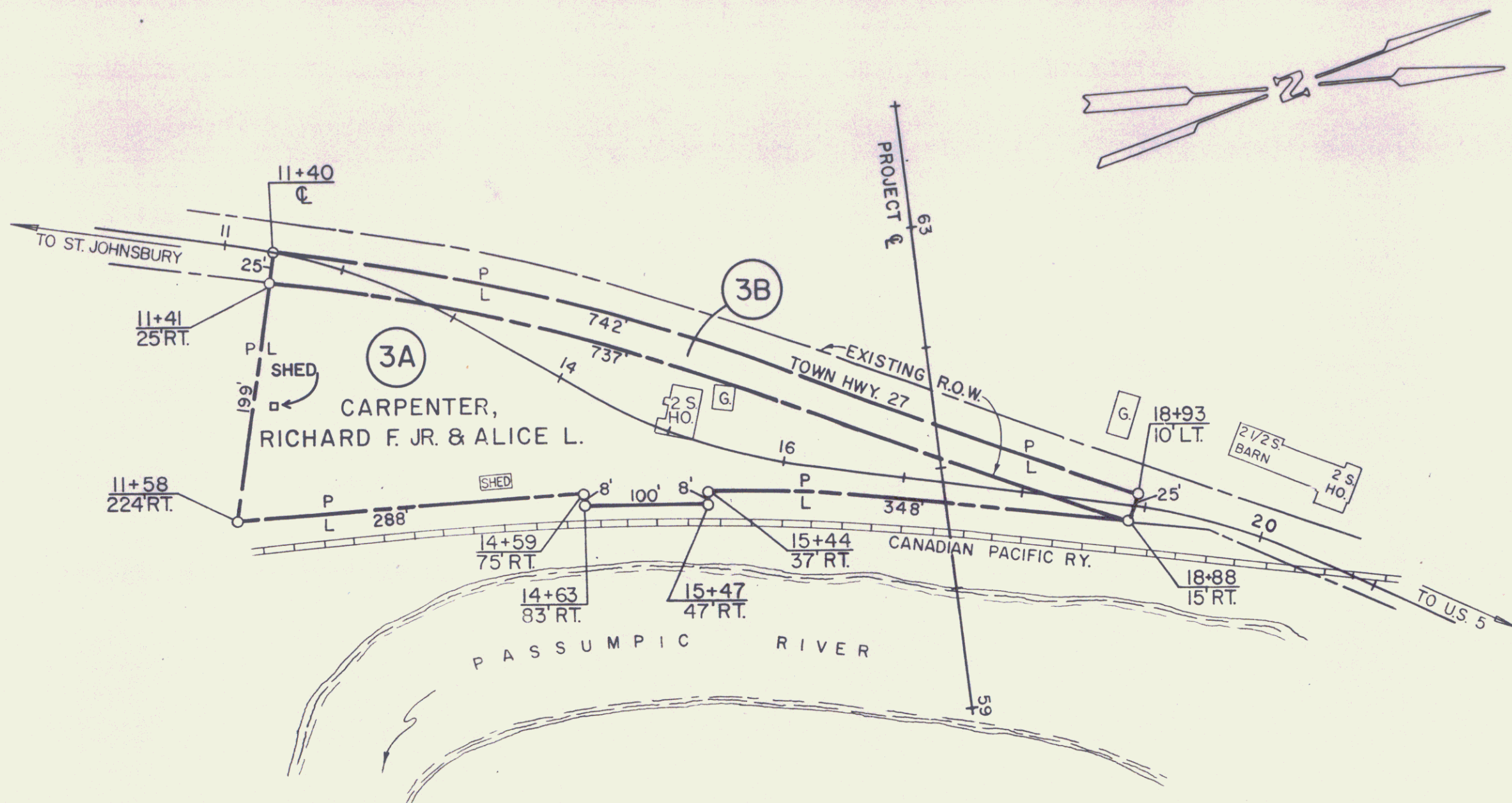

PARCEL NO.	GRANTOR	BEGINNING STATION	ENDING STATION	TAKING	TITLE TAKEN	RIGHTS	REMARKS
3 A	CARPENTER, RICHARD F. JR. & ALICE L.	T.H. 27 11+41 RT. 14+00 RT. 15+00 LT. 15+35 LT. 11+60 RT.	18+88 RT.	1.66 A±	W.D.		SHED 2 STORY HOUSE GARAGE SHED
B		T.H. 27 11+40 CL	18+93 LT.	0.42 A±		ALL R.T. & I.	HIGHWAY EASEMENT T.H. 27

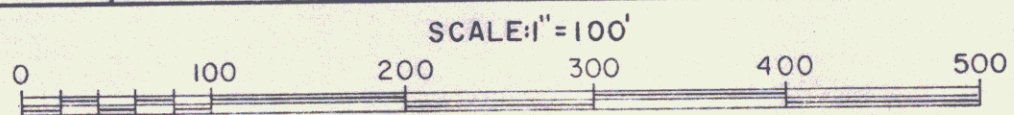

STATE OF VERMONT
 AGENCY OF TRANSPORTATION /
 SHEET 14A
 ST. JOHNSBURY
 PROJECT: FF 041-1(10) 6
 APPROX SCALE 1"=100' DATE: 6-12-79 DRAWN BY: S.J.B.

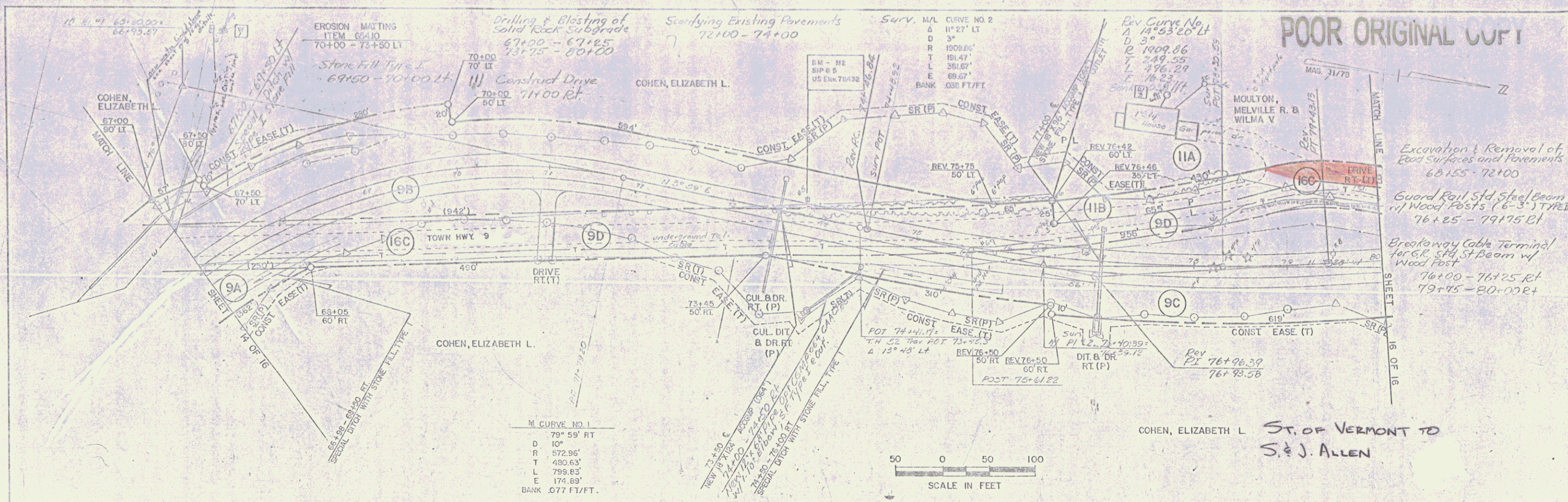

M CURVE NO 1

D	79° 59' RT
R	572.96'
T	430.63'
L	799.83'
E	174.69'
BANK	0.77 FT/FT

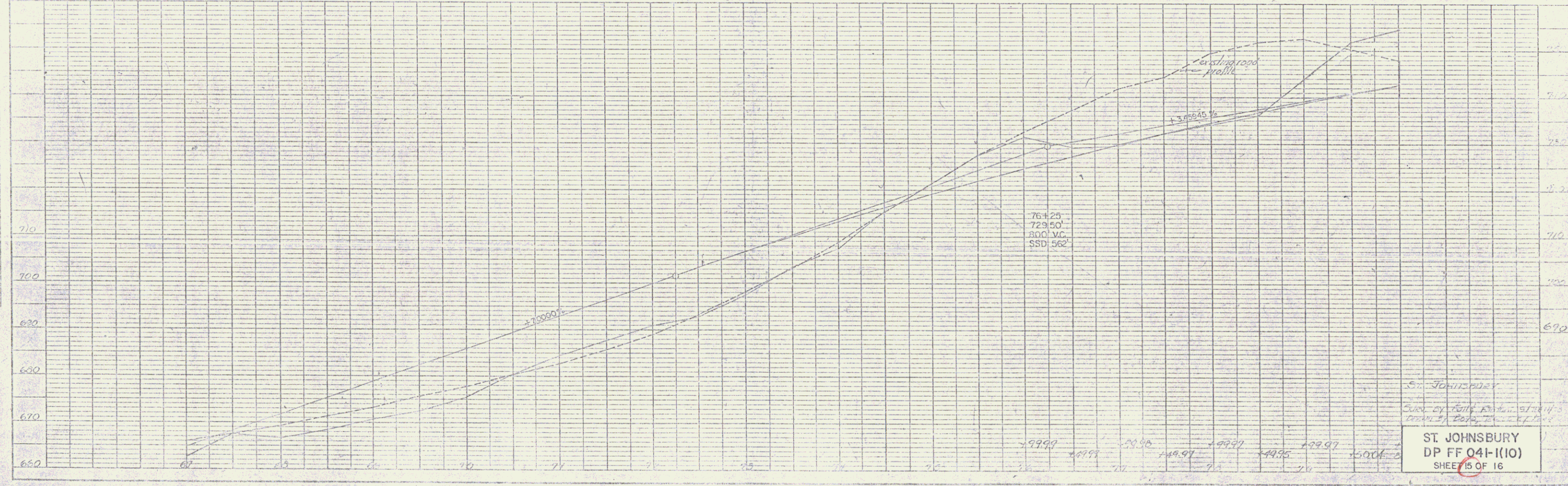

ST JOHNSBURY
 DP FF 041-1(10)
 SHEET 15 OF 16

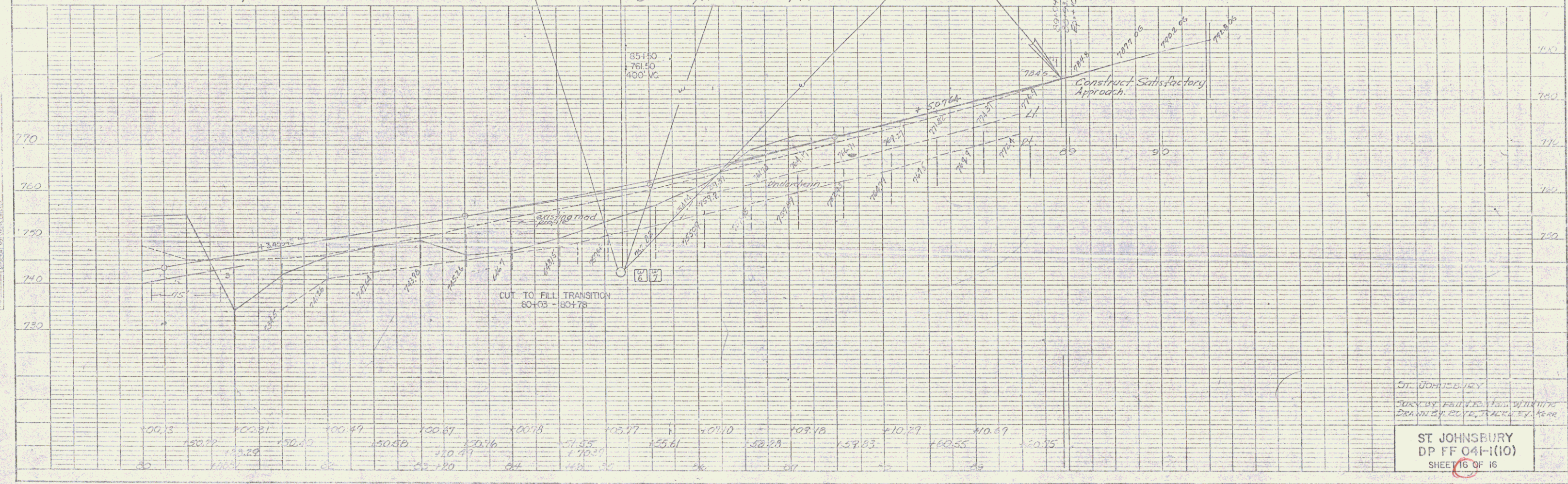
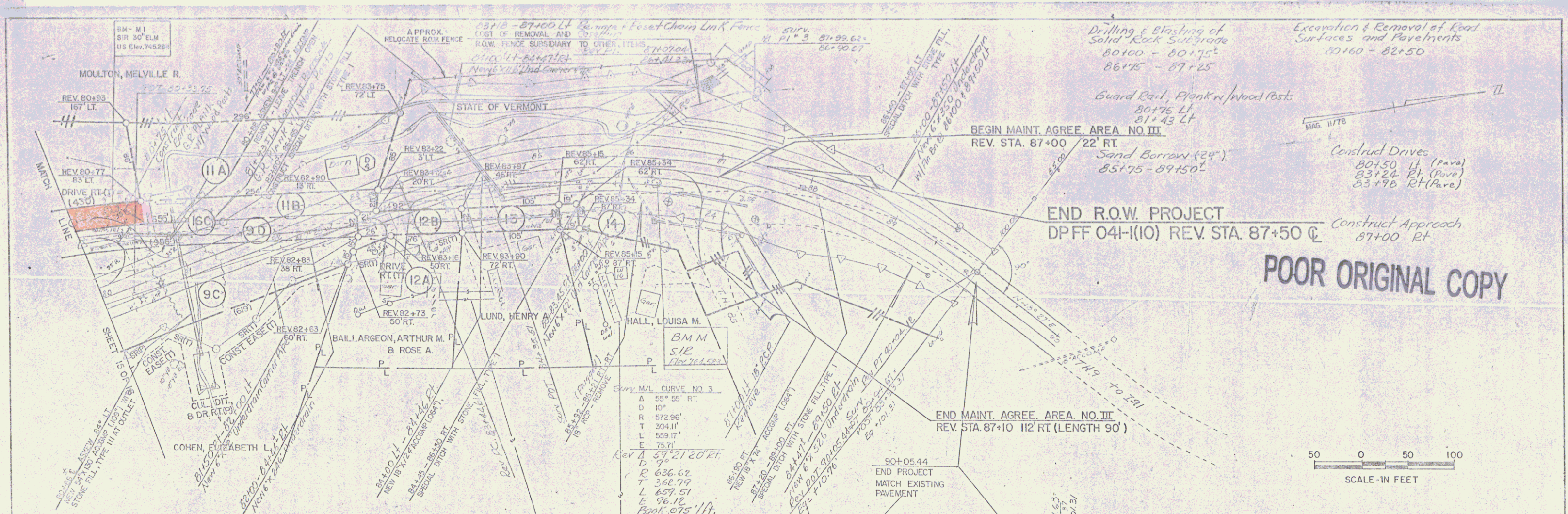

NOTE BOOK

PROFILE

POOR ORIGINAL COPY

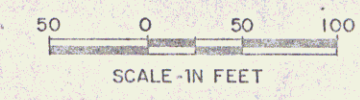

ST. JOHNSBURY
 JUN 25 1955
 DRAWN BY: [unclear], CHECKED BY: [unclear]
ST. JOHNSBURY
DP FF 041-I(10)
 SHEET 16 OF 16

PART OF THE SAME LAND ACQUIRED BY THE
 STATE OF VERMONT FROM THE TOWN OF ST.
 JOHNSBURY AND MELVILLE R. & WILMA V.
 MOULTON BY WARRANTY DEED DATED JUNE 6,
 1984, RECORDED JUNE 28, 1984 IN BOOK 179,
 PAGE 365 OF THE ST. JOHNSBURY LAND RECORDS.

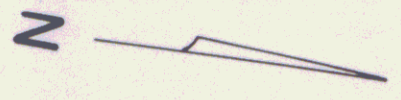
MAG. 11/78 

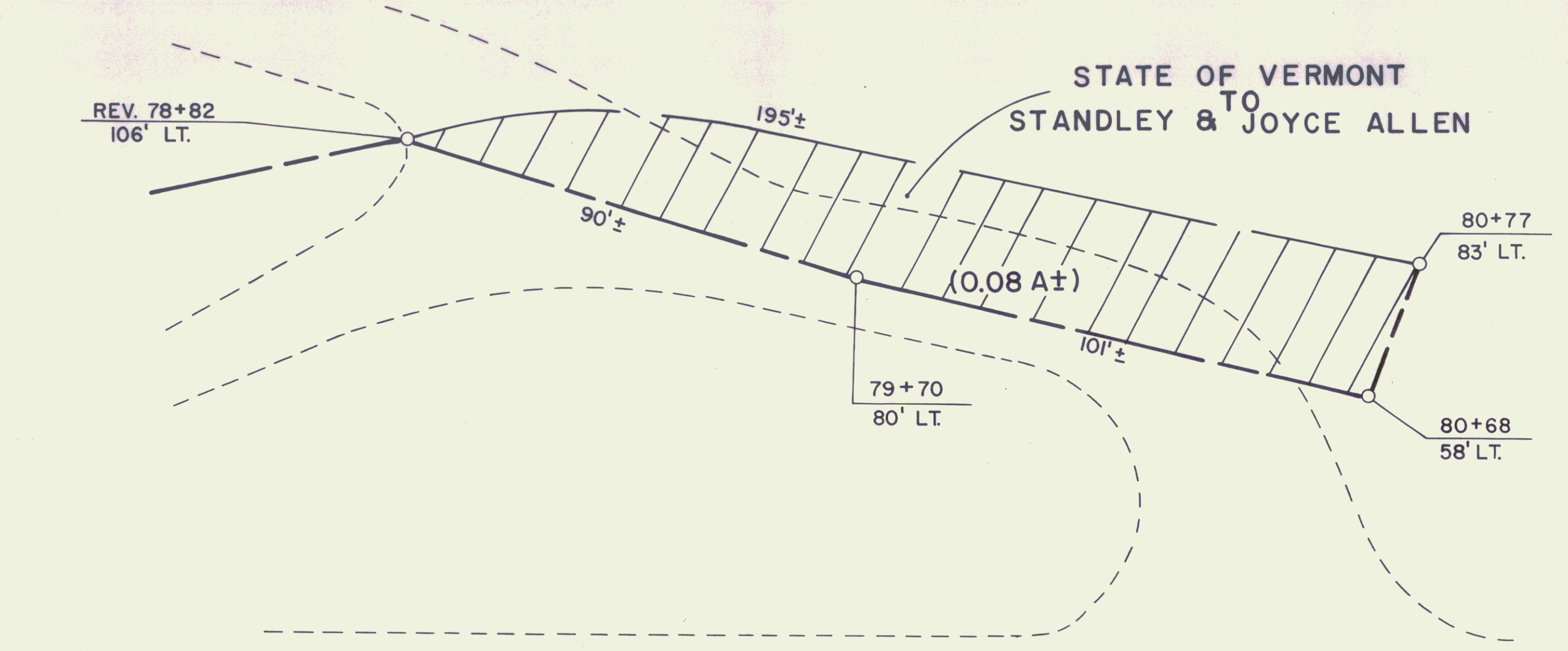

STATE OF VERMONT
 STANDLEY & ^{TO} JOYCE ALLEN

← TO ST JOHNSBURY 79 T.H. 9 80 TO I-91 →

RF: ST. JOHNSBURY DP FF 041-1(10)
 SHEET 38-39 OF 229

STATE OF VERMONT
 AGENCY OF TRANSPORTATION
 SHEET 16A
 TOWN OF ST. JOHNSBURY
 9



APPROX SCALE 1"=20' DATE: 3-2-88 DRAWN BY M.R.

THIS IS PART OF THE SAME LAND AND PREMISES CONVEYED TO THE STATE OF VERMONT BY THE FOLLOWING INSTRUMENTS: WARRANTY DEED FROM MELVILLE R. MOULTON & WILMA V. MOULTON DATED JUNE 21, 1984 AND RECORDED IN BOOK 179 PAGES 365-367, AND CONDEMNATION ORDER FROM ELIZABETH L. COHEN AND THE TOWN OF ST. JOHNSBURY DATED NOV. 14, 1984 AND RECORDED IN BOOK 181, PAGES 130-139, BOTH OF THE LAND RECORDS OF THE TOWN OF ST. JOHNSBURY.

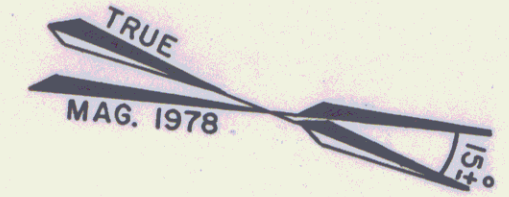

STATE OF VERMONT
TO
STANLEY ALLEN & JOYCE ALLEN

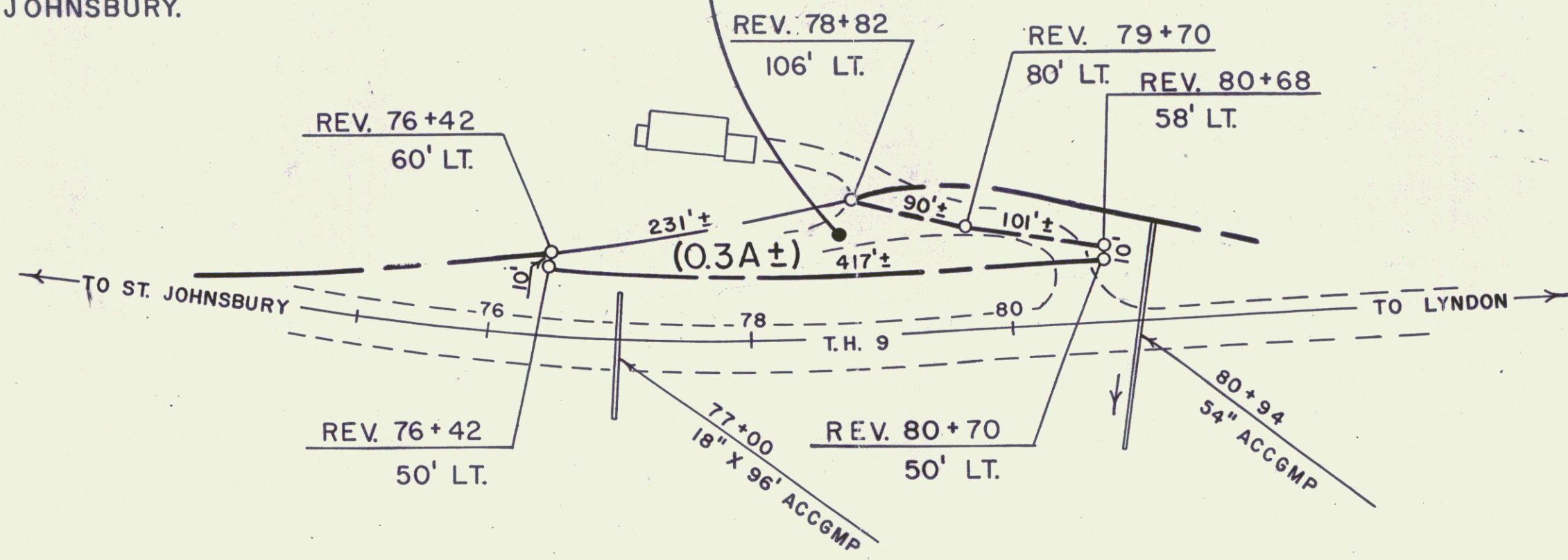

REF: ST. JOHNSBURY DP-FF 041-1(10)
SHEETS 37 & 38 OF 229

STATE OF VERMONT AGENCY OF TRANSPORTATION		
SHEET 16B		
TOWN OF ST. JOHNSBURY		
10		
APPROX. SCALE: 1"=100'	DATE: 1-13-92	DRAWN BY M.R.

