

PART OF THE SAME LAND ACQUIRED BY THE  
STATE OF VERMONT FROM THE TOWN OF ST.  
JOHNSBURY AND MELVILLE R. & WILMA V.  
MOULTON BY WARRANTY DEED DATED JUNE 6,  
1984, RECORDED JUNE 28, 1984 IN BOOK 179,  
PAGE 365 OF THE ST. JOHNSBURY LAND RECORDS.

MAG. 11/78 

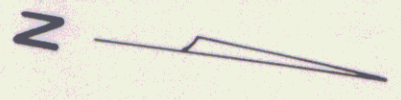

← TO ST JOHNSBURY 79 ———— C T.H. 9 ———— 80 TO I-91 →

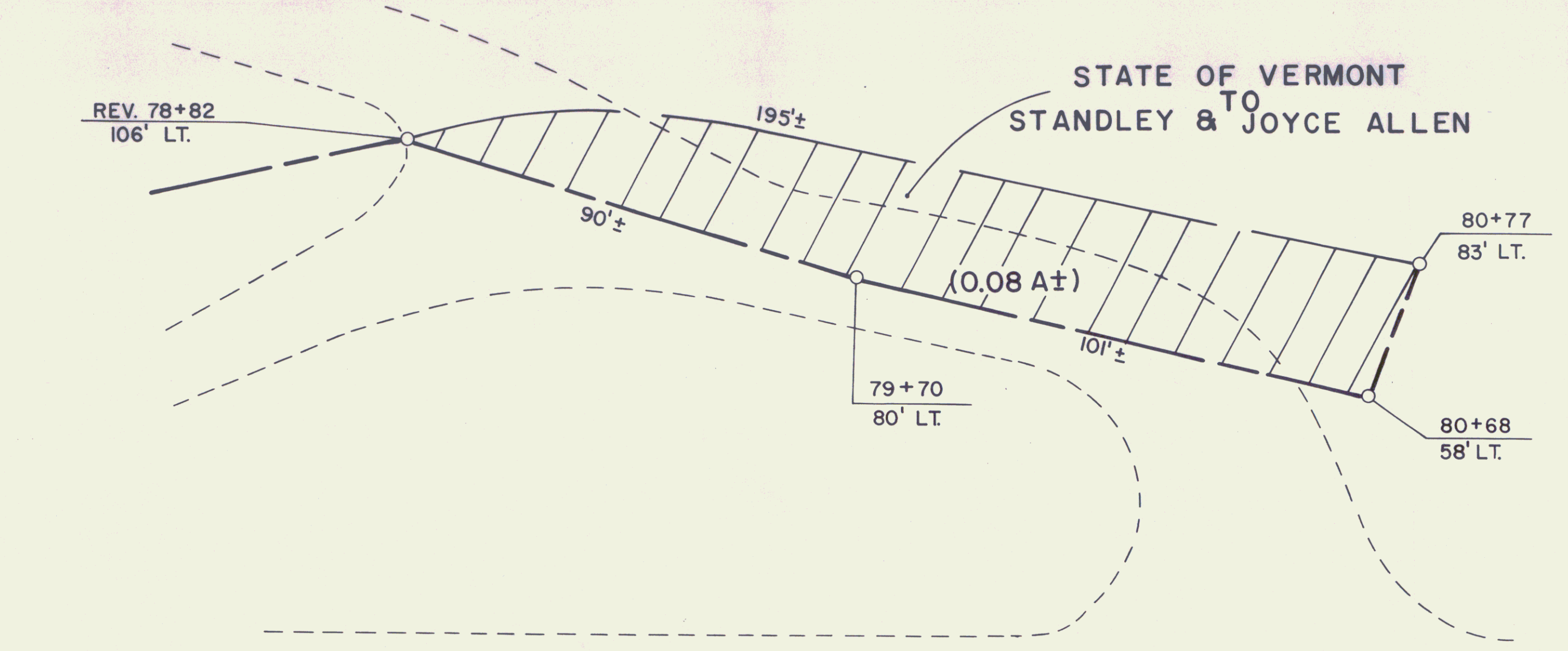
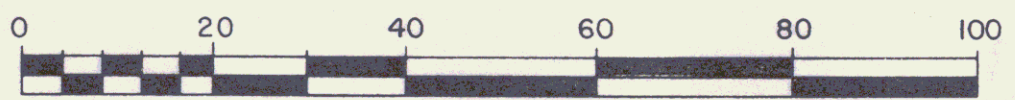

RF: ST. JOHNSBURY DP FF 041-1(10)  
SHEET 38-39 OF 229

STATE OF VERMONT  
AGENCY OF TRANSPORTATION  
SHEET 16A  
TOWN OF ST. JOHNSBURY  
9

APPROX SCALE 1"=20' DATE: 3-2-88 DRAWN BY M.R.