

INDEX OF SHEETS

1. TITLE SHEET
2. POLE BARN DETAILS

RECORD PLANS-MATERIALS
 DUXBURY-MORETOWN RS 0213 (3) A ROW POLE BARN
 CONTRACTOR-GEORGE BURNHAM, JR., MIDDLEBURY, VT.
 CONTRACT DATED AND SIGNED-14 SEPTEMBER 1976
 CONSTRUCTION BEGAN-21 SEPTEMBER 1976
 CONSTRUCTION COMPLETED-31 OCTOBER 1976
 CONSTRUCTION ACCEPTED-2 NOVEMBER 1976
 RESIDENT ENGINEER-RL STANCLIFF
 CONCRETE-A.G. ANDERSON, WATERBURY, VT.
 SUB-BASE OF GRAVEL-MARSHALL PIT, MORETOWN, VT.
 LUMBER-LACILADE LUMBER CO. INC., WILLIAMSTOWN, VT.
 RECORD PLANS-PAUL E. SINGLETON

NOTE: ANY FURTHER INFORMATION CONCERNING FINAL QUANTITIES, AMOUNTS OR OTHER DETAILS RELATIVE TO THIS PROJECT MAY BE FOUND IN EITHER THE FIELD BOOKS OR THE ESTIMATE FILE.

BUILT AS DESIGNED

STATE OF VERMONT
 DEPARTMENT OF HIGHWAYS



FEDERAL AID SECONDARY

PROPOSED IMPROVEMENT
TOWNS OF DUXBURY-MORETOWN
 COUNTY OF WASHINGTON
VERMONT ROUTE 100

BEGINNING AT A POINT ON VT ROUTE 100, 0.047 MILES NORTHEASTERLY OF THE INTERSECTION OF VT. ROUTE 100 AND TH 4 IN THE TOWN OF DUXBURY AND EXTENDING 0.758 MILES NORTHEASTERLY TO US ROUTE 2 IN THE TOWN OF MORETOWN

LENGTH OF ROADWAY 4003.34 FEET • 0.758 MILES
 LENGTH OF BRIDGE
 LENGTH OF PROJECT 4003.34 FEET • 0.758 MILES

1974 ADT = 2175
 1994 ADT = 4340
 1994 DNV = 590
 D = 62%
 T = 6%
 V = 50 MPH

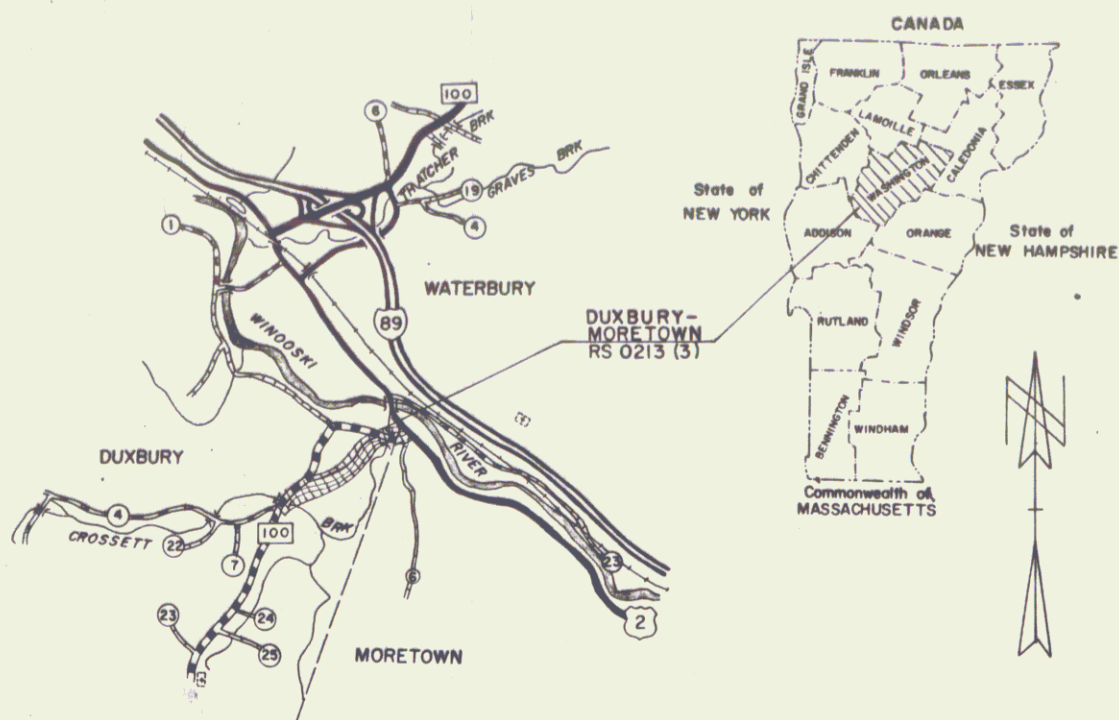

THESE PLANS ARE SUBJECT TO SUCH ENGINEERING CHANGES AS MAY BE REQUIRED BY THE FEDERAL HIGHWAY ADMINISTRATION OR THE CHIEF ENGINEER. CONSTRUCTION IS TO BE CARRIED ON IN ACCORDANCE WITH THESE PLANS AND THE STANDARD SPECIFICATIONS FOR HIGHWAY AND BRIDGE CONSTRUCTION DATED JANUARY 3, 1972 AS APPROVED BY THE FEDERAL HIGHWAY ADMINISTRATION ON DECEMBER 28, 1971 FOR USE ON THIS PROJECT, INCLUDING ALL SUBSEQUENT REVISIONS AND SUCH REVISED SPECIFICATION AND SPECIAL PROVISIONS AS ARE INCORPORATED IN THESE PLANS.

Date: 01/23/1975
Pin: 96C-067

- CONVENTIONAL SIGNS
- COUNTY LINE
 - TOWN LINE
 - LIMITS OF ACCESS
 - POINT OF ACCESS
 - FENCE LINE
 - STONE WALL
 - TRAVELED WAY
 - ROAD RAIL
 - RAILROAD
 - SURVEY LINE
 - CULVERT
 - POWER POLE
 - TELEPHONE POLE
 - TREES
 - F.A. CONST. IDENTIFICATION SIGNS
 - PROPERTY LINE
 - R.O.W. TAKING LINE
 - SLOPE RIGHTS
 - TOP OF CUT
 - TOE OF SLOPE
- BENCH MARKS BASED ON U.S.G.S. ELEVATIONS

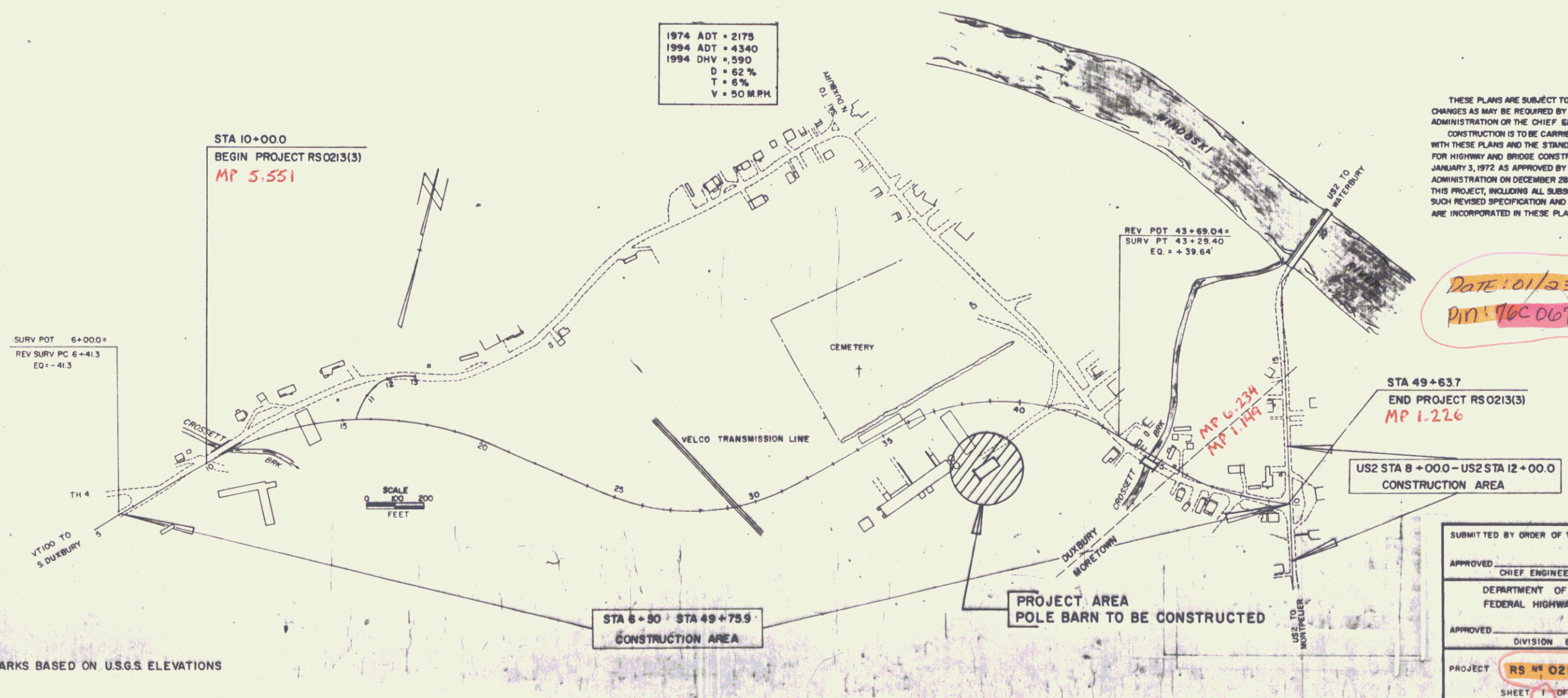

SUBMITTED BY ORDER OF THE STATE HIGHWAY DEPARTMENT

APPROVED: _____ DATE: _____
 CHIEF ENGINEER

DEPARTMENT OF TRANSPORTATION
 FEDERAL HIGHWAY ADMINISTRATION

APPROVED: _____ DATE: _____
 DIVISION ENGINEER

PROJECT: **RS # 0213(3) A ROW**

SHEET 1 OF 2 SHEETS