

TOWN OF LOWELL  
COUNTY OF ORLEANS  
VERMONT ROUTE # 58

LOWELL - RAVENHILL ROAD

R.O.W. PLANS

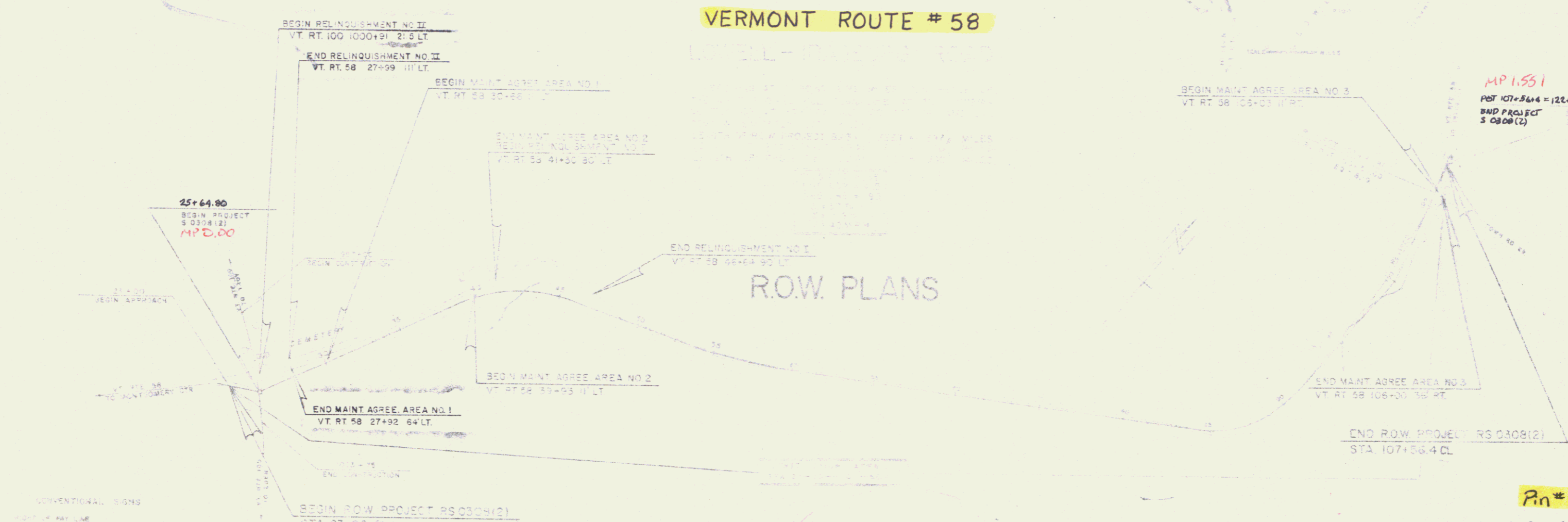

CONVENTIONAL SIGNS

RIGHT OF WAY LINE	---
STATE ROUTE	---
...	---

POOR ORIGINAL COPY

MP 1.551  
POT 107+56.4 = 126+57.35  
END PROJECT  
S 0308(2)

Pin # 76C064  
SEP 09 1988

APPROVED	<i>[Signature]</i>
DATE	7-15-75

RS0308(2)

STATE OF VERMONT  
DEPARTMENT OF HIGHWAYS  
RIGHT-OF-WAY PLANS  
DETAIL SHEET

TABLE OF PROJECT PROPERTY ACQUISITION

PARCEL NO	GRANTOR	SHEET NO	BEGINNING STATION	ENDING STATION	TAKING	REM	RIGHTS	TITLE TAKEN	DATE	TOWN OR CITY RECORDED	BK	PG	REMARKS
1 A	STATE OF VERMONT	10	1004+00 LT	32+87 RT	1.34 A±		SLOPE RT (T) (1.004 A±)	WD	7-15-75	LOWELL	26	430	FORMERLY J GIBSON 200 SF ± WATERLINE TRAILER FOUNDATION
			27+85 RT	28+50 RT									
			1002+44 LT	26+50 RT									
			26+10 RT										
			26+35 CL										
26+25 RT	30+00 RT	0.51 A±	ALL R T & I	WD	10-27-75	LOWELL	27	79	WATERLINE DRIVE 15', GRAVEL DRIVE RELEASE DATE DRIVE PERMIT DATE				
1005+84 LT	32+87 RT												
1 B		10	1001+29 LT	32+85 RT	0.70 A±		ALL R T & I	WD	10-27-75	LOWELL	26	430	HWY EASE VT RTE 50
1 C		10	1000+91 CL	1005+91 CL	0.45 A±		ALL R T & I	WD	10-27-75	LOWELL	26	430	HWY EASE VT RTE 100
					TOTAL	2.49 A±	0.51 A±						
2	BENWARE, PAULINE	10	1002+48 RT	28+50 RT	NONE		ALL R T & I DRIVE RT (T)	WD	6-16-76	LOWELL	27	79	WATERLINE DRIVE 15', GRAVEL DRIVE RELEASE DATE DRIVE PERMIT DATE
3	BENWARE, GORDON R & CHARLOTTE L H & W	10, 13	41+48 RT 1002+20 RT 24+34 RT	45+67 LT 29+34 RT	NONE		ALL R T & I ALL R T & I DRIVE RT (T)	WD	6-25-76	LOWELL	27	91	WATERLINE WATERLINE DRIVE 15', GRAVEL DRIVE RELEASE DATE DRIVE PERMIT DATE
4	SOUTHER, FRANCIS W & BARBARA H & W	10	995+60 RT 1000+15 RT 989+50 RT	1000+48 RT	NONE		SLOPE RT (T) (.01 A±) CULVERT RT (P) DRIVE RT (T)	WDE	9-9-76	LOWELL	27	173	475 SF ± RT TO CONST & MAINT CUL & DROP INLET DRIVE 15', GRAVEL, N.P. (4.43) DRIVE RELEASE DATE DRIVE PERMIT DATE

TABLE OF REVISIONS

REVISION NO	SHEET NO	DESCRIPTION OF REVISION	DATE	MADE BY	APPROVED BY
1	7/1/75	Parcel #13 Added Drive At Sta 85+25 Rt & 100+00 Rt Deleted Drive At Sta 88+30 Rt Per Change Order # 3010	7/1/75	KDP	G.E.S.
2	8-17	Parcel #5 Change in Title from Thiels to Collins. CO # 3020	10-27-75	Red S	
3	7	Parcel #11F Added Waterline & Spring in Remarks at sta 9+53 Lt, 96+25 Lt (Except & Reserve to Collins) CO # 3019	10-27-75	Red S	
4	8	Parcel #15 Eliminated All RT & I to Waterline & Spring at sta 94+35 Lt, 96+25 Lt, a steel (Except & Reserve) in Remarks Eliminated All RT & I to Sewer Line at sta 94+22 Lt, 94+25 Lt, added (Except & Reserve in Remarks. CO # 3018	10-27-75	Red S	
5	4-17	Parcel #8AD, Deleted 007A take from 8A & 004A: take from 8D, Per CO # 3035	11-21-75	Red S	
6	4-7, 8	Change of Sta 107+56.4 Per CO # 3036	11-21-75	Red S	
7	6-7, 9	Added New Parcel #1816/18B Harold J & Dorothy T. Haynes Parcel #11811/11E Silver Adjusted Take And Remainder Areas Per CO # 3075	20 Feb 76	KDP	J.P.P.
8	3-4, 6	Parcel #3 Benware Parcel #5 Warner & Parcel #6 3, 4, 5, 6 removed & Springs from remarks column Parcel #11E Drive Added at sta 45+15 Lt in remarks column - Spring (Except & Reserve to Benware, Warner & Scootie) Per CO # 3073	23 Feb 76	KDP	J.P.P.
9	4-5	Parcel #7 Low School District removed "6 Spring" from remarks column Parcel #9A Cushman Added at sta 45+70 Lt in remarks column - Spring (Except & Reserve to Lowell School District Per Change Order # 3074	23 Feb 76	KDP	J.P.P.
10	9-17	Parcel #18 Haynes Added Drive At Sta 85+00 Rt Per CO # 3076	26 Feb 76	KDP	J.P.P.
11	5-10	Parcel #10 Fuller Added Drive At Sta 33+00 Rt - Sta 37+00 Rt Per CO # 3077	26 Feb 76	KDP	J.P.P.
12	9-10	Added New Parcel #19 Gibson Per CO # 3078	26 Feb 76	KDP	J.P.P.
13	7-8	Parcel #2 Change in Title from Manning to LePlano Per CO # 3079	26 Feb 76	KDP	J.P.P.

MADE BY: K PERKINS DATE: 7 JULY 75  
CHECKED BY: J. PATERSON DATE: 8 JULY 75

DR RT - DRAINAGE RIGHT  
DIT RT - DITCHING RIGHT  
CH RT - CHANNEL RIGHT  
DRIVE RT - DRIVE RIGHT  
CUL RT - CULVERT RIGHT  
DEM RT - DEMOLITION OR REMOVAL  
W - WATER SOURCES

PRESENT R.O.W.  
--- TAKING WITHOUT ACCESS  
--- TAKING WITHOUT ACCESS ALONG PROPERTY LINES  
--- TAKING WITH ACCESS  
(P) PERMANENT EASEMENT  
(T) TEMPORARY EASEMENT

LEGEND  
SR SR SLOPE RIGHTS  
P L PROPERTY LINE  
-Δ-Δ-Δ- TOP OF CUT  
O O O TOP OF SLOPE

APPROVED: Norm P. Baker DATE: 7-15-75  
and CHIEF OF PLANS & TITLES

PROJECT: LOWELL  
NO. RSO 308 (2)  
SHEET 3 OF 18

STATE OF VERMONT  
DEPARTMENT OF HIGHWAYS  
RIGHT-OF-WAY PLANS  
DETAIL SHEET

TABLE OF PROJECT PROPERTY ACQUISITION

PARCEL NO.	GRANTOR	SHEET NO.	BEGINNING STATION	ENDING STATION	TAKING	REM.	RIGHTS	ACQ. DATE	TOWN OR CITY RECORDED	BK.	PG.	REMARKS
5	WARNER, JOHN W & LOIS H H & W	10, 13	41+48 RT 1000+92 LT 998+85 LT	45+67 LT 29+34 RT 1000+42 LT	NONE		ALL R.T. & I. ALL R.T. & I. SLOPE RT (T) (024)					WATERLINE WATERLINE 1120 SF.
6	SICOTTE, ALBERT N & HELENE T H & W	10, 13	41+48 RT 1000+92 LT 997+65 LT	45+67 LT 29+34 RT	NONE		ALL R.T. & I. ALL R.T. & I. DRIVE RT. (T)		LOWELL	27	160	WATERLINE WATERLINE DRIVE 15', GRAVEL, W.P. 4 46 DRIVE RELEASE DATE DRIVE PERMIT DATE DRIVE 15', GRAVEL, W.P. 4 45 DRIVE RELEASE DATE DRIVE PERMIT DATE
			998+50 LT				DRIVE RT (T)					
7	LOWELL SCHOOL DISTRICT	10, 13	1002+23 RT 41+48 RT	27+50 RT 45+10 LT	NONE		ALL R.T. & I. ALL R.T. & I.	WD 6-25-76	LOWELL	27	93	WATERLINE WATERLINE
8 A	TOWN OF LOWELL	10	1000+47 RT	1002+22 RT			RT TO CONST. APPR.					
8 B		13	37+30 RT 37+70 RT	38+54 RT	0.19 AC	NONE	ALL R.T. & I.					GARAGE
8 C		13	37+23 LT	38+33 LT	0.06 AC		ALL R.T. & I.					HWY EASE VT. RTE 58 (262 SF)
8 D		18	105+65 RT	100+28 RT			RT. TO CONST. APPR.					
				TOTAL		0.25 AC						

TABLE OF REVISIONS

REVISION NO.	SHEET NO.	DESCRIPTION OF REVISION	DATE	MADE BY	APPROVED BY
4	6, 7	Parcel #1 Silver Added Drives area from 4.64 to 4.84 Per Change Order #3090	25 June 76	KDP	
5	6, 7	Parcel #1 Silver Added Drives area from 4.64 to 4.84 Per Change Order #3090	25 June 76	KDP	
16	6, 16	Parcel #11 Silver Added Drives 18, 19, 21 STA 53+00 LT, 81+00 LT, 15 32+50 RT, 38+30 LT & 105+30 LT Per CO #3149	25 June 76	KDP	
17	4, 10	Parcel #5 Warner added notation for maple tree at approx Sta 998+62 LT and removed septic system shown on plans Per CO #3158	25 June 76	KDP	
18	9, 10	Parcel #8 Town of Lowell Reduced Maint Area Area 16.1 to Begin 64 LT of Vt. Rte 58 27+32. Added Relinquishment No 2. Begin Sta Vt. Rte 100 1000+31 21.5 LT. End Sta Vt. Rte 58 27+32 64 LT Per C.O. #3167	25 June 76	KDP	
19	10	Revised Approach To Town Highway West of Vt. 100 Per CO #3168	25 June 76	KDP	
20	4	Parcel #8 Town of Lowell Deleted All RTE I to Band- stand Per CO #3170	1 June 76	KDP	
21	9, 10	added running dist, sta, & offsets to Relinquishment No 2 & revised ending sta. Added Sign Maint Agree. Area. Revised end sta. to Relinquishment No 2 Per CO 3804	4/25/76	JPM	CS

MADE BY: E. PERSINS DATE: 7 JULY 75  
CHECKED BY: J. PATERSON DATE: 8 JULY 75

DR. RT. - DRAINAGE RIGHT  
DIT. RT. - DITCHING RIGHT  
CH. RT. - CHANNEL RIGHT  
DRIVE RT. - DRIVE RIGHT  
CUL. RT. - CULVERT RIGHT  
D - DEMOLITION OR  
REMOVAL  
W - WATER SOURCES

PRESENT R.O.W.  
--- TAKING WITHOUT ACCESS  
--- TAKING WITHOUT ACCESS ALONG PROPERTY LINES  
--- TAKING WITH ACCESS  
(P) PERMANENT EASEMENT  
(T) TEMPORARY EASEMENT

LEGEND  
SR - SR SLOPE RIGHTS  
P - P PROPERTY LINE  
-Δ- Δ- TOP OF CUT  
-O- O- TOP OF SLOPE

APPROVED: [Signature] DATE: 7-13-75  
CHIEF OF PLANS & TITLES

SEP 09 1988  
PROJECT: LOWELL  
NO. RS0308 (2)  
SHEET 4 OF 18



STATE OF VERMONT  
DEPARTMENT OF HIGHWAYS  
RIGHT-OF-WAY PLANS  
DETAIL SHEET

TABLE OF PROJECT PROPERTY ACQUISITION

PARCEL NO.	GRANTOR	SHEET NO.	BEGINNING STATION	ENDING STATION	TAKING	REM	RIGHTS	TITLE TAKEN	DATE	TOWN OR CITY RECORDED	BK	PG	REMARKS	
11 A	SILVER, GEORGE F	13, 15, 16	48+53 LT	72+50 LT	1.0 Ac		SLOPE RT. (T)	WD	9-3-76	LOWELL	27	168-169	180 S.F.	
			49+30 LT	50+20 LT			SLOPE RT. (T) 10.03 Ac						100 S.F.	
			55+00 LT	57+30 LT			SLOPE RT. (T) 10.01 Ac						507 S.F.	
			60+00 LT	62+00 LT			DRIVE RT. (T)						DRIVE 15' GRAVEL, W.P. 0.59	
			56+70 LT				DRIVE RT. (T)						DRIVE RELEASE DATE:	
62+60 LT		DRIVE RT. (T)	DRIVE PERMIT DATE:											
69+50 LT		DRIVE RT. (T)	DRIVE 15' GRAVEL, W.P. 0.70											
53+00 LT		DRIVE RT. (T)	DRIVE RELEASE DATE:											
													DRIVE PERMIT DATE:	
														DRIVE 15' GRAVEL, W.P. 0.83
														DRIVE RELEASE DATE:
														DRIVE PERMIT DATE:
														DRIVE 15' GRAVEL, W.P. 0.52
														DRIVE RELEASE DATE:
														DRIVE PERMIT DATE:
														BY OPTION ONLY
11 B		13, 15, 16, 17	52+32 RT	107+56.4 LT	1.71 Ac		DITCH & DRAINAGE (P)							423 S.F.
			57+00 RT	58+70 RT			SLOPE RT. (T) 10.01 Ac							
			58+50 RT	59+50 RT			DITCH & DRAINAGE (P)							
			66+00 RT	66+20 RT			DITCH RT. (P)							
			69+50 RT	69+70 RT			DITCH RT. (P)							
			71+40 RT	71+70 RT			DITCH RT. (P)							
			77+30 RT				DRAINAGE (P)							
			80+65 RT				DRAINAGE (P)							
			82+50 RT				DRIVE RT. (T)							
														DRIVE RELEASE DATE:
														DRIVE PERMIT DATE:
														BY OPTION ONLY
11 C		16, 17	77+00 LT	86+80 LT	0.59 Ac		DRIVE RT. (T)							DRIVE 15' GRAVEL, W.P. 1.05
			81+00 LT				DRIVE RELEASE DATE:							
														DRIVE PERMIT DATE:
														BY OPTION ONLY
11 D		18	98+00 LT	107+56.4 LT	1.2 Ac		DRIVE RT. (T)							DRIVE 15' GRAVEL, W.P. 1.30
			98+30 LT				DRIVE RELEASE DATE:							
							DRIVE PERMIT DATE:							
														BY OPTION ONLY
														DRIVE 15' GRAVEL, W.P. 1.51
														DRIVE RELEASE DATE:
														DRIVE PERMIT DATE:
														BY OPTION ONLY
11 E		10, 13, 15, 16, 17	36+51 LT	86+24 RT	2.48 Ac		ALL RT & I							Hwy. EASE. VT. RTE. 58
			39+90 LT				DRIVE 14' GRAVEL, W.P. 0.27							
			45+70 LT				DRIVE RELEASE DATE:							
														DRIVE PERMIT DATE:
														SPRING (EASEMENT & RESERVE TO BENBARE, J., WARNE, J. & SACKETT, A.)

TABLE OF REVISIONS

REVISION NO.	SHEET NO.	DESCRIPTION OF REVISION	DATE	MADE BY	APPROVED BY

PARCEL 11 CONTINUED ON NEXT SHEET

MADE BY: B. PERKINS DATE: 8 JULY 75  
 CHECKED BY: J. PATERSON DATE: 9 JULY 75

DR. RT. - DRAINAGE RIGHT  
 DIT. RT. - DITCHING RIGHT  
 CH. RT. - CHANNEL RIGHT  
 DRIVE RT. - DRIVE RIGHT  
 CUL. RT. - CULVERT RIGHT  
 (D) - DEMOLITION OR REMOVAL  
 (W) - WATER SOURCES

PRESENT R.O.W.  
 --- TAKING WITHOUT ACCESS  
 --- TAKING WITHOUT ACCESS ALONG PROPERTY LINES  
 --- TAKING WITH ACCESS  
 (P) - PERMANENT EASEMENT  
 (T) - TEMPORARY EASEMENT

LEGEND  
 ---SR---SR--- SLOPE RIGHTS  
 ---P---P--- PROPERTY LINE  
 ---Δ---Δ---Δ--- TOP OF CUT  
 ---○---○---○--- TIDE OF SLOPE

APPROVED: [Signature] DATE: 7/11/75  
 CHIEF OF PLANS & TITLES

SEP 09 1988  
 PROJECT: LOWELL  
 NO. RS0308 (2)  
 SHEET 6 OF 18

STATE OF VERMONT  
DEPARTMENT OF HIGHWAYS  
RIGHT-OF-WAY PLANS  
DETAIL SHEET

TABLE OF PROJECT PROPERTY ACQUISITION

PARCEL NO.	GRANTOR	SHEET NO.	BEGINNING STATION	ENDING STATION	TAKING	REM.	RIGHTS	TITLE TAKEN	DATE	TOWN OR CITY RECORDED	BK	PG	REMARKS
11 F	SILVER, GEORGE	17, 18	94+40 LT. 94+53 LT.	107+56 4/11 LT. 96+25 LT.	1.0 Ac.		ALL RT & I.						HWY EASE VT RTE 58 WATERLINE & SPRING (EXCEPT & RESERVE TO COLLINS, MERLE G & WANDETTA V.)
				TOTAL	7.90 Ac.	823.41 Ac.							
12 A	LEBLANC, HERMAN & LUCERNE	13	44+11 RT. 50+80 RT. 44+50 RT.	52+32 RT. 51+20 LT.	1.41 Ac.		ALL RT & I. DRIVE RT. (T)	WD	8-9-76	LOWELL	27	143	FORMERLY NANNING, RICHARD & DYMETTE I. WATERLINE DRIVE 15', GRAVEL, M.P. 0.36 DRIVE RELEASE DATE: DRIVE PERMIT DATE: DRIVE 15', PAVED, M.P. 0.45 DRIVE RELEASE DATE: DRIVE PERMIT DATE:
			49+75 RT.				DRIVE RT. (T)						
			44+11 RT.	52+32 RT.		6.68 Ac.							
12 B		13	45+70 LT.	52+32 RT.	0.33 Ac.		ALL RT & I.						HWY EASE VT RTE 58
				TOTAL	1.74 Ac.	6.68 Ac.							
13 A	STACKPOLE, DAVID B.	17, 18	87+87 RT. 86+25 RT.	105+74 RT.	1.70 Ac.		DRIVE RT. (T)						DRIVE 12', GRAVEL, M.P. 0.69 DRIVE RELEASE DATE: DRIVE PERMIT DATE: WATERLINE
			88+75 RT. 88+95 RT. 92+50 RT. 94+25 RT. 85+95 RT.	88+80 LT. 94+60 RT. 105+65 RT.		596.71 Ac.	ALL RT & I. DRAINAGE (P) DRAINAGE (P) DITCH RT (P)						
13 B		17, 18	85+95 RT. 100+00 RT.	108+03 RT.	1.59 Ac.		ALL RT & I. DRIVE RT. (T)						HWY EASE VT RTE 58 DRIVE 12', GRAVEL, M.P. 0.95 DRIVE RELEASE DATE: DRIVE PERMIT DATE:
				TOTAL	3.29 Ac.	596.71 Ac.							

TABLE OF REVISIONS

REVISION NO.	SHEET NO.	DESCRIPTION OF REVISION	DATE	MADE BY	APPROVED BY

MADE BY: E. PERKINS DATE: 9 JULY 75  
CHECKED BY: J. PATERSON DATE: 10 JULY 75

DR RT - DRAINAGE RIGHT  
DT RT - DITCHING RIGHT  
CH RT - CHANNEL RIGHT  
DRIVE RT - DRIVE RIGHT  
CUL RT - CULVERT RIGHT  
⊙ - DEMOLITION OR REMOVAL  
W - WATER SOURCES

----- PRESENT R.O.W.  
--- TAKING WITHOUT ACCESS  
--- TAKING WITHOUT ACCESS ALONG PROPERTY LINES  
--- TAKING WITH ACCESS  
(P) PERMANENT EASEMENT  
(T) TEMPORARY EASEMENT

LEGEND

SR - SR SLOPE RIGHTS  
P - P PROPERTY LINE  
Δ - Δ TOP OF CUT  
○ - ○ TOP OF SLOPE

APPROVED: [Signature] DATE: 7-14-75  
CHIEF OF PLANS & TITLES

PROJECT: LOWELL  
NO. RSO308(2)  
SHEET 7 OF 18

SEP 09 1975

STATE OF VERMONT  
DEPARTMENT OF HIGHWAYS  
RIGHT-OF-WAY PLANS  
DETAIL SHEET

TABLE OF PROJECT PROPERTY ACQUISITION

PARCEL NO.	GRANTOR	SHEET NO.	BEGINNING STATION	ENDING STATION	TAKING	REM	RIGHTS	TITLE TAKEN	DATE	TOWN OR CITY RECORDED	BK	PG	REMARKS
14A	KOLVOORD, PHILIP A & DOLLIVER, RODNEY C	17	86+26 RT	93+27 LT	0.70 Ac		SLOPE RT (T) DRIVE RT (T)						765 F.S. DRIVE 15' GRAVEL, W.P. 1.25 DRIVE RELEASE DATE: DRIVE PERMIT DATE:
			90+40 LT	90+85 LT									
			92+00 LT										
			86+80 LT	93+27 LT	1.93 Ac								
14B		18	106+15 RT	107+56.4RT	0.14 Ac								
			106+15 RT	107+56.4RT	14.77 Ac								
14C		17	86+07 RT	89+37 LT	0.57 Ac		ALL RT & I.						HWY EASE. VT. RTE. 58
14D		18	106+00 RT	107+56.4LT	0.09 Ac		ALL RT & I.						HWY EASE. VT. RTE. 58 (38405 F.S.)
			TOTAL		1.50 Ac	16.70 Ac							
15	COLLINS, MERLE G. & WARETTA V. (H&W)	17	93+27 LT	94+57 LT	0.10 Ac		ALL RT & I. DRIVE RT (T)	WD	7-8-78	LOWELL	27	108	HWY EASE. VT. RTE. 58 DRIVE 15' GRAVEL, W.P. 1.29 DRIVE RELEASE DATE: DRIVE PERMIT DATE: SEWER LINE (EXCEPT & RESERVE) WATERLINE & SPRING (EXCEPT & RESERVE)
			94+22 LT	94+25 RT									
			94+35 LT	96+25 LT									
			93+27 LT	94+49 LT	0.97 Ac								
16	VT ELECTRIC CO-OP												UTILITY
17	NEW ENGLAND TELEPHONE & TELEGRAPH COMPANY												UTILITY

TABLE OF REVISIONS

REVISION NO.	SHEET NO.	DESCRIPTION OF REVISION	DATE	MADE BY	APPROVED BY

MADE BY: E. PERKINS DATE 10 JULY 75  
CHECKED BY: J. PATERSON DATE 10 JULY 75

DR. RT. - DRAINAGE RIGHT  
DIT. RT. - DITCHING RIGHT  
CH. RT. - CHANNEL RIGHT  
DRIVE RT. - DRIVE RIGHT  
CUL. RT. - CULVERT RIGHT  
⊖ - DEMOLITION OR REMOVAL  
[W] - WATER SOURCES

----- PRESENT R.O.W.  
--- TAKING WITHOUT ACCESS  
--- TAKING WITHOUT ACCESS ALONG PROPERTY LINES  
--- TAKING WITH ACCESS  
(P) PERMANENT EASEMENT  
(T) TEMPORARY EASEMENT

LEGEND  
---SR---SR--- SLOPE RIGHTS  
---P---P--- PROPERTY LINE  
---Δ---Δ---Δ--- TOP OF CUT  
---O---O---O--- TOP OF SLOPE

APPROVED: [Signature] DATE 7-1978  
CHIEF OF PLANS & TITLES

SEP 09 1988  
PROJECT LOWELL  
NO. RSQ308 (2)  
SHEET 8 OF 18

STATE OF VERMONT  
DEPARTMENT OF HIGHWAYS  
RIGHT-OF-WAY PLANS  
DETAIL SHEET

TABLE OF PROJECT PROPERTY ACQUISITION

PARCEL NO.	GRANTOR	SHEET NO.	BEGINNING STATION	ENDING STATION	TAKING	REM.	RIGHTS	TITLE TAKEN	DATE	TOWN OR CITY RECORDED	BK.	PG.	REMARKS
	RELINQUISHMENT NO. I RELINQUISHMENT NO. II		41+30 LT. VT. RTE. 100 1000-S+LT	46+64 LT. 27+85 LT.									
	MAINTENANCE AGREE AREA NO. 1		30+66 LT.	27+92 LT.									
	MAINTENANCE AGREE AREA NO. 2		38+95 LT.	41+30 LT.									
	MAINTENANCE AGREE AREA NO. 3		106+03 RT.	106+00 RT.									
18 A	HAYNES, HAROLD J. & DOROTHY T.	17	84+30 RT. 85+00 RT.	85+95 RT.	0.02 Ac.		DRIVE (T)	WD	7-20-76	LOWELL	27	122	(1046 S.F.) 34' WIDE GRAVEL, HP 0.67 DRIVE RELEASE DATE DRIVE PERMIT DATE
18 B		17	84+54 RT.	86+07 RT.	0.13 Ac.		ALL RT & I						(5709 S.F.) HWY EASE VT. RTE. 100
			84+30 RT.	85+95 RT.	0.50 Ac.								
				TOTAL	0.15 Ac.	0.50 Ac.							
19	GIBSON, JAMES N.	10	34+00 RT.				ALL RT & I	WD	7-20-76	LOWELL	27	120	ROW

TABLE OF REVISIONS

REVISION NO.	SHEET NO.	DESCRIPTION OF REVISION	DATE	MADE BY	APPROVED BY

MADE BY: K. PERKINS DATE 10 JULY 75  
CHECKED BY: J. PATERSON DATE 10 JULY 75

DR. RT. - DRAINAGE RIGHT  
DIT. RT. - DITCHING RIGHT  
CH. RT. - CHANNEL RIGHT  
DRIVE RT. - DRIVE RIGHT  
CUL. RT. - CULVERT RIGHT  
⊖ - DEMOLITION OR REMOVAL  
W - WATER SOURCES

----- PRESENT R.O.W.  
--- TAKING WITHOUT ACCESS  
--- TAKING WITHOUT ACCESS ALONG PROPERTY LINES  
--- TAKING WITH ACCESS  
(P) PERMANENT EASEMENT  
(T) TEMPORARY EASEMENT

LEGEND

SR - SR SLOPE RIGHTS  
P - P PROPERTY LINE  
--- TOP OF CUT  
--- TOE OF SLOPE

APPROVED [Signature] DATE 7-21-76  
and CHIEF OF PLANS & TITLES

SEP 09 1988  
PROJECT LOWELL  
NO. RS0308 (2)  
SHEET 9 OF 18

1. 00 West  
270 28 17  
190 38 17  
446 38 6  
91 38 6  
5 0  
Bank Normal  
12 - 31 37  
11 - 23 47 31

1001+78  
(11) Pte 52 West

1001+78  
1001+78

BENWARE, JORDON R &  
CHARLOTTE L.

Rte 58 West  
Sta P1 24+18.55  
12476.75

P10 58 TRAIL  
PI 85+20.15  
Δ 56° 78' 13"

P10 100 POC 100+18.0  
P10 58 TRAIL P1 2301.2  
A 72° 51' 45.5" LT

P10 58 TRAIL  
P1 24+18.55  
P10 58 TRAIL P1 2301.2  
A 72° 51' 45.5" LT

STATE OF VT  
ROUTE 100  
EXISTING WAY LIMITS  
SEE PLAN SHEET 100

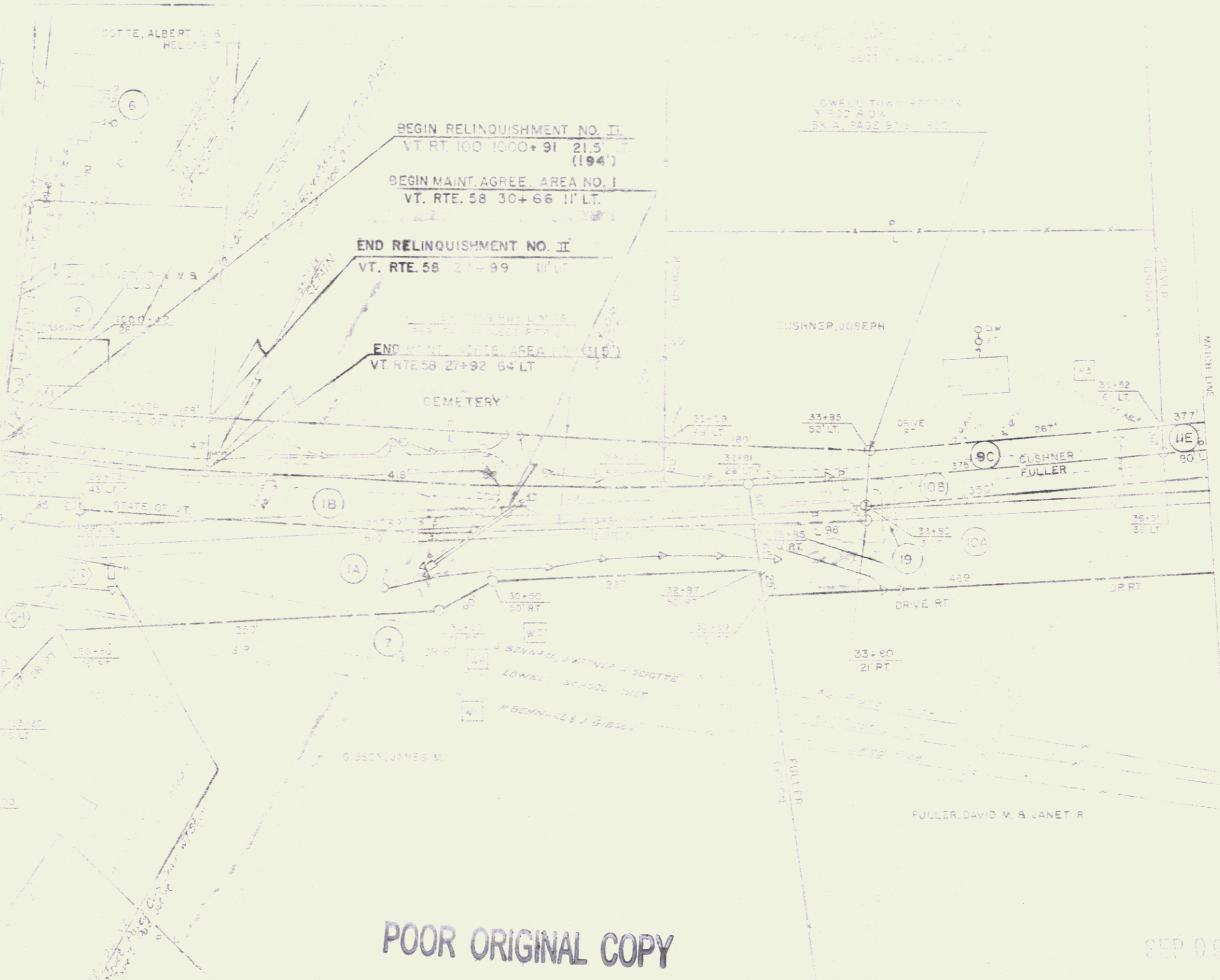

POOR ORIGINAL COPY

SEP 09 1988

SHEET 10

9

THIS PART OF THE ...  
 ...

PARCEL IA GIBSON, JAMES M. BEG. STA. RTE. 100 1004+00 LT. - END STA. 32+87 RT. 1.34 A±  
 SLOPE (T) (200 S.F.±) STA. 27+85 RT. - STA. 28+50 RT.  
 STA. RTE. 100 1002+44 LT. - STA. 26+50 RT. ALL R.T.B.I. WATERLINE  
 STA. 26+10 RT. TRAILER STA. 26+35 C. FOUNDATION  
 STA. 26+25 RT. B STA. 30+00 RT. DRAINAGE (P)

PARCEL IB BEG. STA. RTE. 100 1001+29 LT. - END STA. 32+85 RT.  
 ALL R.T.B.I. HIGHWAY EASE. RTE. 58 0.7 A±

PARCEL IC BEG. STA. RTE. 100 1000+91 C. - END STA. RTE. 100 1005+91 C.  
 ALL R.T.B.I. HIGHWAY EASE. RTE. 100 0.45 A±

MP 0418

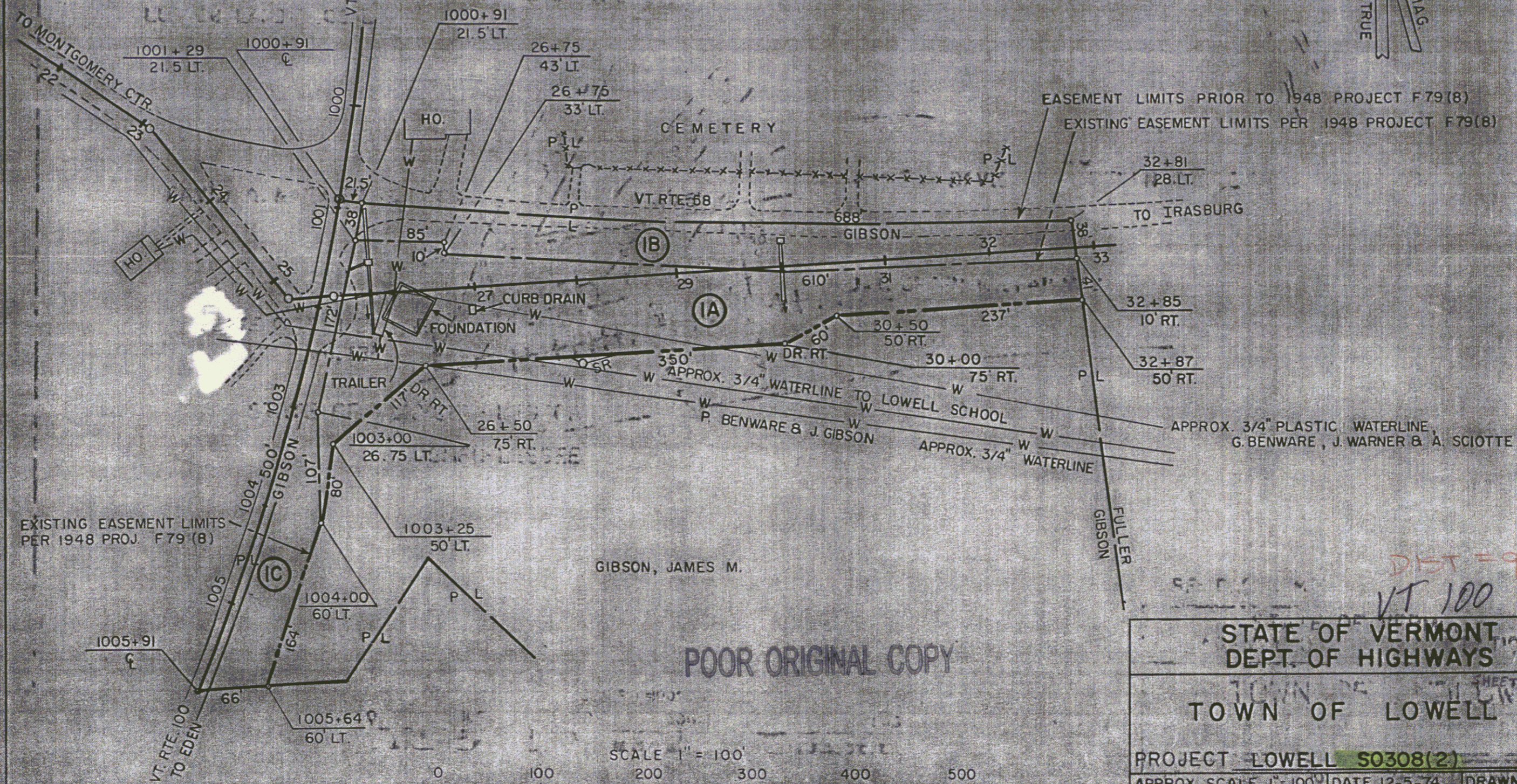
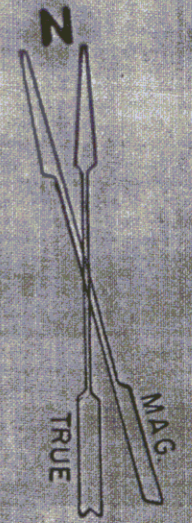

POOR ORIGINAL COPY

STATE OF VERMONT DEPT. OF HIGHWAYS		
TOWN OF LOWELL		
PROJECT LOWELL S0308(2)		
APPROX. SCALE 1" = 100'	DATE 12-5-74	DRAWN BY KDP

DIST = 9  
 VT 100

Relinquished to Town of Lowell  
9/12/79 BK 28 Pg 227 of Lowell Land Records

STATE CONTROL

42-34 - 64  
37-30 - 45+75  
37-30 - 37+75

SILVER, GEORGE F  
END MAINT ACRES AREA NO 2  
BEGIN RELINQUISHMENT NO I  
STA 41+30 90' LT (670)

SILVER, GEORGE F  
END RELINQUISHMENT NO I  
STA 46+64 90' LT



POOR ORIGINAL COPY

Scale 1" = 100'



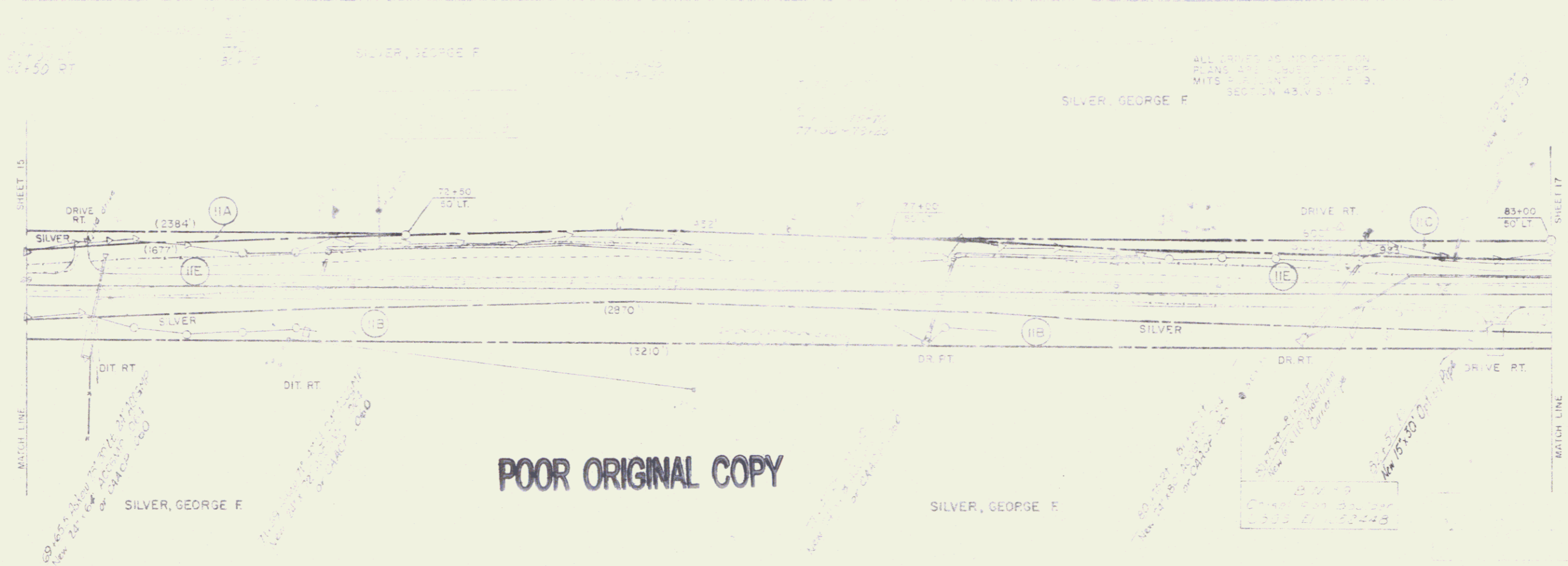

ALL DRIVE AND DRIVE OFF  
PLANS ARE ISSUED TO THE  
MITS. PLANTING DIST. 19.  
SECTION 43.V.3.4

POOR ORIGINAL COPY

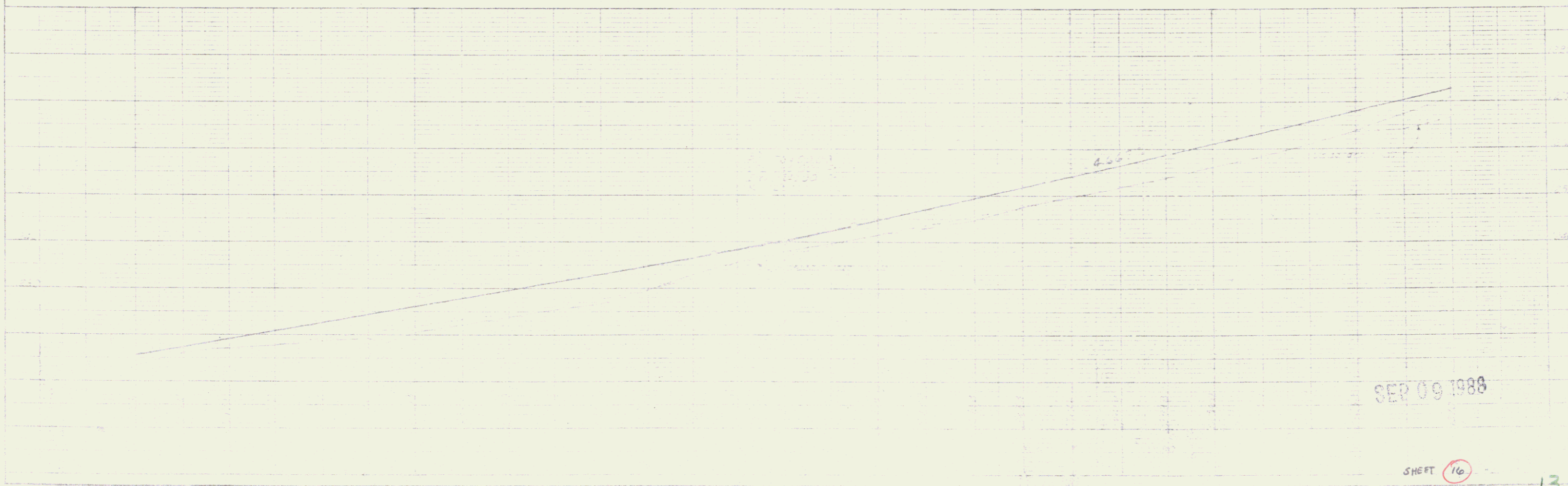

SEP 09 1988

SHEET 16

13

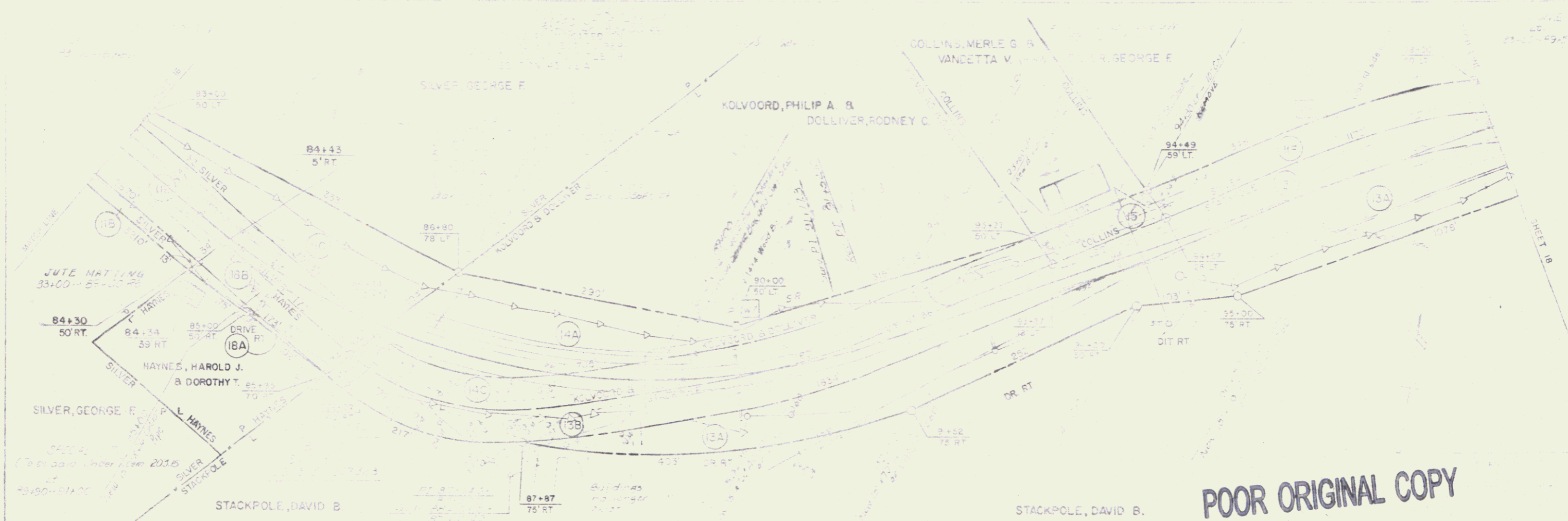

POOR ORIGINAL COPY

1988

SHEET 17

14

SILVER, GEORGE F.

SECTION 15.101

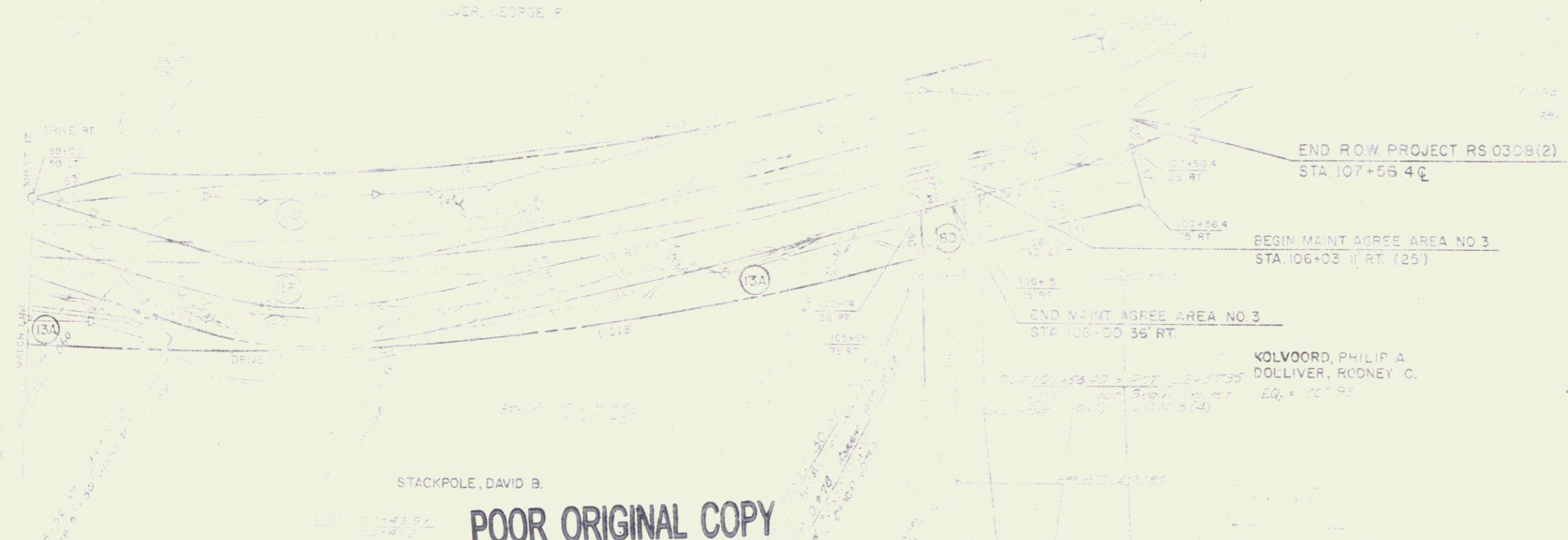

FOCK FILL  
 25+50 - 100+00  
 12" SAND 25+50 - 79+20  
 79+20 - 105+50  
 CONSTRUCT DRIVE  
 100+00 - 105+50

KOLVOORD, PHILIP A.  
 DOLLIVER, RODNEY C.  
 EQ. = 100195

STACKPOLE, DAVID B.

POOR ORIGINAL COPY

SEP 09 1999