

SPECIAL DITCH
 (To be paid under Item 203.17)
 LT
 356+00 ~ 364+00
 366+57 ~ 364+00

CONSTRUCT DRIVE
 LT
 367+70 (16' Wide) 357+95
 370+90 (16' Wide) 370+90 (16' Wide)
 357+50 (16' Wide) 359+20 (16' Wide)

ROCK FILL
 363+75 ~ 369+25

ALL DRIVES AS INDICATED ON
 PLANS ARE SUBJECT TO PER-
 MITS PURSUANT TO TITLE 13,
 SECTION 42, V.T.A.

STONE FILL, Type II
 LT
 366+49 ~ 366+57

REV. CURVE DATA
 Δ 55° 20' LT
 D 3° 30'
 R 153° 02'
 T 85° 22'
 L 153° 10'
 E 211° 3'
 Bank C 0.45' per Ft.

BM # 43
 S/T 12" X 8"
 U.S. Elev. 1027.6

BM # 44
 S/T 18" X 8"
 U.S. Elev. 1007.12

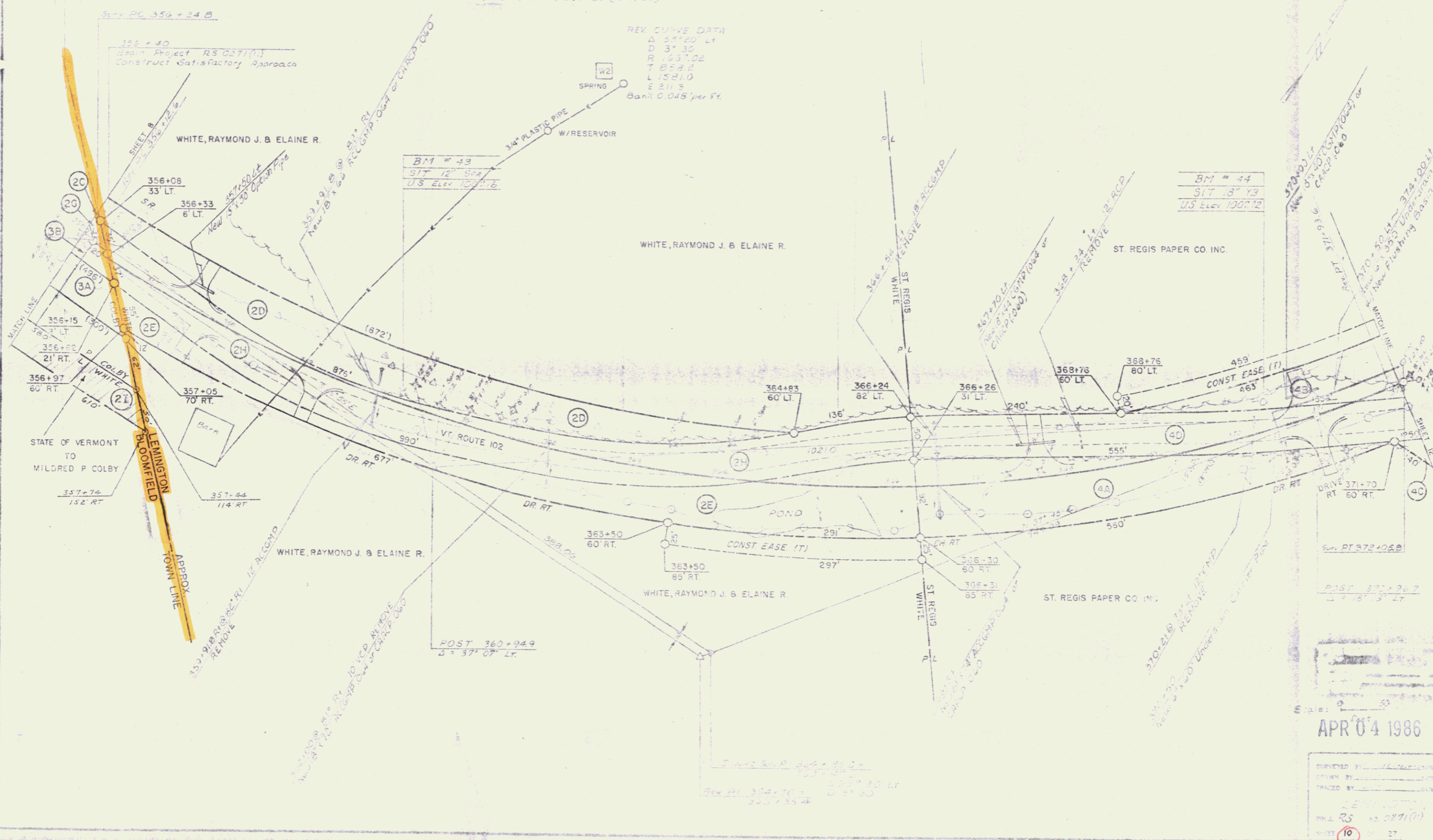

APR 04 1986

SURVEYED BY: [Signature]
 DRAWN BY: [Signature]
 TRACED BY: [Signature]
 SCALE: 1" = 40'
 SHEET NO. 10 OF 27