

POOR ORIGINAL COPY

STONE FILL FOR SLOPE PROTECTION  
(LIGHT TYPE) ITEM 512  
Western Ave 32+00-34+00 Lt

EXCAVATION & REMOVAL OF ROAD  
SURFACES AND/OR PAVEMENTS, ITEM 119  
Hill St 2+25-3+00 Lt

REMOVAL & DISPOSAL OF PRESENT  
GUARD RAIL, ITEM 549  
Western Ave 30+80-34+45 Lt  
Hill St 2+80 Lt - 3+85 Rt

CONSTRUCT DRIVE  
30+82 Lt  
11+12 Rt, E Main St  
29+38 Rt, Sias Ave

THREE CABLE GUARD RAIL  
w/STEEL POSTS, ITEM 542  
Western Ave 30+20-33+39 Rt  
Western Ave 34+31 - US 5 10+60 Rt  
Western Ave 31+36 - 34+85 Lt  
Hill St 0+28 - 2+52 Lt  
Hill St 0+28 - 3+70 Rt

CHAIN LINK FENCE  
30+00-31+65 Rt  
34+00-36+15 Rt  
32+00-35+00 Lt

BITUMINOUS CONCRETE CURB  
ITEM 555  
30+00-33+50 Rt  
31+20-34+70 Lt  
Hill St App of 28-3+00 Rt

SLOPE EDGING  
Western Ave 34+20-35+66 (Island)  
Western Ave 35+60 Lt (Island)  
US 5 8+81-9+51 (Island)  
US 5 10+31-11+26 (Island)  
Sias Ave 28+45-29+15 (Island)

DEMOLITION & DISPOSAL OF BUILDINGS  
ITEM 586  
30+25 Lt  
30+50 Lt  
35+00 E  
35+10 Rt

CURB  
Western Ave 34+70 Lt - US 5 8+80 Rt  
Hill St 0+85 Lt - US 5 11+04 Rt  
US 5 11+20 - 12+34 Rt  
Sias Ave 28+45 - 29+00 Rt

STANDARD CONCRETE STEPS  
ITEM 401-B  
E Main St 10+97 Lt  
Sias Ave 29+05 Rt

BITUMINOUS CONCRETE SIDEWALK  
ITEM 56E  
Hill St 0+85 Lt - US 5 12+34 Rt

FLANK GUARD RAIL  
ITEM 540  
Hill St 3+00 Lt

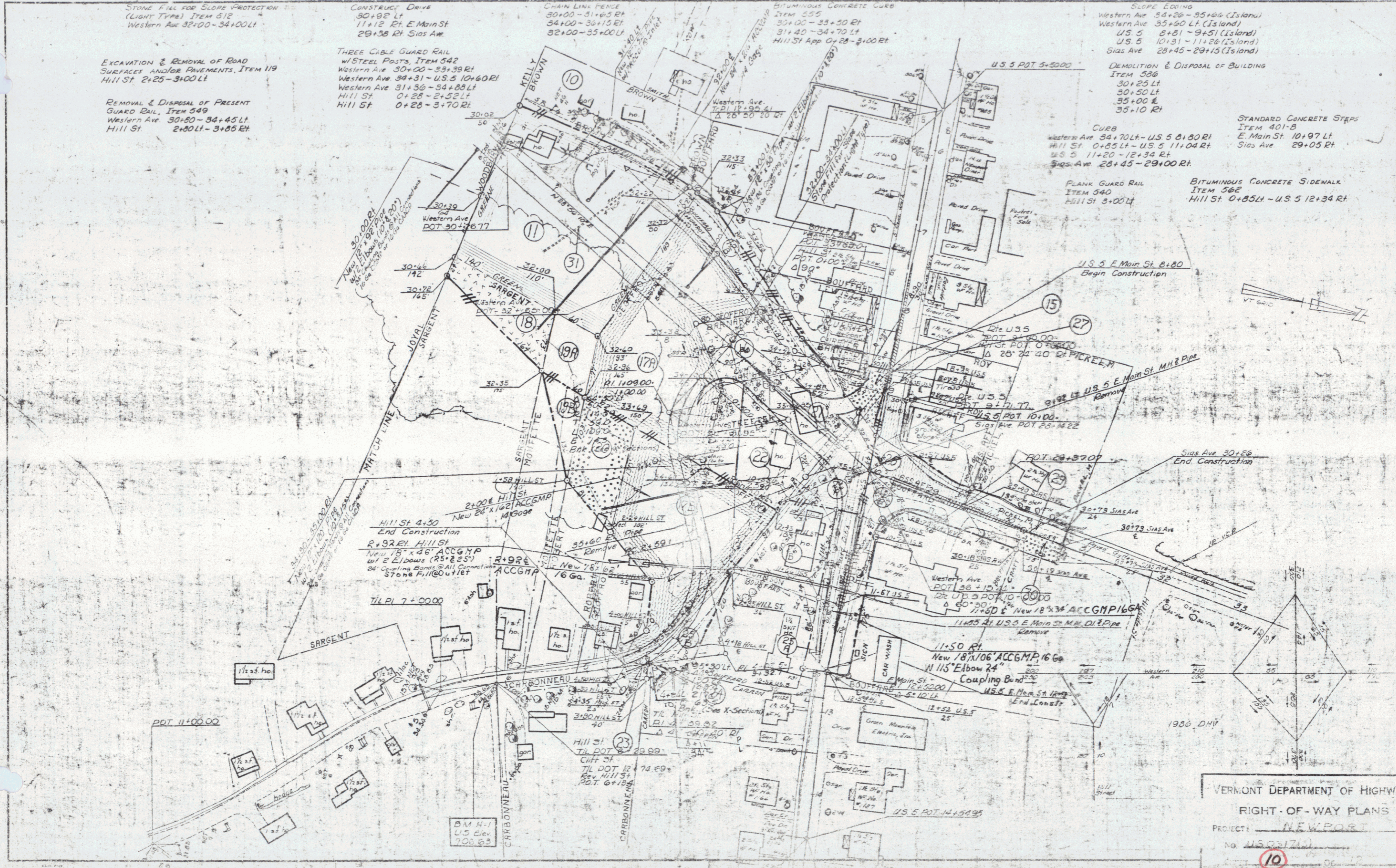

VERMONT DEPARTMENT OF HIGHWAYS  
RIGHT-OF-WAY PLANS  
PROJECT: NEWPORT  
NO. 4503/710  
10