

NOTE: FOR DETAILS OF R.R. RELOCATION, REFER TO THE FOLLOWING TWO SHEETS.

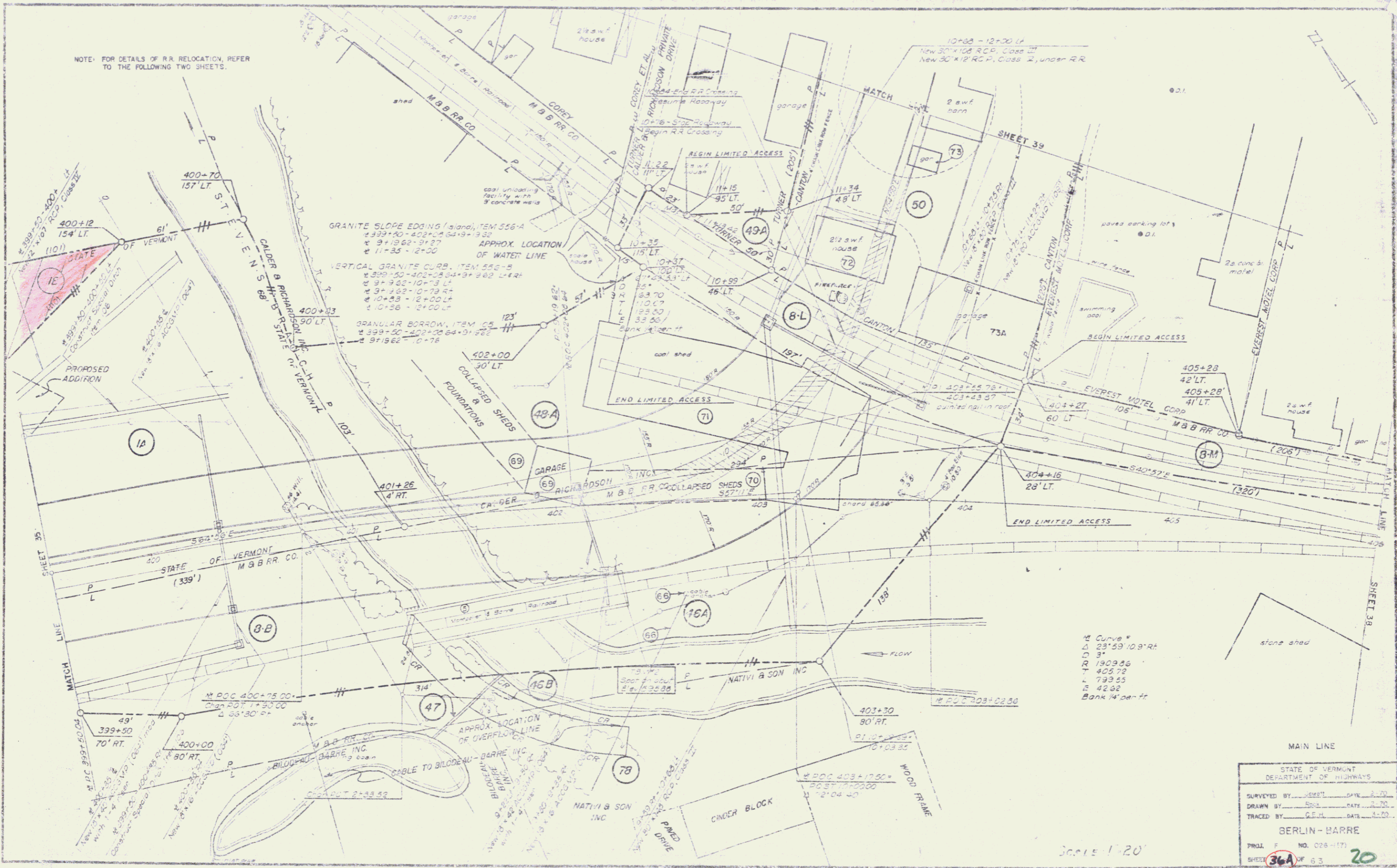

M Curve #  
 Δ 23°59'10.9" R  
 3'  
 1909.86  
 405.72  
 799.55  
 42.82  
 Bank 14' on ft

STATE OF VERMONT DEPARTMENT OF HIGHWAYS	
SURVEYED BY	DATE
DRAWN BY	DATE
TRACED BY	DATE
BERLIN - BARRE	
PROJ. #	NO. 028-171
SHEET	36A OF 63

Scale 1"=20'

36A