

JUTE MATTING ITEM  
 NB 879+75-883+00 Lt  
 NB 876+00-880+50 Rt

\* THREE CABLE GUARD RAIL  
 w/LIGHT STEEL POSTS ITEM  
 NB 880+48-883+00 Rt

DRILLING & BLASTING OF  
 SOLID ROCK-SUBGRADE  
 ITEM  
 NB 867+00-880+50

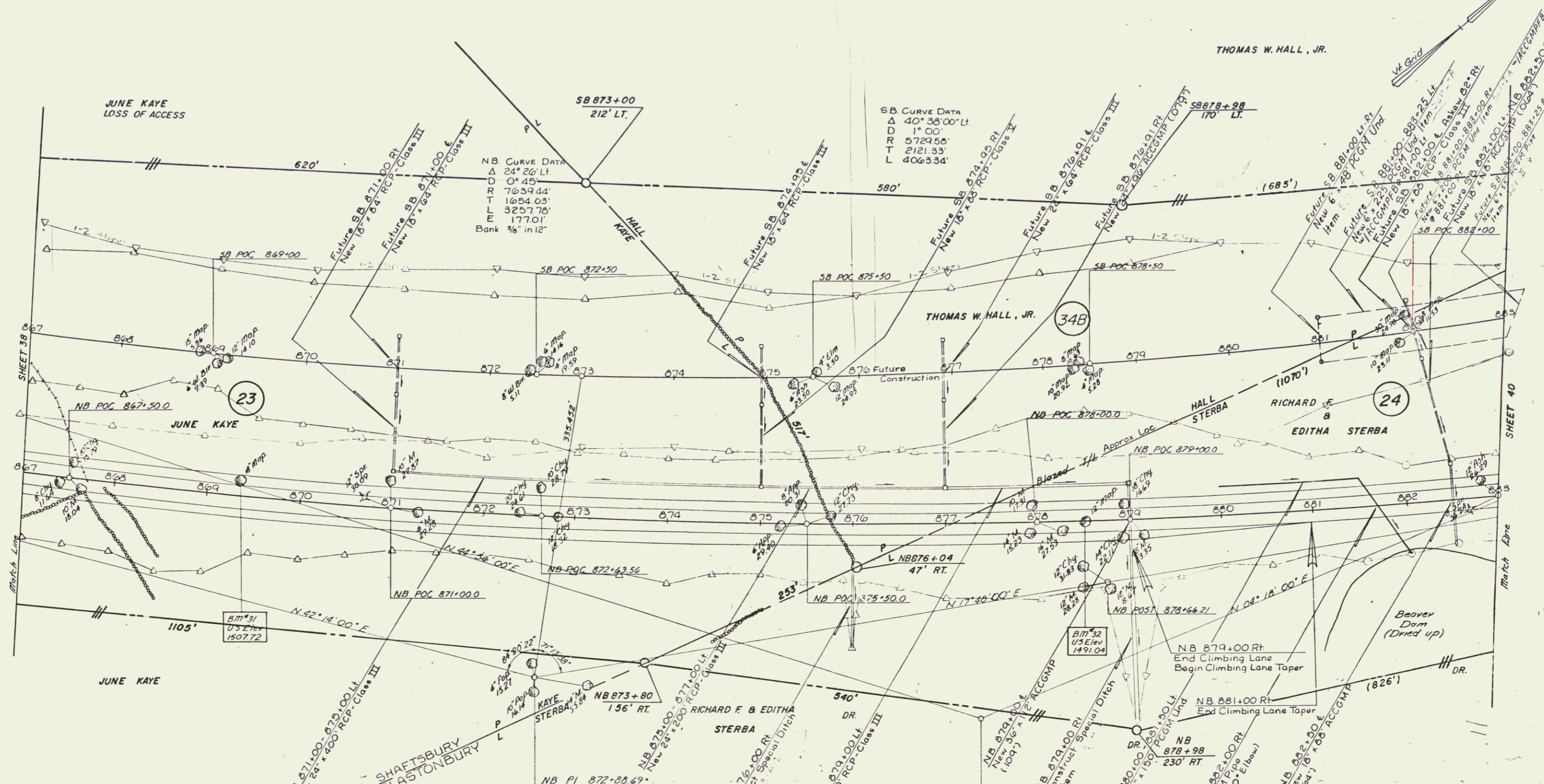

Contract 2  
 BENNINGTON-SUNDERLAND

SURVEYED BY *Baswell Eng Co* DATE *GA*  
 DRAWN BY \_\_\_\_\_ DATE \_\_\_\_\_  
 TRACED BY *MMG* DATE *10/18*

PROJ. RF NO. 019-1 (S) SECT. II  
 ROW  
 SHEET 39 OF 99

D-7