

* THREE CABLE GUARD RAIL
w/LIGHT STEEL POSTS ITEM
NB 805+48-812+52 LT

STONE FILL ITEM
NB 815+50-816+00 LT

24" SUB-BASE OF SAND
ITEM
NB 813+05-814+00

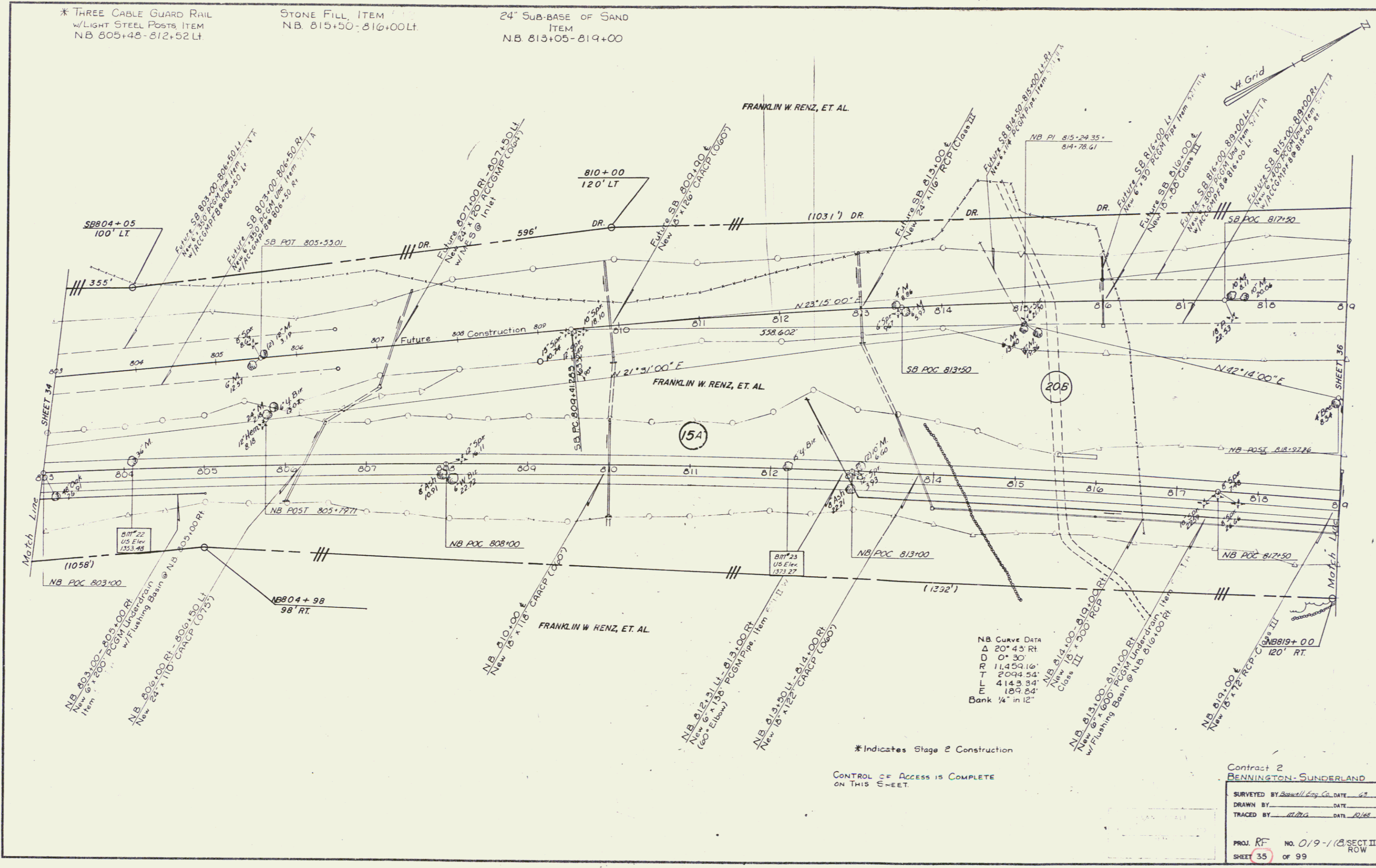

Contract 2
BENNINGTON-SUNDERLAND

SURVEYED BY: *Boswell Eng. Co.* DATE: *68*
DRAWN BY: *...* DATE: *...*
TRACED BY: *...* DATE: *...*

PROJ. RF NO. 019-1 (B) SECT. II
SHEET 35 OF 99 ROW

D-7