

POOR ORIGINAL COPY

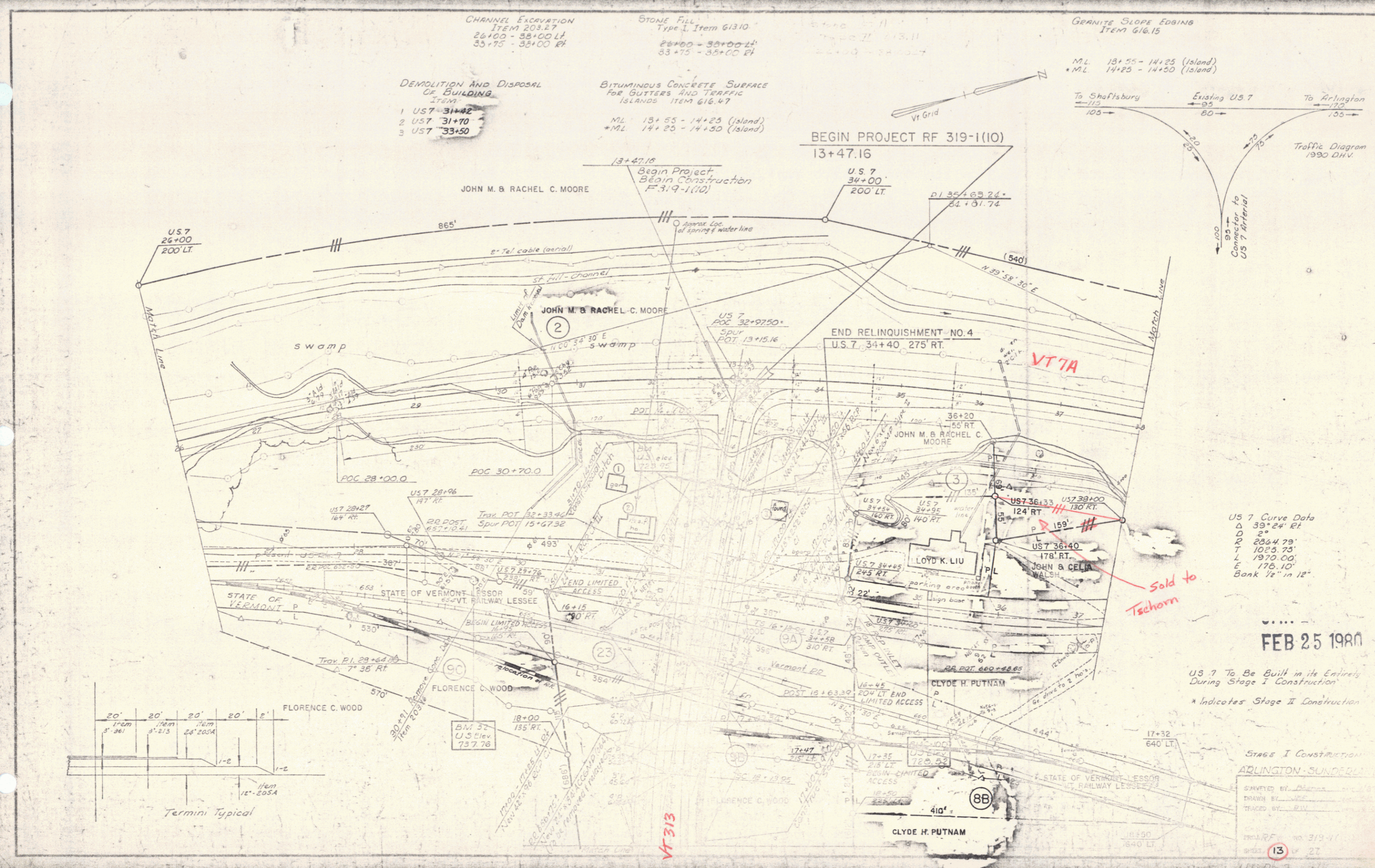

CHANNEL EXCAVATION
ITEM 203.17
26+00 - 33+00 LT
33+75 - 35+00 RT

STONE FILL
Type I, Item 613.10
26+00 - 33+00 LT
33+75 - 35+00 RT

GRANITE SLOPE EDGING
ITEM 616.15

DEMOLITION AND DISPOSAL
OF BUILDING
ITEM
1 US 7 31+42
2 US 7 31+70
3 US 7 33+50

BITUMINOUS CONCRETE SURFACE
FOR GUTTERS AND TRAFFIC
ISLANDS
ITEM 616.47
*ML 13+55 - 14+23 (Island)
*ML 14+25 - 14+50 (Island)

ML 13+55 - 14+25 (Island)
*ML 14+25 - 14+50 (Island)

BEGIN PROJECT RF 319-1(10)
13+47.16

To Shaftsbury 115
Existing US 7 80
To Arlington 172

Traffic Diagram
1990 D.H.V.

US 7 Curve Data
Δ 33° 24' RT
D 2°
R 2864.79'
T 1025.75'
L 1970.00'
E 178.10°
Bank 1/2 in 12°

FEB 25 1980

US 7 To Be Built in its Entirety
During Stage I Construction
* Indicates Stage II Construction

STAGE I CONSTRUCTION
ARLINGTON-SUNDERLAND

Surveyed by: [unclear]
Drawn by: [unclear]
Traced by: [unclear]
Checked by: [unclear]
Date: 3/13/11
Sheet 13 of 27
US 7

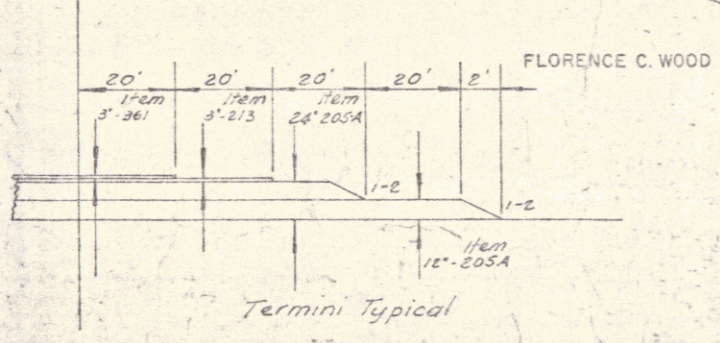

Sold to
Tschorn

VT 313