

GRANITE SLOPE EDGING ITEM 556-A		
STATION	STATION	POS

STONE FILL FOR SLOPE PROTECTION (LIGHT TYPE) ITEM 512		
STATION	STATION	POS

DEMOLITION AND DISPOSAL OF BUILDINGS ITEM 506		
STATION	STATION	POS

* STOCKPILED TOPSOIL
EB 1285+0 - 1292+0 RI (2400 c.y.)
Construct U-Turn
EB 1294+00 Lt.

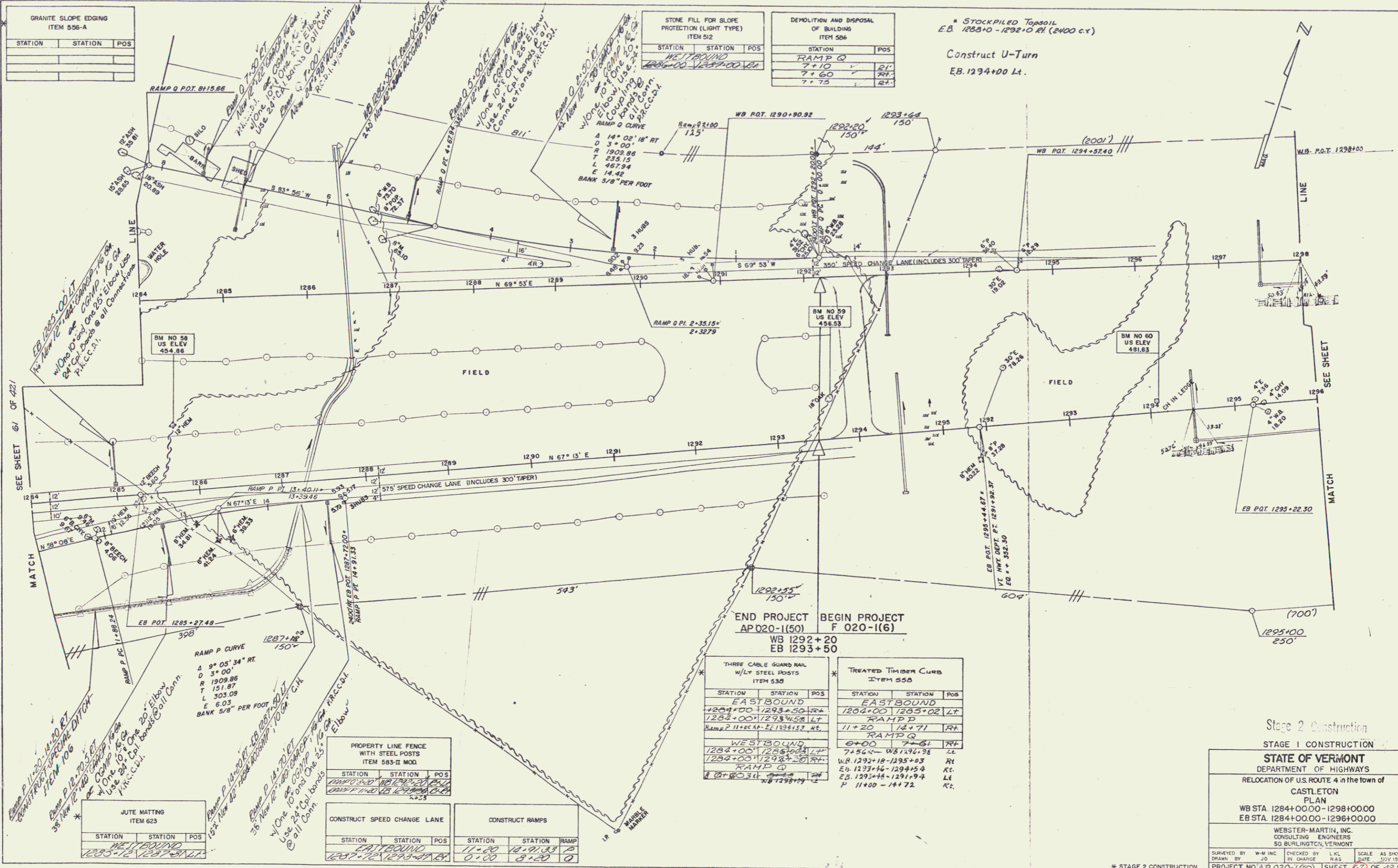

SEE SHEET 67 OF 421

SEE SHEET

END PROJECT BEGIN PROJECT
AP 020-(150)
WB 1292+20
EB 1293+50

THREE CABLE GUARD RAIL W/LY STEEL POSTS ITEM 530			TREATED TIMBER CURB ITEM 550		
STATION	STATION	POS	STATION	STATION	POS
EASTBOUND			EASTBOUND		
1284+00	1289+50	RA	1284+00	1285+02	LT
1282+00	1293+50	LT	RAMP D		
WESTBOUND			RAMP Q		
1284+00	1285+02	LT	11+20	12+71	RT
1282+00	1293+50	RT	12+00	12+51	RT
1278+00	1293+50	RT	7+54	11+34	RT
1278+00	1293+50	RT	11+20	12+71	RT
1278+00	1293+50	RT	11+20	12+71	RT

JUTE MATTING ITEM 623		
STATION	STATION	POS

PROPERTY LINE FENCE WITH STEEL POSTS ITEM 585-B MOD		
STATION	STATION	POS

CONSTRUCT SPEED CHANGE LANE		
STATION	STATION	POS

CONSTRUCT RAMPS		
STATION	STATION	RAMP

Stage 2 Construction
Stage 1 Construction

STATE OF VERMONT
DEPARTMENT OF HIGHWAYS
RELOCATION OF U.S. ROUTE 4 in the town of
CASTLETON
PLAN
WB STA. 1284+00.00 - 1298+00.00
EB STA. 1284+00.00 - 1296+00.00

WEBSTER-MARTIN, INC.
CONSULTING ENGINEERS
50 BURLINGTON, VERMONT

SURVEYED BY W-M INC. CHECKED BY LKL SCALE AS SHOWN
DRAWN BY JO IN CHARGE RAS DATE NOV 1958

PROJECT NO. AP 020-150 SHEET 67 OF 421
F Shee. 10701255