

PLAN
 DATE: _____ BY: _____
 CHECKED BY: _____
 DRAWN BY: _____
 NO. OF WAYS CHECKED: _____

PROFILE
 DATE: _____ BY: _____
 CHECKED BY: _____
 DRAWN BY: _____
 NO. OF WAYS CHECKED: _____

CONSTRUCT DRIVE		
STATION	POS	
906+18.3	BZ	

REMOVE EXISTING ROAD SURFACE COMMON EXCAVATION, CLASS I ITEM 103-A-1		
STATION	STATION	POS
903+00	907+00	-

PROPERTY LINE FENCE WITH STEEL POSTS ITEM 583-II, MOD.		
STATION	STATION	POS
906+25.4	907+00.0	BZ
906+25.4	907+00.0	BZ

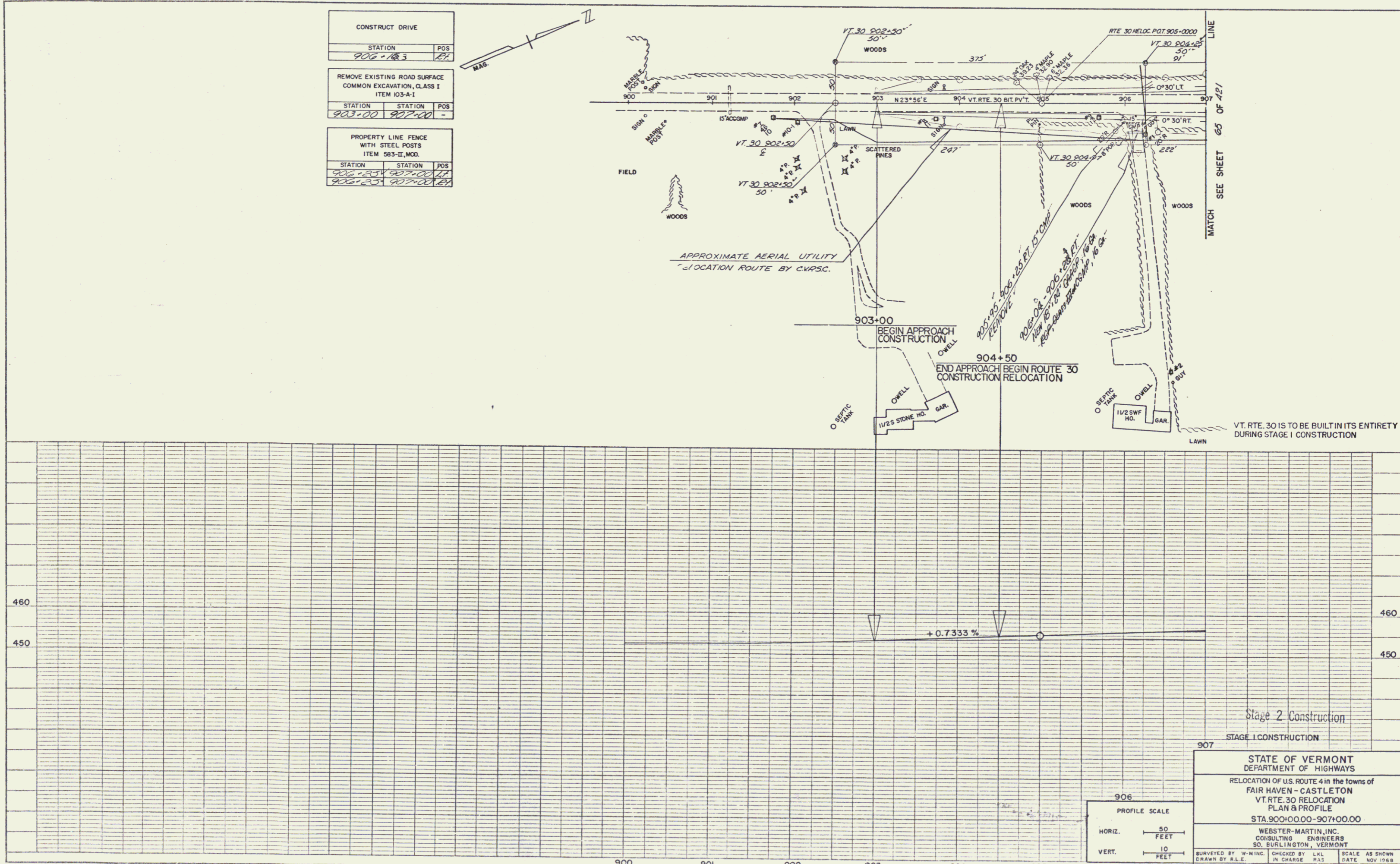

STATE OF VERMONT
 DEPARTMENT OF HIGHWAYS
 RELOCATION OF U.S. ROUTE 4 in the towns of
 FAIR HAVEN - CASTLETON
 VT. RTE. 30 RELOCATION
 PLAN & PROFILE
 STA 900+00.00 - 907+00.00
 WEBSTER-MARTIN, INC.
 CONSULTING ENGINEERS
 50, BURLINGTON, VERMONT
 SURVEYED BY W-M:INC. IN CHARGE RAS CHECKED BY LKL SCALE AS SHOWN
 DRAWN BY R.L.E. DATE NOV 1988
 PROJECT NO. A P 020-1(20) SHEET 64 OF 127

PROFILE SCALE
 HORIZ. 50 FEET
 VERT. 10 FEET