

STONE FILL FOR SLOPE PROTECTION (LIGHT TYPE) ITEM 512		
STATION	STATION	POS
EASTBOUND		
1221+00	1221+50	Lt
1221+50	1222+00	Rt
WESTBOUND		
1221+00	1221+50	Rt
1221+50	1222+00	Lt

RIPRAP (HEAVY TYPE) ITEM 513-A		
STATION	STATION	POS
EASTBOUND		
1221+00	1221+50	Lt
1221+50	1222+00	Rt
WESTBOUND		
1221+00	1221+50	Rt
1221+50	1222+00	Lt

CONSTRUCT DRIVE		
STATION	STATION	POS
FRONTAGE ROAD		
1223+91		Lt

Plank Guard Rail  
W.B. 1221+50 Lt.

TWO CABLE GUARD RAIL ITEM 541		
STATION	STATION	POS
FRONTAGE ROAD		
1235+02	1237+00	Lt

PROPERTY LINE FENCE WITH STEEL POSTS ITEM 583-II MOD.		
STATION	STATION	POS
EASTBOUND		
1221+00	1223+00	Lt
WESTBOUND		
1221+00	1223+00	Rt

THREE CABLE GUARD RAIL W/LT STEEL POSTS ITEM 558		
STATION	STATION	POS
EASTBOUND		
1229+99	1232+51	Lt
1229+99	1233+51	Rt
WESTBOUND		
1229+99	1232+51	Rt
1229+99	1233+51	Lt

JUTE MATTING ITEM 623		
STATION	STATION	POS
EASTBOUND		
1221+00	1221+50	Lt
1221+50	1222+00	Rt
WESTBOUND		
1221+00	1221+50	Rt
1221+50	1222+00	Lt

CONSTRUCT SATISFACTORY APPROACH  
BEGIN FRONTAGE ROAD  
1227+00

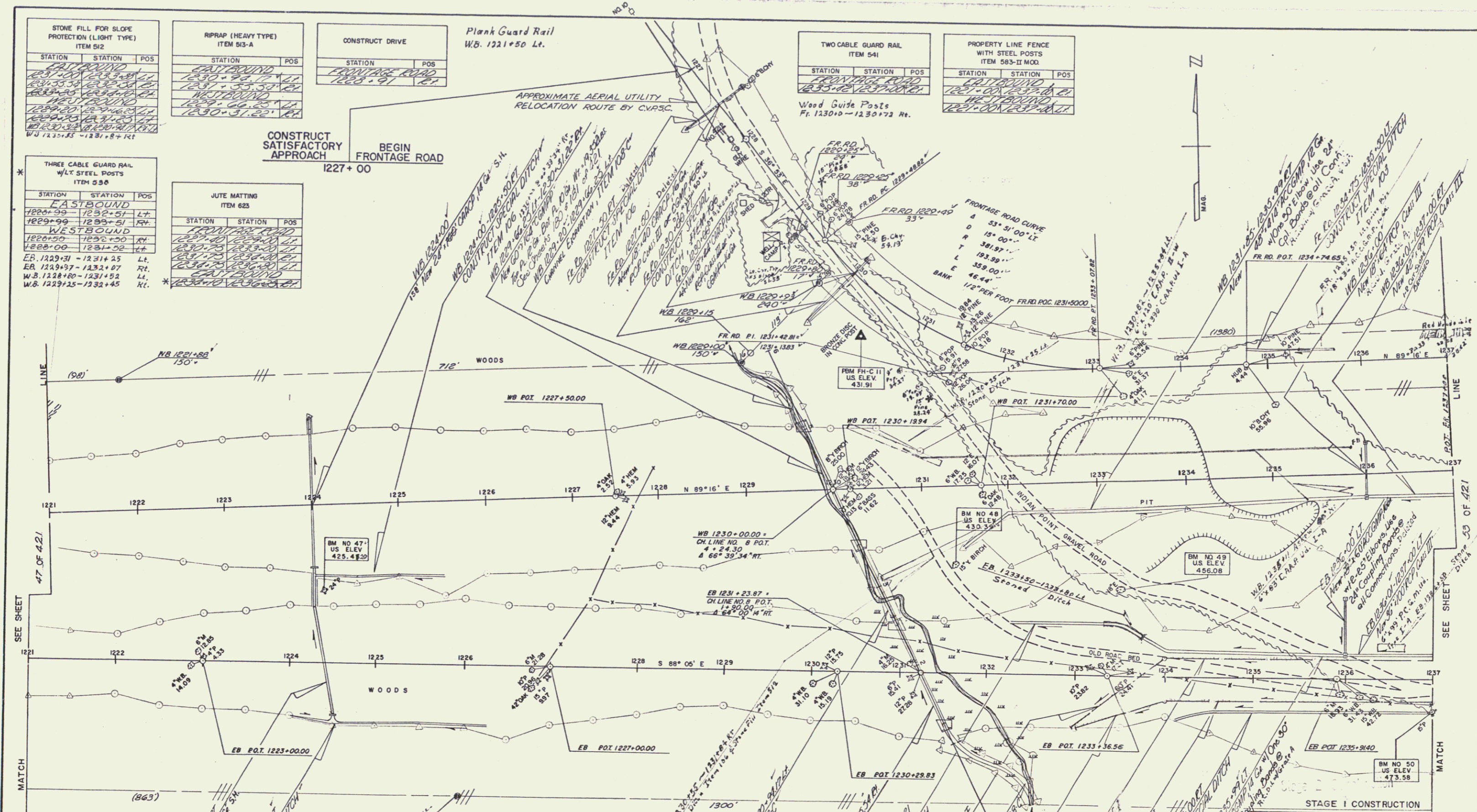

STAGE 1 CONSTRUCTION

**STATE OF VERMONT**  
DEPARTMENT OF HIGHWAYS

RELOCATION OF U.S. ROUTE 4 in the towns of  
**FAIR HAVEN - CASTLETON**  
PLAN  
STA. 1221+00.00 - 1237+00.00

WEBSTER-MARTIN, INC.  
CONSULTING ENGINEERS  
50 BURLINGTON, VERMONT

DESIGNED BY W-M INC. CHECKED BY LKL SCALE AS SHOWN  
DRAWN BY JLD IN CHARGE RAS DATE NOV 1968

PROJECT NO. A P 020-1(50) SHEET 20 OF 221

