

STONE FILL FOR SLOPE PROTECTION (LIGHT TYPE) ITEM 52			CHAIN LINK FENCE 6' HIGH			PROPERTY LINE FENCE WITH STEEL POSTS ITEM 583-II, MOD.		
STATION	STATION	POS	STATION	STATION	POS	STATION	STATION	POS
1100+00	1104+00	BT	1100+00	1114+00	BT	1100+00	1114+00	BT
1100+00	1101+25	BT						

Note: Chain Link Fence 1098+00 - 1106+77 E.B. Property Line Fence 1100+00 - 1114+00 WB LI To be constructed prior to commencement of other work in this area.

\* STOCKPILED TOPSOIL W.B. 1100+00 - 1104+10 R.H. (3000 C.Y.)  
\* CONSTRUCT "U" TURN EB-1103+00 LT - WB-1104+50 R.H. EB 1102+40

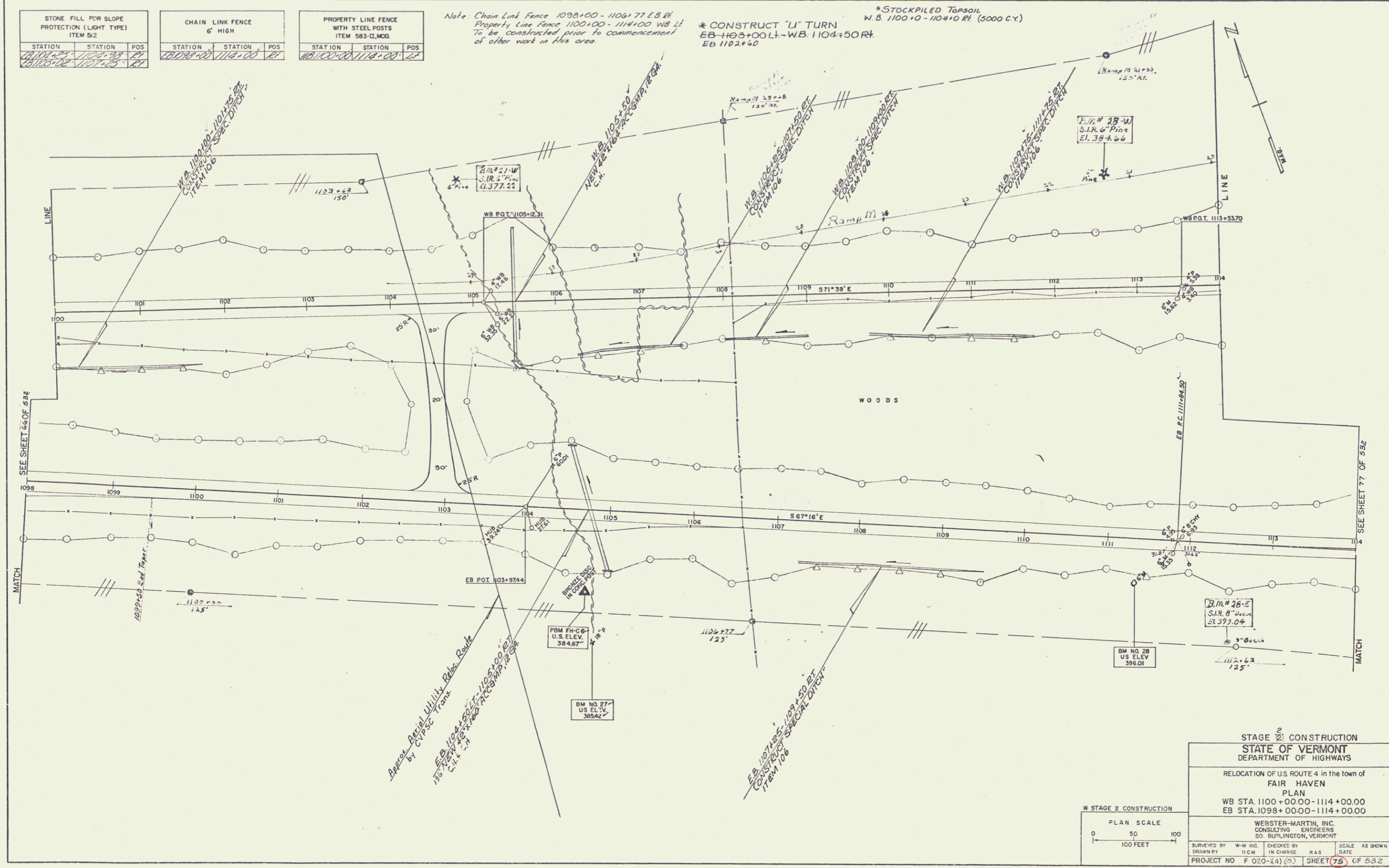

STAGE 2 CONSTRUCTION  
STATE OF VERMONT  
DEPARTMENT OF HIGHWAYS

RELOCATION OF U.S. ROUTE 4 in the town of FAIR HAVEN  
PLAN  
WB STA. 1100+00.00 - 1114+00.00  
EB STA. 1098+00.00 - 1114+00.00

WEBSTER-MARTIN, INC.  
CONSULTING ENGINEERS  
50 BURLINGTON, VERMONT

BENCHMARKS:  
BM NO. 27 U.S. ELEV. 384.67'  
BM NO. 28 U.S. ELEV. 396.01'  
BM NO. 29 U.S. ELEV. 393.04'

PROJECT NO. F 020-14(0) SHEET 75 OF 532

