

JUTE MATTING ITEM 623			* GRANITE SLOPE EDGING ITEM 556-A			CHAIN LINK FENCE 6' HIGH			STONE FILL FOR SLOPE PROTECTION (LIGHT TYPE) ITEM 512		
STATION	STATION	POS	STATION	STATION	POS	STATION	STATION	POS	STATION	STATION	POS
1087.00	1087.00	11									
1087.00	1087.00	11									
1087.00	1087.00	11									
1087.00	1087.00	11									
1087.00	1087.00	11									

* THREE CABLE GUARD RAIL WITH LIGHT STEEL POSTS ITEM 538		
STATION	STATION	POS
EB 1084.00	1084.50	61
EB 1087.00	1087.00	61
EB 1088.00	1088.00	61
WB 1088.00	1088.00	61
WB 1088.00	1088.00	61
EB 1088.00	1088.00	61
EB 1088.00	1088.00	61
EB 1088.00	1088.00	61
EB 1088.00	1088.00	61

DEMOLITION AND DISPOSAL OF BUILDING ITEM 536		
STATION	NO	POS
EB 1090+60	1	61
EB 1090+98	1	61
EB 1091+52	1	61

Note: Chain Link Fence  
This area to be Constructed  
prior to commencement  
of other work in this  
area.

RAMP G CURVE  
A 118' 00" RT  
D 0' 30' 00"  
R 11459.16'  
T 130.01'  
L 260.00'  
E .73

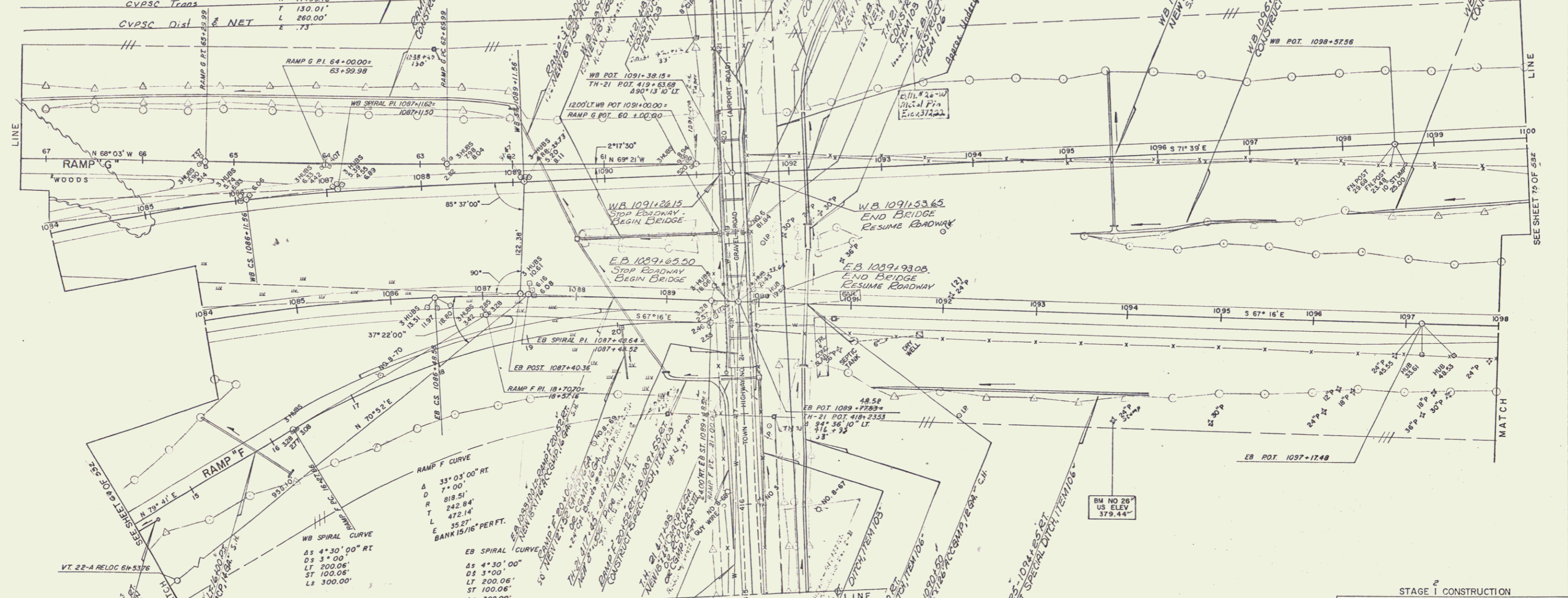

PROPERTY LINE FENCE WITH STEEL POSTS ITEM 583-II, MOD			* TREATED TIMBER CURB ITEM 558		
STATION	STATION	POS	STATION	STATION	POS
667.30	719.25	11	1087.00	1087.50	61
719.25	719.25	11	1087.50	1088.00	61
719.25	719.25	11	1088.00	1088.50	61
719.25	719.25	11	1088.50	1089.00	61
719.25	719.25	11	1089.00	1089.50	61
719.25	719.25	11	1089.50	1090.00	61

Note: 67130 - WB 109425  
Property Line Fence to be con-  
structed prior to commencement  
of other work in this area. Also  
of WB 109154 - 1100400.00

STAGE 1 CONSTRUCTION  
STATE OF VERMONT  
DEPARTMENT OF HIGHWAYS  
RELOCATION OF U.S. ROUTE 4 in the town of  
FAIR HAVEN  
PLAN  
WB STA 1084+00.00-1100+00.00  
EB STA 1084+00.00-1098+00.00

WEBSTER-MARTIN, INC.  
CONSULTING ENGINEERS  
50 BURLINGTON, VERMONT

SURVEYED BY W.M. INC. CHECKED BY [ ] SCALE AS SHOWN  
DRAWN BY [ ] IN CHARGE [ ] DATE [ ]  
PROJECT NO. F020-1(4) (3) SHEET 68 OF 532  
68 253

