

PLAN
 DATE: _____
 DRAWN BY: _____
 CHECKED BY: _____
 NO. _____

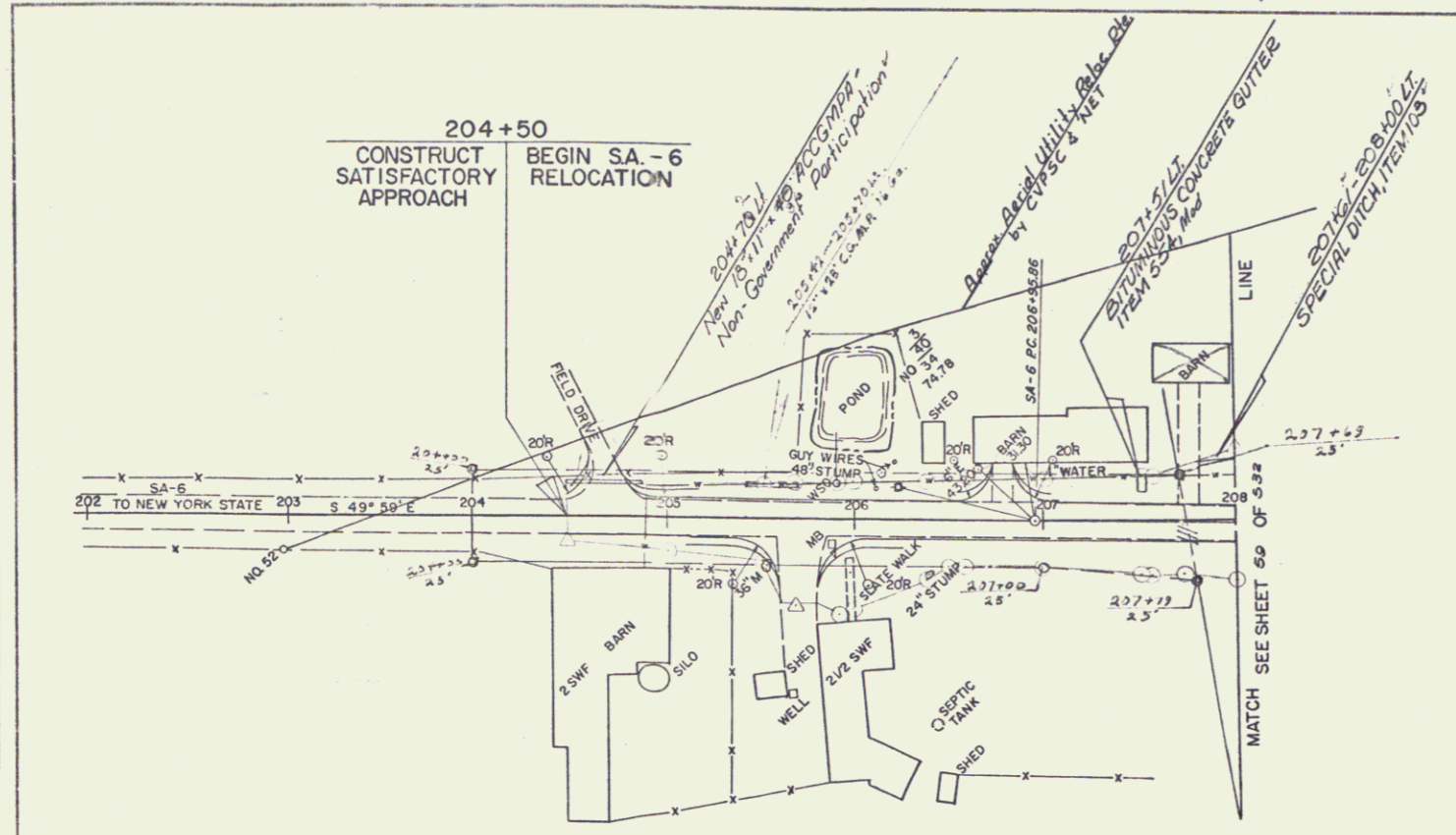

CONSTRUCT DRIVE	
STATION	POS
204+50	LT
205+68.5	RT
208+283.0	LT

TOPSOIL ITEM 621		
STATION	STATION	POS
205+00	206+50	RT

TREATED TIMBER CURB ITEM 558		
STATION	STATION	POS
207+33	208+00	LT

BITUMINOUS CONCRETE SURFACE FOR GUTTERS AND TRAFFIC ISLANDS ITEM 554		
STATION	STATION	POS
207+53	208+00	LT

TWO CABLE GUARD RAIL ITEM 541		
STATION	STATION	POS
207+03	208+00	LT
207+33	208+00	RT

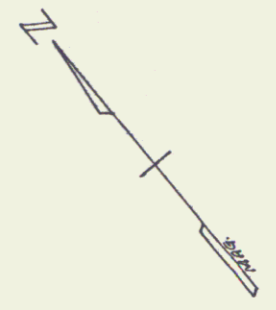

PROFILE
 DATE: _____
 DRAWN BY: _____
 CHECKED BY: _____
 NO. _____

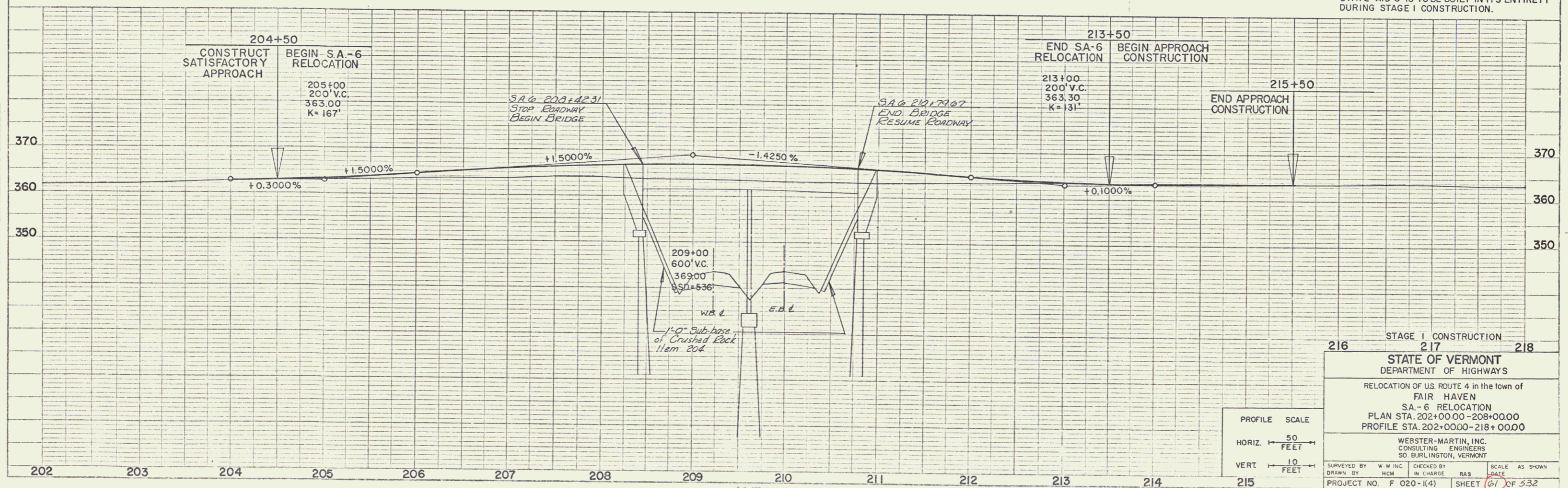

STATE AID 6 IS TO BE BUILT IN ITS ENTIRETY DURING STAGE I CONSTRUCTION.

STAGE I CONSTRUCTION

216 217 218

STATE OF VERMONT
 DEPARTMENT OF HIGHWAYS

RELOCATION OF U.S. ROUTE 4 in the town of
 FAIR HAVEN
 SA - 6 RELOCATION
 PLAN STA. 202+00.00 - 208+00.00
 PROFILE STA. 202+00.00 - 218+00.00

WEBSTER-MARTIN, INC.
 CONSULTING ENGINEERS
 50 BURLINGTON, VERMONT

SURVEYED BY: W.M. INC. CHECKED BY: RAS SCALE: AS SHOWN
 DRAWN BY: HCM IN CHARGE: RAS DATE: _____
 PROJECT NO. F 020-(14) SHEET 61 OF 532

STATE 1. PROFILE
 48 PLS. IMPERIAL