

1 TITLE SHEET  
 2 ALIGNMENT DATA SHEET  
 3-5 TYPICAL SECTIONS  
 6-7 QUANTITY SHEETS  
 8 BLANK  
 9-11 DRAINAGE SHEETS  
 12-16 EARTHWORK SHEETS  
 17-18 PLAN & PROFILE SHEETS  
 19-40 BLANK  
 41-42 BLANK  
 43-59 BR SERIES 1100 T.M. 17 OVER RELOC. U.S. 4  
 60 A-50 SOLID ROCK EXCAVATION (IN AREAS OVER 50 MPH) 1-17-69 R  
 61 B-1 BANKING TABLES 7-17-67 R  
 62 B-5 TYPICAL SLOPE GRADING 3-10-65  
 63 B-6 MUCK EXCAVATION 3-10-65  
 64 B-10 EMBANKMENT ON A SLOPE 3-10-65  
 65 B-11 METHODS OF SLOPE STABILIZATION 3-10-65  
 66 C-1 CURBS 9-10-69 R  
 67 D-2 HEADWALLS & UNDERDRAIN 4-14-69 R  
 68 D-3 JUTE MATTING & TREATED GUTTERS 7-19-67 R  
 69 D-4 UNDERDRAIN FLUSHING BASINS & ELBOWS 12-4-68 R  
 70 D-8 R.C. DRO' INLETS 3-10-65  
 71 D-9 R.C. DRO' INLETS 3-10-65  
 72 D-9 DROP INLET TOPS 3-10-65  
 73 D-10 DROP INLET TOPS 3-10-65  
 74 D-11 DETAILS OF GRATES & COVERS 3-10-65  
 75 D-13 CATCH BASIN OR MANHOLE 5-15-69 R  
 76 D-16 DROP INLET TYPE II 10-28-69  
 77 D-17 ACCOMP. VERTICAL RISER 7-1-68 R  
 78 E-31 FEDERAL AID CONSTRUCTION IDENTIFICATION SIGNS 8-21-67 R  
 79 E-32 ROAD CONSTRUCTION APPROACH SIGNS 1-6-67  
 80 E-33 BRIDGE CONSTRUCTION APPROACH SIGNS 1-6-67  
 81 E-34 ON-PROJECT CONSTRUCTION SIGNS 5-3-67 R  
 82 F-1 PROPERTY LINE FENCE 11-29-67 R  
 83 G-29 TWO CABLE GUARD RAIL 10-24-69  
 84 J-1 BOUNDARY MARKERS 3-10-65  
 85 BLANK  
 86 SCB-D1-67 BENCH MARK DETAILS & GENERAL NOTES 4-28-70 R  
 87 SCB-D2-67 BEAM HAUNCH 1-24-68  
 88 SCB-D5-67 CURB DETAILS, PILE SPICE DETAILS, & CONSTRUCTION JOINT DETAILS R 4-28-70 R  
 89 SCB-D7-67 DIAPHRAGM DETAILS 1-24-68  
 90 SB-R1-64 ALUMINUM RAILING DETAILS SK 1 4-28-70 R  
 91 SB-R1-64 ALUMINUM RAILING DETAILS SK 2 4-28-70 R  
 92 SB-R2-65 STEEL RAILING DETAILS 11-8-66 R  
 93-194 MAINLINE CROSS SECTIONS  
 195-202 T.H. 17 CROSS SECTIONS  
 203 CHANNEL LINE NO. 1 SECTIONS  
 204-206 DRAINAGE SECTIONS

**TOWN OF CASTLETON**  
**COUNTY OF RUTLAND**  
**RELOCATION OF U.S. ROUTE 4 L.A.**  
**FAIR HAVEN - WEST RUTLAND ROAD**

BEGINNING AT A POINT APPROXIMATELY 5.765 MILES EASTERLY OF THE NEW YORK-VERMONT STATE LINE AND PROCEEDING EASTERLY 1.661 MILES.  
 LENGTH OF ROADWAY 8,771.12 FEET = 1.661 MILES  
 LENGTH OF BRIDGES FEET = MILES  
 LENGTH OF PROJECT 8,771.12 FEET = 1.661 MILES

TRAFFIC DATA

1970	ADT	4800
1990	ADT	8250
1990	DHV	990
	D	56%
	T	7%
	V	60 MPH

PROJECT F020-1(7) F020-1(7) 205  
 RIGHT-OF-WAY DIVISION  
 TOWN FILE  
 PERPETUAL  
 Town of U.S. 4 L.A.  
 (To Be Returned To R.O.W. Division)

RECORD PLANS STAGE 1  
 MATERIALS  
 SUBBASE OF GRAVEL & GRAVEL BACKFILL -  
 PELLITIER PIT - CASTLETON, VT.  
 SUBBASE OF SAND - CARRARA PIT - FOULNEY, VT.  
 WATER PROOF MEMBRANE - UNIROVAL, INC. - MICHAWAKA, IND.  
 BITUMINOUS CONCRETE - F.W. WHITCOMB - NO. WALPOLE, N.H.  
 CONCRETE CLASS AA & B - CARRARA READY MIX CONCRETE - WALLINGFORD & CASTLETON, VT.  
 RETARDER - CARATARD, DIV. W.R. GRACE CHEMICAL CO. - NO. BERGEN, N.J.  
 REINFORCING STEEL - BETHLEHEM STEEL CO. - SPARROWS PT. MD. & ALDANY, N.Y.  
 SHEAR CONNECTORS - NELSON STUD WELDING CO. - LORAIN, OHIO.  
 STRUCTURAL STEEL - VERMONT STRUCTURAL STEEL CORR. - SURLINGTON, VT.  
 BRIDGE PAINT - CADILAC PAINT & VARNISH CO. - BOSTON, MA.  
 PAINT WATERPROOFING - KOPPERS CO. - ALBANY, N.Y.  
 WATER REPELLENT - RUTLAND FIRE CLAY CO. - RUTLAND, VT.  
 METAL CULVERT PIPE - NORTHEASTERN METAL CULVERT CORP. - WESTMINSTER, VT.  
 CAST IRON GRAPES - E.L. LEBERSON FOUNDRY CO. - BROOKTON, MA.  
 GRANITE BRIDGE CURB - BARRETTO GRANITE CO. - MILFORD, N.H.  
 REINFORCED CONCRETE PIPE, PRECAST REIN. CONC. CURB D.I., TREATED TIMBER CURB, PROPERTY LINE FENCE, BRIDGE RAILING, GUARD RAIL & BRUSH CONTROL ITEMS - S.T. GRISWOLD & CO., INC. - WILLISTON, VT.  
 CONTRACTOR - E.T. O'NEILL & SONS CONSTRUCTION CORP. HOLYOKE, MA.  
 RESIDENT ENGINEER - THOMAS W. DITTMER.  
 ASSIST. RES. ENGR. - JACQUES S. COUTURE.  
 INSPECTORS - SAMFORD WOODBORN, RICHARD HOSKINS, CHARLES LOHR, RICHARD RUSSELL, ROBERT A. SYLVESTER, EUGENE A. CRIS, VICTOR D'VIRE, BRUCE E. LINDHOLM, MICHAEL L. HERSEY & LAWRENCE R. WHEELER.  
 RECORD PLANS - A.C. SPIDLE.

CONTRACT DATED - AUGUST 19, 1970.  
 STARTED - AUGUST 20, 1970  
 COMPLETED - SEPTEMBER 13, 1971  
 ACCEPTED - SEPTEMBER 13, 1971

END PROJECT APO20-1(50) EB 1293+50.00 WB 1292+2000 M.P.S. 744  
 BEGIN PROJECT F 020-1(7)  
 END PROJECT F020-1(7) EB 1376+73.40 WB 1380+86.53 M.P. 7424  
 BEGIN PROJECT AP 020-1(4)

WEBSTER-MARTIN, INC.  
 Robert H. Taylor  
 REGISTERED PROFESSIONAL ENGINEER  
 SUBMITTED DECEMBER 2, 1968  
 DATE

FOR RIGHT-OF-WAY DETAILS, SEE RIGHT-OF-WAY PLANS FOR THIS PROJECT.  
 THESE PLANS ARE SUBJECT TO SUCH REVISIONS AS MAY BE REQUIRED BY THE BUREAU OF PUBLIC ROADS OR THE COMMISSIONER OF HIGHWAYS.  
 CONSTRUCTION IS TO BE CARRIED ON IN ACCORDANCE WITH THESE  
 STAGE 1 CONSTRUCTION  
 TRANSPORTATION

Pin # 68B098

CASTLETON F 020-1(7)  
 CONTRACTOR - E.T. O'NEILL & SONS CONSTRUCTION CORP.  
 HOLYOKE, MA.  
 COMPLETED - SEPTEMBER 13, 1971.

EW Stebbins 10/11/67  
 H. Lubin 13 Dec 68  
 Hudson 10/10/67  
 J. Dunbar 10/11/67  
 G.M. Lane 10/12/67  
 R.H. Carroll 10/31/67

F 020-1(7)  
 206

SPIRAL CURVE ① EB $\theta_s$ 3° 07' 30" RT. $D_s$ 2° 30' 00" LT 166.69 ST 83.36 LS 250.00 TS 1302+73.97 SC 1305+23.97 SPI 1304+40.66 1304+40.61	SPIRAL CURVE ② WB $\theta_s$ 3° 07' 30" RT. $D_s$ 2° 30' 00" LT 166.69 ST 83.36 LS 250.00 TS 1308+01.27 SC 1310+51.27 SPI 1309+67.96 1309+67.91	CURVE ③ EB $\Delta$ 63° 58' 00" RT $D$ 2° 30' 00" $R$ 2291.83 $T$ 1431.17 $L$ 2558.67 $E$ 410.15 BANK 7/8" PER FOOT SC 1310+51.27 CS 1330+82.64 PI 1319+55.14 1316+51.47	CURVE ④ WB $\Delta$ 64° 12' 00" RT. $D$ 2° 30' 00" $R$ 2291.83 $T$ 1437.66 $L$ 2568.00 $E$ 413.60 BANK 7/8" PER FOOT SC 1310+51.27 CS 1336+19.27 PI 1324+88.93 1321+81.61	SPIRAL CURVE ⑤ EB $\theta_s$ 3° 07' 30" RT. $D_s$ 2° 30' 00" LT 166.69 ST 83.36 LS 250.00 TS 1330+82.64 SC 1333+32.64 SPI 1331+66.00 1331+65.95	SPIRAL CURVE ⑥ WB $\theta_s$ 3° 07' 30" RT. $D_s$ 2° 30' 00" LT 166.69 ST 83.36 LS 250.00 TS 1336+19.27 SC 1339+69.27 SPI 1337+02.63 1337+02.58	SPIRAL CURVE ⑦ EB $\theta_s$ 6° 07' 30" LT. $D_s$ 3° 30' 00" LT 233.47 ST 116.79 LS 350.00 TS 1366+10.65 SC 1369+60.65 SPI 1368+44.12 1368+43.86	SPIRAL CURVE ⑧ WB $\theta_s$ 6° 07' 30" LT. $D_s$ 3° 30' 00" LT 233.47 ST 116.79 LS 350.00 TS 1362+34.80 SC 1365+84.80 SPI 1364+68.27 1364+68.01	CURVE ⑨ EB $\Delta$ 24° 14' 00" LT. $D$ 3° 30' 00" $R$ 1637.02 $T$ 351.44 $L$ 692.38 $E$ 37.30 BANK 1" PER FOOT SC 1372+77.18 CS 1377+33.98 PI 1369+36.24 1369+25.74	CURVE ⑩ WB $\Delta$ 27° 04' 00" LT. $D$ 3° 30' 00" $R$ 1637.02 $T$ 394.02 $L$ 773.33 $E$ 46.75 BANK 1" PER FOOT SC 1372+77.18 CS 1377+33.98 PI 1373+54.67 1373+52.96	SPIRAL CURVE ⑪ EB $\theta_s$ 6° 07' 30" LT. $D_s$ 3° 30' 00" LT 233.47 ST 116.79 LS 350.00 TS 1372+77.18 SC 1376+27.18 SPI 1373+93.71 1373+93.71	SPIRAL CURVE ⑫ WB $\theta_s$ 6° 07' 30" LT. $D_s$ 3° 30' 00" LT 233.47 ST 116.79 LS 350.00 TS 1377+33.98 SC 1380+83.98 SPI 1378+50.77 1378+50.51	CURVE ⑬ TH-17 $\Delta$ 7° 15' 40" RT. $D$ 1° 00' 00" $R$ 5729.58 $T$ 363.54 $L$ 726.11 $E$ 11.52 BANK 1/4" PER FOOT PC 12+89.81 PT 20+15.92 PI 16+53.35 16+52.38
--	--	---	--	--	--	---	---	---	---	---	---	---



STAGE I CONSTRUCTION  
 STATE OF VERMONT  
 DEPARTMENT OF HIGHWAYS  
 RELOCATION OF U.S. ROUTE 4 in the town of  
 CASTLETON  
 ALIGNMENT DATA SHEET

PLAN SCALE  
 0 500 1000  
 1000 FEET

WEBSTER-MARTIN INC.  
 CONSULTING ENGINEERS  
 50, BURLINGTON, VERMONT

DESIGNED BY W.H. INC. CHECKED BY L.K.L. SCALE AS SHOWN  
 DRAWN BY J.D. IN CHARGE P.A.S. DATE JUNE 1968  
 PROJECT NO. F 020-1(7) SHEET 2 OF 206

Construct U Turn  
 EB 1294+00-WB 1296+05

STONE FILL FOR SLOPE PROTECTION (LIGHT TYPE) ITEM 512

STATION	STATION	POS
WESTBOUND		
1292+30	1297+20	ET
EASTBOUND		
1292+20	1293+20	ET

CONSTRUCT SPEED CHANGE LANE

STATION	STATION	POS
WESTBOUND		
1292+20	1293+20	LT

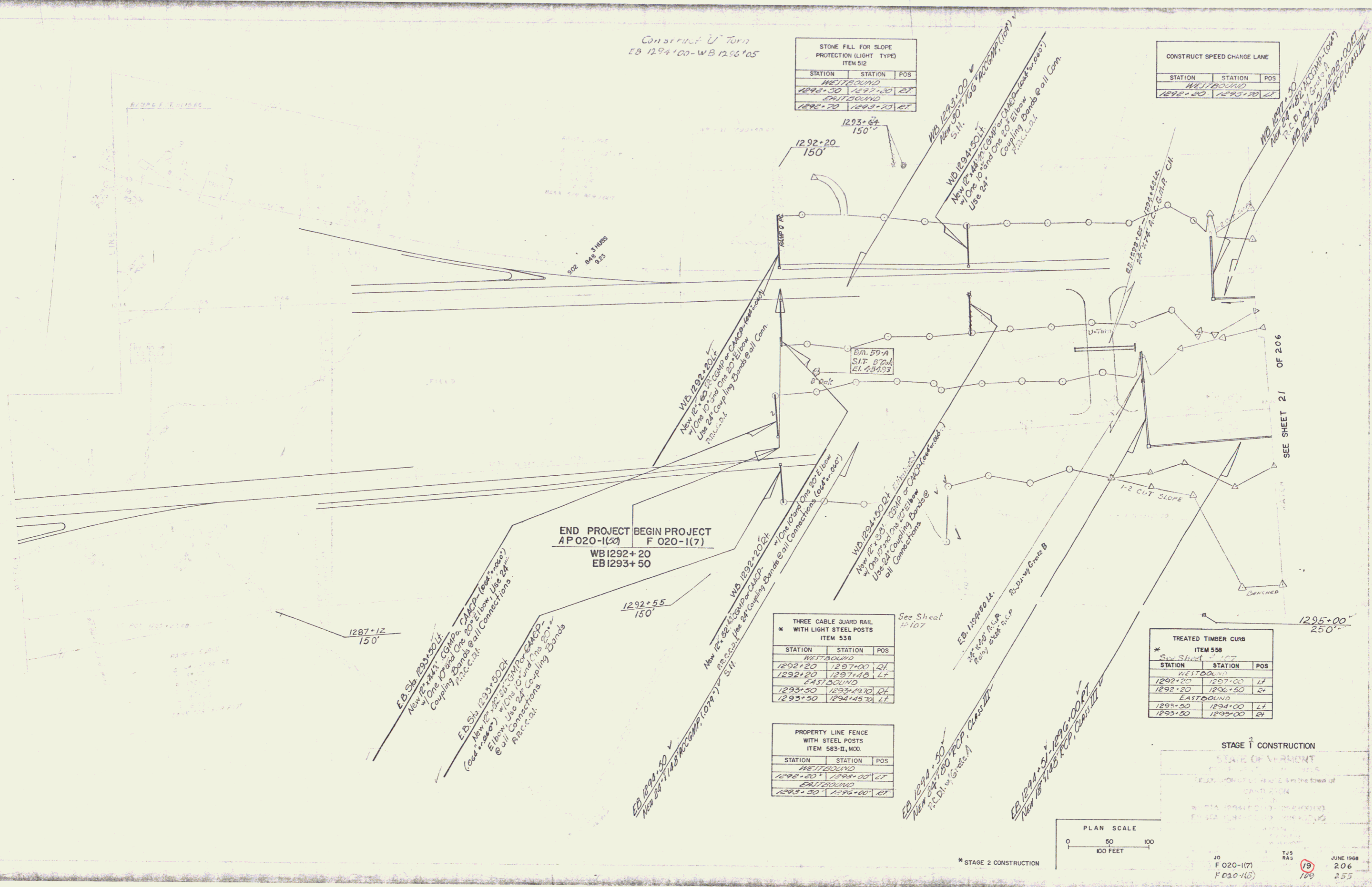

THREE CABLE GUARD RAIL WITH LIGHT STEEL POSTS ITEM 538

STATION	STATION	POS
WESTBOUND		
1292+20	1297+00	LT
1292+20	1297+15	LT
EASTBOUND		
1293+50	1293+40	LT
1293+50	1294+45	LT

PROPERTY LINE FENCE WITH STEEL POSTS ITEM 583-II, MOD.

STATION	STATION	POS
WESTBOUND		
1292+20	1293+20	ET
EASTBOUND		
1293+30	1294+00	ET

TREATED TIMBER CURB ITEM 558

STATION	STATION	POS
WESTBOUND		
1292+20	1297+00	LT
1292+20	1296+50	LT
EASTBOUND		
1293+50	1294+00	LT
1293+50	1293+00	LT

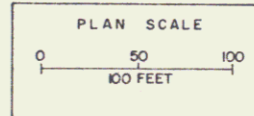

STAGE 2 CONSTRUCTION

STATE OF VERMONT  
 DEPARTMENT OF TRANSPORTATION  
 VERMONT HIGHWAY DEPARTMENT

JO F 020-1(7)  
 F 020-1(5)

TJS RAS  
 19 100

JUNE 1968  
 206  
 255

STONE FILL FOR SLOPE PROTECTION (LIGHT TYPE) ITEM 512		
STATION	STATION	POS
WESTBOUND		
1298+00	1300+00	LT
1300+00	1302+00	LT
EASTBOUND		
1309+00	1310+00	LT

* JUTE MATTING ITEM 623		
STATION	STATION	POS
WESTBOUND		
1298+00	1300+00	LT
1300+00	1302+00	LT
EASTBOUND		
1309+00	1310+00	LT

PROPERTY LINE FENCE WITH STEEL POSTS ITEM 583-II, MOD		
STATION	STATION	POS
WESTBOUND		
1298+00	1300+00	LT
EASTBOUND		
1309+00	1310+00	LT

THREE CABLE GUARD RAIL WITH LIGHT STEEL POSTS ITEM 538		
STATION	STATION	POS
WESTBOUND		
1300+00	1302+00	LT
EASTBOUND		
1309+00	1310+00	LT

* TREATED TIMBER CURB ITEM 538		
STATION	STATION	POS
WESTBOUND		
1300+00	1302+00	LT
EASTBOUND		
1309+00	1310+00	LT

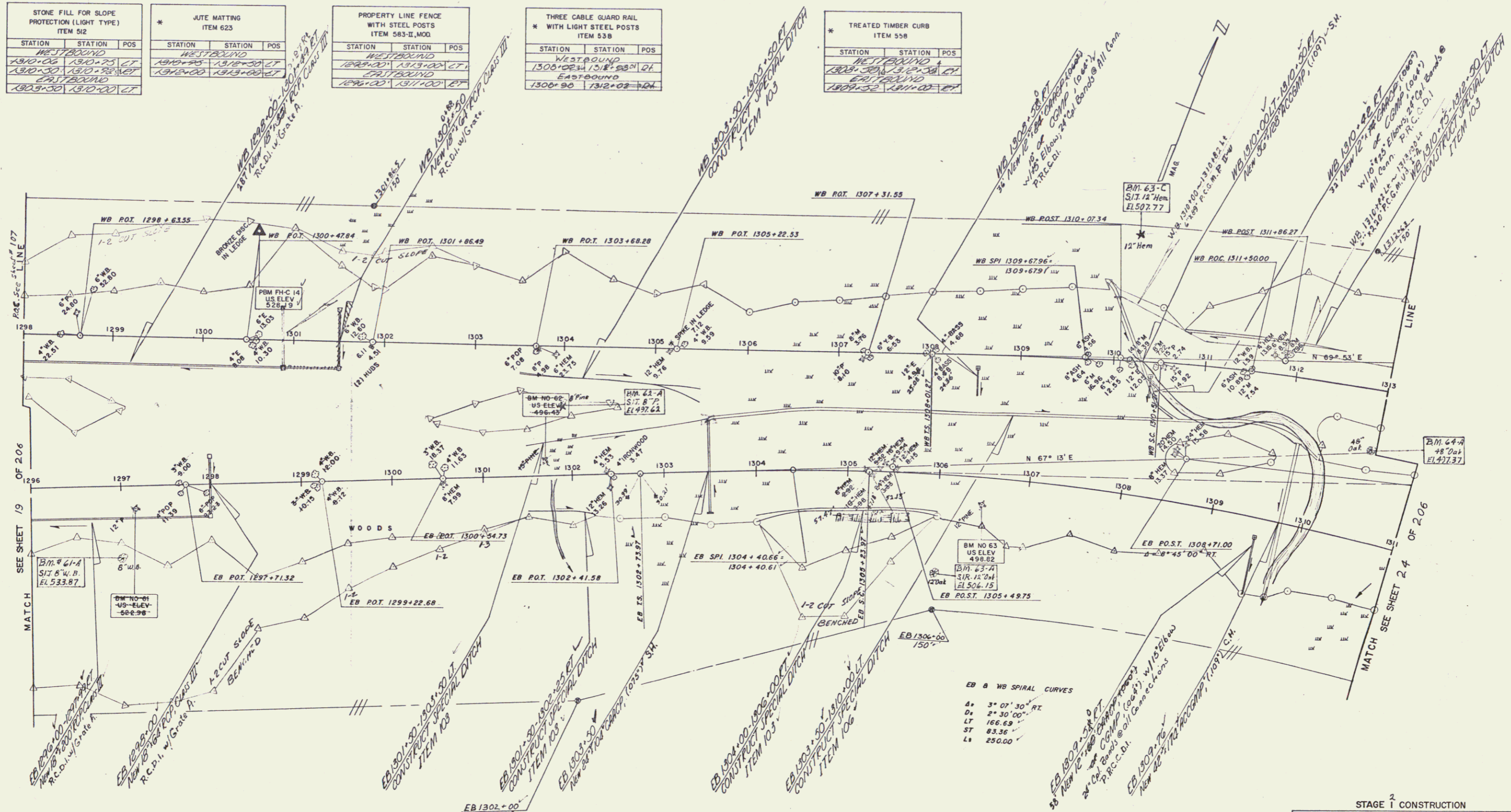

EB & WB SPIRAL CURVES  
 A = 3° 07' 30" RT  
 D = 2° 30' 00"  
 LT = 166.69  
 ST = 83.36  
 L = 250.00

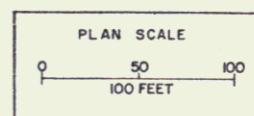

STAGE 2 CONSTRUCTION  
 STATE OF VERMONT  
 DEPARTMENT OF HIGHWAYS  
 RELOCATION OF U.S. ROUTE 4 in the town of  
 CASTLETON  
 PLAN  
 WB STA. 1298+00.00-1313+00.00  
 EB STA. 1296+00.00-1311+00.00

WEBSTER-MARTIN, INC.  
 CONSULTING ENGINEERS  
 50 BURLINGTON, VERMONT

SUPPLIED BY: W.M. INC.    CHECKED BY: T.J.S.    SCALE: AS SHOWN  
 DRAWN BY: J.B.    IN CHARGE: R.A.S.    DATE: JUNE 1988  
 PROJECT NO. F020-1(7)    SHEET (2) OF 206  
 F020-1(B)    177    255

STONE FILL FOR SLOPE PROTECTION (LIGHT TYPE) ITEM 512		
STATION	STATION	POS
WESTBOUND		
1312+25	1313+30	1'
1313+35	1314+40	1'
1314+45	1315+50	1'
1315+55	1316+60	1'
EASTBOUND		
1315+00	1316+05	1'
1316+10	1317+15	1'
1317+20	1318+25	1'
1318+30	1319+35	1'

THREE CABLE GUARD RAIL WITH LIGHT STEEL POSTS ITEM 538		
STATION	STATION	POS
WESTBOUND		
1316+54	1316+46	4'
1316+91	1316+87	4'
EASTBOUND		
1318+24	1318+18	4'
1318+58	1318+58	4'

JUTE MATTING ITEM 623		
STATION	STATION	POS
WESTBOUND		
1313+00	1313+30	1'

TREATED TIMBER CURB ITEM 558		
STATION	STATION	POS
WESTBOUND		
1316+54	1316+43	1'
1316+93	1316+87	1'
EASTBOUND		
1317+00	1317+00	1'

PROPERTY LINE FENCE WITH STEEL POSTS ITEM 583-II, MOD		
STATION	STATION	POS
WESTBOUND		
1313+00	1313+00	1'
EASTBOUND		
1311+00	1311+00	1'

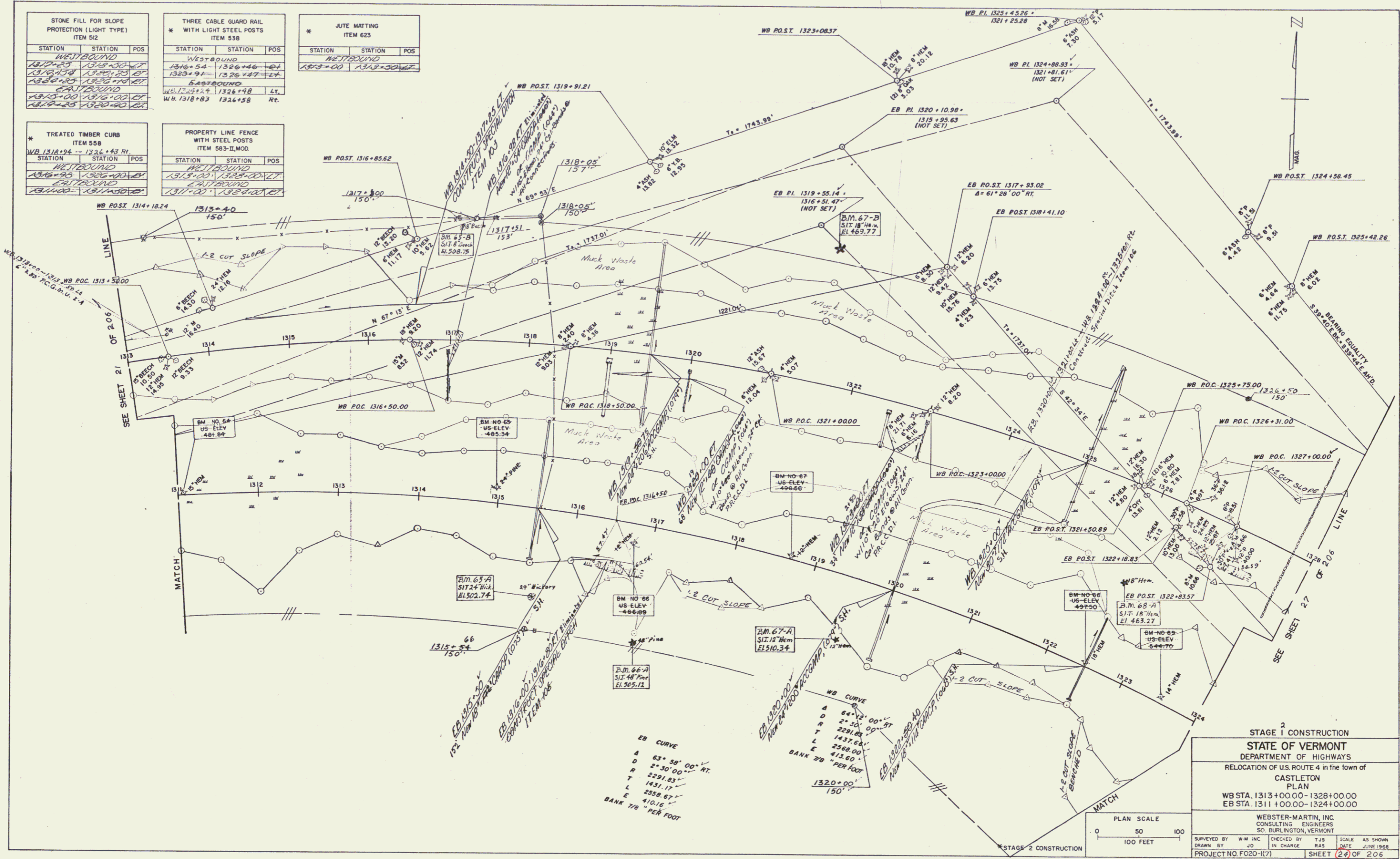

2  
**STAGE 1 CONSTRUCTION**  
**STATE OF VERMONT**  
 DEPARTMENT OF HIGHWAYS  
 RELOCATION OF U.S. ROUTE 4 in the town of  
**CASTLETON**  
 PLAN  
 WB STA. 1313+00.00-1328+00.00  
 EB STA. 1311+00.00-1324+00.00

WEBSTER-MARTIN, INC.  
 CONSULTING ENGINEERS  
 50 BURLINGTON, VERMONT

SURVEYED BY	W.M. INC.	CHECKED BY	T.J.S.	SCALE	AS SHOWN
DRAWN BY	J.D.	IN CHARGE	R.A.S.	DATE	JUNE 1968
PROJECT NO. F020-(17)			SHEET (24) OF 206		

174 255

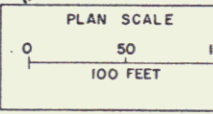

EB CURVE	
A	63° 58' 00" RT.
R	2291.83'
T	1431.17'
L	2558.67'
E	410.16'
BANK 7% PER FOOT	

WB CURVE	
A	64° 12' 00" ST.
R	2291.83'
T	1431.17'
L	2558.67'
E	410.16'
BANK 7% PER FOOT	

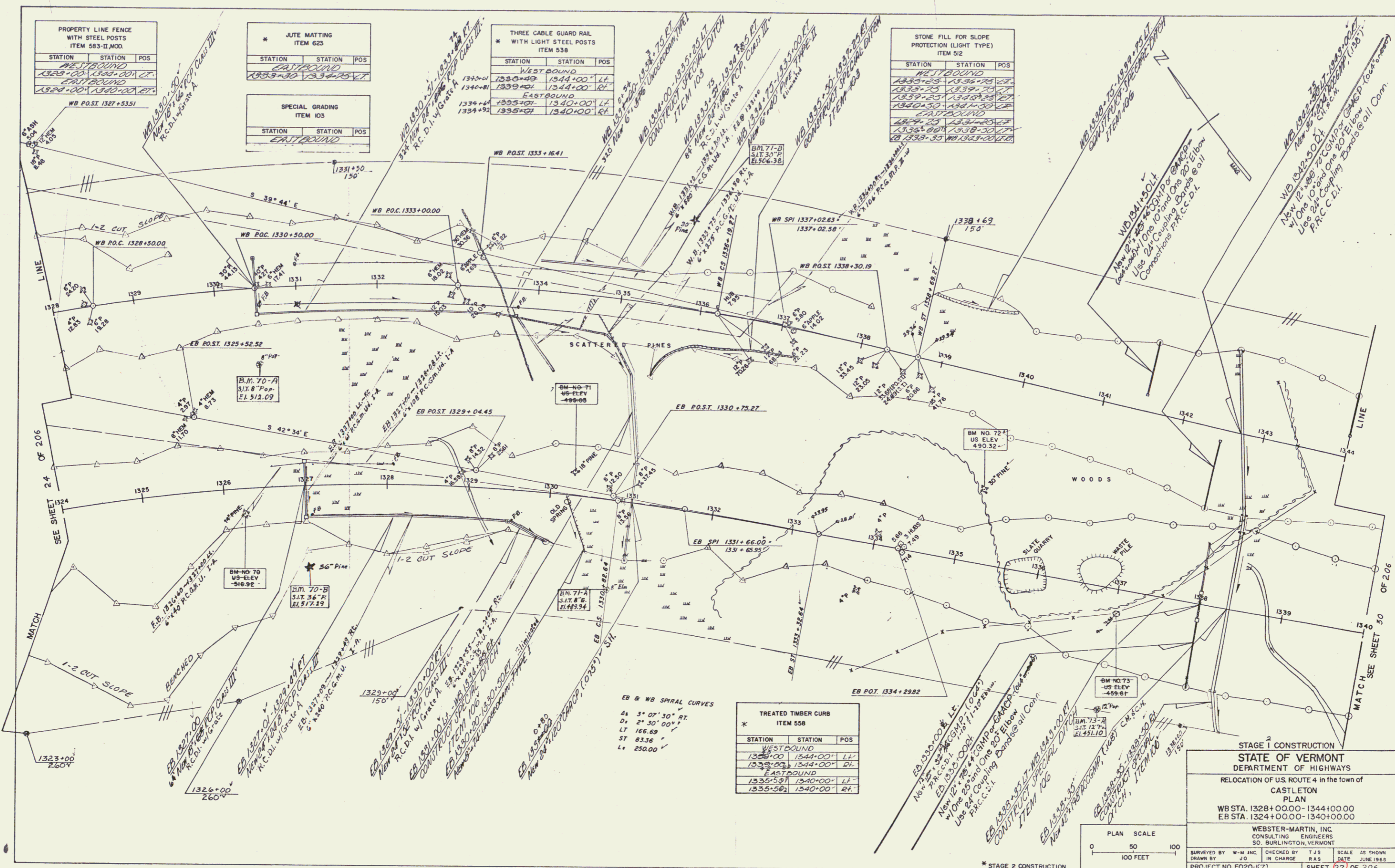

PROPERTY LINE FENCE WITH STEEL POSTS ITEM 583-II.MOD.		
STATION	STATION	POS
WESTBOUND		
1329+00	1334+00	LT.
EASTBOUND		
1329+00	1340+00	RT.

* JUTE MATTING ITEM 623		
STATION	STATION	POS
EASTBOUND		
1339+00	1334+00	RT.

THREE CABLE GUARD RAIL WITH LIGHT STEEL POSTS ITEM 538		
STATION	STATION	POS
WESTBOUND		
1330+00	1344+00	LT.
EASTBOUND		
1339+00	1344+00	RT.

STONE FILL FOR SLOPE PROTECTION (LIGHT TYPE) ITEM 92		
STATION	STATION	POS
WESTBOUND		
1335+00	1339+00	LT.
EASTBOUND		
1339+00	1344+00	RT.

TREATED TIMBER CURB ITEM 558		
STATION	STATION	POS
WESTBOUND		
1330+00	1344+00	LT.
EASTBOUND		
1335+00	1340+00	RT.

STAGE 1 CONSTRUCTION

**STATE OF VERMONT**  
DEPARTMENT OF HIGHWAYS

RELOCATION OF U.S. ROUTE 4 in the town of CASTLETON

PLAN

WB STA. 1328+00.00-1344+00.00  
EB STA. 1324+00.00-1340+00.00

WEBSTER-MARTIN, INC.  
CONSULTING ENGINEERS  
50 BURLINGTON, VERMONT

SCALE AS SHOWN

SURVEYED BY W-M INC. IN CHARGE TJS DATE JUNE 1965  
DRAWN BY JJO CHECKED BY RAS DATE JUNE 1965

PROJECT NO. F020-117 SHEET 27 OF 206

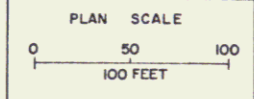

\* STAGE 2 CONSTRUCTION



PLAN  
 DRAWN BY: [ ]  
 CHECKED BY: [ ]  
 DATE: [ ]

PROFILE  
 DRAWN BY: [ ]  
 CHECKED BY: [ ]  
 DATE: [ ]

TOPSOIL ITEM 621		
STATION	STATION	POS
10+22	11+30	11
11+18	12+00	12

REMOVE EXISTING ROAD SURFACE COMMON EXCAVATION, CLASS I ITEM 103-A-1		
STATION	STATION	POS
7+75	11+25	-

CONSTRUCT DRIVES		
STATION	POS	
10+00	11	
11+00	12	

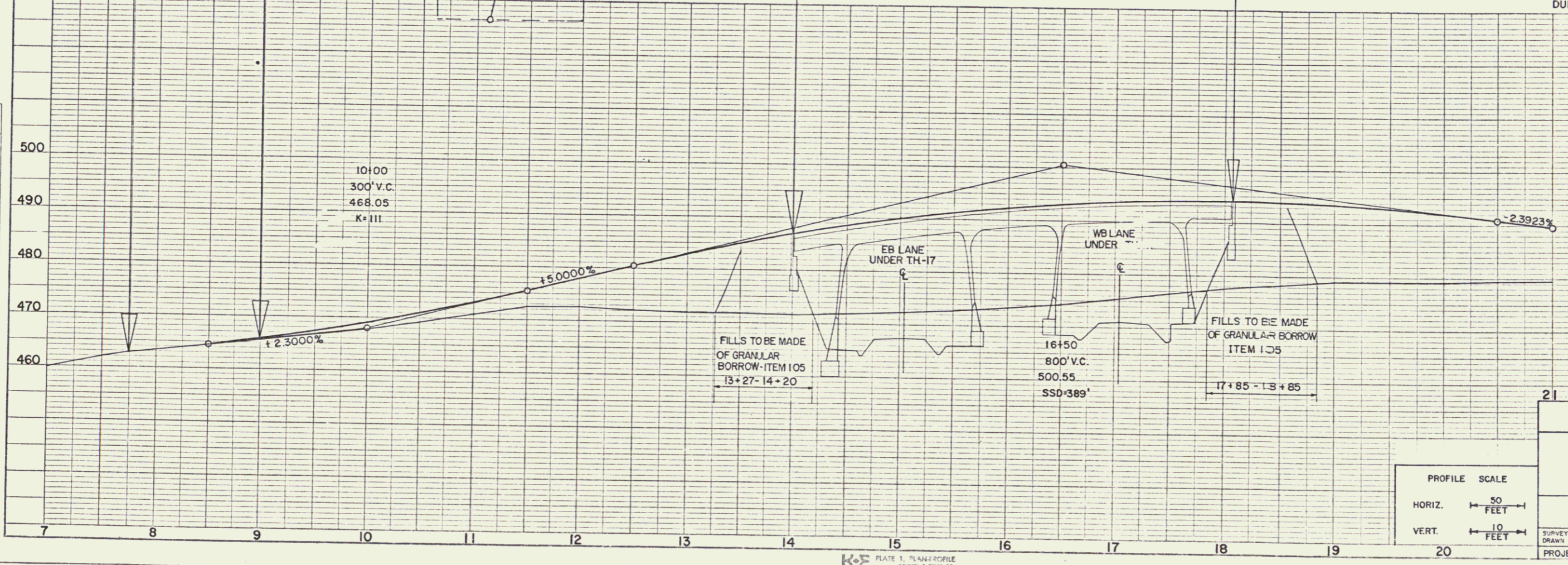
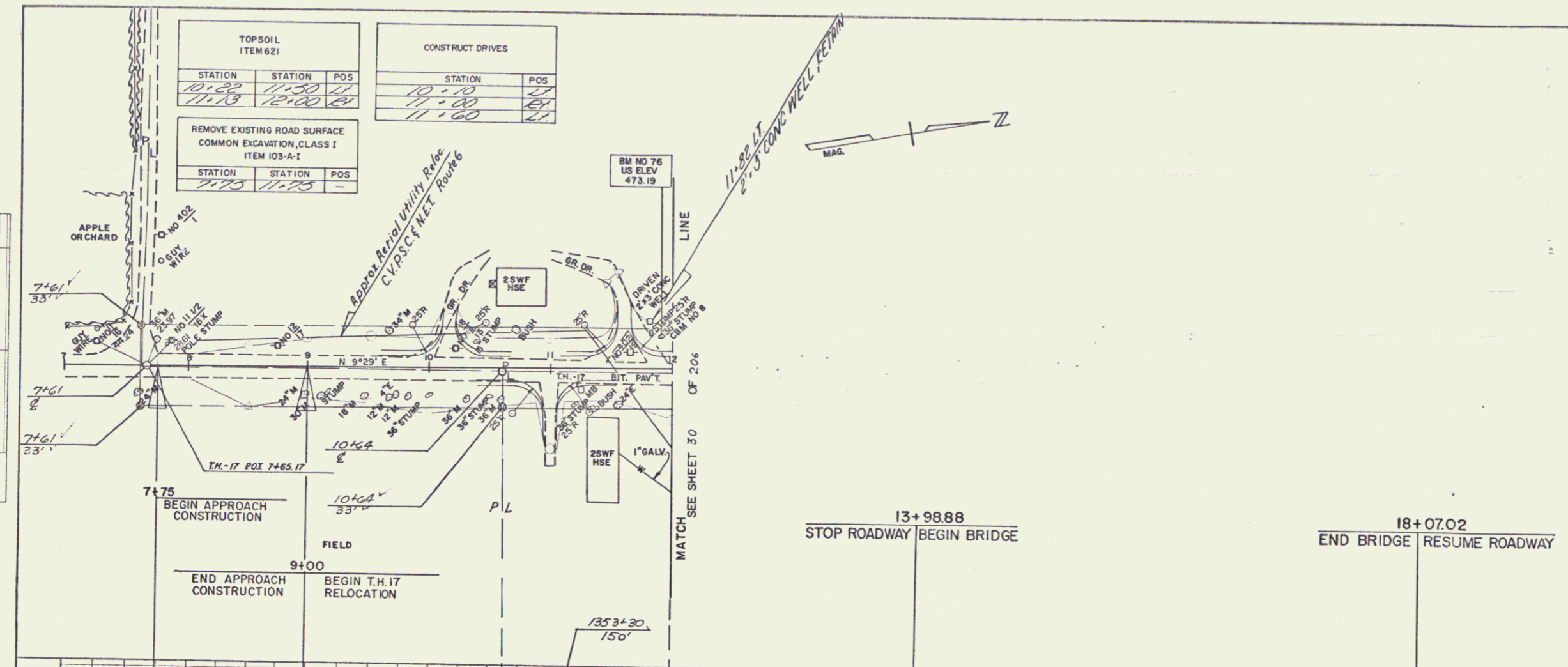

TH-17 IS TO BE BUILT IN ITS ENTIRETY DURING STAGE I CONSTRUCTION.

21

STATE OF VERMONT  
 DEPARTMENT OF HIGHWAYS

RELOCATION OF U.S. ROUTE 4 in the town of  
 CASTLETON  
 T.H. 17 RELOCATION  
 PLAN STA. 7+00.00-12+00.00  
 PROFILE STA. 7+00.00-21+00.00

WEBSTER-MARTIN, INC.  
 CONSULTING ENGINEERS  
 50 BURLINGTON, VERMONT

SUPPLIED BY: W.M. INC. CHECKED BY: T.J.S. SCALE: AS SHOWN  
 DRAWN BY: J.D. IN CHARGE: R.A.S. DATE: DEC 1967  
 PROJECT NO. F020-177 SHEET 63 OF 206

K-E PLATE 1, PLAN & PROFILE  
 487012 IMPERIAL™  
 21/65

PLAN  
 DRAWN BY: [ ]  
 CHECKED BY: [ ]  
 DATE: [ ]

PROFILE  
 DRAWN BY: [ ]  
 CHECKED BY: [ ]  
 DATE: [ ]

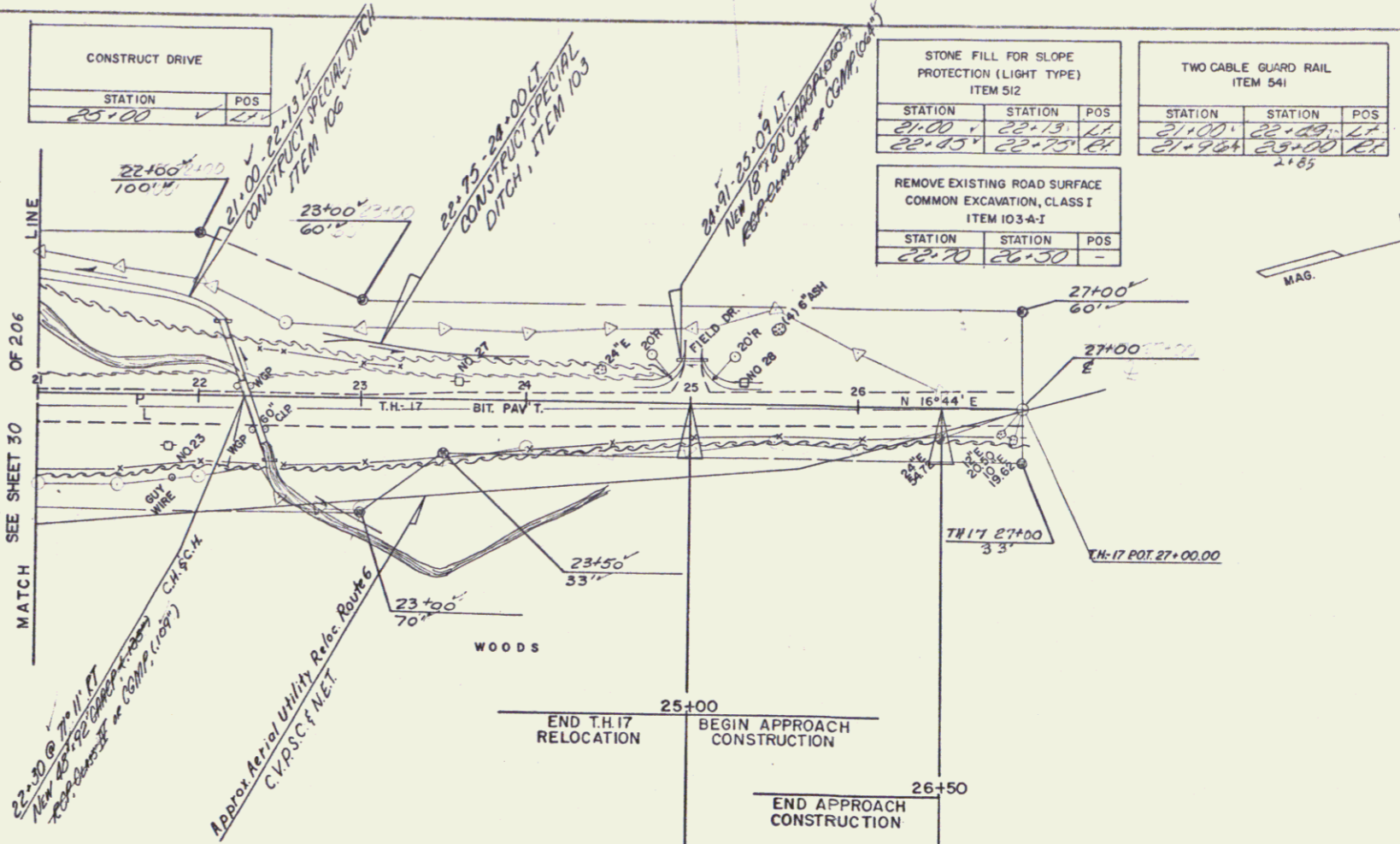

STONE FILL FOR SLOPE PROTECTION (LIGHT TYPE) ITEM 512			TWO CABLE GUARD RAIL ITEM 541		
STATION	STATION	POS	STATION	STATION	POS
21+00	22+13	11	21+00	22+29	17
22+13	22+75	62	22+29	23+00	71
					2185

REMOVE EXISTING ROAD SURFACE COMMON EXCAVATION, CLASS I ITEM 103.4-1		
STATION	STATION	POS
22+70	26+30	-

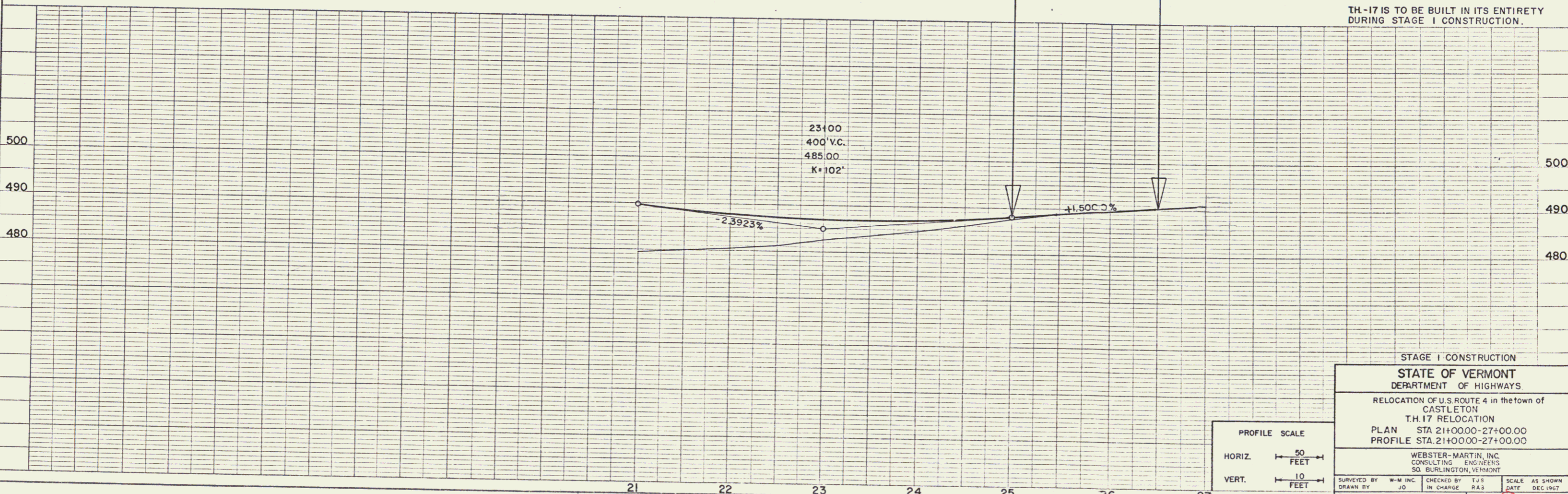

TH-17 IS TO BE BUILT IN ITS ENTIRETY DURING STAGE I CONSTRUCTION.

STAGE I CONSTRUCTION  
**STATE OF VERMONT**  
 DEPARTMENT OF HIGHWAYS  
 RELOCATION OF U.S. ROUTE 4 in the town of CASTLETON  
 T.H. 17 RELOCATION  
 PLAN STA 21+00.00-27+00.00  
 PROFILE STA 21+00.00-27+00.00

WEBSTER-MARTIN, INC.  
 CONSULTING ENGINEERS  
 50 BURLINGTON, VERMONT

SURVEYED BY: W.M. INC. CHECKED BY: T.J.S. SCALE AS SHOWN  
 DRAWN BY: [ ] IN CHARGE: P.A.S. DATE: DEC 1987  
 PROJECT NO. F020-1(7) SHEET 52 OF 206

PROFILE SCALE  
 HORIZ. 50 FEET  
 VERT. 10 FEET

* JUTE MATTING ITEM 623		
STATION	STATION	POS
1374+75	1375+00	LT

THREE CABLE GUARD RAIL WITH LIGHT STEEL POSTS ITEM 538		
STATION	STATION	POS
1368+00	1371+00	LT

STONE FILL FOR SLOPE PROTECTION (LIGHT TYPE) ITEM 512		
STATION	STATION	POS
1360+30	1362+30	LT

PROPERTY LINE FENCE WITH STEEL POSTS ITEM 583-II, MOD		
STATION	STATION	POS
1360+00	1375+00	LT

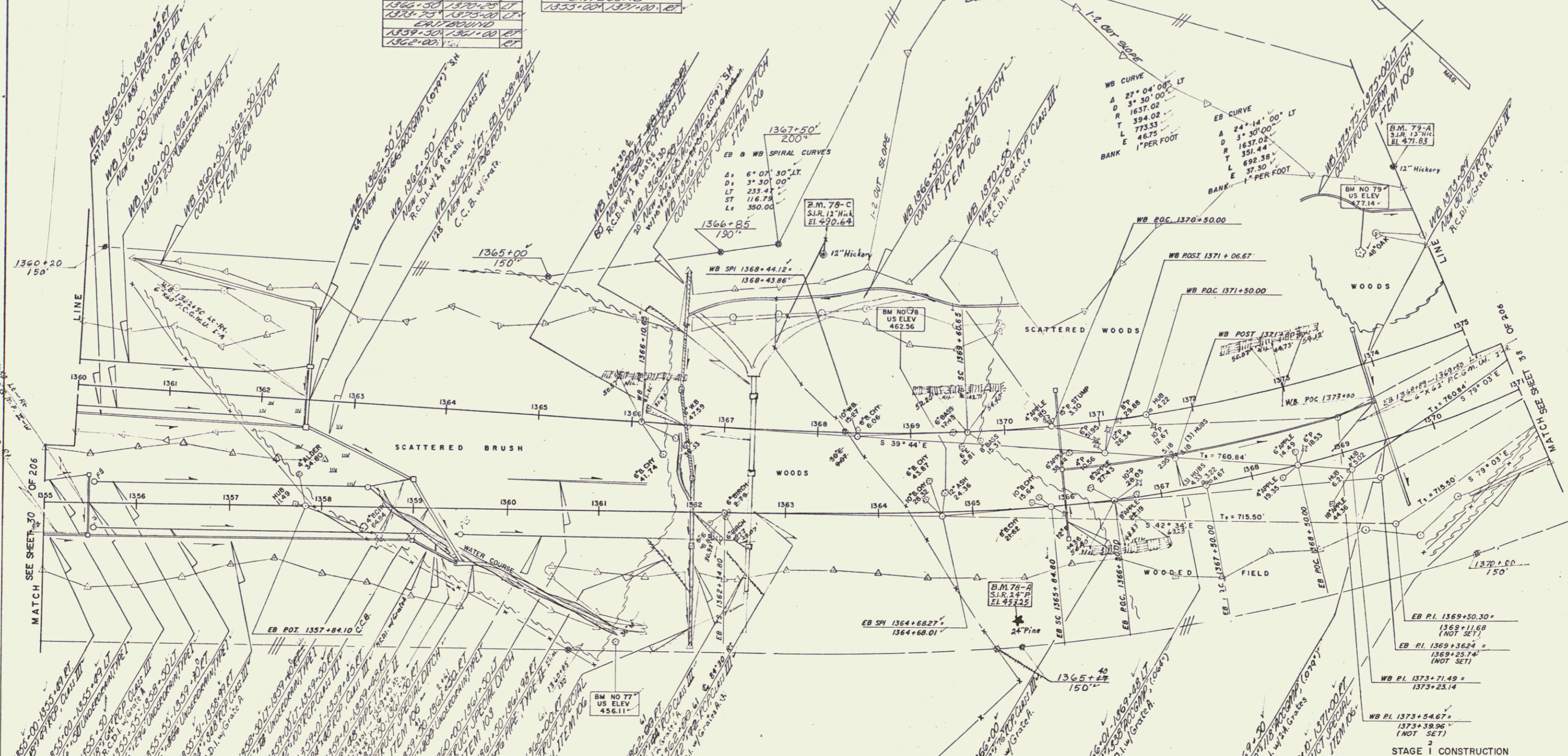

MATCH SEE SHEET 206  
 OF 206  
 EB STA. 1355+00 TO 1357+00  
 EB STA. 1357+00 TO 1359+00  
 EB STA. 1359+00 TO 1361+00  
 EB STA. 1361+00 TO 1363+00  
 EB STA. 1363+00 TO 1365+00  
 EB STA. 1365+00 TO 1367+00  
 EB STA. 1367+00 TO 1369+00  
 EB STA. 1369+00 TO 1371+00  
 EB STA. 1371+00 TO 1373+00  
 EB STA. 1373+00 TO 1375+00

MATCH SEE SHEET 207  
 OF 206  
 EB STA. 1375+00 TO 1377+00  
 EB STA. 1377+00 TO 1379+00  
 EB STA. 1379+00 TO 1381+00  
 EB STA. 1381+00 TO 1383+00  
 EB STA. 1383+00 TO 1385+00  
 EB STA. 1385+00 TO 1387+00  
 EB STA. 1387+00 TO 1389+00  
 EB STA. 1389+00 TO 1391+00  
 EB STA. 1391+00 TO 1393+00  
 EB STA. 1393+00 TO 1395+00

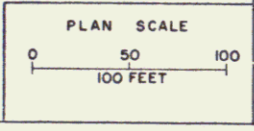

STAGE 1 CONSTRUCTION  
**STATE OF VERMONT**  
 DEPARTMENT OF HIGHWAYS  
 RELOCATION OF U.S. ROUTE 4 in the town of  
**CASTLETON**  
 PLAN  
 WB STA. 1360+00.00-1375+00.00  
 EB STA. 1355+00.00-1371+00.00

WEBSTER-MARTIN, INC.  
 CONSULTING ENGINEERS  
 50, BURLINGTON, VERMONT

SURVEYED BY W.M. INC. CHECKED BY T.J.S. SCALE AS SHOWN  
 DRAWN BY J.D. IN CHARGE R.A.S. DATE JUNE 1958  
 PROJECT NO. F020-1(7) SHEET 35 OF 206  
 F020-1(8) 25

\* STAGE 2 CONSTRUCTION

THREE CABLE GUARD RAIL WITH LIGHT STEEL POSTS ITEM 538		
STATION	STATION	POS
EASTBOUND		
1371+00	1373+98	121'

JUTE MATTING ITEM 623		
STATION	STATION	POS
WESTBOUND		
1375+00	1375+85	27'

PROPERTY LINE FENCE WITH STEEL POSTS ITEM 565-II-MOD.		
STATION	STATION	POS
WESTBOUND		
1375+00	1380+38	27'
EASTBOUND		
1371+00	1376+80	27'

STONE FILL FOR SLOPE PROTECTION (LIGHT TYPE) ITEM 512		
STATION	STATION	POS
WESTBOUND		
1375+00	1376+20	27'
EASTBOUND		
1375+00	1376+05	27'

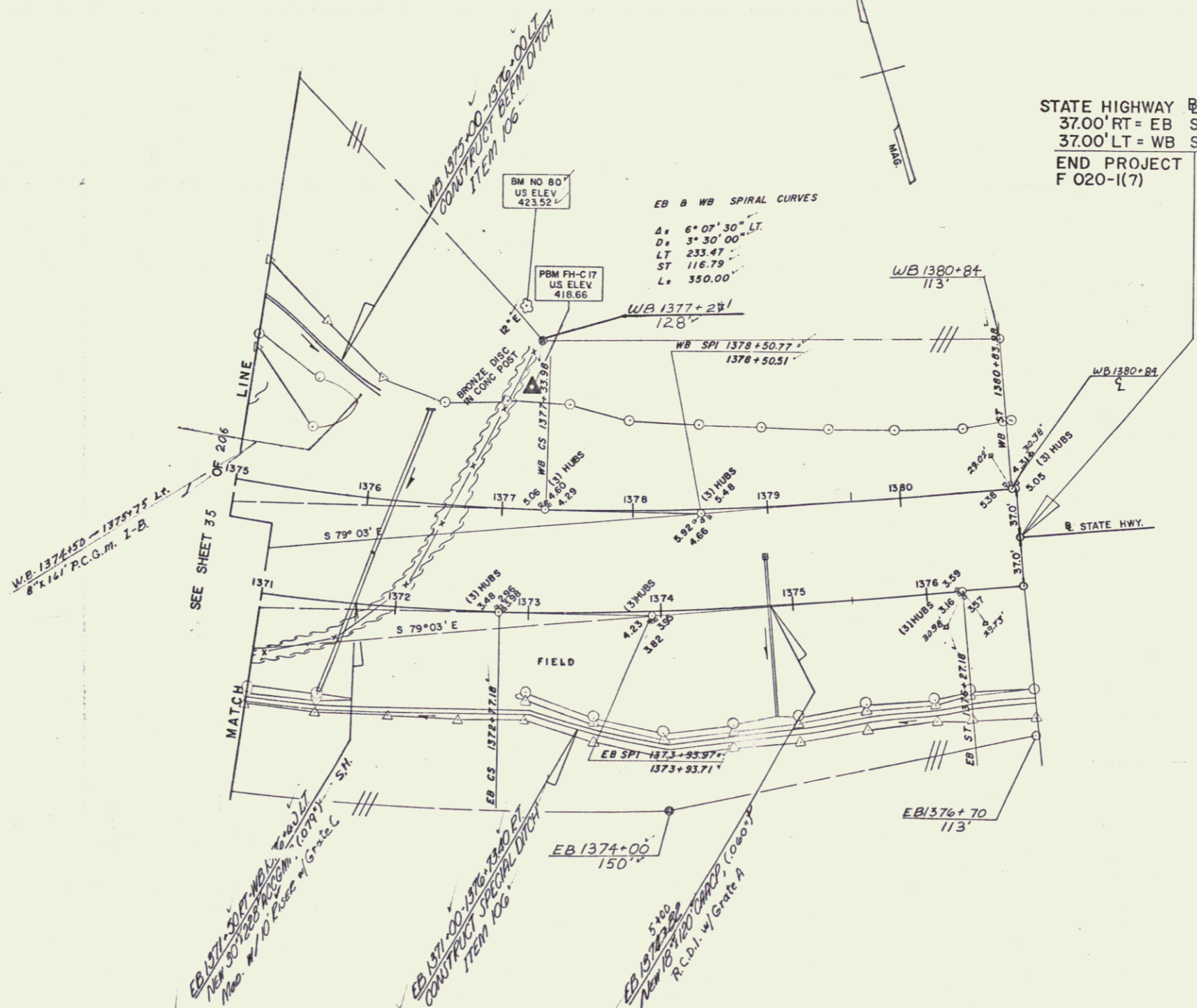

STATE HIGHWAY R STA 373+00.00  
 37.00' RT = EB STA 1376+73.40  
 37.00' LT = WB STA 1380+86.53  
 END PROJECT F 020-I(7) BEGIN PROJECT APO20-I(4)

Note  
 \* Sta 377+50 [Proj APO20-I(4)]  
 Reconstruct Existing  
 Maintenance Turn  
 to a "U" Turn

2  
 STAGE 1 CONSTRUCTION

**STATE OF VERMONT**  
 DEPARTMENT OF HIGHWAYS

RELOCATION OF U.S. ROUTE 4 in the town of  
 CASTLETON  
 PLAN

WB STA. 1375+00.00-1380+86.53  
 EB STA. 1371+00.00-1376+73.40

WEBSTER-MARTIN, INC.  
 CONSULTING ENGINEERS  
 50 BURLINGTON, VERMONT

SURVEYED BY W-M INC	CHECKED BY TJS	SCALE AS SHOWN
DRAWN BY JD	IN CHARGE BAS	DATE JUNE 1968
PROJECT NO. F020-I(7)	SHEET 58	OF 206

126 25.5

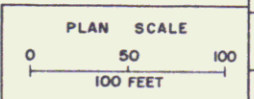

\* STAGE 2 CONSTRUCTION