

THREE CABLE GUARD RAIL WITH LIGHT STEEL POSTS ITEM 538		
STATION	STATION	POS
EASTBOUND		
1371+00	1373+98	121'

JUTE MATTING ITEM 623		
STATION	STATION	POS
WESTBOUND		
1375+00	1375+85	27'

PROPERTY LINE FENCE WITH STEEL POSTS ITEM 565-II-MOD.		
STATION	STATION	POS
WESTBOUND		
1375+00	1380+38	27'
EASTBOUND		
1371+00	1376+38	27'

STONE FILL FOR SLOPE PROTECTION (LIGHT TYPE) ITEM 512		
STATION	STATION	POS
WESTBOUND		
1375+00	1376+20	27'
EASTBOUND		
1371+00	1376+05	27'

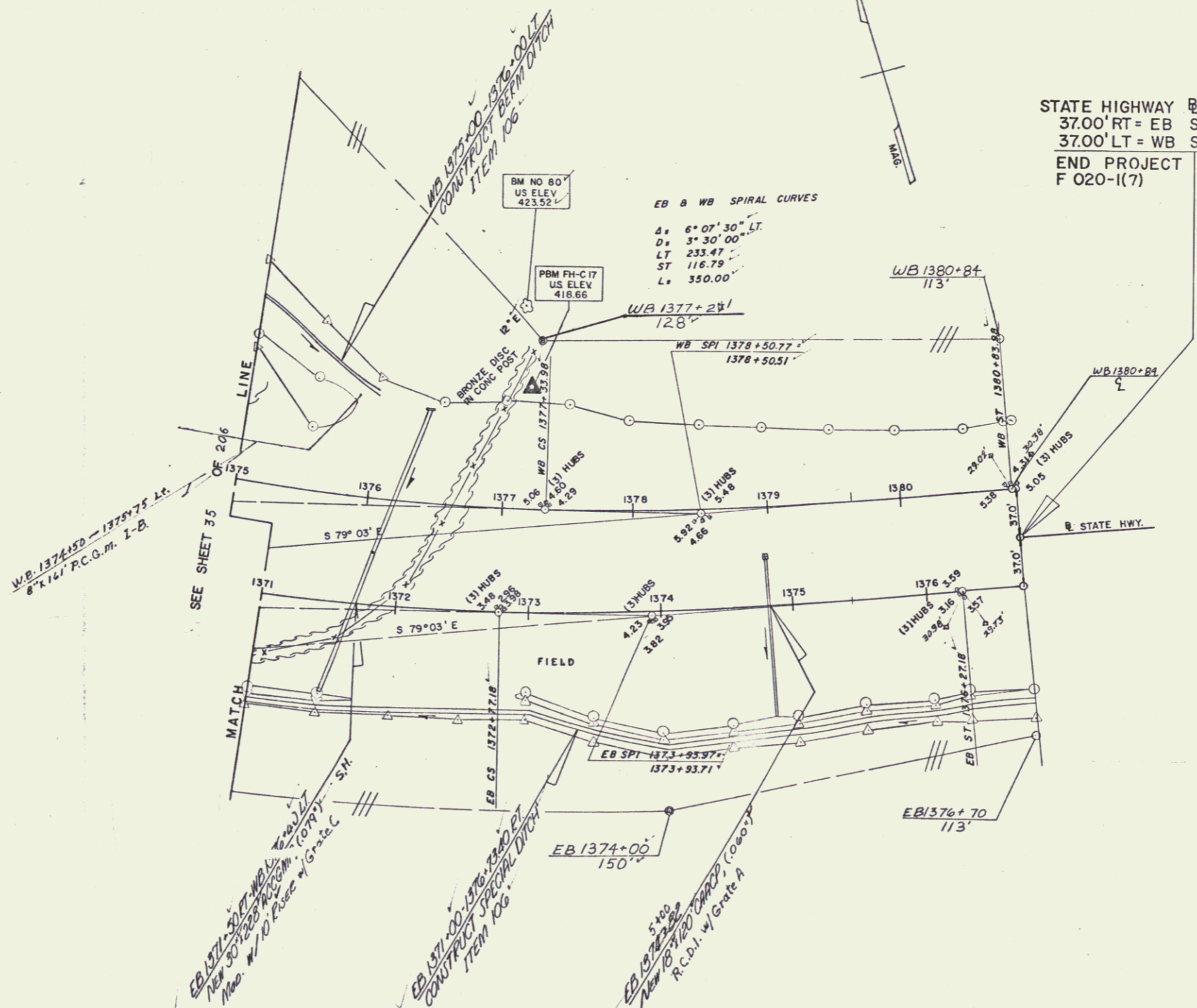

STATE HIGHWAY R STA 373+00.00
 37.00' RT = EB STA 1376+73.40
 37.00' LT = WB STA 1380+86.53
 END PROJECT F 020-1(7) BEGIN PROJECT APO20-1(4)

Note
 * See 377+50 [Proj APO20-1(4)]
 Reconstruct Existing
 Maintenance Turn
 to a "U" Turn

2
 STAGE 1 CONSTRUCTION

STATE OF VERMONT
 DEPARTMENT OF HIGHWAYS

RELOCATION OF U.S. ROUTE 4 in the town of
 CASTLETON
 PLAN

WB STA. 1375+00.00-1380+86.53
 EB STA. 1371+00.00-1376+73.40

WEBSTER-MARTIN, INC.
 CONSULTING ENGINEERS
 50 BURLINGTON, VERMONT

SURVEYED BY: W-M INC	CHECKED BY: TJS	SCALE: AS SHOWN
DRAWN BY: JD	IN CHARGE: BAS	DATE: JUNE 1968
PROJECT NO. F020-1(7)	SHEET 58	OF 206

126 25.5

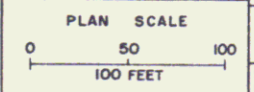

* STAGE 2 CONSTRUCTION