

PLAN
 DRAWN BY: []
 CHECKED BY: []
 DATE: []

PROFILE
 DRAWN BY: []
 CHECKED BY: []
 DATE: []

TOPSOIL ITEM 621		
STATION	STATION	POS
10+22	11+30	11
11+18	12+00	11

REMOVE EXISTING ROAD SURFACE COMMON EXCAVATION, CLASS I ITEM 103-A-1		
STATION	STATION	POS
7+75	11+25	-

CONSTRUCT DRIVES		
STATION	POS	
10+00	11	
11+00	11	

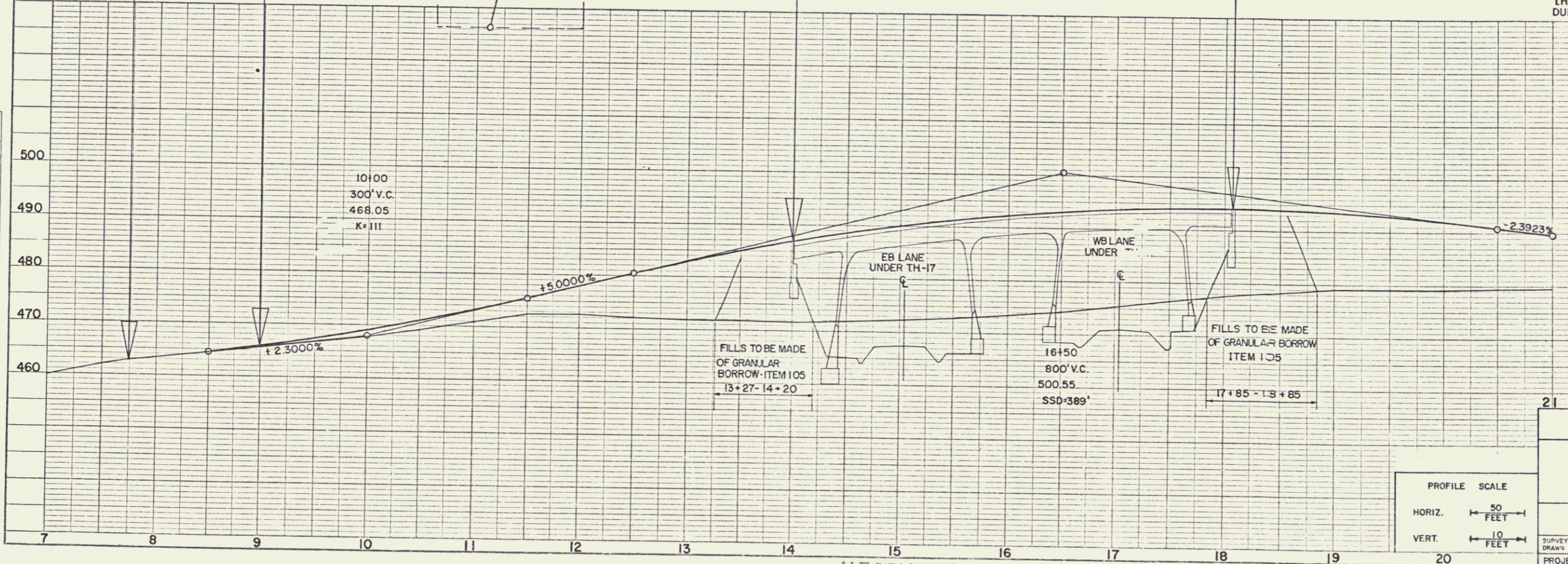
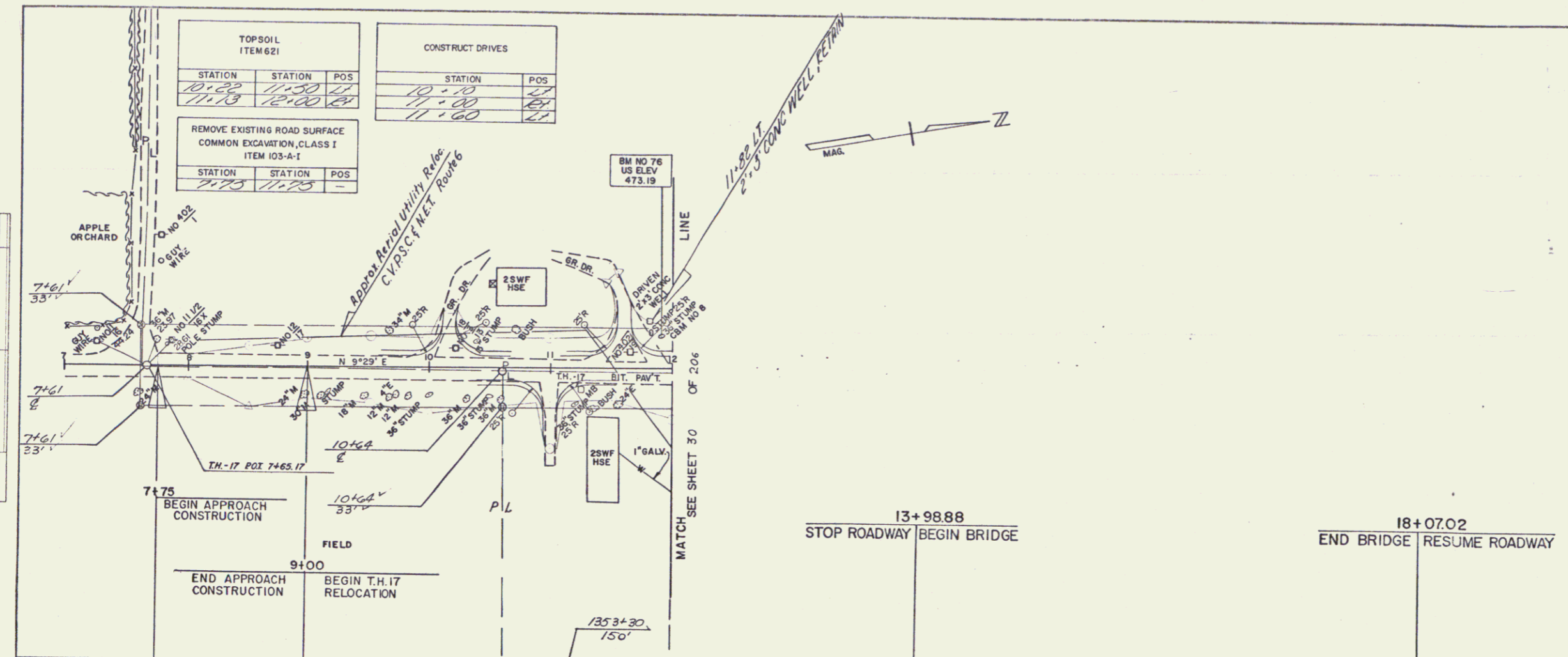

TH-17 IS TO BE BUILT IN ITS ENTIRETY DURING STAGE I CONSTRUCTION.

21

STATE OF VERMONT
 DEPARTMENT OF HIGHWAYS

RELOCATION OF U.S. ROUTE 4 in the town of
 CASTLETON
 T.H. 17 RELOCATION
 PLAN STA. 7+00.00-12+00.00
 PROFILE STA. 7+00.00-21+00.00

WEBSTER-MARTIN, INC.
 CONSULTING ENGINEERS
 50 BURLINGTON, VERMONT

SUPPLIED BY: W.M. INC. CHECKED BY: T.J.S. SCALE: AS SHOWN
 DRAWN BY: J.D. IN CHARGE: R.A.S. DATE: DEC 1967
 PROJECT NO. F020-177 SHEET 63 OF 206

K-E PLATE 1, PLAN & PROFILE
 487012 IMPERIAL™
 21/65