

PROPERTY LINE FENCE WITH STEEL POSTS ITEM 583-II.MOD.		
STATION	STATION	POS
WESTBOUND		
1344+00	1351+00	LT
1351+25	1360+00	LT
EASTBOUND		
1340+00	1349+30	RT
1349+65	1355+00	RT

STONE FILL FOR SLOPE PROTECTION (LIGHT TYPE) ITEM 512		
STATION	STATION	POS
WESTBOUND		
1345+00	1346+48	RT
1348+30	1349+00	LT
EASTBOUND		
1349+23	-	-
1350+00	1350+00	LT

TWO CABLE GUARD RAIL ITEM 541		
STATION	STATION	POS
TH-17		
13+08.3	13+79.1	RT
13+80.1	13+97.1	RT
13+11.1	13+45.3	RT
13+43.3	2+14.0	LT

TREATED TIMBER CURB ITEM 556		
STATION	STATION	POS
TH-17		
13+08.3	13+29.1	LT
13+12.1	13+29.1	LT
WESTBOUND		
13+44+00	13+49+00	LT
13+44+00	13+50+00	RT
EASTBOUND		
13+41+00	13+41+00	LT
13+41+00	13+41+00	RT

EXCAVATION AND REMOVAL OF ROAD SURFACES AND/OR PAVEMENTS ITEM 119		
STATION	STATION	POS
TH-17		
13+64	13+29	E

REMOVE EXISTING ROAD SURFACE COMMON EXCAVATION, CLASS I ITEM 103-A-1		
STATION	STATION	POS
WESTBOUND		
130+78.1	133+00	RT
EASTBOUND		
1343+30	1349+42	RT

THREE CABLE GUARD RAIL WITH LIGHT STEEL POSTS ITEM 538		
STATION	STATION	POS
WESTBOUND		
1344+00	1350+00	LT
1344+00	1350+00	RT
EASTBOUND		
1340+00	1347+45	RT
1340+00	1347+45	LT

SPECIAL GRADING ITEM 103		
STATION	STATION	POS
EASTBOUND		

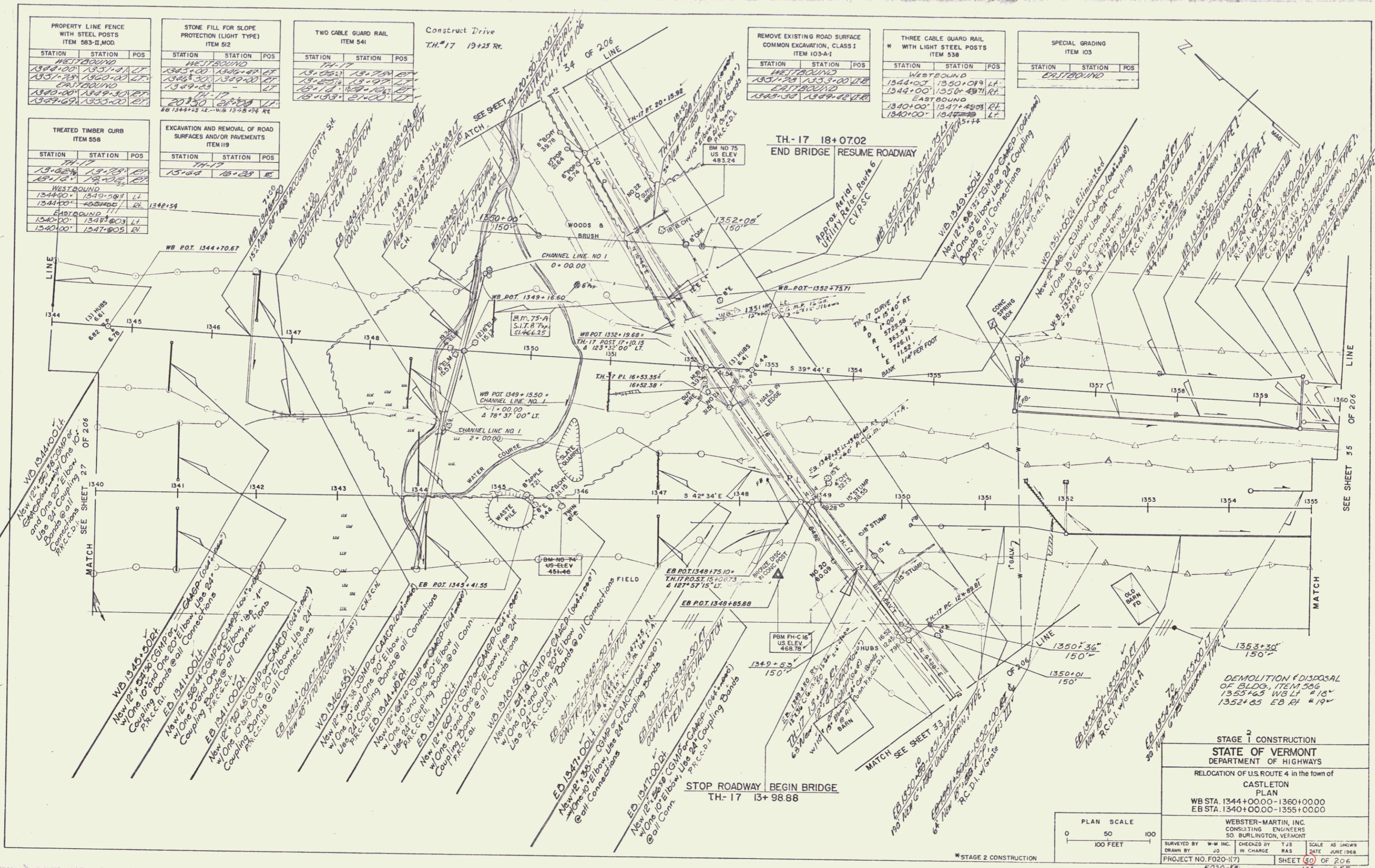

STAGE 2 CONSTRUCTION

STATE OF VERMONT
DEPARTMENT OF HIGHWAYS

RELOCATION OF U.S. ROUTE 4 in the town of
CASTLETON

PLAN
WB STA. 1344+00.00 - 1360+00.00
EB STA. 1340+00.00 - 1355+00.00

WEBSTER-MARTIN, INC.
CONSULTING ENGINEERS
50 BURLINGTON, VERMONT

SURVEYED BY W.M. INC. CHECKED BY T.J.S. SCALE AS SHOWN
DRAWN BY J.S. IN CHARGE RAS DATE JUNE 1968
PROJECT NO. F020-173 SHEET 50 OF 206
F020-18 120 293

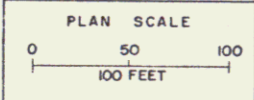

*STAGE 2 CONSTRUCTION