

| STONE FILL FOR SLOPE PROTECTION (LIGHT TYPE) ITEM 512 |         |     |
|---|---------|-----|
| STATION   | STATION | POS |
| WESTBOUND   |         |     |
| 1312+25   | 1313+30 | 1'  |
| 1313+35   | 1314+40 | 1'  |
| 1314+45   | 1315+50 | 1'  |
| 1315+55   | 1316+60 | 1'  |
| EASTBOUND   |         |     |
| 1315+50   | 1316+55 | 1'  |
| 1316+60   | 1317+65 | 1'  |
| 1317+70   | 1318+75 | 1'  |
| 1318+80   | 1319+85 | 1'  |

| THREE CABLE GUARD RAIL WITH LIGHT STEEL POSTS ITEM 538 |         |      |
|--|---------|------|
| STATION  | STATION | POS  |
| WESTBOUND  |         |      |
| 1314+54  | 1316+46 | 24'  |
| 1316+91  | 1326+47 | 147' |
| EASTBOUND  |         |      |
| 1318+82  | 1326+58 | 86'  |

| JUTE MATTING ITEM 623 |         |     |
|-----------------------|---------|-----|
| STATION               | STATION | POS |
| WESTBOUND             |         |     |
| 1313+00               | 1313+50 | 50' |

| TREATED TIMBER CURB ITEM 558 |         |      |
|------------------------------|---------|------|
| STATION                      | STATION | POS  |
| WESTBOUND                    |         |      |
| 1318+54                      | 1322+43 | 49'  |
| EASTBOUND                    |         |      |
| 1316+93                      | 1326+40 | 147' |

| PROPERTY LINE FENCE WITH STEEL POSTS ITEM 583-II, MOD |         |      |
|---|---------|------|
| STATION   | STATION | POS  |
| WESTBOUND   |         |      |
| 1313+00   | 1328+00 | 157' |
| EASTBOUND   |         |      |
| 1311+00   | 1324+00 | 133' |

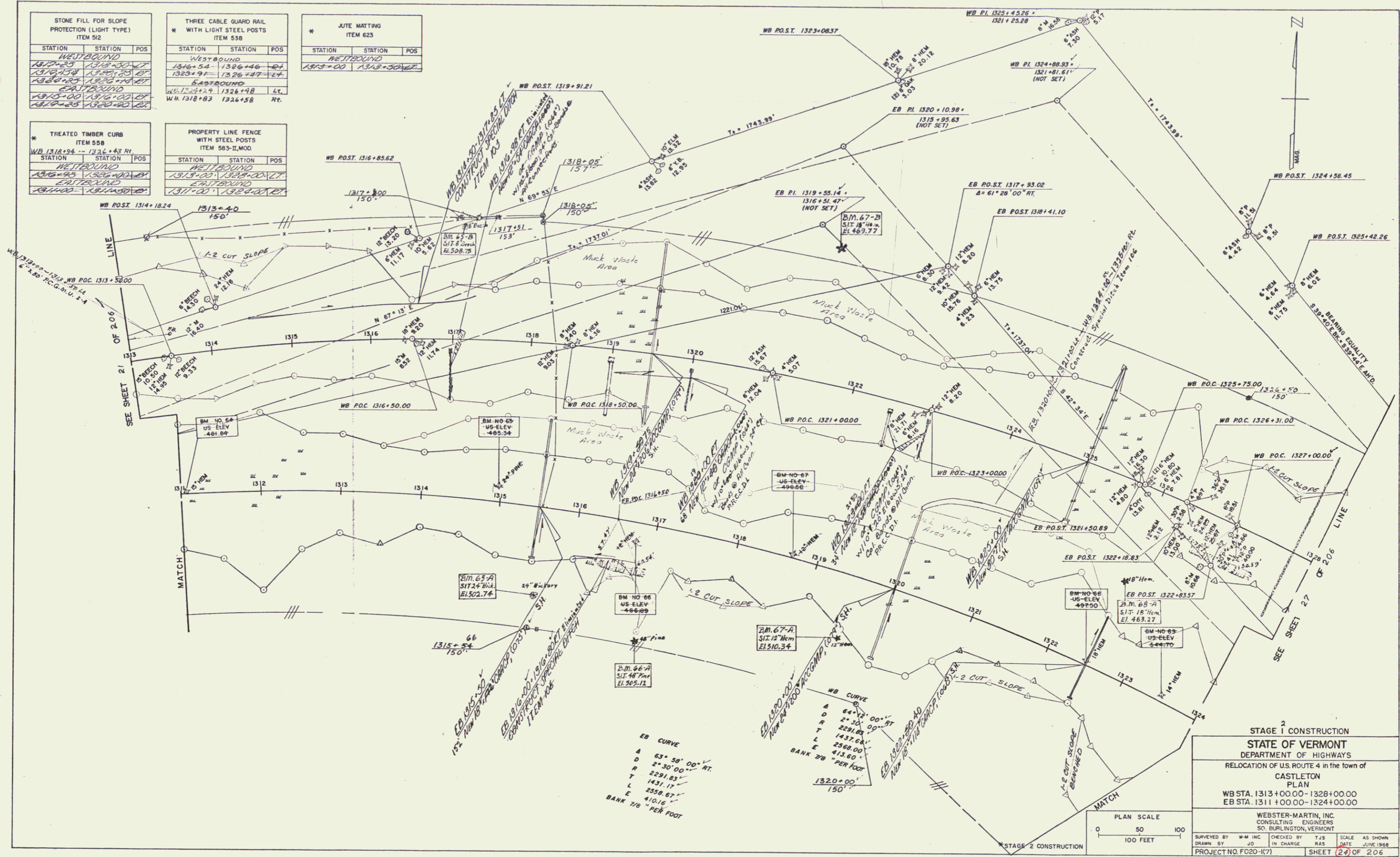

2  
STAGE 1 CONSTRUCTION  
STATE OF VERMONT  
DEPARTMENT OF HIGHWAYS  
RELOCATION OF U.S. ROUTE 4 in the town of  
CASTLETON  
PLAN  
WB STA. 1313+00.00-1328+00.00  
EB STA. 1311+00.00-1324+00.00

WEBSTER-MARTIN, INC.  
CONSULTING ENGINEERS  
50 BURLINGTON, VERMONT

|                       |           |            |                   |       |           |
|-----------------------|-----------|------------|-------------------|-------|-----------|
| SURVEYED BY           | W.M. INC. | CHECKED BY | T.J.S.            | SCALE | AS SHOWN  |
| DRAWN BY              | J.D.      | IN CHARGE  | R.A.S.            | DATE  | JUNE 1968 |
| PROJECT NO. F020-1(7) |           |            | SHEET (24) OF 206 |       |           |

174 255

EB CURVE

|   |                 |
|---|-----------------|
| A | 63° 58' 00" RT. |
| D | 2° 30' 00" RT.  |
| R | 2291.83'        |
| T | 1431.17'        |
| L | 2558.67'        |
| E | 410.16'         |

BANK 7% PER FOOT

