

STONE FILL FOR SLOPE PROTECTION (LIGHT TYPE) ITEM 512		
STATION	STATION	POS
WESTBOUND		
1298+00	1300+00	LT
1300+00	1300+00	RT
EASTBOUND		
1309+00	1310+00	LT

* JUTE MATTING ITEM 623		
STATION	STATION	POS
WESTBOUND		
1298+00	1300+00	LT
1300+00	1300+00	RT
EASTBOUND		
1309+00	1310+00	LT

PROPERTY LINE FENCE WITH STEEL POSTS ITEM 583-II, MOD		
STATION	STATION	POS
WESTBOUND		
1298+00	1300+00	LT
1300+00	1300+00	RT
EASTBOUND		
1309+00	1310+00	LT

THREE CABLE GUARD RAIL WITH LIGHT STEEL POSTS ITEM 538		
STATION	STATION	POS
WESTBOUND		
1300+00	1302+00	LT
1302+00	1302+00	RT
EASTBOUND		
1309+00	1310+00	LT

* TREATED TIMBER CURB ITEM 538		
STATION	STATION	POS
WESTBOUND		
1300+00	1302+00	LT
1302+00	1302+00	RT
EASTBOUND		
1309+00	1310+00	LT

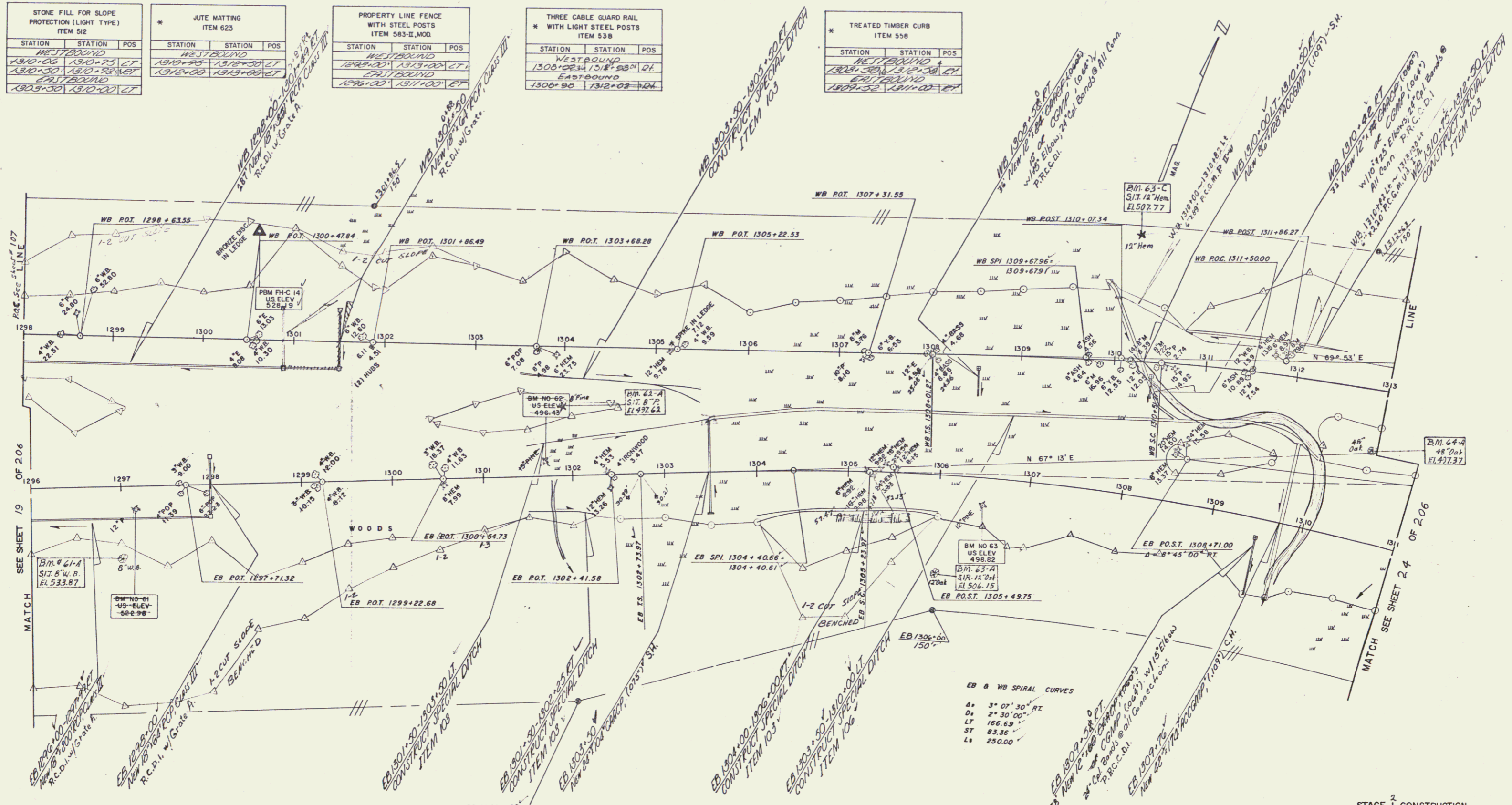

EB 8 WB SPIRAL CURVES
 A= 3° 07' 30" RT
 D= 2° 30' 00"
 LT 166.69
 ST 83.36
 L= 250.00

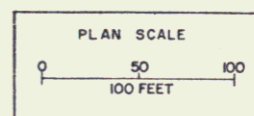

STAGE 2 CONSTRUCTION
 STATE OF VERMONT
 DEPARTMENT OF HIGHWAYS
 RELOCATION OF U.S. ROUTE 4 in the town of
 CASTLETON
 PLAN
 WB STA. 1298+00.00-1313+00.00
 EB STA. 1296+00.00-1311+00.00

WEBSTER-MARTIN, INC.
 CONSULTING ENGINEERS
 50 BURLINGTON, VERMONT

SUPPLIED BY W.M. INC. CHECKED BY T.J.S. SCALE AS SHOWN
 DRAWN BY J.B. IN CHARGE R.A.S. DATE JUNE 1988
 PROJECT NO. F020-1(7) SHEET (2) OF 206
 F020-1(B) 177 255