

POOR ORIGINAL COPY

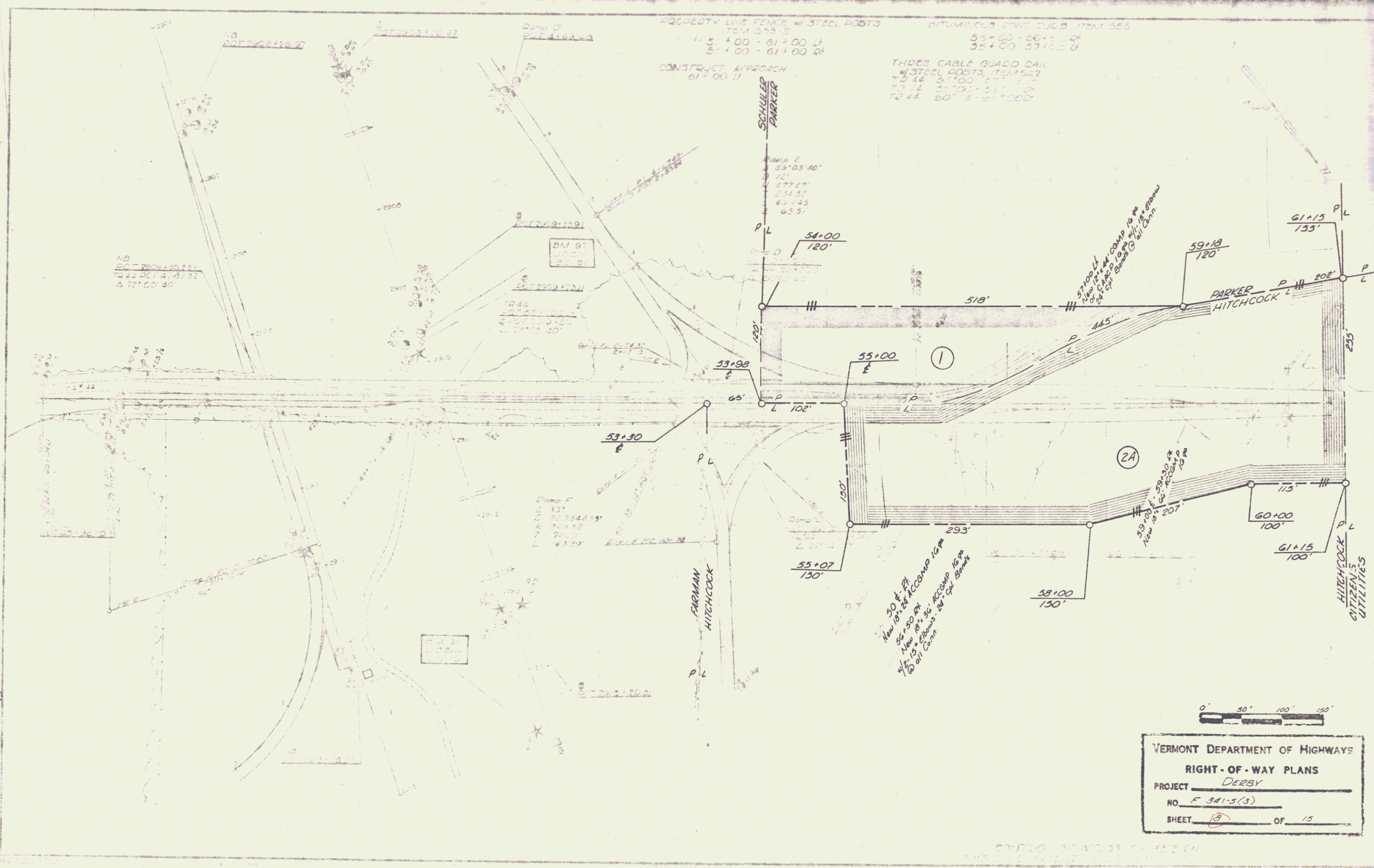

PROPERTY LINE FENCE W/ STEEL POSTS
ITEM 545 B
53+00 - 61+00 LF
53+00 - 61+00 DF

BITUMINOUS CONC CURB ITEM 553
55+00 - 56+25 LF
56+00 - 57+25 LF

THREE CABLE GUARD RAIL
W/ STEEL POSTS ITEM 542
53+00 - 57+00 LF
57+00 - 59+00 LF
59+00 - 61+00 LF

NO
207 2808+10.21
7241 DCI 41 03 32
A 72° 00' 40"

BM 97
D. 28
E. 28

Curve F
C. 33'
L. 207.42 LF
T. 74.03'
L. 43.30'

P.L.
54+00
120'

53+98
E
65'

53+30
E

55+00
E
120'

55+07
150'

30' LF
New 18" x 18" CONC 16" R
50+50 LF
New 18" x 18" CONC 16" R
48" x 24" Slopes to Ch. Bank
to at Conn.

58+00
150'

(2A)

59+00
150'

60+00
100'

61+15
100'

61+15
133'

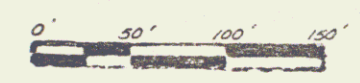

VERMONT DEPARTMENT OF HIGHWAYS
RIGHT-OF-WAY PLANS
PROJECT DERBY
NO. F 341-5(3)
SHEET 13 OF 15

CONT'D. OF SHEET 12 ON
THIS SIDE OF SHEET