

ALL DRIVES AS INDICATED ON PLANS ARE SUBJECT TO PERMITS PURSUANT TO TITLE 19 SECTION 43, V.S.A

CONTRACT PLANS FOR DEAD END

SB 1628+00 LT
NB 1628+05 RT

Removal of Disposal of Bldg. Item 604/0

SB 1625+33 LT
NB 1625+00 LT
NB 1626+10 RT
NB 1625+45 LT
SB 1625+15 RT
NB 1625+55 E
NB 1625+55 LT
SB 1625+30 RT
NB 1627+80 LT
Reloc. In 27' to 65' E
(See Sht. 601)
NB 1628+40 RT
NB 1629+00 RT
NB 1629+10 RT
NB 1629+20 LT
SB 1625+15 LT

W. City Limits for Gutters and Traffic Islands Item 616/2

TH 27 28-30 - 24-50 RT
TH 27 23-30 - 24-50 LT

W. City Limits Item 634/0

TH 27 25+32 - 26-50 RT
TH 27 25+32 - 26-50 LT

Treated Timber Curb

Item 616/3
Crossover
1-60-4-00

Three-Edge Guard Rail

1/2 Night Steel Posts Item 621/1
NB 1636+00
Crossover 4+00 LT

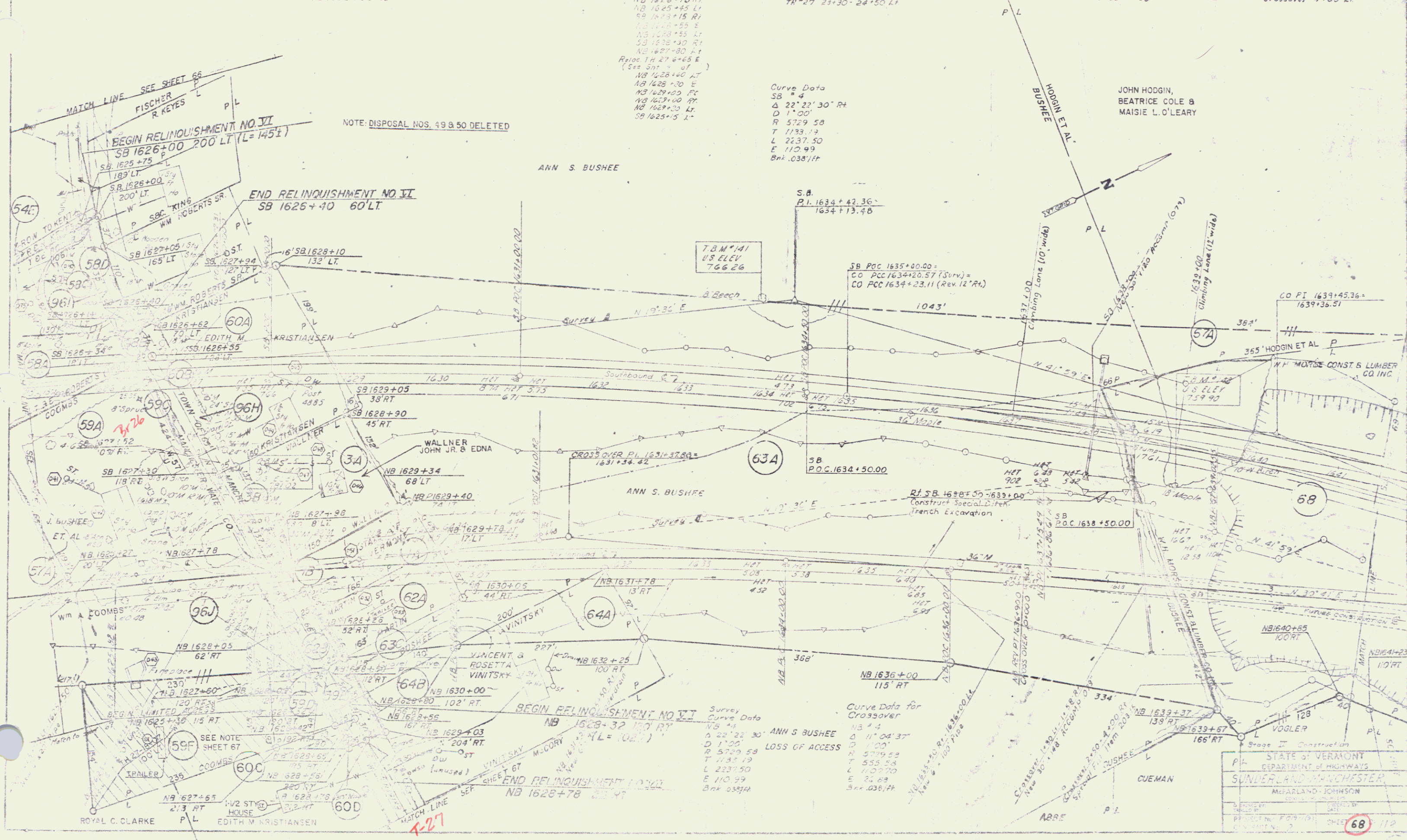

Curve Data
SB 4
Δ 22° 22' 30" RT
D 1' 00"
R 5729.58
T 1133.13
L 2237.50
E 110.99
Bnk 0.38/ft

Survey Curve Data
NB 4
Δ 22° 22' 30"
D 1' 00"
R 5729.58
T 1133.13
L 2237.50
E 110.99
Bnk 0.38/ft

Curve Data for Crossover
NB 4
Δ 11° 04' 37"
D 1' 00"
R 5729.58
T 555.58
L 1107.70
E 21.28
Bnk 0.38/ft

STATE OF VERMONT	
DEPARTMENT OF HIGHWAYS	
SUNDERLAND-MANCHESTER	
MEARLAND-JOHNSON	
DESIGNED BY	DATE
DRAWN BY	DATE
CHECKED BY	DATE
PROJECT NO. 68-112	SHEET 68