

ALL DRIVES AS INDICATED ON PLANS ARE SUBJECT TO PERMITS PURSUANT TO TITLE 19 SECTION 43, VSA

NOTE: DISPOSAL NO. 10 DELETED

* Jute Matting Item 65410
 * NB 1538+25-1607+30 R.
 * NB 1538+75-1600+50 L.
 * Treated Timber Cuts Item 61635
 * NB 1608+24-1608+72 L.
 * Three Cable Guard Rail Light Steel Posts Item 62121
 * NB 1533+00-1593+98 L.
 * NB 1533+00-1594+58 R.
 * NB 1604+00-1608+96 L.

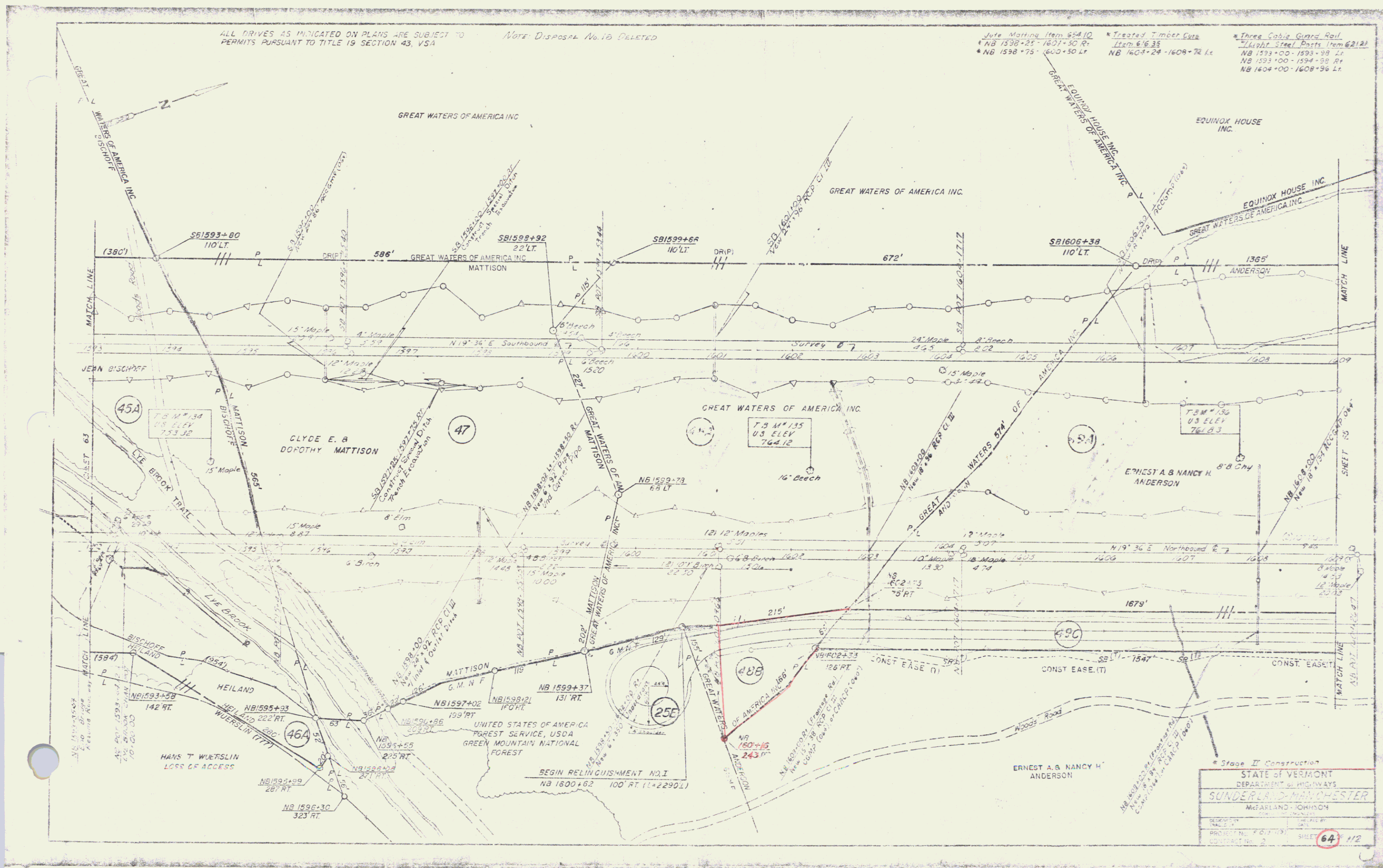

* Stage II Construction	
STATE OF VERMONT	
DEPARTMENT OF HIGHWAYS	
SUNDERLAND-MANCHESTER	
McFARLAND-JOHNSON	
DESIGNED BY	DATE
DRAWN BY	DATE
PROJECT NO. 707-13	SHEET 64
CONTRACT NO. 2	112