

ALL DRIVES AS INDICATED ON PLANS ARE SUBJECT TO PERMITS PURSUANT TO TITLE 19 SECTION 43, VSA

Stone Fill  
Type Hem 512  
NB 1510+95 - 1511+15 Rt

Joint Matting Item 65410  
NB 1509+25 - 1510+85 Rt

\*Tress Code Guard Rail  
\*Light Street Posts Item 52121  
NB 1497+00 - 1498+90 Lt

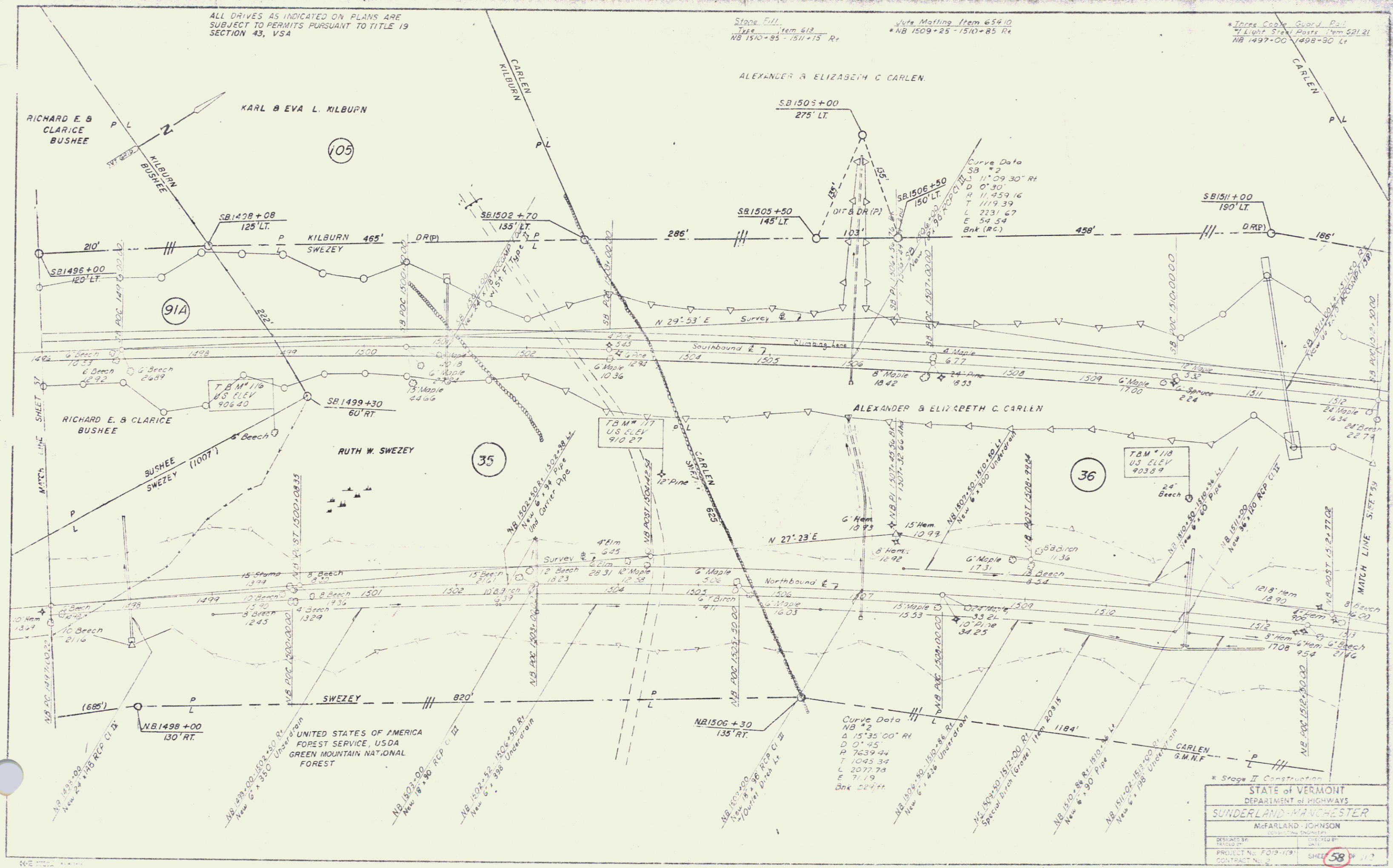

* Stage II Construction	
STATE OF VERMONT	
DEPARTMENT OF HIGHWAYS	
SUNDERLAND-MANCHESTER	
McFARLAND-JOHNSON	
REGISTERED ENGINEER	
DESIGNED BY	CHECKED BY
DRAWN BY	DATE
PROJECT No. F019-119	SHEET 58 OF 112
CONTRACT No. 2	