

GRAY, EDWARD A. & MAUDE B.  
BOARDMAN, WENDALL H. & MARILYN G.

STATE OF VERMONT  
SEE F028-4(2) SECT. II

END R.O.W. PROJECT  
F 028-4(2) STA. 1769+77 (338' LT.)

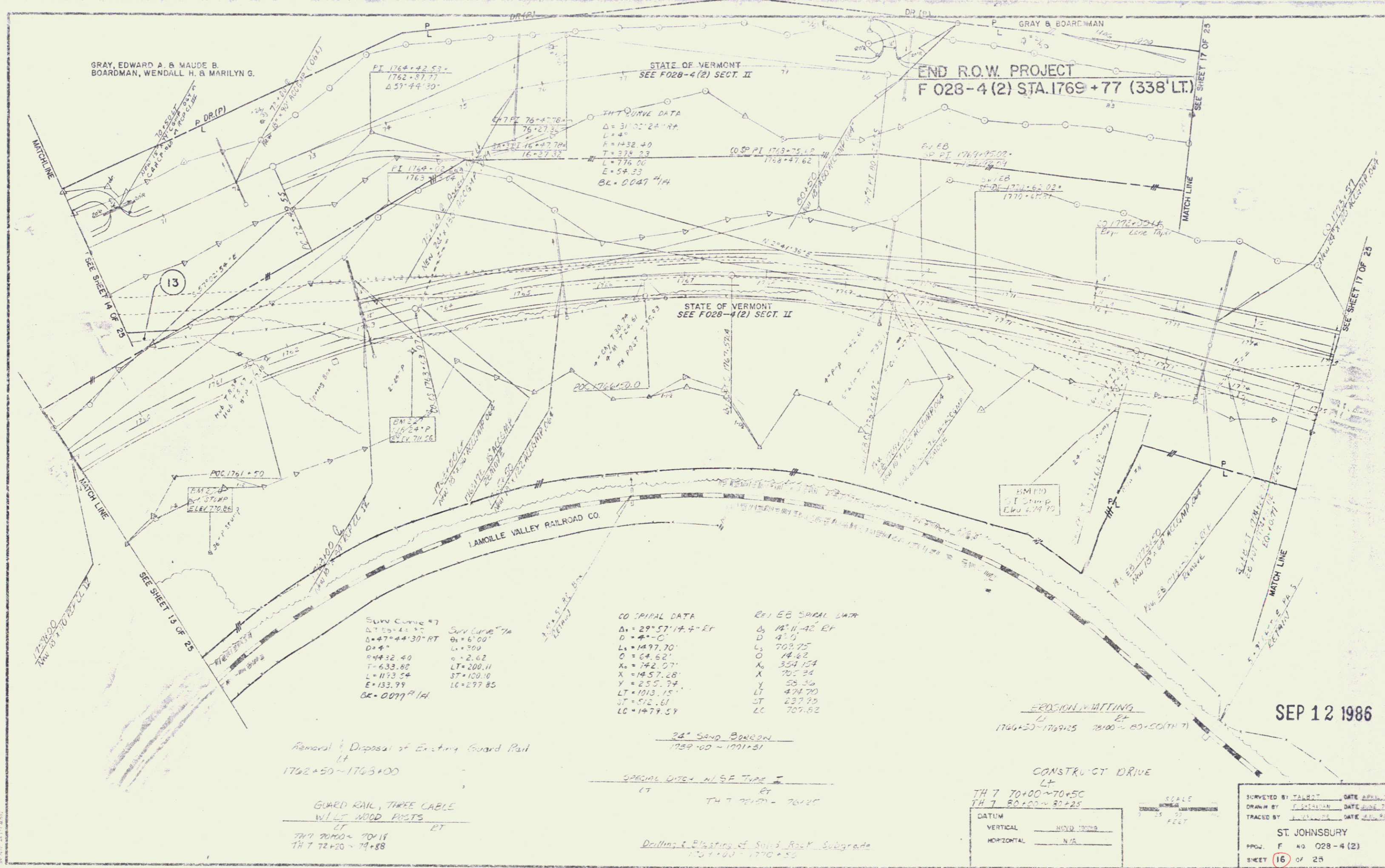

LOW CURVE #7

$\Delta = 74^{\circ}44'30''$ RT	SP. CURVE #7A
$D = 4^{\circ}00'$	$D = 6^{\circ}00'$
$L = 1497.70'$	$L = 870.00'$
$O = 64.62'$	$O = 2.62'$
$X = 1457.28'$	$LT = 200.11'$
$Y = 255.77'$	$ST = 100.10'$
$LT = 1913.15'$	$LC = 297.85'$
$ST = 512.61'$	
$LC = 1479.59'$	

CO. SPIRAL DATA

$\Delta = 29^{\circ}57'14.4''$ LT
$D = 4^{\circ}00'$
$L = 1497.70'$
$O = 64.62'$
$X = 1457.28'$
$Y = 255.77'$
$LT = 1913.15'$
$ST = 512.61'$
$LC = 1479.59'$

REV. EB SPIRAL DATA

$\Delta = 14^{\circ}11'42''$ RT
$D = 4^{\circ}00'$
$L = 708.75'$
$O = 14.62'$
$X = 354.154'$
$Y = 58.36'$
$LT = 474.70'$
$ST = 237.75'$
$LC = 707.82'$

Removal & Disposal of Existing Guard Rail  
LT  
1762+50 - 1763+00

GUARD RAIL, THREE CABLE  
W/LS WOOD POSTS  
LT  
TH 7 70+00 - 70+18  
TH 7 72+20 - 72+88

34" SAND BORER  
1759+00 - 1771+51

SPECIAL DRIVE - W/LS TYPE I  
LT  
TH 7 70+00 - 70+50

Drilling & Blasting of Solid Rock Subgrade  
1767+00 - 1770+50

EROSION & MATTING  
LT  
1766+50 - 1769+25 70+00 - 80+50 (TH 7)

CONSTRUCT DRIVE  
LT  
TH 7 70+00 - 70+50  
TH 7 80+20 - 82+25

DATUM

VERTICAL	NAD 83
HORIZONTAL	N/A

SCALE  
1" = 25' FEET

SURVEYED BY: T.A.R. DATE: APRIL 78  
DRAWN BY: J. JOHNSON DATE: JUNE 77  
TRACED BY: J. JOHNSON DATE: APR. 80  
ST. JOHNSBURY  
PROJ. F NO 028-4(2)  
SHEET 16 OF 25

SEP 12 1986