

REMOVAL & DISPOSAL OF EXISTING
 GUARD RAIL, ITEM 20240
 268+26 Lt-Ramp A 4+90 Lt
 271+30 - 273+01 Lt
 271+70 - 273+13 Rt.

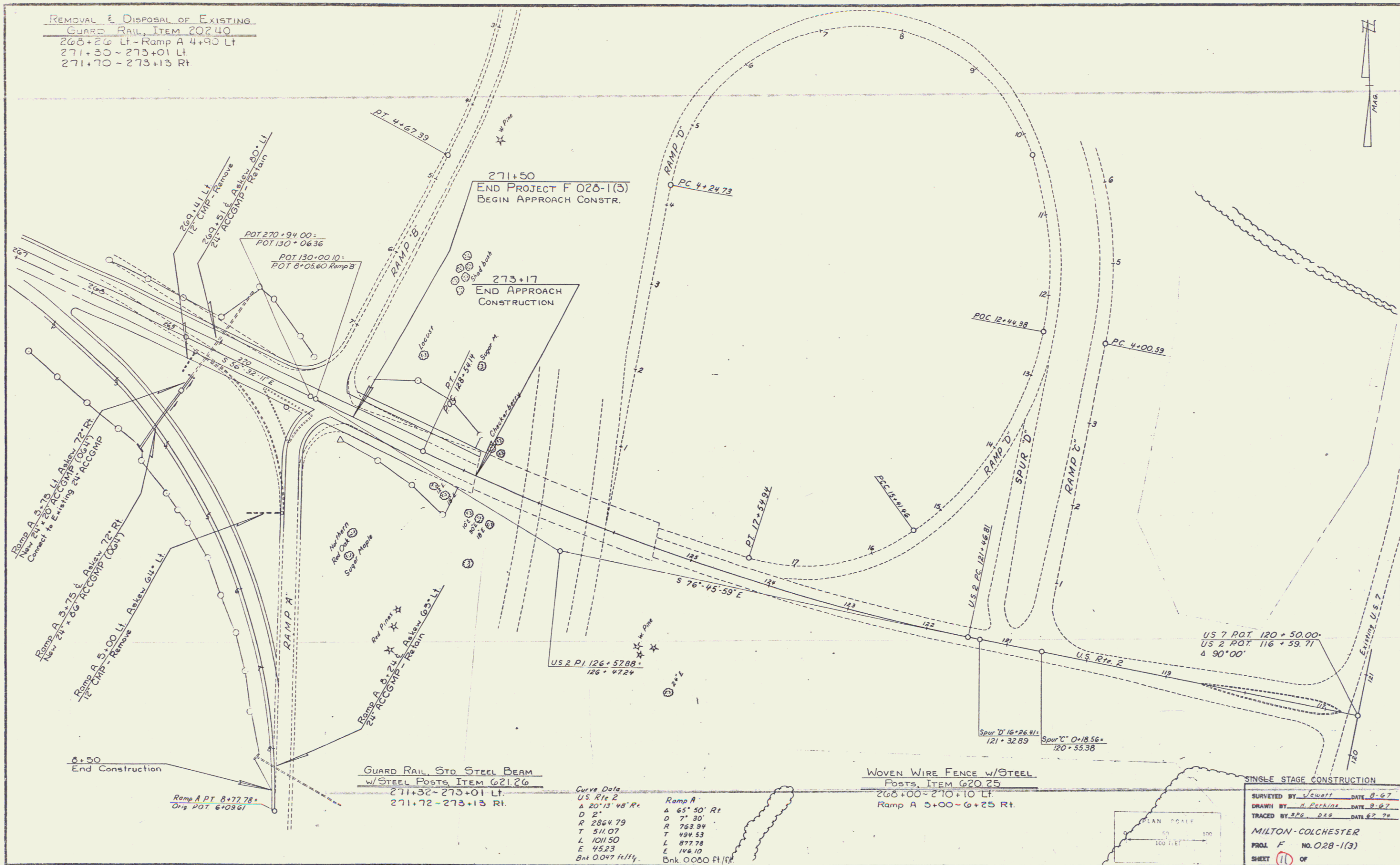

271+50
 END PROJECT F 028-1(3)
 BEGIN APPROACH CONSTR.

273+17
 END APPROACH
 CONSTRUCTION

6+50
 End Construction

GUARD RAIL, STD. STEEL BEAM
 w/STEEL POSTS, ITEM G2126
 271+32-273+01 Lt.
 271+72-273+13 Rt.

Curve Data
 US Rte 2
 Δ 20°13'48" Rt
 D 21'
 R 2864.79
 T 511.07
 L 1011.50
 E 4523
 B+ 0.047 fill ft.
 Bnk 0.060 ft./ft.

WOVEN WIRE FENCE w/STEEL
 Posts, ITEM G2025
 268+00-270+10 Lt.
 Ramp A 3+00-6+25 Rt.

SINGLE STAGE CONSTRUCTION

SURVEYED BY Swatt DATE 8-67
 DRAWN BY H. Perkins DATE 8-67
 TRACED BY SPB, DSS DATE 6-72
 MILTON-COLCHESTER
 PROJ. F NO. 028-1(3)
 SHEET 11 OF

