

WIRE MATTING
ITEM 654.10
147.00-149+00 RT & LT
151+25-152+50 RT.

GUARD RAIL, STANDARD STEEL
BEAM w/ STEEL POSTS, ITEM 621.26
155.97-155+00 RT
155.95-159+00 LT

DRILLING & BLASTING OF SOLID
ROCK SUBGRADE, ITEM 206.10
151+25-154+75
TREATED TIMBER CURBS
ITEM 616.93
156+00-159+00 RT.

WOVEN WIRE FENCE w/
STEEL POSTS, ITEM 620.25
144+00-159+00 LT
144+50-159+00 RT.

ALL DRIVES AS INDICATED ON PLANS
ARE SUBJECT TO PERMITS PURSUANT
TO TITLE 19,
SECTION 43, V.S.A.

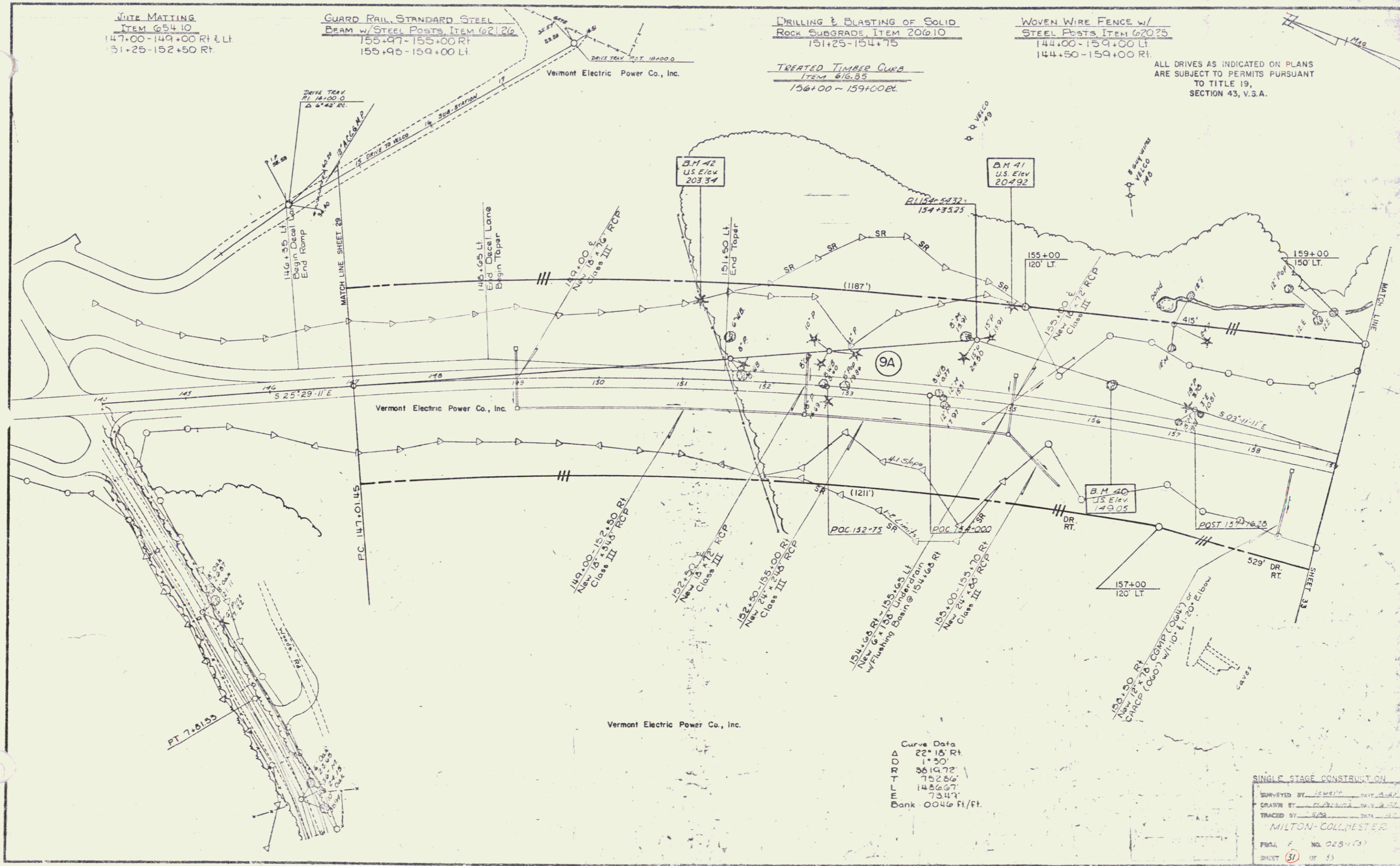

Curve Data
D 22° 18' Rt
R 1+50
T 3614.72'
L 752.86'
E 1488.67'
Bank 004% ft/ft.

SINGLE STAGE CONSTRUCTION
SURVEYED BY: [Signature]
DRAWN BY: [Signature]
TRACED BY: [Signature]
MILTON-COLLISTER
FIG. NO. 028-153
SHEET 51 OF 55