

Removal & Resetting Guard Rail

84+00-84+81 Lt. Tr. Rd #24
84+96-85+11 Rt. Tr. Rd #24

PART OF THE SAME LAND AND PREMISES ACQUIRED FROM
FRANK BOUTET BY WD. DATED 3-29-72 AND RECORDED 4-5-72
IN BK 142 PG. 425-6 OF THE ST. JOHNSBURY LAND RECORDS
IN CONNECTION WITH PROJECT WITH PROJECT WATERFORD I 93-1121

STATE OF VERMONT
TO
VIOLET G. NICHOLS & ELMER L. NICHOLS

*QCD dated 10/15/26
recorded in BK 190, Pages 118-120*

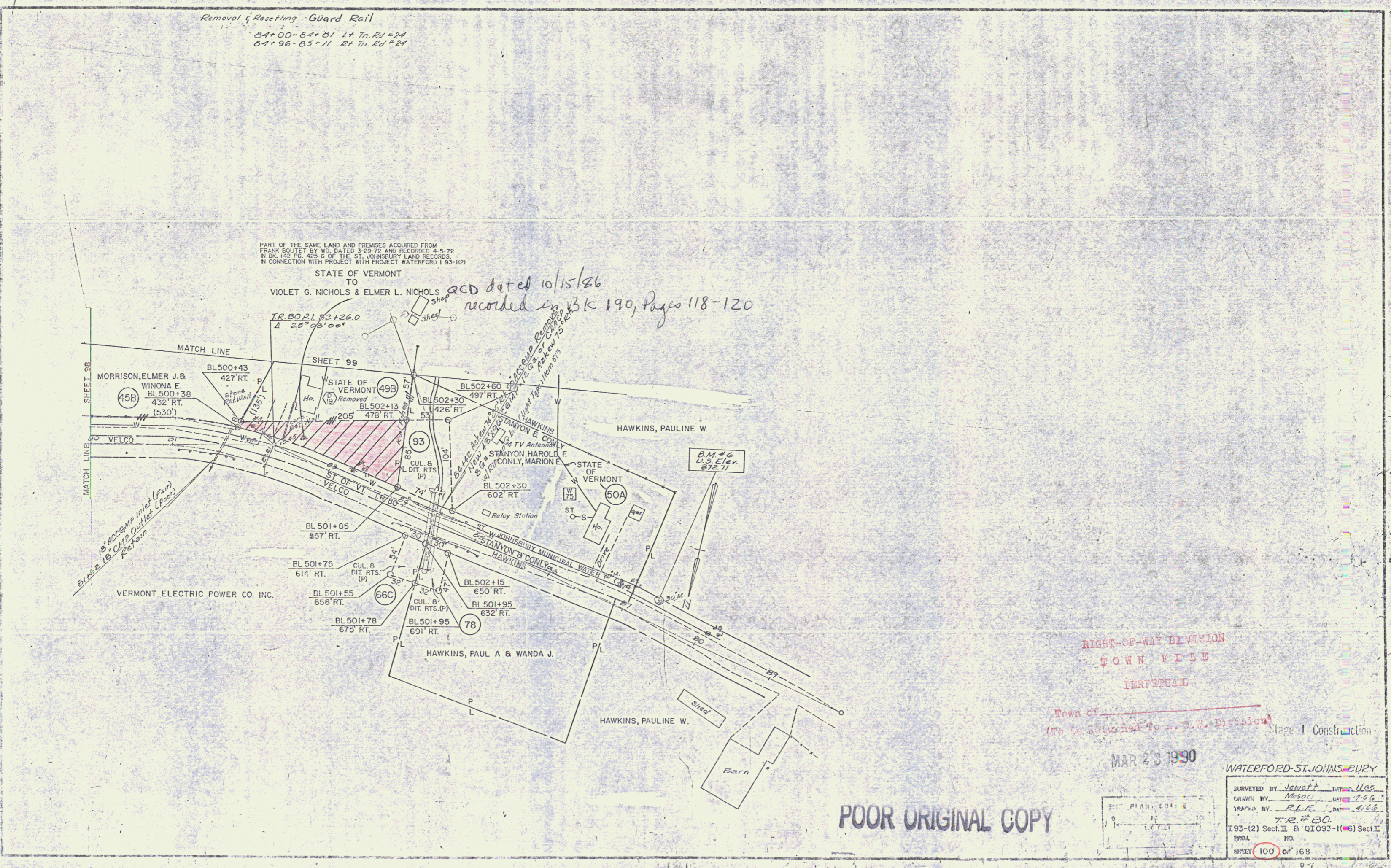

RIGHT-OF-WAY DIVISION
TOWN FILE
PERPETUAL
Town of _____
(To be Returned to R.O.W. Division) Stage 1 Construction

MAR 23 1990

POOR ORIGINAL COPY

WATERFORD-ST. JOHNSBURY	
SURVEYED BY: <i>Jewett</i>	DATE: <i>Nov</i>
DRAWN BY: <i>Mesco</i>	DATE: <i>7-89</i>
TRACKED BY: <i>R.L.C.</i>	DATE: <i>4-88</i>
TR. # <i>30</i>	
I 93-(2) Sect. II & Q1093-1(6) Sect. II	
SHEET <i>100</i> OF 168	